

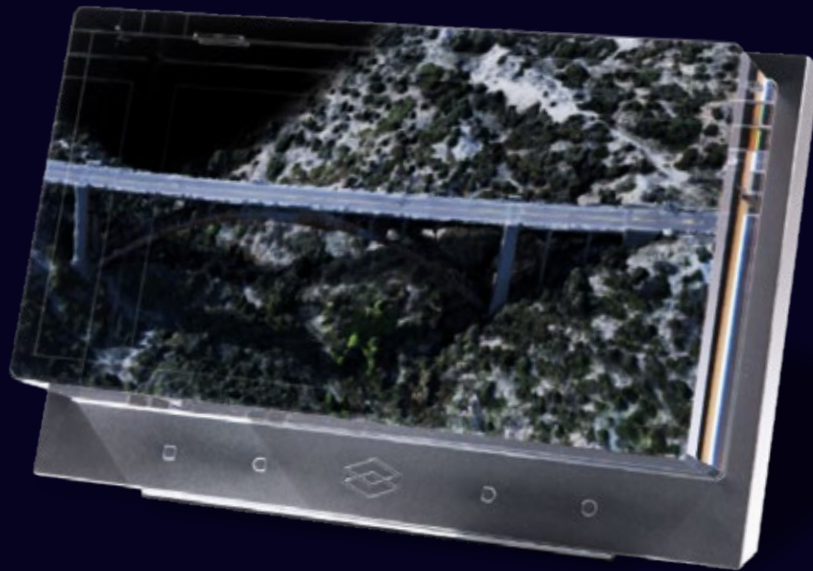



Looking Glass 15.6"

The Holographic Display for 3D Work

Looking Glass 15.6"







A larger 15.6" holographic display system for simulations, reviews, or complex 3D scenes.



-  14.5"x6.9"x9.6" (LxWxH) 18.6Lbs
-  Viewing angle: 50 °
-  ~4 million pixels
-  USB-C power cable, HDMI cable, power cord

MSRP US\$3,000

+ MSRP US\$99 Interaction Accessory Pack (Leap Motion Controller)

Minimum Specifications Requirement	Software Suite		
<p>Operating system: Windows 10 64-bit CPU: Equivalent to Intel Core i5 or above GPU: Equivalent to NVIDIA GeForce GTX 1060 or above RAM: 4GB or above Internal storage: 128GB or above</p>	<p>  </p> <ul style="list-style-type: none">• HoloPlay Unity Plugin• HoloPlay Plugin for Unreal Engine• HoloPlay.js Three.js Library	<p>  </p> <ul style="list-style-type: none">• 3D Model Viewer accepts OBJ, glTF files• Depth Media Player• Light Field Photo Viewer	<p></p> <ul style="list-style-type: none">• HoloPlay Core SDK Cross-platform for building native Looking Glass support into your 3D software

How It Works



Proprietary Light Field Technology

The Looking Glass displays are powered by our proprietary light field technology that generates 45 distinct views of a three-dimensional scene. Unlike any 3D display that has come before it, multiple users now have the ability to gather around a Looking Glass to see different parts of that scene in the real world, without any eye-tracking or headsets.

Many Perspectives At Once

As you move around the Looking Glass, your eyes are exposed to different sets of 3D information, creating a life-like 3D experience for the viewer.

	AR / VR Headsets	3D Monitors	CAVE	Peppers Ghost (e.g. Tupac Hologram)	Looking Glass
Stereo 3D Content	✓	✓	✓	✗	✓
Viewable from different perspectives	✓	✗	✓	✗	✓
Headset-free experience	✗	✗	✗	✓	✓
Viewers per device	1	1	Depends	Many	Many
Ease of Setup	Medium	Easy	Difficult	Depends	Easy
Price of Deployment	\$\$	\$\$	\$\$\$	\$ - \$\$\$ (Depends)	\$\$
Nauseau / Discomfort Level	Medium	Medium	Medium	None (similar to 2D display)	None (similar to 2D display)

About the Company

Who is Looking Glass Factory?

Founded in 2014, Looking Glass Factory Inc. is headquartered in Greenpoint, Brooklyn with additional operations in Hong Kong. In 2018 the company launched the world's first desktop holographic display dev kit; in 2019, started shipping the world's first 8K light field display; and in 2020, launched Looking Glass Portrait, a personal holographic display. Yeah, we really love holograms.

Today, Looking Glass Factory is building a world in which everyone from LiDAR photographers to Unity developers to Fortune 500 companies can leave Flatland and enter the third dimension. Welcome to the [holographic] future.

What is the Looking Glass?

The Looking Glass is a patent-pending combination of light field and volumetric display technologies within a single three-dimensional display system. See your 3D creations come to life. No headsets required. The Looking Glass comes in the following models:

- Looking Glass Portrait
- Looking Glass 15.6"
- Looking Glass 8K

How does it work?

The Looking Glass is a unique combination of light field and volumetric display technologies within a single three-dimensional display system that updates at up to 60fps. It generates 45 distinct views of a three-dimensional scene so that multiple people standing around a Looking Glass can see different parts of the scene in the real world.



Looking Glass Portrait

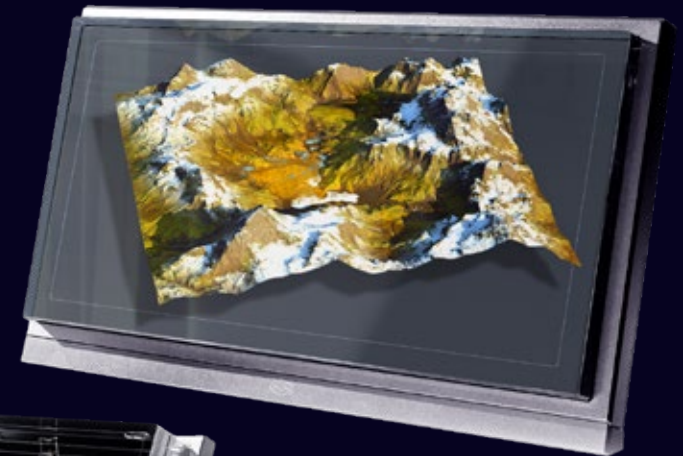

Looking Glass 8K

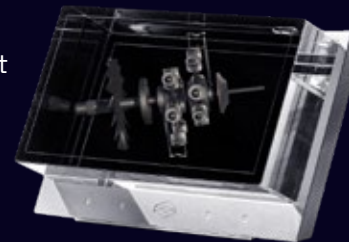

Looking Glass 15.6"