

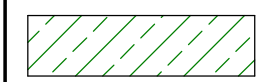

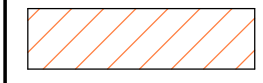

| Loading Legend UNO On Plan |                             |           |          |   |
|----------------------------|-----------------------------|-----------|----------|---|
| Mark                       | Loading Type                | SDL (kPa) | LL (kPa) | Notes   |
| L01                        | Car Parking                 | 0.50      | 2.50     |   |
| L02                        | Stairs and Landing          | 0.25      | 4.00     |   |
| L03                        | Store (Light Usage)         | 0.50      | 5.00     |   |
| L06                        | Corridors / Circulation     | 2.50      | 5.00     | Retail loading adopted for corridors within main mall       |
| L07                        | Retail                      | 2.50      | 5.00     |   |
| L08                        | OSD Tank                    |           | 65.00    | Refer to CJA documentation (CJ Arms-GCOR-000063)            |
| L09                        | Mezzanine Plantroom         |           | 5.00     | 5.00 kPa generally, 2.00 kPa at AHU mezzanine plantrooms    |
| L10                        | Toilet                      | 1.50      | 2.50     |   |
| L11                        | Ramp                        | 0.50      | 2.50     |   |
| L12                        | CM Storage                  | 0.50      | 5.00     |   |
| L15                        | Plant Areas                 | 2.50      | 5.00     |   |
| L16                        | Commercial                  | 1.50      | 3.00     | Compactus is excluded                                       |
| L17                        | Steel Roof                  | 0.80      | 0.25     | UNO on plan   |
| L18                        | Terrace                     | 2.30      | 4.00     | Refer to landscape documentation (LatStu-TRANSMIT-000013)   |
| L19                        | Generator                   |           |          | Refer to NDY electrical documentation (NDY-TRANSMIT-000008) |
| L20                        | Pergola (steel secondary)   | 0.10      | 0.50     |   |
| L21                        | Pergola (polycarbonate)     | 0.60      | 0.25     |   |
| L22                        | 450 lightweight podium soil | 1.30      | 10.30    | Refer to landscape documentation (LatStu-TRANSMIT-000013)   |
| L23                        | 900 lightweight planter     | 1.30      | 12.60    | Refer to landscape documentation (LatStu-TRANSMIT-000013)   |
| L24                        | Concrete seating 450x650    | 7.50      |          |   |
| L25                        | Concrete Seating 900x650    | 15.00     |          |   |
| L26                        | Havillar Crash Deck         | 2.50      | 10.00    |   |
| L27                        | End of Trip Facilities      | 2.00      | 3.00     |   |

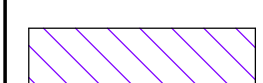

| Existing Building Loading Legend UNO On Plan                                     |      |  |  |
|--|------|--|--|
| Mark   | Year | Carpark Load   | Retail Load  |
|  | 1981 | Design Load = 3.15 kPa                                     | Design Load = 5.00 kPa                                     |
|  | 1995 | Live Load = 3.00 kPa                                       | Live Load = 5.00 kPa                                       |
|  | 2007 | Super Imposed Dead Load = 0.50 kPa<br>Live Load = 2.50 kPa | Super Imposed Dead Load = 2.50 kPa<br>Live Load = 5.00 kPa |

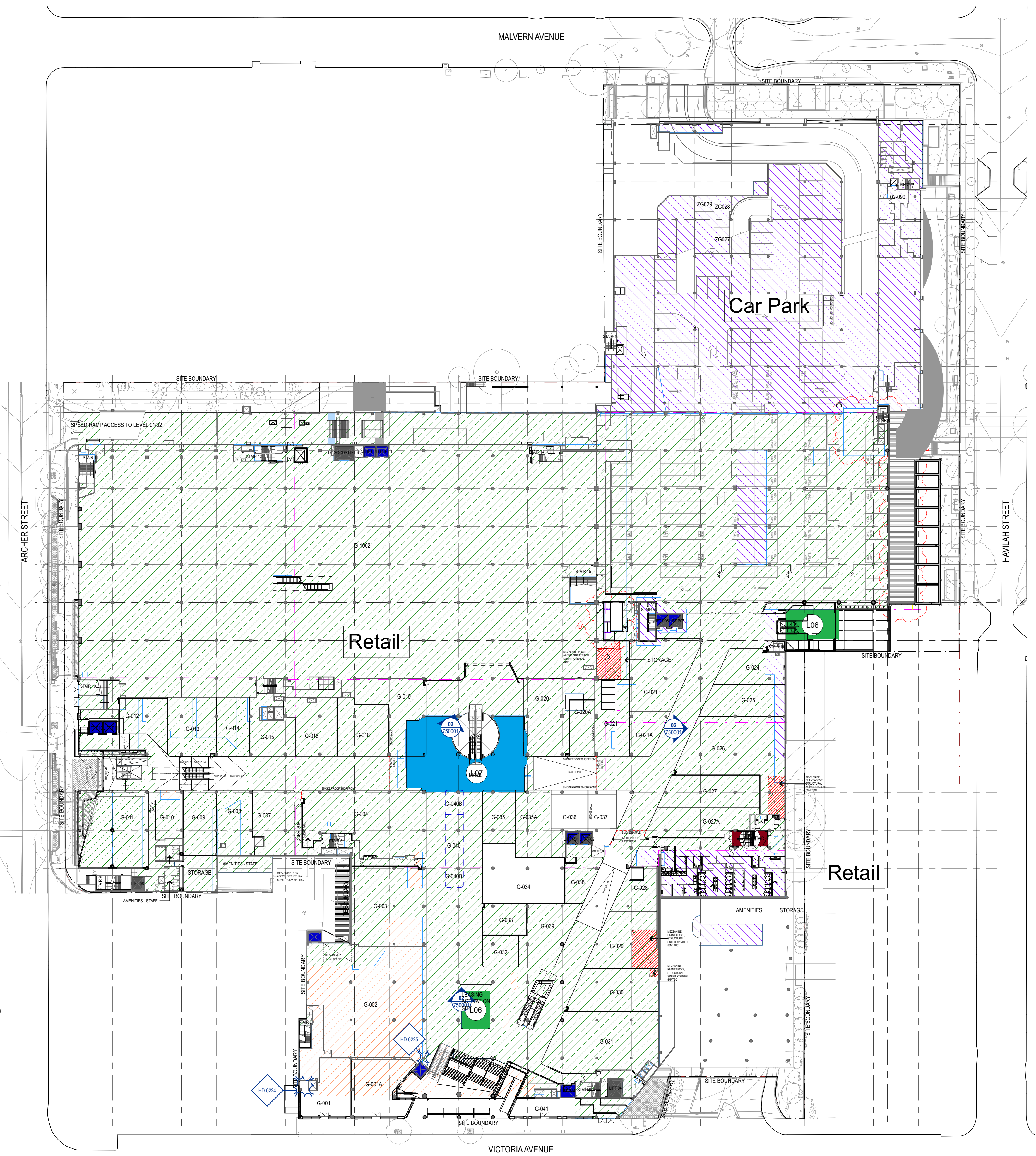
NOTE: THE LOADING INFORMATION SHOWN IS FOR INFORMATION ONLY AND NOT TO BE RELIED ON FOR ANY OTHER PURPOSE AND IS TAKEN FROM ARUP DRAWING SE-ARP-DRG-001003[D]. WEBBER ARE NOT RESPONSIBLE FOR ANY ERRORS OR OMISSIONS. REFER TO LATEST ARUP SE-ARP-DRG-001003 TO CONFIRM LOADING INFORMATION IF FOR ANY OTHER USE.



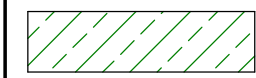
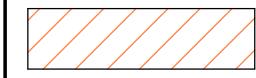

| Loading Legend UNO On Plan |                             |           |          |   |
|----------------------------|-----------------------------|-----------|----------|---|
| Mark                       | Loading Type                | SDL (kPa) | LL (kPa) | Notes   |
| L01                        | Car Parking                 | 0.50      | 2.50     |   |
| L02                        | Stairs and Landing          | 0.25      | 4.00     |   |
| L03                        | Store (Light Usage)         | 0.50      | 5.00     |   |
| L06                        | Corridors / Circulation     | 2.50      | 5.00     | Retail loading adopted for corridors within main mall       |
| L07                        | Retail                      | 2.50      | 5.00     |   |
| L08                        | OSD Tank                    |           | 65.00    | Refer to CJA documentation (CJ Arms-GCOR-000063)            |
| L09                        | Mezzanine Plantroom         |           | 5.00     | 5.00 kPa generally, 2.00 kPa at AHU mezzanine plantrooms    |
| L10                        | Toilet                      | 1.50      | 2.50     |   |
| L11                        | Ramp                        | 0.50      | 2.50     |   |
| L12                        | CM Storage                  | 0.50      | 5.00     |   |
| L15                        | Plant Areas                 | 2.50      | 5.00     |   |
| L16                        | Commercial                  | 1.50      | 3.00     | Compactus is excluded                                       |
| L17                        | Steel Roof                  | 0.80      | 0.25     | UNO on plan   |
| L18                        | Terrace                     | 2.30      | 4.00     | Refer to landscape documentation (LatStu-TRANSMIT-000013)   |
| L19                        | Generator                   |           |          | Refer to NDY electrical documentation (NDY-TRANSMIT-000008) |
| L20                        | Pergola (steel secondary)   | 0.10      | 0.50     |   |
| L21                        | Pergola (polycarbonate)     | 0.60      | 0.25     |   |
| L22                        | 450 lightweight podium soil | 1.30      | 10.30    | Refer to landscape documentation (LatStu-TRANSMIT-000013)   |
| L23                        | 900 lightweight planter     | 1.30      | 12.60    | Refer to landscape documentation (LatStu-TRANSMIT-000013)   |
| L24                        | Concrete seating 450x650    | 7.50      |          |   |
| L25                        | Concrete Seating 900x650    | 15.00     |          |   |
| L26                        | Havillar Crash Deck         | 2.50      | 10.00    |   |
| L27                        | End of Trip Facilities      | 2.00      | 3.00     |   |

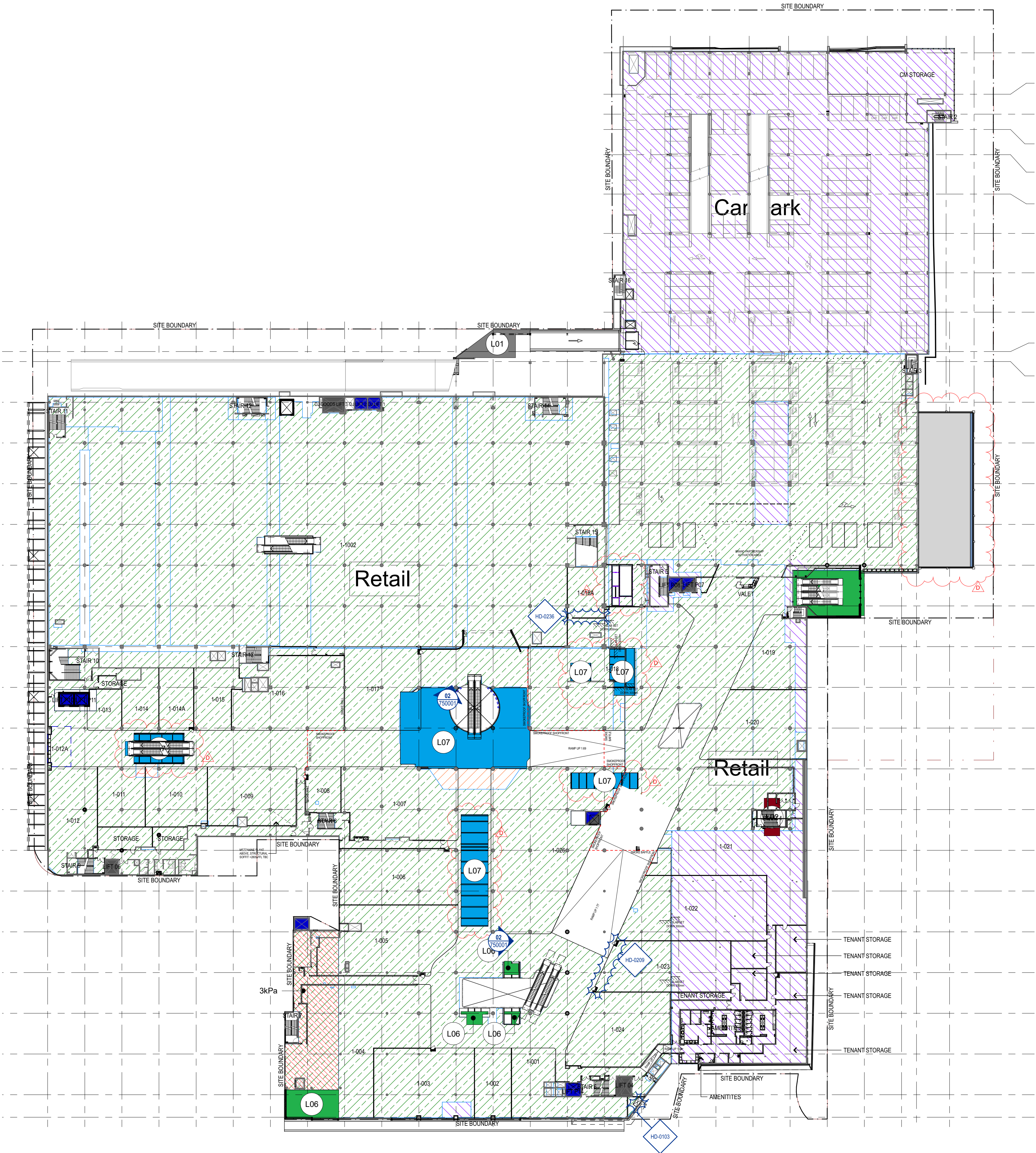

| Existing Building Loading Legend UNO On Plan                                     |      |  |  |
|--|------|--|--|
| Mark   | Year | Carpark Load   | Retail Load  |
|  | 1981 | Design Load = 3.15 kPa                                     | Design Load = 5.00 kPa                                     |
|  | 1995 | Live Load = 3.00 kPa                                       | Live Load = 5.00 kPa                                       |
|  | 2007 | Super Imposed Dead Load = 0.50 kPa<br>Live Load = 2.50 kPa | Super Imposed Dead Load = 2.50 kPa<br>Live Load = 5.00 kPa |

NOTE: THE LOADING INFORMATION SHOWN IS FOR INFORMATION ONLY AND NOT TO BE RELIED ON FOR ANY OTHER PURPOSE AND IS TAKEN FROM ARUP DRAWING SE-ARP-DRG-001004[D]. WEBBER ARE NOT RESPONSIBLE FOR ANY ERRORS OR OMISSIONS. REFER TO LATEST ARUP SE-ARP-DRG-001004 TO CONFIRM LOADING INFORMATION IF FOR ANY OTHER USE.



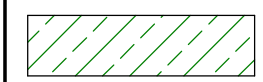
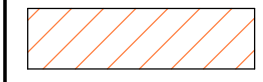

| Loading Legend UNO On Plan |                             |           |          |   |
|----------------------------|-----------------------------|-----------|----------|---|
| Mark                       | Loading Type                | SDL (kPa) | LL (kPa) | Notes   |
| L01                        | Car Parking                 | 0.50      | 2.50     |   |
| L02                        | Stairs and Landing          | 0.25      | 4.00     |   |
| L03                        | Store (Light Usage)         | 0.50      | 5.00     |   |
| L06                        | Corridors / Circulation     | 2.50      | 5.00     | Retail loading adopted for corridors within main mall       |
| L07                        | Retail                      | 2.50      | 5.00     |   |
| L08                        | OSD Tank                    |           | 65.00    | Refer to CJA documentation (CJ Arms-GCOR-000063)            |
| L09                        | Mezzanine Plantroom         |           | 5.00     | 5.00 kPa generally, 2.00 kPa at AHU mezzanine plantrooms    |
| L10                        | Toilet                      | 1.50      | 2.50     |   |
| L11                        | Ramp                        | 0.50      | 2.50     |   |
| L12                        | CM Storage                  | 0.50      | 5.00     |   |
| L15                        | Plant Areas                 | 2.50      | 5.00     |   |
| L16                        | Commercial                  | 1.50      | 3.00     | Compactus is excluded                                       |
| L17                        | Steel Roof                  | 0.80      | 0.25     | UNO on plan   |
| L18                        | Terrace                     | 2.30      | 4.00     | Refer to landscape documentation (LatStu-TRANSMIT-000013)   |
| L19                        | Generator                   |           |          | Refer to NDY electrical documentation (NDY-TRANSMIT-000008) |
| L20                        | Pergola (steel secondary)   | 0.10      | 0.50     |   |
| L21                        | Pergola (polycarbonate)     | 0.60      | 0.25     |   |
| L22                        | 450 lightweight podium soil | 1.30      | 10.30    | Refer to landscape documentation (LatStu-TRANSMIT-000013)   |
| L23                        | 900 lightweight planter     | 1.30      | 12.60    | Refer to landscape documentation (LatStu-TRANSMIT-000013)   |
| L24                        | Concrete seating 450x650    | 7.50      |          |   |
| L25                        | Concrete Seating 900x650    | 15.00     |          |   |
| L26                        | Havillar Crash Deck         | 2.50      | 10.00    |   |
| L27                        | End of Trip Facilities      | 2.00      | 3.00     |   |

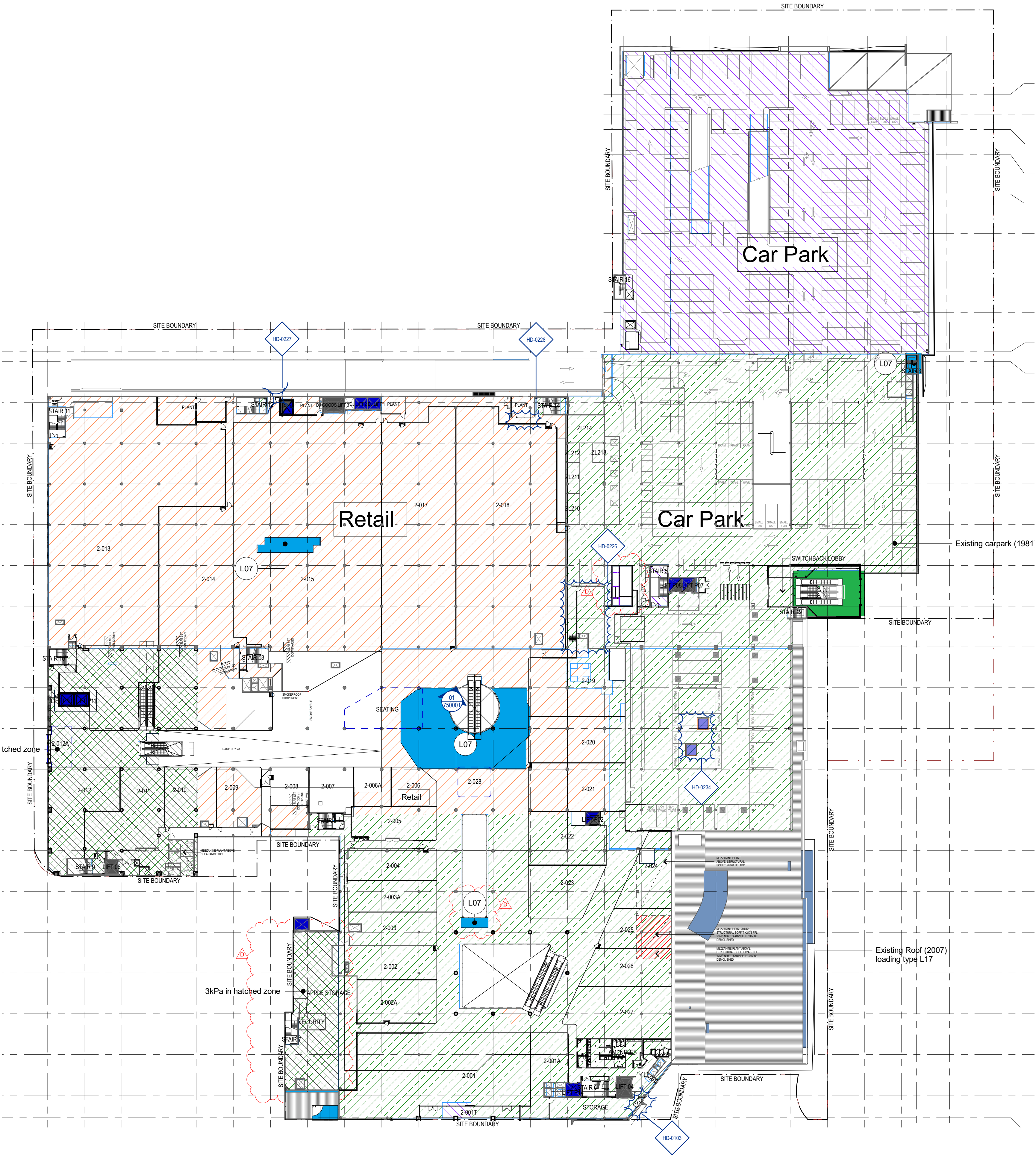

| Existing Building Loading Legend UNO On Plan                                     |      |  |  |
|--|------|--|--|
| Mark   | Year | Carpark Load   | Retail Load  |
|  | 1981 | Design Load = 3.15 kPa                                     | Design Load = 5.00 kPa                                     |
|  | 1995 | Live Load = 3.00 kPa                                       | Live Load = 5.00 kPa                                       |
|  | 2007 | Super Imposed Dead Load = 0.50 kPa<br>Live Load = 2.50 kPa | Super Imposed Dead Load = 2.50 kPa<br>Live Load = 5.00 kPa |

NOTE: THE LOADING INFORMATION SHOWN IS FOR INFORMATION ONLY AND NOT TO BE RELIED ON FOR ANY OTHER PURPOSE AND IS TAKEN FROM ARUP DRAWING SE-ARP-DRG-001005[D]. WEBBER ARE NOT RESPONSIBLE FOR ANY ERRORS OR OMISSIONS. REFER TO LATEST ARUP SE-ARP-DRG-001005 TO CONFIRM LOADING INFORMATION IF FOR ANY OTHER USE.



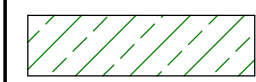
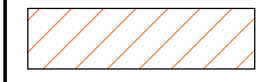

| Loading Legend UNO On Plan |                             |           |          |   |
|----------------------------|-----------------------------|-----------|----------|---|
| Mark                       | Loading Type                | SDL (kPa) | LL (kPa) | Notes   |
| L01                        | Car Parking                 | 0.50      | 2.50     |   |
| L02                        | Stairs and Landing          | 0.25      | 4.00     |   |
| L03                        | Store (Light Usage)         | 0.50      | 5.00     |   |
| L06                        | Corridors / Circulation     | 2.50      | 5.00     | Retail loading adopted for corridors within main mall       |
| L07                        | Retail                      | 2.50      | 5.00     |   |
| L08                        | OSD Tank                    |           | 65.00    | Refer to CJA documentation (CJ Arms-GCOR-000063)            |
| L09                        | Mezzanine Plantroom         |           | 5.00     | 5.00 kPa generally, 2.00 kPa at AHU mezzanine plantrooms    |
| L10                        | Toilet                      | 1.50      | 2.50     |   |
| L11                        | Ramp                        | 0.50      | 2.50     |   |
| L12                        | CM Storage                  | 0.50      | 5.00     |   |
| L15                        | Plant Areas                 | 2.50      | 5.00     |   |
| L16                        | Commercial                  | 1.50      | 3.00     | Compactus is excluded                                       |
| L17                        | Steel Roof                  | 0.80      | 0.25     | UNO on plan   |
| L18                        | Terrace                     | 2.30      | 4.00     | Refer to landscape documentation (LatStu-TRANSMIT-000013)   |
| L19                        | Generator                   |           |          | Refer to NDY electrical documentation (NDY-TRANSMIT-000008) |
| L20                        | Pergola (steel secondary)   | 0.10      | 0.50     |   |
| L21                        | Pergola (polycarbonate)     | 0.60      | 0.25     |   |
| L22                        | 450 lightweight podium soil | 1.30      | 10.30    | Refer to landscape documentation (LatStu-TRANSMIT-000013)   |
| L23                        | 900 lightweight planter     | 1.30      | 12.60    | Refer to landscape documentation (LatStu-TRANSMIT-000013)   |
| L24                        | Concrete seating 450x650    | 7.50      |          |   |
| L25                        | Concrete Seating 900x650    | 15.00     |          |   |
| L26                        | Havillar Crash Deck         | 2.50      | 10.00    |   |
| L27                        | End of Trip Facilities      | 2.00      | 3.00     |   |

| Existing Building Loading Legend UNO On Plan                                     |      |  |  |
|--|------|--|--|
| Mark   | Year | Carpark Load   | Retail Load  |
|  | 1981 | Design Load = 3.15 kPa                                     | Design Load = 5.00 kPa                                     |
|  | 1995 | Live Load = 3.00 kPa                                       | Live Load = 5.00 kPa                                       |
|  | 2007 | Super Imposed Dead Load = 0.50 kPa<br>Live Load = 2.50 kPa | Super Imposed Dead Load = 2.50 kPa<br>Live Load = 5.00 kPa |

NOTE: THE LOADING INFORMATION SHOWN IS FOR INFORMATION ONLY AND NOT TO BE RELIED ON FOR ANY OTHER PURPOSE AND IS TAKEN FROM ARUP DRAWING SE-ARP-DRG-001006[D]. WEBBER ARE NOT RESPONSIBLE FOR ANY ERRORS OR OMISSIONS. REFER TO LATEST ARUP SE-ARP-DRG-001006 TO CONFIRM LOADING INFORMATION IF FOR ANY OTHER USE.

