

User Manual

FM Transmitter For Car

BTCK-310

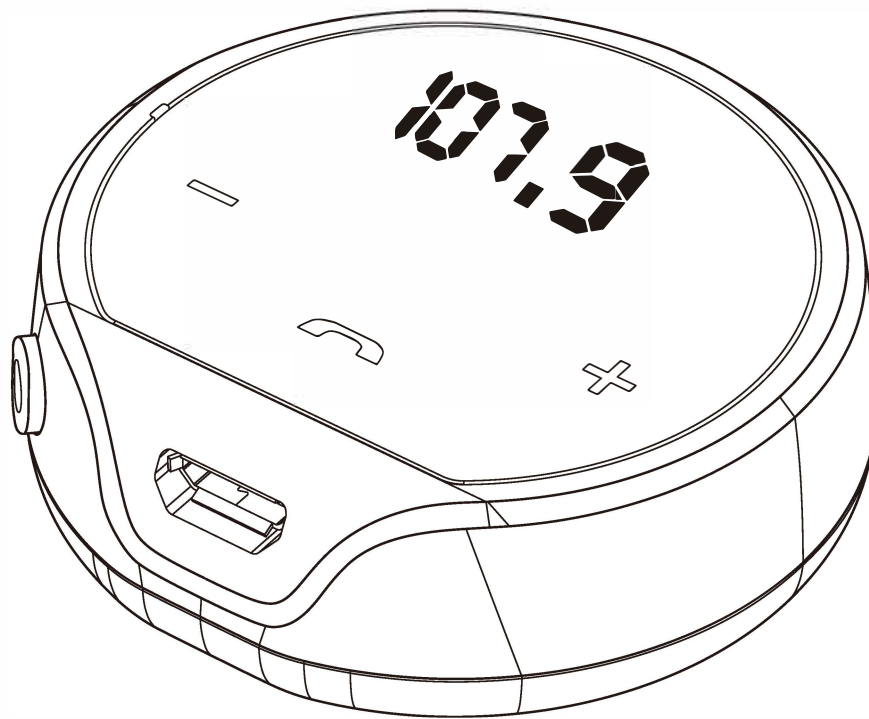

Product Overview	1
Basic Operations	1
LED Indicators	2
Set up	2
Installing CK310 onto your Car	2
Pairing with your mobile phone	3
FM Setting (Support frequency 88.1MHz ~ 107.9MHz)	4
Reconnecting	4
Factory Reset	5
How to Charge	5
Troubleshooting	6

Product Overview

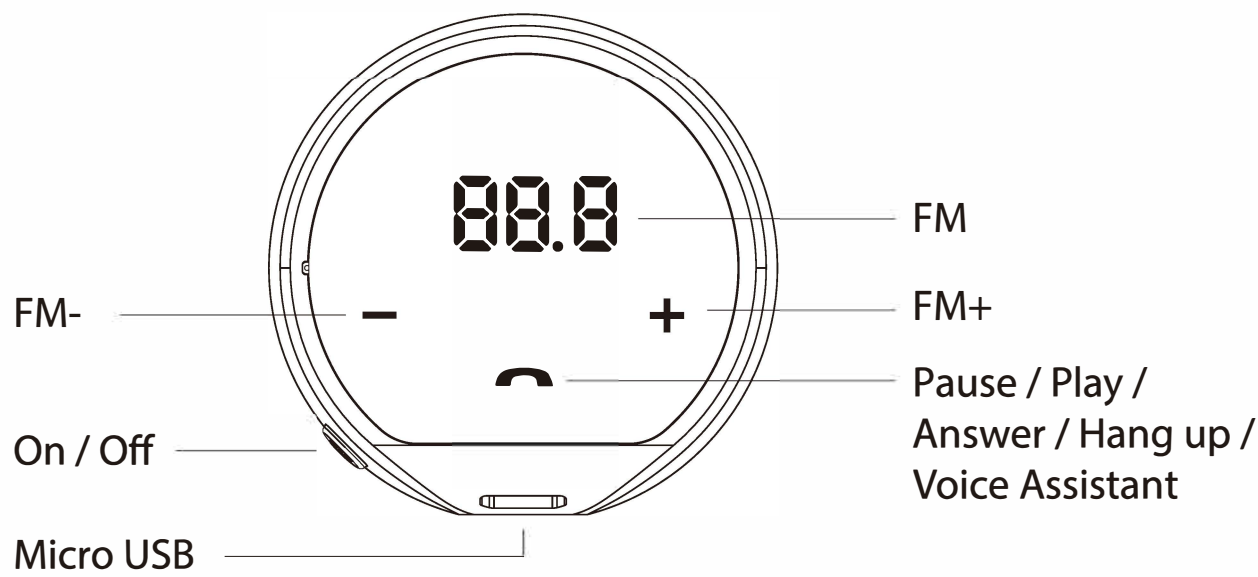

 : On / Off / Pair













 : Reconnect

Music (Play / Pause)

Call (Answer / Hand Up / Reject)

Voice Assistant (Long press for 3 seconds)

Basic operation

FUNCTION	OPERATION
Power on / off	Manually turn on/off: Press  once Auto-power on/off: when charging/out of charge
ENTER PAIRING MODE	From ON, press and hold  for 3 seconds until the  LED flashes BLUE and RED alternately.
Manually re-connect	Tap  once
Answer/End a call	Tap  once
Reject a call	Tap and hold  for 2 seconds
Mute/Un-mute the microphone	Tap and hold  for 3 second DURING CALL
Voice control (phone feature: Siri, Google assistant)	Tap and hold  for 3 second
Play / Pause	Tap  once
Set FM frequency	Short tap  /  once to increase/reduce 0.1 MHz Long tap  /  once to increase/reduce 1 MHz

LED Indicators

Working Status	LED indicator	Voice Prompts
Power on	BLUE LED on 1 second	"Power ON"
Pairing in progress	RED and BLUE LED flash alternately	"Pairing"
Connected	BLUE LED flash once then will off if no-ops within 8 seconds	"Your headset is connected"
Disconnected	BLUE LED flash once every 2 seconds	"Your headset is disconnected"
Low battery		"Battery Low"
Charging in progress	RED LED steady on	"Charging"
Charging completed	RED LED off	

Note: The RED LEDs for FM number display and + / - touch buttons will turn off if left idle for over 8 seconds. Tap any button to wake it up.

Set up

Installing CK310 onto your Car

1. Find a spot on your dashboard that is easily reachable for you and has a flat/smooth surface.
2. Use the magic tape provided to attach the CK310 in the spot you've selected.
3. Please check to make sure the device and the spot won't hinder your driving.



If you would like to use CK310 with charger always connected>



Please connect CK310 to your existing car charger using the USB cable provided, it will automatically turn on once in charge, and turn off when out of charge.



To improve sound quality during calls >

To improve the sound quality during calls, try moving the CK310 to a spot closer to you (e.g steering wheel). The closer the device is to you, the better the sound/call quality.

Pairing with your mobile phone

1. Turn on CK310 – Press  once.
2. Set CK310 to PAIRING MODE - Press and hold  button for 3 seconds until LED flashes **BLUE** and **RED** alternately.
(On first use, CK310 will automatically enter pairing mode once powered on)
3. Activate Bluetooth on your phone, search and select "Avantree CK310" to connect.

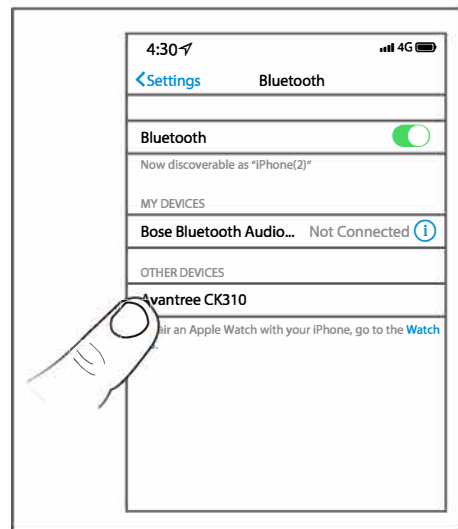
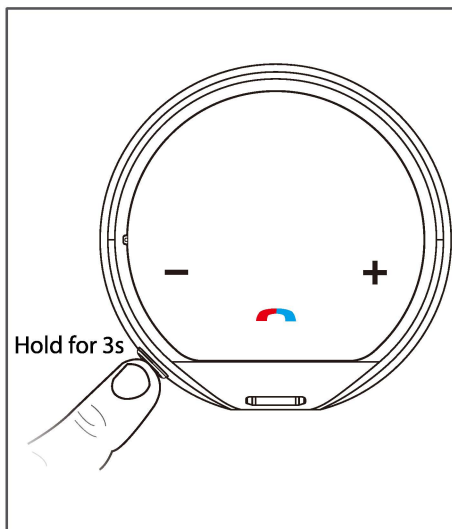
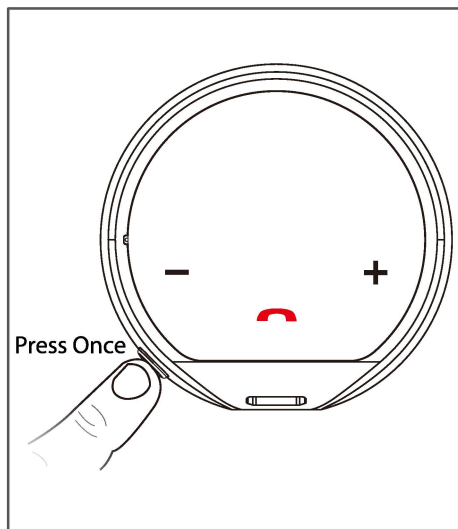

FM Setting (Support frequency 88.1MHz ~ 107.9MHz)

1. Choose a vacant channel from your car radio: most vacant channels may still contain pure noise; the purer the channel, the more suitable it is for FM transmitter use.
2. Set the FM frequency of CK310 to the same as your car radio channel using the **+** & **-** touch buttons.



Reconnecting

Please ensure your device's Bluetooth is on. CK310 will auto reconnect to the most recently connected device once being powered on. Otherwise, tap  once to manually reconnect. For other paired devices, please tap "Avantree CK310" on your phone to reconnect.

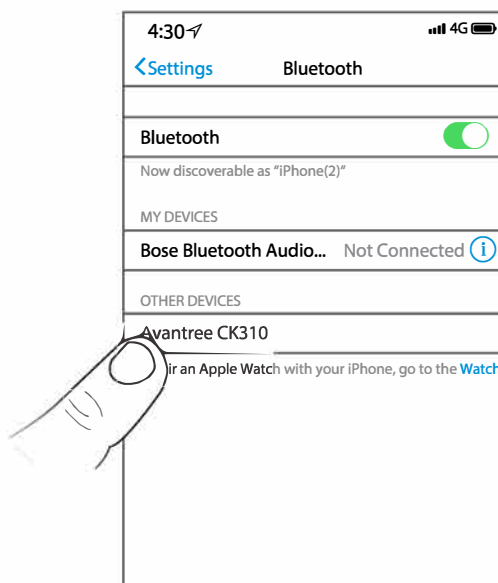
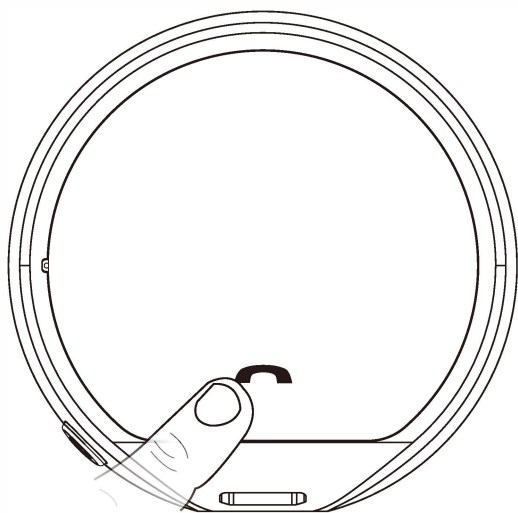

Factory Reset

You may reset the CK310 to factory settings if it's not working as expected. After resetting to factory default, pairing history will be erased from the CK310. Please

1. Make sure CK310 is connected to the charger.
2. Press and hold  for 3 seconds until the  LED flashes **BLUE** and **RED** alternately.
3. Double click  button and you will hear 2 "beeps" indicating a successful reset. After resetting, the device will automatically enter pairing mode again.

Note: For successful connection, please also delete the pairing history on your phone and re-pair with CK310.

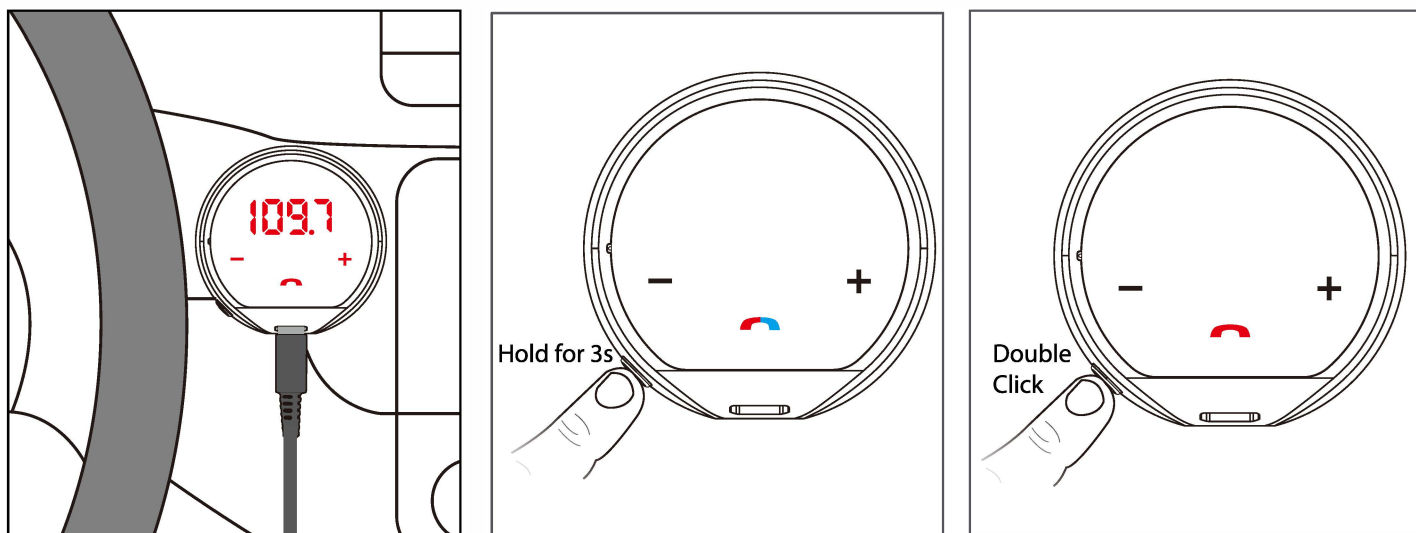

How to Charge

When you hear a "Battery low" prompt every 5 minutes, you should charge the device. Full charge takes about 2 hours. The  LED will remain **RED** while charging and will turn off automatically once charging is complete. You can plug the CK310 into a USB wall charger/car charger (DC 5V/0.5-1A) or a computer USB port with the computer powered on.

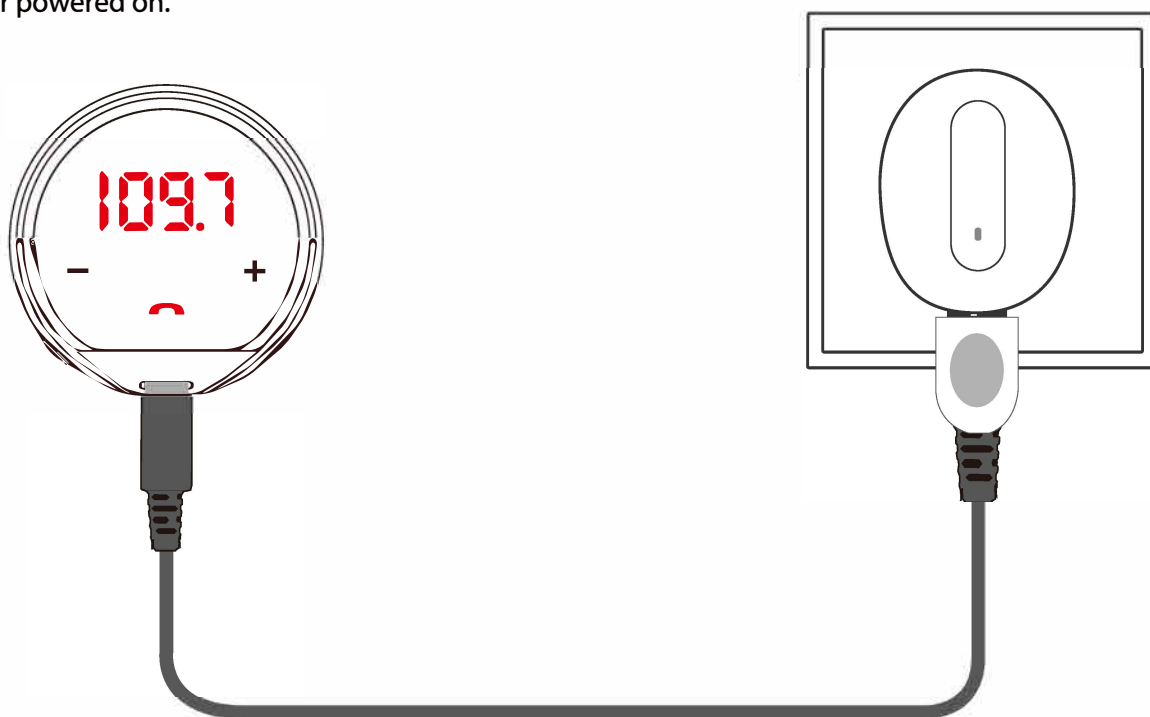

Troubleshooting

1. Why aren't the touch buttons working?

The product enters in "power save" mode once left idle for 8 seconds, the touch buttons does not work in this state. Please touch the bottom half of the screen to wake the product up to use the touch buttons.

2. What to do if I'm not satisfied with the sound quality?

- a) Adjust the car radio to a quieter channel; the less noise the channel has, the more suitable it is as a channel for FM transmission.
- b) Ensure the CK310 and the car radio are on the same frequency.

3. Why can't I connect the CK310 with my Bluetooth device?

- a) Ensure CK310 is in pairing mode - LED  will flash **BLUE** and **RED** alternately
- b) Reboot the Bluetooth device you would like to use. Delete "Avantree CK310" from your device's Bluetooth list and then try to pair again.
- c) Reset the CK310 as above. See the "clear pairing history" section above.

4. Why can't I adjust the volume via the touch screen of CK310?

Please note that the **+**/**—** buttons on CK310 can only adjust the FM frequency, NOT the volume. You may adjust the volume using your cell phone or car speaker.