

User Manual

True Wireless Stereo Earbuds

BTHS-TWS115

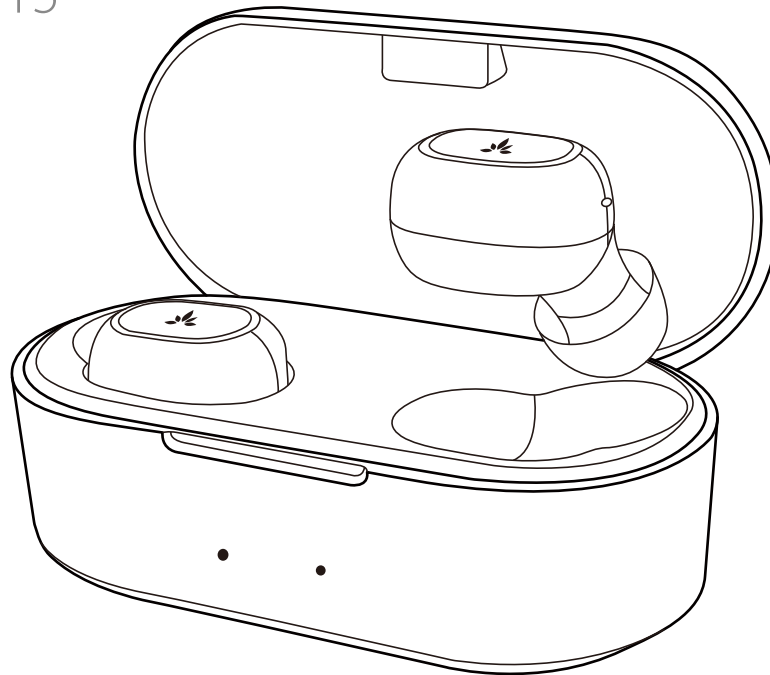

Product overview	1
Included accessories	2
How to wear.....	2
Select & replace eartips	2
Fitting adjustment.....	3
How to charge	3
Charging the earbuds.....	3
Charging the case.....	4
Basic operations	5
LED Indications	5
For earbuds.....	5
For charging case.....	6
How to pair.....	6
Connect to a Bluetooth device	6
How to clear pairing history / reset.....	10
Support.....	11
FAQ	11
How to care for your earbuds.....	11

Product Overview

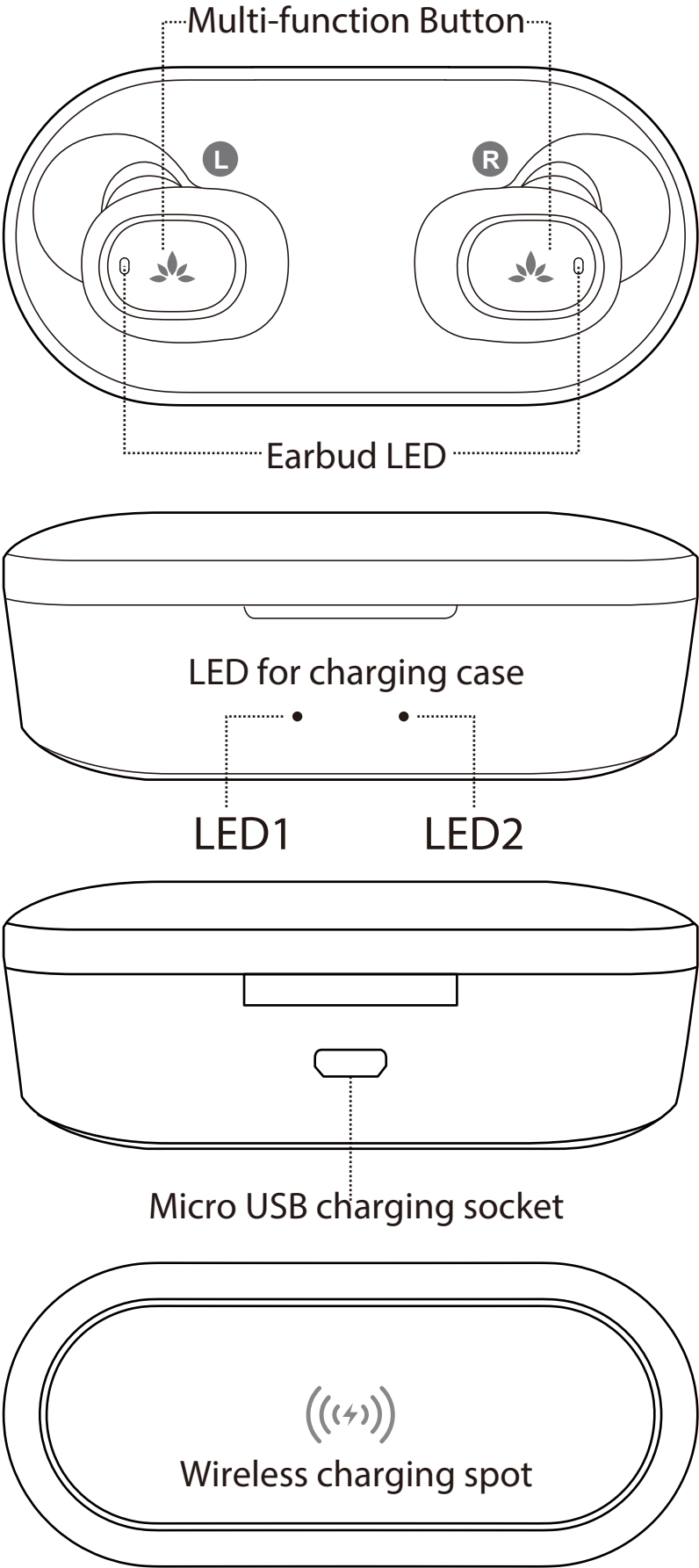

Included accessories

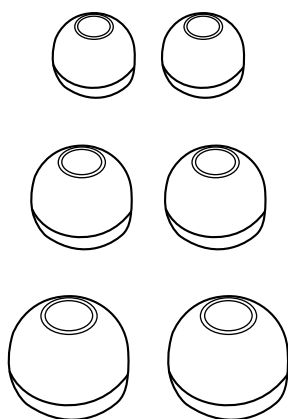

Ear tips

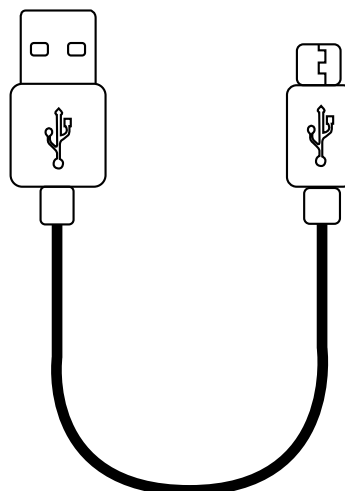

Micro-USB cable

How to wear

Select & replace eartips

To get the optimal experience, we recommend that you give each of the different sized eartips a try and find the pair that fits your ears the best. The medium-sized eartips are pre-mounted on the earbuds. Please ensure that the eartips are firmly attached.

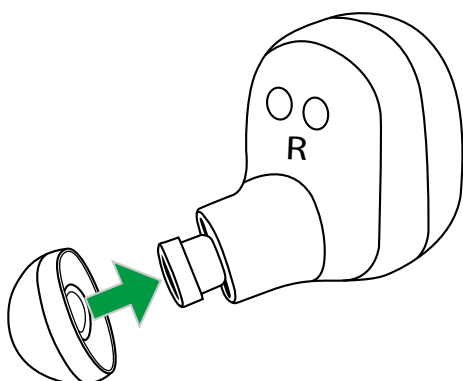
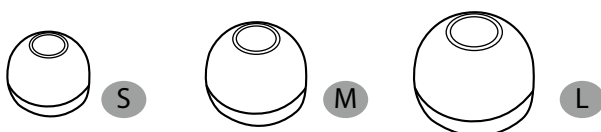

Fitting adjustment

Insert the earbud into your ear and rotate to fit comfortably.

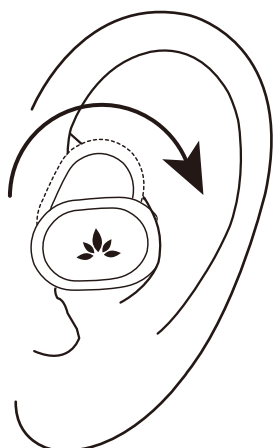

How to charge

With up to 4 hours of battery in the earbuds, and 5-6 recharges in the charging case, Avantree TWS115 offers up to 36 hours of playtime.

Charging the earbuds

When you start hearing the “battery low” voice prompt, please charge the earbuds by putting them back into the charging case. It takes about 1 hour to fully charge. The LED indicators on the earbuds will illuminate **RED** while charging. Once the charging has completed, the indicators will show **WHITE** for a minute before automatically turning off.

(Note: The earbuds will automatically turn off about 10 minutes after the first low battery warning.)

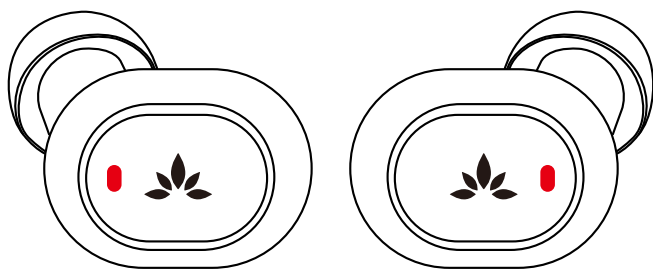

Charging - illuminate **RED**

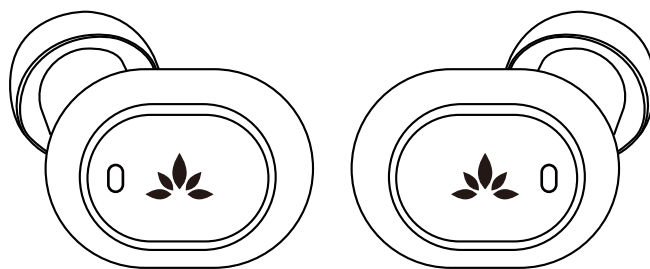

Fully charged - illuminate **White** then go off

Charging the case

Please charge the case if the earbuds won't power off automatically after putting in the case. Charging the case will also charge the earbuds if the earbuds are inside the case.

The case supports both wired and wireless charging :

- **Wired charge** - Please use a DC 5V / 0.5-2A USB wall charger / car charger / computer USB port with the included Micro USB cable to charge.

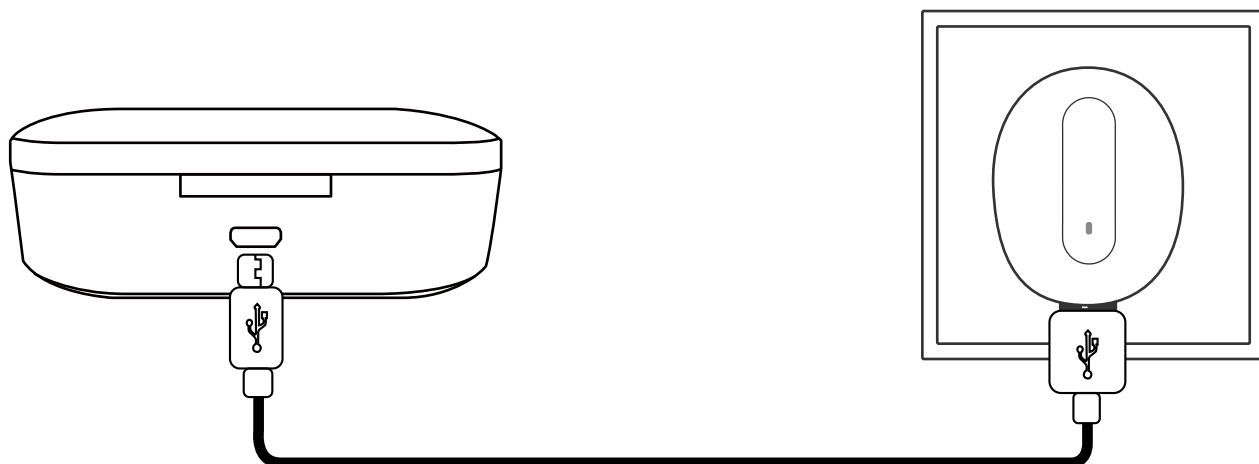

- **Wireless charge** – Please put the charging case of Avantree TWS115 onto your wireless charger with the (()) icon close to the induction area.

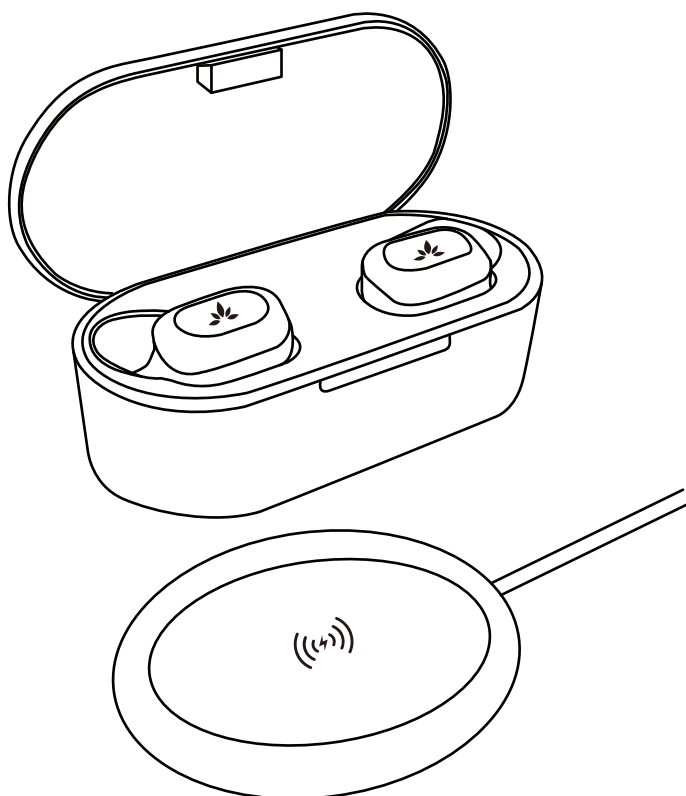

The left-side LED (LED 1) will illuminate **RED** while charging. When fully charged, the left-side LED (LED 1) will turn off and the right-side LED (LED 2) will illuminate **GREEN**.

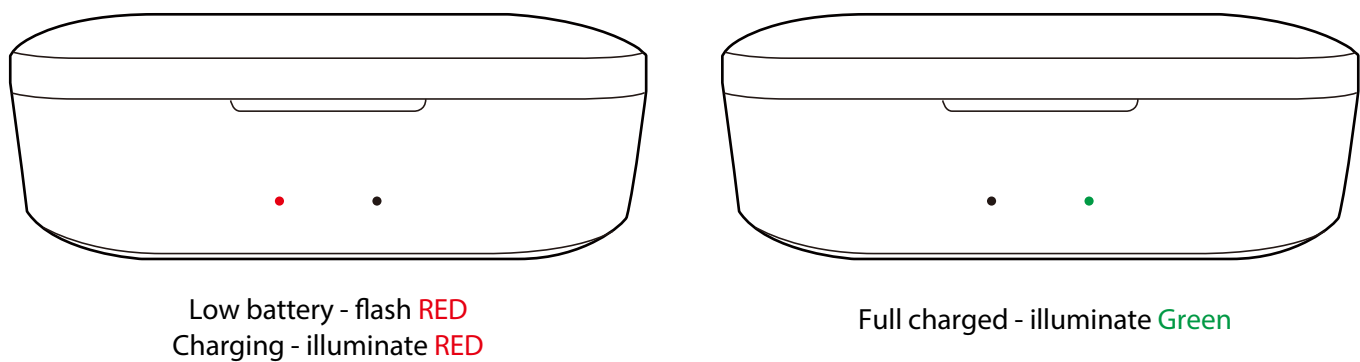

Basic operations

Function	Operation
Power On	Remove the earbuds from charging case OR from off status, short press the Multi-function Button for 1s, LED light will illuminate WHITE for about 1s
Power Off	Put the earbuds back into the charging case; they will power off and start charging. OR long press the Multi-function Button for 5s, the LED light will illuminate RED and then turn off
Pairing	Remove BOTH earbuds from case - one will automatically enter pairing mode and its LED will flash WHITE and RED alternately
Play / Pause	Short press the Multi-function Button once on either earbud
Previous Track	Double tap the Multi-function Button on the LEFT earbud
Next Track	Double tap the Multi-function Button on the RIGHT earbud
Answer / End A Call	Short press the Multi-function Button once on either earbud

LED Indications

For earbuds

Connected with mobile device	LED on the R earbud double-flashes WHITE every 5s
Not connected with mobile device	LED on the R earbud flashes WHITE once every 1s
Earbuds connected with each other	LED on the L earbud double-flashes WHITE every 5s
Earbuds not connected with each other	LED on the L earbud flashes WHITE once every 1s
Battery low	LEDs will flash RED 4 times every 2 mins
Charging	LEDs stay RED
Fully charged	RED LEDs turn to WHITE for about 1 min then turn off

For charging case

Battery low	Left-side LED (LED 1) flashes RED
Charging	Left-side LED (LED 1) stays GREEN
Fully charged	Right-side LED (LED 2) turns solid GREEN

How to pair

Connect to a Bluetooth device

NOTE: Make sure to remove **BOTH** earbuds from case for first time use with a new mobile device.

First use >

1. Remove **BOTH** earbuds from the charging case. They will connect to each other, and within 10s one of the earbuds will enter pairing mode - its LED will flash **WHITE** and **RED** alternately.

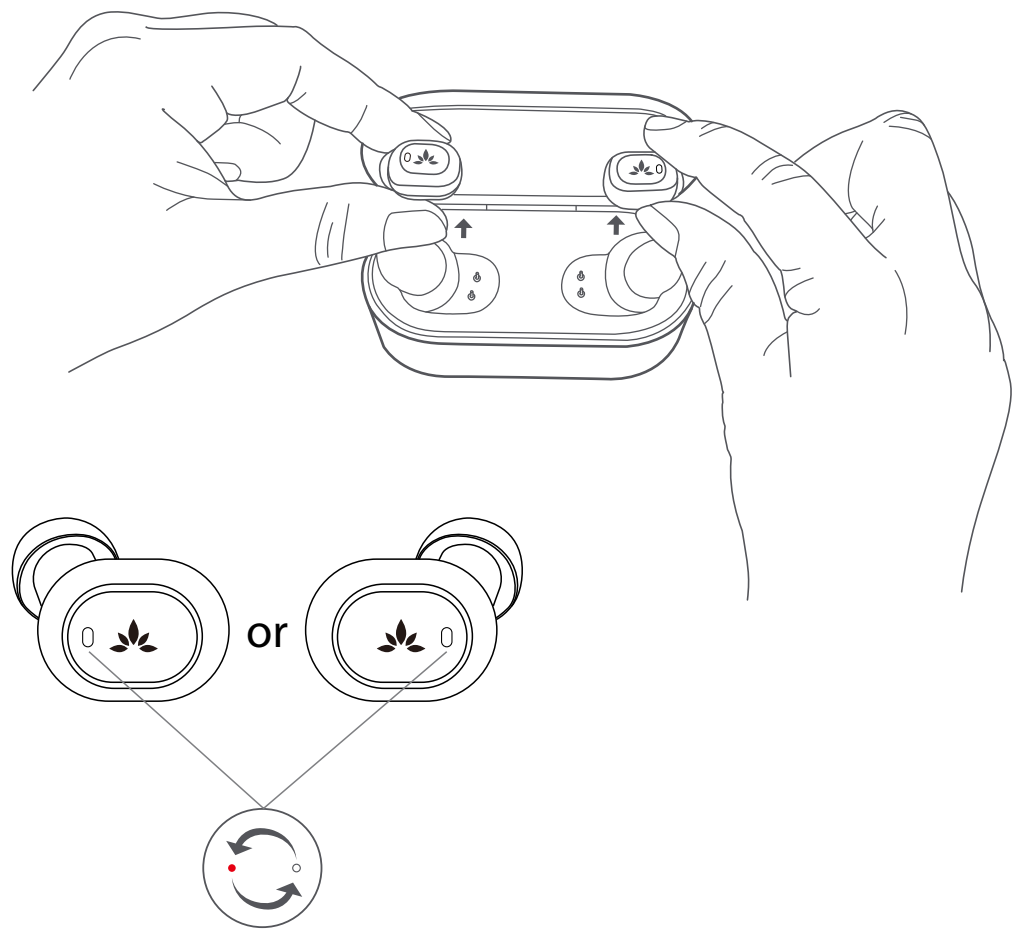

flash **WHITE** and **RED**

2. Activate Bluetooth on your device. Search and select “Avantree TWS115” to connect. All the LEDs will turn off once connected. Now you can stream audio.

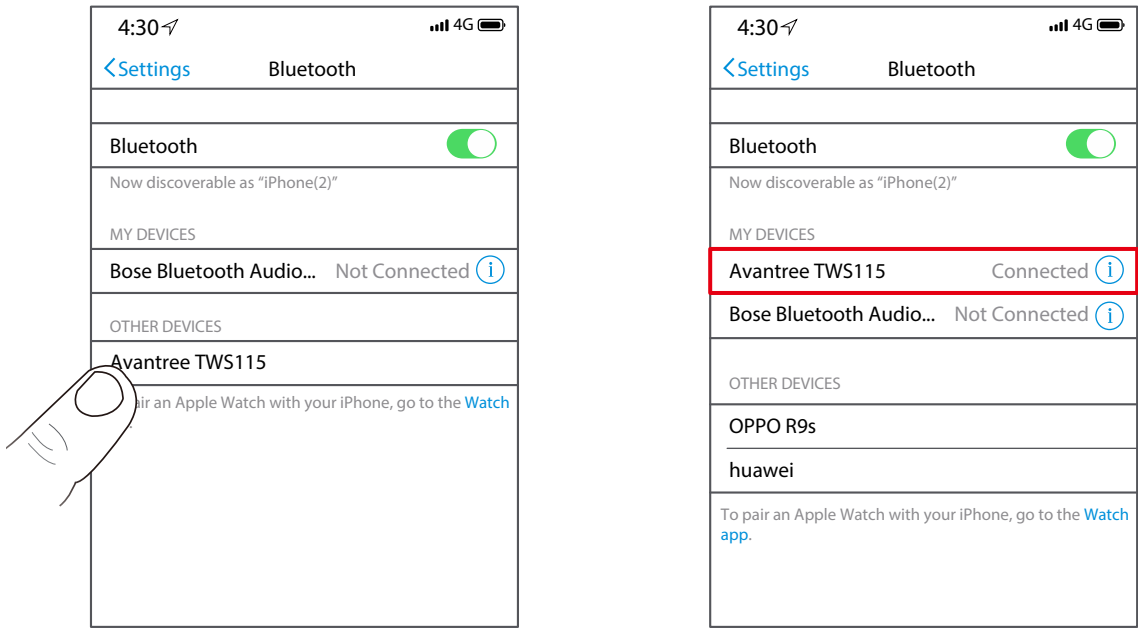

After first use (Reconnect), please >

1. Ensure the Bluetooth on your device is on.

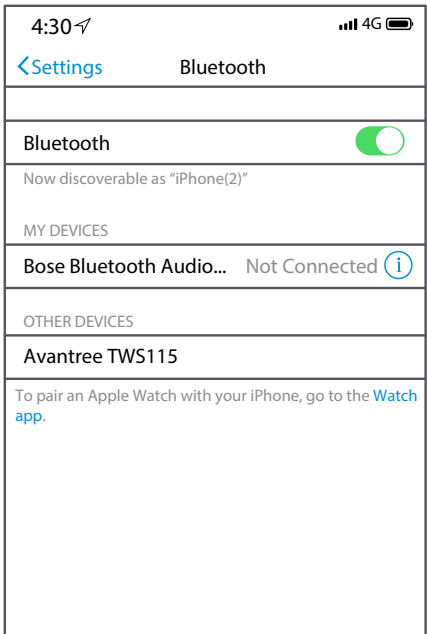

2. Remove BOTH earbuds from the charging case. Wait for 5~10 seconds, they will connect to the LAST PAIRED device.

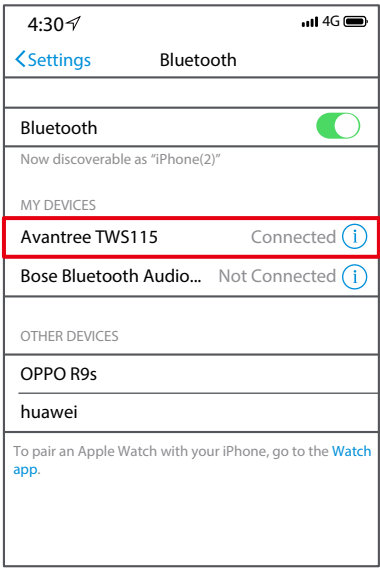
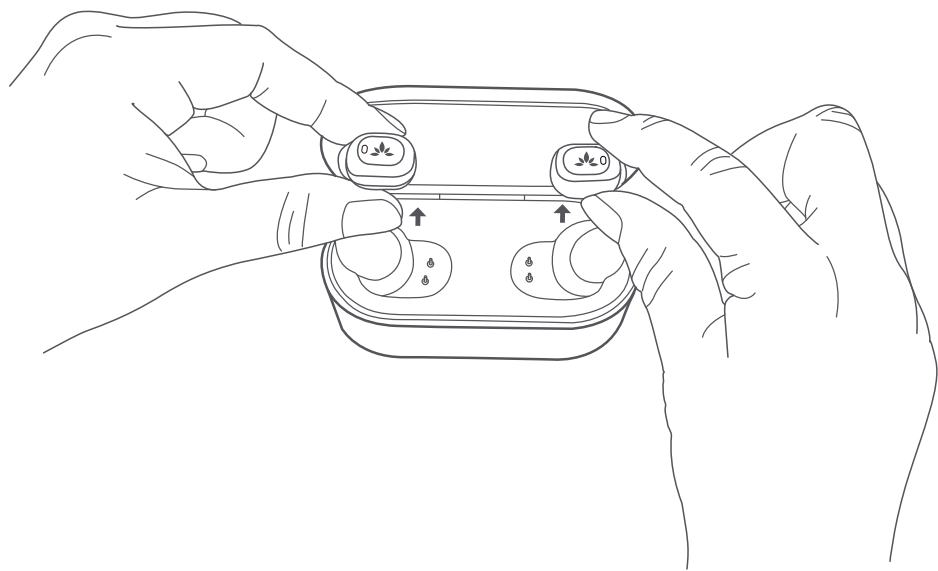

Note: If it fails to reconnect, please click “Avantree TWS115” on your device to manually connect.

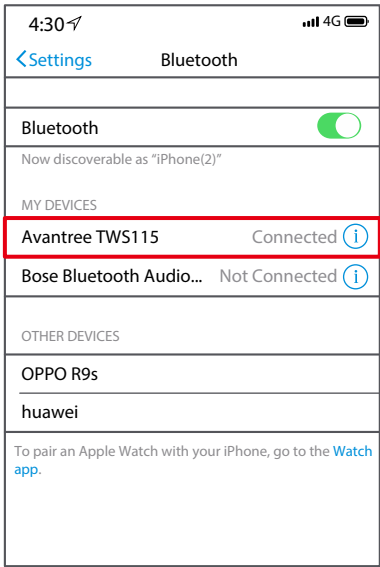
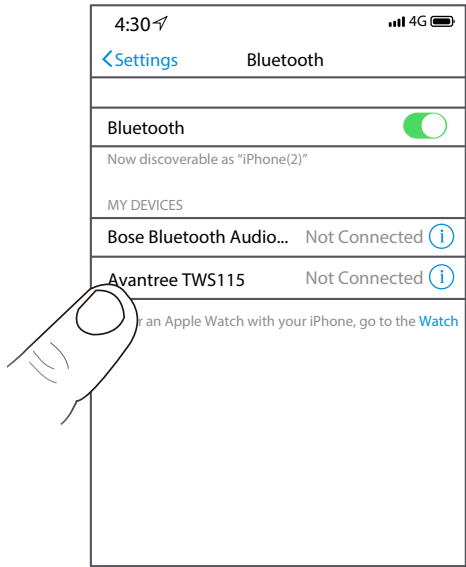

Connect to a NEW device>

1. Make sure the Bluetooth on previously connected device is off.

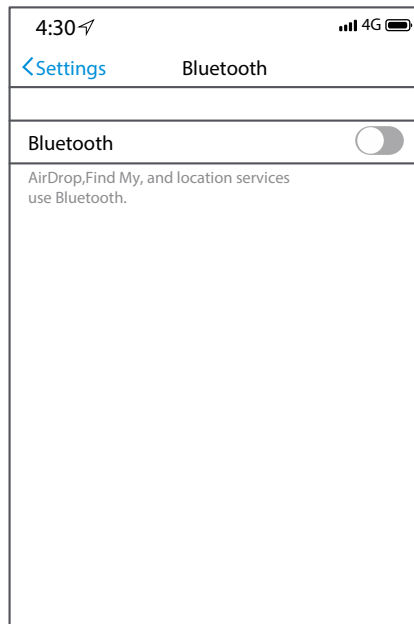
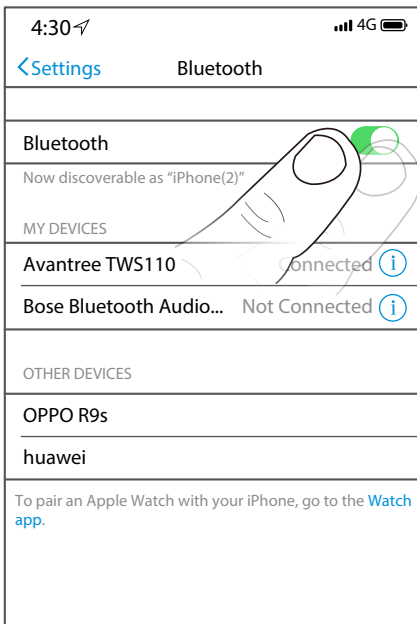

2. Follow the steps in the “First use” section to connect to a new device.

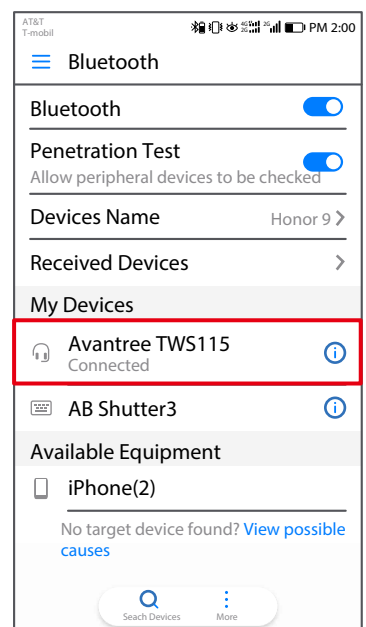
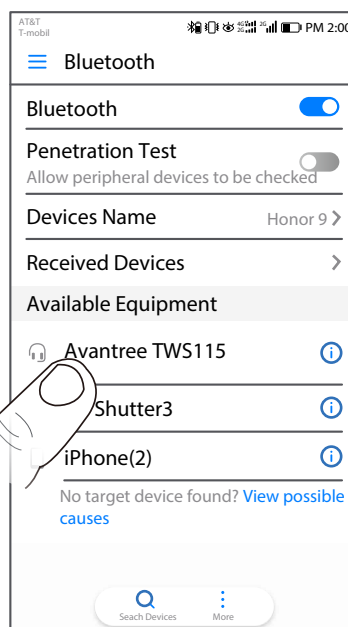
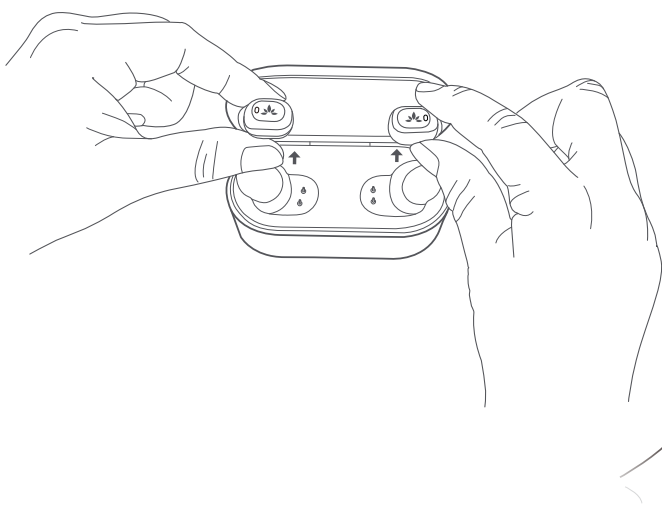

Mono earbud use >

Either side can be used separately as a mono earbud.

1. Make sure you have previously connected the earbuds with your phone as a TWS pair first.
2. Just remove the earbud you want from the case and it will automatically reconnect.

Note that button functions remain unchanged, so R earbud controls volume up and next track.

How to clear pairing history / reset

1. Put both earbuds back into the charging case. Make sure the earbuds are powered off and charging.

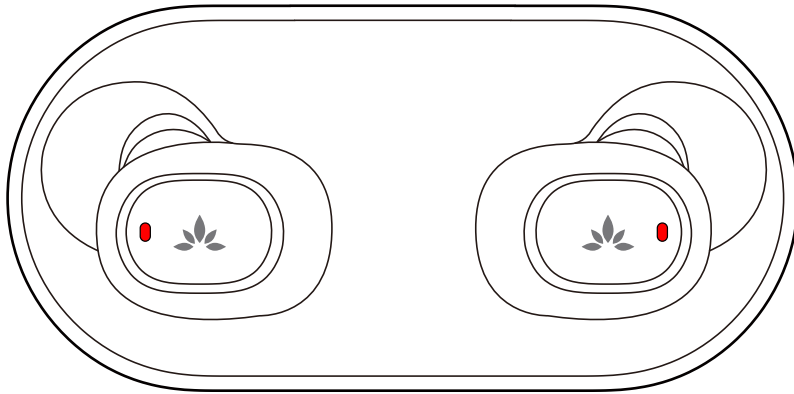

charging

2. Press and hold the Multi-function Button on both earbuds for about 15s, until the LEDs turn WHITE for about 2s. (You can also operate one by one.)

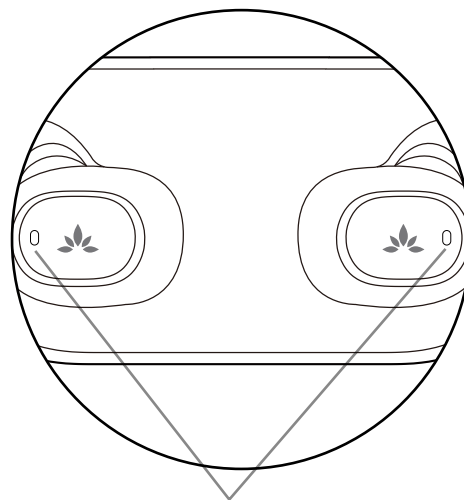
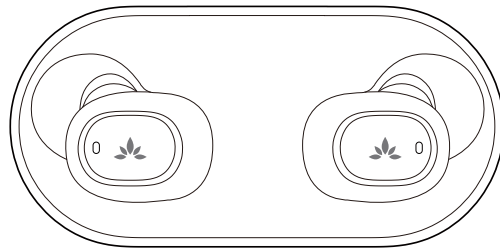
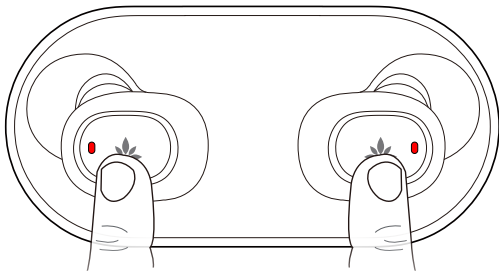

turn White for 2s

3. Both earbuds are now reset to their factory settings.

Note: In order to pair again with your phone please delete "Avantree TWS115" you're your phone's Bluetooth menu and refer to "First use" section.

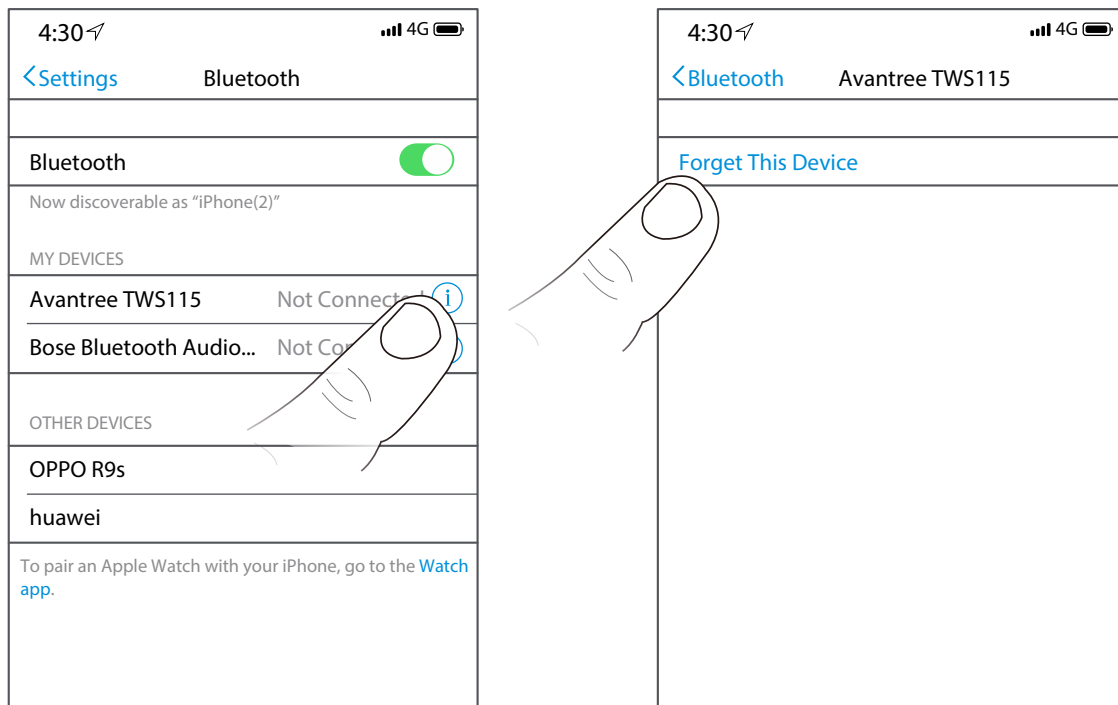

Support

FAQ

View the FAQs on support.avantree.com/TWS115

How to care for your earbuds

- Always store the earbuds in the charging case and make sure they are safely protected.
- If you would like to clean your earbuds, we recommend that you follow these instructions.
- The TWS115 is designed to function optimally between the temperatures of 0°C and 40°C (32-100°F.) Although it can and will function beyond this temperature range, performance may be impaired.
- Avoid storing the earbuds for extended periods of time without recharging them (max. three months.)
- The charging case is designed to charge using standard USB voltage (5v ± 0,25v). It is not recommended to charge this product using power supplies/sources with higher voltage.