

SVK

Experts in
fibre cement

 **PURO PLUS**

CONTENT

SVK fibre cement, on-trend since 1923	04-05
Facts & facades	06-07
1 Stability to last a lifetime	08-09
2 Intense power shield	10-11
3 Safety is hot	12-13
4 Pure and respectful	14-15
5 A healthy choice	16-17
6 Flexible simplicity	18-19
7 A perfect match	20-21
Puro Plus in action	22-33
Strong products, powerful support	34-35

 PURO PLUS

Created by SVK, in line with nature

SVK FIBRE CEMENT, ON TREND SINCE 1923

Proven reliability

It was on 8th August 1905 that Léon Scheerders and his wife Camilla van Kerchove established their business, called 'Pannen en Steenbakkerijen van Sint-Nicolaas'. Manufacturing and selling bricks, tiles, paving stones and pipes became their speciality and before they knew it, their business was booming.

In 1923, the family firm began producing products made from fibre cement. Corrugated sheeting, slates, pipes and even flower planter boxes all saw the light of day under the watchful eye of Léon and Camilla. When, just after the Second World War, the "Decora products" division of the company was set up, 'Pannen en Steenbakkerijen van Sint Nicolaas' truly began to resemble the SVK company that we have today. This division was responsible for the decorative finish of fibre cement façade panels, which remains one of SVK's specialities to this day.

Fibre cement is a mixture made from natural components. In the production process of fibre cement products, natural materials are used in a deliberate and responsible manner. SVK fibre cement products contain:

- **Cement (as the base)**
- **Cellulose fibres and PVA fibres (which provide the "reinforcement" and hence the strength of the panel)**
- **Fillers**
- **Water**
- **No sand***

All SVK fibre cement panels are still manufactured today using the traditional Hatschek process. This is a production method that can manufacture a product with the required thickness and properties by building up and pressing individual layers to create an ultra-stable, extra-strong and long-lasting end result. The thin, strong and very versatile material produced is perfect for applications such as outer wall or roof cladding.

The flagship of the SVK range of fibre cement panels is without doubt the **Puro Plus**. This product is the very essence of fibre cement board. Puro Plus façade panels come in natural grey and are available in two standard sizes. They also have a unique, lightly sanded surface that creates a natural, cloudy pattern. This is definitely SVK's star product!



”

Fibre cement is a mixture made up of natural components, cement, fillers and water.

”

* SVK no longer uses sand for the production of its Puro Plus façade panels. Which is a good thing, because the large-scale use of sand by the construction industry is severely affecting our planet's natural reserves of sand.

■ PURO PLUS Created by SVK, in line with nature

FACTS & FACADES



Puro Plus Natural façade panels are SVK fibre cement sheeting in its purest form. It is one of a kind, thanks to the unique sanding process that results in the typical cloudy Puro Plus pattern. This process means that every panel is different, which further reinforces its natural effect. The façade panel **patinates like natural stone**, gradually changing colour towards more intense shades of grey in the cloudy pattern under the influence of the weather. Puro Plus Natural façade panels are SVK fibre cement sheeting in its purest form. Lovers of natural stone and a natural, patinated look are attracted by the changing colours of the Natural façade panels. Puro Plus Natural façade panels are of incomparable quality. It has been an SVK classic for many years – and with good reason!

In this fact book, we reveal the unique properties of Puro Plus Natural through **7 important facts and characteristics**. Ready to become a Puro Plus specialist?

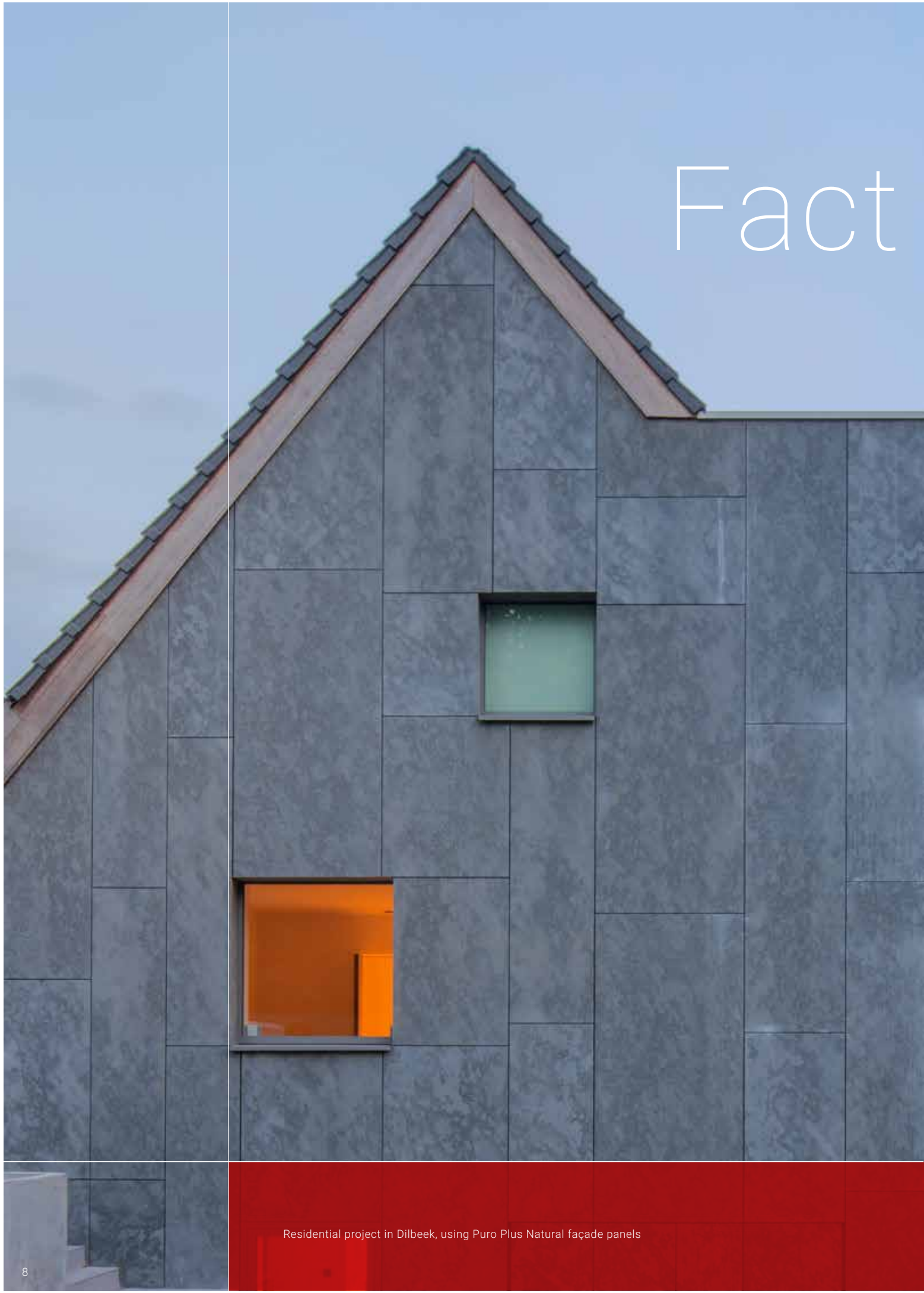

Fact /1

■ PURO PLUS Created by SVK, in line with nature

STABILITY TO LAST A LIFETIME

Air-dried & ultra-stable

SVK pays particular attention to the drying process used for its façade panels. In contrast to the trend towards accelerated production processes, SVK cherishes the very slowness of its drying process. Puro Plus façade panels are allowed a minimum of 28 days to dry naturally. This is the key to their exceptional quality, which is acknowledged by the market.

process ensures that the façade panels are fully dried, right to the core. As a result, **SVK achieves the highest drying percentages in the market.**

This is important, because too much moisture in a sheet adversely affects the strength and dimensional stability of the material. And as a result of this extra care, the risk of the boards becoming distorted is extremely limited.

Through continuous and extensive durability tests, the effects of moisture, frost, rain and sun are thoroughly tested on the Puro Plus façade panels. Under normal circumstances, a maximum loss of strength of 25% is allowed after durability testing, according to current testing standards. However, our façade panels have virtually **no loss of strength**. As a result, we are able to say that our façade panels are able to maintain the same high standards for many years. This is **the best guarantee for a long-lasting and durable outer wall.**



Puro Plus boards are air-dried and left for **4 weeks to harden under normal air conditions**. Immediately after pressing, the sheets are first dried for several hours in a maturation room at a temperature of 50°C. After that, they continue to dry in a normal storage area until their moisture content reaches approximately 12%. After that, they are given **additional time to dry until the moisture level comes down to a maximum of 5%**. This gradual drying

SVK pays particular attention to the drying process used for its façade panels

Residential project in Dilbeek, using Puro Plus Natural façade panels



Fact /2

■ PURO PLUS Created by SVK, in line with nature

INTENSE POWER SHIELD

Extremely high density

Following good SVK practice, Puro Plus façade panels are **doubled-pressed**, which results in **very high density**. This also makes them **exceptionally strong and stable**. All SVK façade panels also have a **strength classification of 5, which is the highest category for construction materials**.

And that's not just an empty promise! When they are being formed, the fibre cement boards undergo an initial pressing on a roller press, after which they are pressed for a second time on a stack press. This all done before the sheets are sent to the drying chamber (see Fact 1). The second pressing is done with 150 sheets at the same time, with metal inserts between the individual sheets. That way, their surface can be kept extra smooth.

The result is an **extremely high-density** board that outstrips competitive boards by around 170 kg per m3 (maximum 1600 kg per m3 for the average board on the market, versus a minimum of 1770 kg per m3 for SVK). And we're happy to protect that extra quality, because it means that each finished panel has a layer of **removable film** that can be taken off after installation. All of which helps to protect against possible damage when the panel is being placed!

Lab tests confirm the exceptional strength of the Puro Plus sheets





Private residence in Dilbeek

■ PURO PLUS Created by SVK, in line with nature

SAFETY IS HOT

SVK boards are among the safest solutions for outer walls in terms of fire safety



Safe and non-combustible

As you would expect, the safety standards that apply to façade panels are becoming tougher all the time. And safety is a top priority for SVK. **All fibre cement products in the SVK product range are in fire reaction class A2-s1, d0, according to European standard EN 13501-1.**

The fire reaction class is the classification that shows the extent to which a construction product contributes to a fire to which it is exposed. The fire reaction is the way the product behaves through its own decomposition to contribute to the fire.

All construction materials are divided into classes A to F. Classes A1 and A2 are awarded to materials that only contribute to the fire to a very limited extent in the most severe circumstances.

Class 's1' means that the smoke generated (with 's' standing for 'smoke') is very limited when exposed to fire. The production of burning droplets is expressed by 'd' for 'droplets', so 'd0' means that no burning droplets are produced.

The use of cement is one of the reasons why fibre cement has such a favourable fire reaction. You can avoid most risks by using non-combustible building materials (fire reaction classes A1 and A2) only for your outer wall cladding, roof cladding and insulation. **This makes SVK façade panels some of the best fire-safe solutions for outer wall cladding.**



Fact / 4

■ PURO PLUS Created by SVK, in line with nature

PURE & RESPECTFUL

With respect for the future

Surface water is used during the various production processes

Puro Plus façade panels are **produced from natural raw materials**, which makes them **100% ecological and asbestos-free**. In addition, both the air-curing process and the finishing of the boards are environmentally friendly. **The sanding dust and other product surpluses are collected and reused in the production of new boards.**

However, SVK also wants to find other ways of working on a production process that is environmentally aware.



To keep our carbon footprint as small as possible as a manufacturer, we are always looking for sustainable solutions. **For example, the surface water required during the production process is always reused and our facilities and**

lighting are both highly energy-efficient, which is totally in line with the energy pact that we have signed with the Flemish government with the aim of reducing our consumption of energy even more. We are also investing in spray-painting booths with double filtering in the ventilation system so that no components from the paint are able to find their way out into the environment.

But SVK's biggest contribution to the environment is the **durability of our products**. Fibre cement materials have a demonstrated long service life of at least 50 years. This period may even be much longer, but the material in its current formulation is still too young to provide examples that achieve periods longer than 50 years. That is why SVK is currently conducting additional research into the actual service life of the material. With this in mind, the possibilities for the material's circularity and reuse are also being optimised further.



Fact / 5

■ PURO PLUS Created by SVK, in line with nature

A HEALTHY CHOICE

Rot-resistant and maintenance free

Puro Plus façade panels have a **smooth surface that makes it difficult for dirt to attach to it**. This property also makes them particularly low-maintenance. All SVK façade panels are simple to clean using water and a neutral all-purpose cleaner. The composition of fibre cement also ensures that the sheeting **will never rot**. And the material itself is **resistant to living organisms, such as fungi, bacteria, insects and vermin**.

Another major factor that contributes to the health of users is the ventilated placement of SVK façade panels. This **ventilation** means that any moisture

from inside the cavity is easily removed and so internal condensation is prevented. A second benefit of ventilated installation is that the structure itself only heats up to a certain degree when the sun shines on it. A dark panel can heat up to over 60 °C in the sun. Ventilating the cavity prevents the underlying building materials from being exposed to such high temperatures.

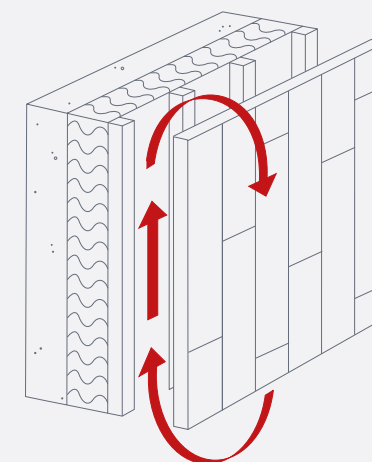

The ventilated placement of Puro Plus façade panels means that any moisture inside the cavity is quickly removed and internal condensation is avoided.

Retail premises with apartments in Asse



Fact / 6

■ PURO PLUS Created by SVK, in line with nature

FLEXIBLE SIMPLICITY

Choose your method of attachment

SVK offers a **range of methods for attaching the façade panels in a durable, long-term manner**. With the same thickness of panel, both visible and invisible fixings are possible. You choose according to the result you want – which is unique.

Each technique has its own specific advantages. For example, using **adhesive** creates a sleek, luxurious appearance and its high elasticity means that it is able to accommodate vibrations better. This technique is also notable for the continuous line bonding of the material and guarantee of a perfect bonding system suited to each of our façade panels. The biggest advantage of **screws** is that the panels are easy to dismantle in full and with screw caps in the same colour as the façade panel, they are virtually invisible. For an extra-fast result, using **rivets** is an option. This is a quicker technique than ordinary screws and here again, the blind rivets are the same colour as the façade panel. A fourth option in **blind mechanical fixing**. The exceptional strength of Puro Plus means that this can be done already with panels 8 mm thick. This method also creates a sleek and luxurious look and the system can be dismantled in full. These last three fixing methods can also be carried out in all weather conditions.



ADHESIVE



SCREWS

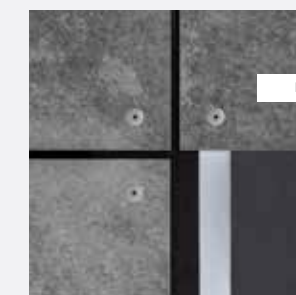

RIVETS



BLIND MECHANICAL FIXING



However, for all these methods, one rule applies: when handling and installing Puro Plus Natural panels, you must wear gloves. Because Puro Plus Natural has no coating, the panels can absorb dirt and oil from your hands, which could result in stains. By wearing gloves during installation, you remove this risk and you also don't impede the natural patination process. Forewarned is forearmed...

Private residence on the waterside in Amsterdam

Fact / 7

■ PURO PLUS Created by SVK, in line with nature

A PERFECT MATCH

Maximum creative expression

All SVK façade panels offer **maximum creative expression for the outer skin** of a building. They provide a **timeless** alternative and **combine effortlessly with other materials**. They also create scope for endless design possibilities and architectural austerity, such as concealing windows and doors behind façade panels attached with adhesive.

Puro Plus panels in particular come beautifully into their own **when combined with other natural materials**, such as **wood** and **SVK roof and façade tiles**. The natural look and sheer honesty of the material enhance the authenticity and durability of every structure.

Fibre cement panels are also a great idea for **renovation** projects. And because of the suspended mounting system used, no groundworks are required. Installation is flexible and straightforward – and **the possibilities are endless**. For example, the panels can be drilled at any point to create an eye-catching visual effect. Yet the same material can also be used to produce letterboxes or to cut out house numbers. With Puro Plus sheeting, you can really go to town, architecturally speaking.

Puro Plus panels combine really well with other natural materials



PURO PLUS IN ACTION

Puro Plus Natural façade panels from SVK have already demonstrated what they are capable of. Not only us, but also architects, contractors and installers are unanimous in their enthusiasm for Puro Plus. Read what they have to say here and who knows, maybe you will soon be joining the fast-growing club of satisfied Puro Plus customers. We simply can't wait!

■ PURO PLUS In action

Interaction between architecture
and occupant

Private residence on the
waterside in Amsterdam
(TailorD in conjunction with
MVK Architects)

The architectonic design of this private dwelling at the port of Amsterdam is a straight concrete box that opens up to the garden and the waterside. This fully transparent side allows the inside to flow seamlessly to the outside. And when the weather is fine, a large section of the façade opens up to the water.

“The people building the house were very much involved in the design process,” recalls Evelien Rodenburg from TailorD Architecture. “Together we chose various architectural styles that appealed to them and that’s what I went to work with. Their imagination showed that they liked simple façade materials that came together in a very abstract way. I was able to translate that into minimal transitions and light lines that cut through the façade in a Mondrianesque interplay of lines and concealed sun blinds.”

“The personality of the occupants is reflected in the façade”

As a result, Evelien Rodenburg went looking for a façade panel with a concrete look to give the house a robust, solid impression. “The façade of a house needs to reflect the personality of the people who live there, which makes the choice of materials so important. For these particular people, a high level of finish, clean lines and minimalistic detailing was a must. Which is why our gaze soon fell on the Puro Plus Natural fibre cement panel.

This is a beautiful board that offers so many options when it comes to attaching and sawing the panels.” The fact that the Puro Plus Natural panel has a different appearance under the effect of the weather was also an important element for the architect. “This variety gives the façade a natural, living look. And with an abstract façade design like this one, you need to inject a little life!” She also cites the striking resemblance to concrete or natural stone at a fraction of the price as an additional advantage.

“The Puro Plus Natural panels are also made through and through with the same material, which means you can create beautiful details at the outer corners,” adds Evelien Rodenburg. “This works particularly well, because the panels are very light and so can be attached with adhesive to a rear structure. This technique can also be applied to rotating parts, such as doors.” The clients’ dream of building a unique home has definitely come true and their house stands out from the rest in a row of uninspiring brick facades in the street. Evelien Rodenburg is also happy. “I’d like to work with Puro Plus on another project in the future, although I am not an architect who imposes the choice of materials on clients,” she clarifies. “This method of working helps the quality of the project

and keeps all parties satisfied. Of course, I will make adjustments, but these kinds of choices cannot be forced. In any case, not every building lends itself to every kind of material,” adds the architect. “But when a design is suited to it, I will certainly work with Puro Plus again, you can be sure of that!”



This renovated private home in Dilbeek makes the ultimate connection between nature and Puro Plus. It was architect Kati Lamens who undertook extensive work to this 1950s structure.

“Not only did the original dwelling not work in terms of energy, which was only to be expected given its age, but the internal layout was also uninspiring. But it was the plot itself that attracted the client, who was an acquaintance of mine.” And it has to be said that the sloping garden, with a difference in level of a full storey, is indeed very charming. All the more so when you look at the lovely wooded surroundings.

“The lively look of Puro Plus enters into dialogue with its environment”

“Our first task was to find a way of bringing the attractive setting into dialogue with contemporary living quality,” recounts Kati Lamens. “The only way of doing that was to strip the whole building back to its basic shell. This was the only way we could properly isolate and change the internal layout.” All of which made it virtually a new house, although the basic shape of the original structure was retained. “Keeping the basic morphology of a building is not always as obvious as it might seem. Clients usually want to add new volumes on to the building and create an immediate extension to the home. But I like to look at the original volume of the house first and determine whether we can accommodate all of the required functions organically into the existing

■ PURO PLUS In action



An unexpected volume on a sloping plot



volume.” In this particular case, it turned out to be possible, with only and old veranda being demolished and replaced by a similar new volume.

“Fortunately, the client gave me all the freedom I wanted with the design,” smiles the architect. “Also, when it came to the materials for the façade, there were many options, just so long as the end result was what the client wanted. We first considered rendering for the frontage. However, given the wooded surroundings in which the home was situated, I advised against that for the higher sections of the house. In the end, we only rendered the part of the home up to a height of one storey to make maintenance a good deal less difficult.” Much more straightforward to maintain are sheeting materials, such as the SVK fibre cement panels that Kati Lamens opted for in the end for the rest of the house. “Panels have lots of advantages – ease of maintenance and installation to name but two,” she says. “And Puro Plus panels also have a major visual benefit to offer, because they look very much like concrete. The cloudy structure and warm look of Puro Plus is very different from more traditional, evenly coloured panels and that’s what swayed us for this project.”

“Great collaboration, right down the line”

And it doesn’t stop there. “We have always had good contacts with SVK and when it comes to technical support, there’s very little they don’t know. They gave us an immediate answer to all our questions and a representative from the company even came on-site to supervise the installation.” A good installer who Kati Lamens had worked with frequently before did the rest.

“The house is an unusual volume and we also wanted to create an irregular interplay without too much cutting waste. It was no easy task, but thanks to the smooth collaboration with both Apers & Partners and SVK, everything came out well.”

The architect is always inclined to opt for a sober design, which is why she works regularly with sheeting materials such as Puro Plus from SVK. And she’ll continue to do so in the future, too. “If I could choose, I’d finish all of my facades in fibre cement panels,” she laughs. “It’s also a logical consideration when it comes to fire safety and that plays an important role, especially in the construction of public buildings,” adds Kati Lamens. She also emphasises her satisfaction with the material when it comes to private homes. “My experience with Puro Plus and SVK is totally positive, so I’ll be happy to work with them again on future projects.”



Renovation project for the CSGP office building in Charleroi (Installation company: Rose NV.)

The CGSP building (General Headquarters for Public Services) in Charleroi was renovated in 2020. The installation company, Rose from Hanzinelle, handled the frontage, using Puro Plus Natural façade panels from SVK.

In all, the frontage of the CGSP building covers 500 square metres. This was the first time that Rose NV from Hanzinelle had opted to use fibre cement sheeting from the SVK range. The natural look of the panels and the ease of cutting the material made the company's decision an easy one.

"The advice given by SVK was worth its weight in gold"

For David Rose of Rose NV, installing fibre cement façade cladding was nothing new. "I think it is very important to follow the manufacturer's installation instructions to the letter. Experience has taught me that only when you do that can a beautiful result be guaranteed. The secret of a good result is often in the details, such as using the right fixing method for the right project. For example, for this renovation, we decided to use adhesive to attach the panels. However, there



are a lot of factors to take into consideration when it comes to gluing a façade panel in place correctly. SVK's extra advice about using adhesive to attach the panels certainly came in handy."

However, the biggest challenge of this project was not how to attach the Puro Plus Natural panels, but getting the base structure right. "The base structure protrudes 450 mm from the façade, which required a lot of extra work but the result is impressive," concludes David, happily.



"The natural look and trouble-free way the material can be cut made opting for Puro Plus Natural self-evident."



An office building that stimulates all the senses



Nature and architecture in dialogue

Cavo Zoe Sea
Side Hotel in Cyprus
(C+ Studio Architects)

The renovation of the Cavo Zoe Sea Side Hotel in Cyprus is a great example of Puro Plus Natural being used as a material that communicated with nature.

"The philosophy behind this conversion is that the façade of the building blends in totally with its surroundings, says architect Christos Paraskeva from C+ Studio Architects. "In Cyprus, those surroundings are mainly rocks and Puro Plus Natural is ideally suited to the task." The texture and colour palette of the Puro Plus Natural panels enters into dialogue with the environment in just the way you want. "We would not have been able to achieve the same effect with a different material," he continues. "Puro Plus Natural has the appearance of rock or concrete, but is much easier to use and maintain – plus it is a good deal less expensive financially speaking than these other options."

The fact that Puro Plus panels are also easy to install also played a role in the choice of cladding to be used for the façade. "When you only have 3 to 4 months to do a thorough renovation, that kind of feature is inestimable," explains the architect. "The hotel had to be ready to receive guests from the beginning of the tourist season. Also, add the ability to install Puro Plus invisibly on a freestanding substructure and you begin to understand our enthusiasm for it! Having a tight

■ PURO PLUS In action

time schedule meant we could not allow ourselves to have any problems of the kind that tend to crop up on a renovation project, such as unexpectedly slanting outer walls or unsuitable materials for fixing the panels in place. But the method of mechanical fixing on a separate structure meant that we could be sure of not having any unpleasant surprises."

"Having the project complete in barely 4 months was a real tour-de-force!"

"Everything went entirely to plan and also on schedule. Which is not always as straightforward as it may sound," added Christos Paraskeva: "With an in-depth renovation like the one at the Cavo Zoe Sea Side Hotel, delays are not unusual." Not only was the hotel given a new façade, but it was also totally rebranded, from a budget hotel to a five-star boutique hotel. "Achieving something like that in barely 4 months was a real tour-de-force," recounts the architect with some pride. "We created a link between two separate sections of the original hotel, playing with the different heights on the façade." Fortunately, Puro Plus Natural lends itself very well to a bit of creativity. "Because the material is so light and easy to saw, we were able to be very creative with it. For instance, we incorporated lighting strips into the frontage to reflect the way the sun and water play on the rocks in the evening."

And all that was possible because the new owners of the Cavo Zoe Sea Side Hotel gave C+ Studio Architects all the creative freedom they needed. "The owners are Chinese and for this project in Cyprus, they placed total faith in our Cypriot architects. Their only condition was the amount of time we had and to requirement to produce a luxury finish. 'Make it the best' is all that they told us to do," laughs the architect. And anyone who looks at the photos of the hotel can see that Christos Paraskeva and his team did indeed 'make it the best'.



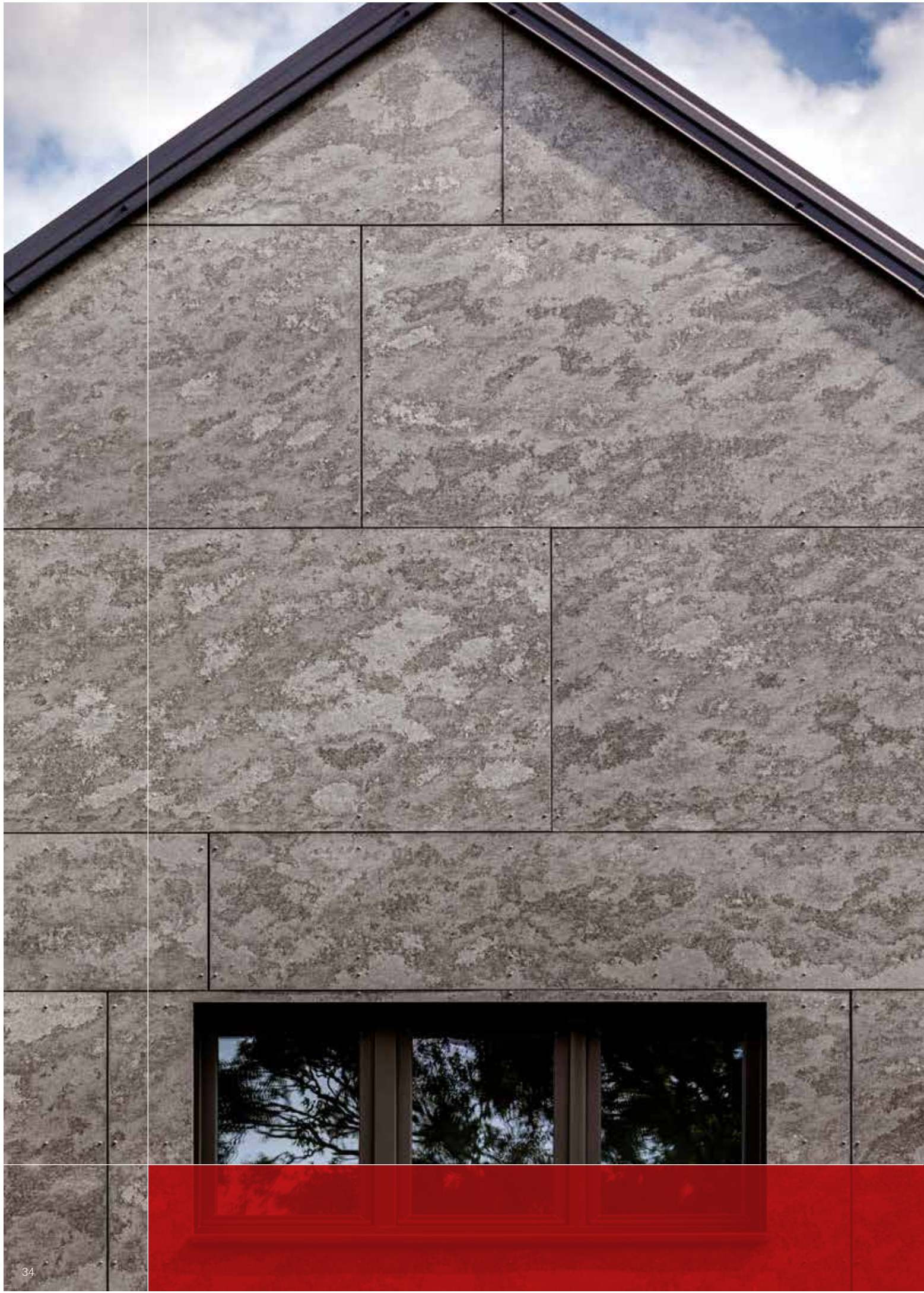

■ PURO PLUS In action

STRONG PRODUCTS, POWERFUL SUPPORT

SVK working on your behalf

Strong products deserve great service. That's why SVK likes to pamper you. From samples, technical information and how-to videos, to installation clips, production videos and interviews, we have thought of everything.

Scan the QR code below and watch all our videos now. Learn about the placement and capabilities of our Puro Plus Natural façade panels and enjoy the simplicity and authenticity of Puro Plus.



If you have any specific questions about issues you can't find an immediate answer to, then please contact our technical team. Their advice is obligation-free and they will be happy to talk to you about the specifications, installation and use of colour of our products.



www.svk.global
info@svk.be
+32 3 760 49 00