

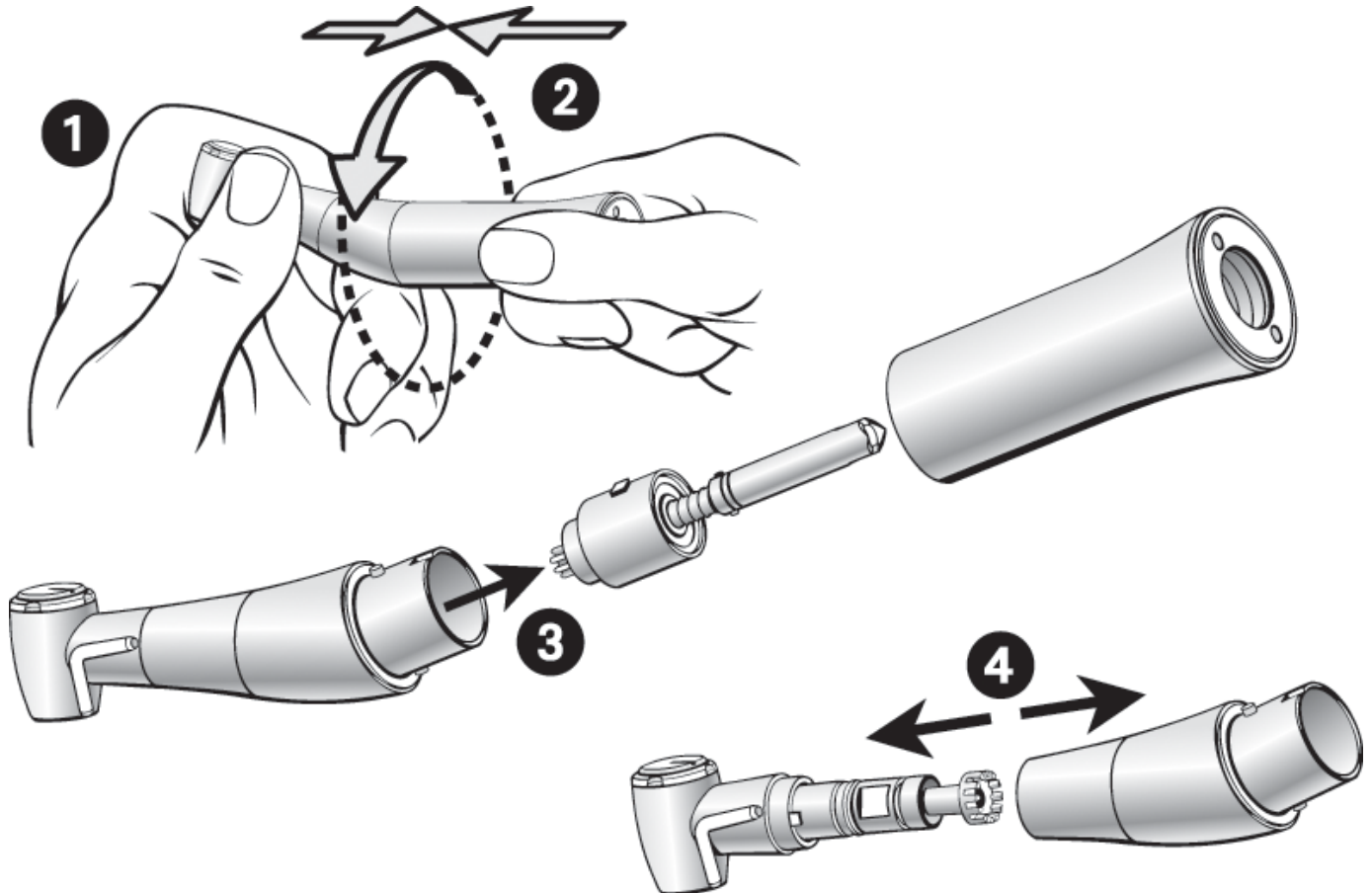

## Disassembly of surgical instruments WS-75 E/KM (Mk I), WS-56 E & WS-92 E/3

- Follow local guidelines regarding protective clothing and eyewear
- Clean instrument immediately after every surgical application
- These instructions are to be used in conjunction with our information sheet “Hygienic Maintenance & Sterilization Instructions” (Ref: UK/HHMSI/1109/5L)
- Remove the rotary implement
- Remove the instrument from the motor



1. For instrument type WS-75 E/KM only, remove the internal irrigation spray tube from the head of the handpiece.
2. Grip the front section of the instrument, whilst twisting & pulling rear section in the direction of the arrows to remove (bayonet fitting).
3. Remove rear drive dog section.
4. Holding the mid section in one hand and the front section in the other, pull to remove in the direction of the arrows.
5. Remove any debris with a soft brush under running water.
6. Check general condition of the instrument.

When disassembled, the WS-56 E and WS-92 E/3 should have 4 individual parts: back, middle and front body sections and rear drive dog. The WS-75 E/KM (Mk I) also has the internal irrigation spray supply tube, so will consist of 5 individual parts.



## Reassembly of surgical instruments WS-75 E/KM (Mk I), WS-56 E & WS-92 E/3

- Follow local guidelines regarding protective clothing and eyewear.
- Following disinfection, cleaning, and reassembly, the instrument is ready for lubrication and sterilization. Use these instructions in conjunction with our information sheet "Hygienic Maintenance & Sterilization Instructions" (Ref: UK/HHMSI/1109/5L).

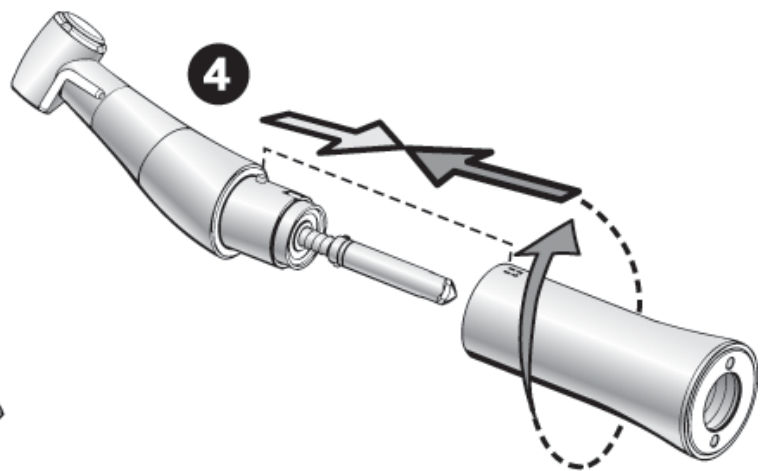
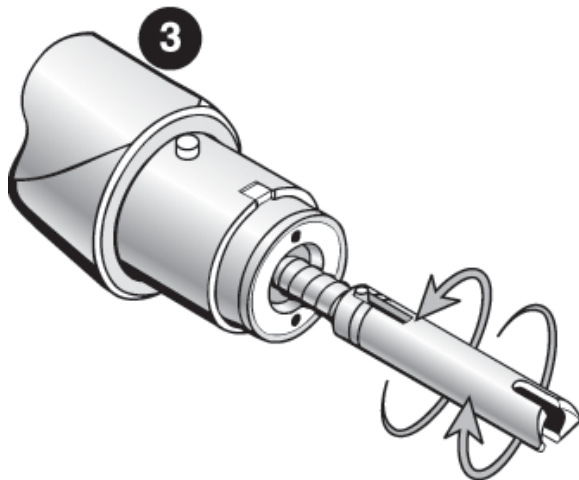
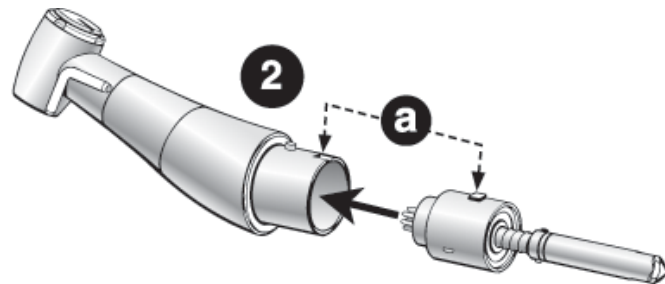
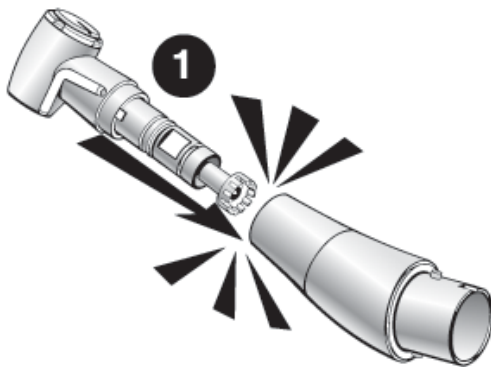

**Before reassembly, ensure that all parts have identical serial numbers.**

1. Holding the mid section, insert the front section until it clicks into place. Note that the head of the instrument can be positioned in 4 different locations.
2. Push the rear drive dog section into the mid section.  
For instrument type WS-75 E/KM (Mk I), ensure that the locating lug is aligned with the corresponding slot (a).
3. Check that the drive dog rotates freely.
4. Holding the mid section, push & twist the rear section as indicated (bayonet fitting).
5. For instrument type WS-75 E/KM (Mk I), insert the internal irrigation spray supply tube, which clicks into place.