



## Property Highlights

- Last vacancy: 1,408 SF
- Attractive, contemporary architecture
- Well established neighborhood serving Glendale & Peoria

## Intersection / Area Co-Tenants



## Contact

**JASON FESSINGER** ..... 602.368.1090  
[jfessinger@w-retail.com](mailto:jfessinger@w-retail.com)

**KALEN RICKARD** ..... 602.931.4492  
[krickard@w-retail.com](mailto:krickard@w-retail.com)

**JAKE MCCLAUGHRY** ..... 602.368.1088  
[jmclaughry@w-retail.com](mailto:jmclaughry@w-retail.com)

**JULIE GREEN** ..... 602.710.1786  
[jgreen@w-retail.com](mailto:jgreen@w-retail.com)





**WESTERN**  
RETAIL ADVISORS

# Plaza 59

Northwest Corner Peoria Avenue & 59th Avenue | Glendale, Arizona

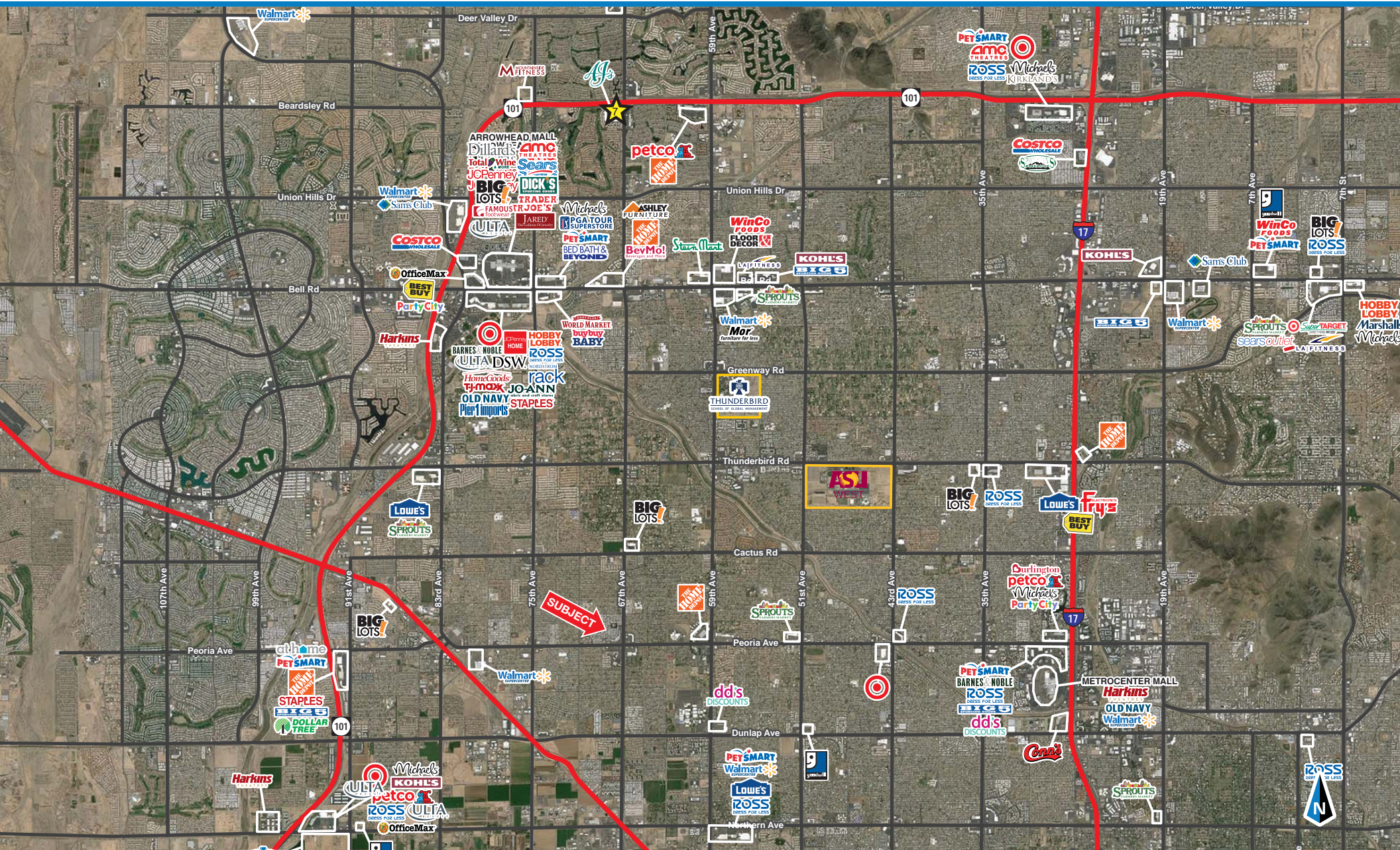

**WESTERN RETAIL ADVISORS**  
2555 E Camelback Rd, Ste 200, Phoenix, AZ 85016

The information contained within this brochure has been obtained from sources other than Western Retail Advisors, LLC. Western Retail Advisors has not verified such information and makes no guarantee, warranty or representation about such information. It is your responsibility to independently confirm its accuracy and completeness. Any dimensions, specifications, floor plans and information may not be accurate and should be verified by you prior to the lease or purchase of the property.





**WESTERN**  
RETAIL ADVISORS

# Plaza 59

Northwest Corner Peoria Avenue & 59th Avenue | Glendale, Arizona

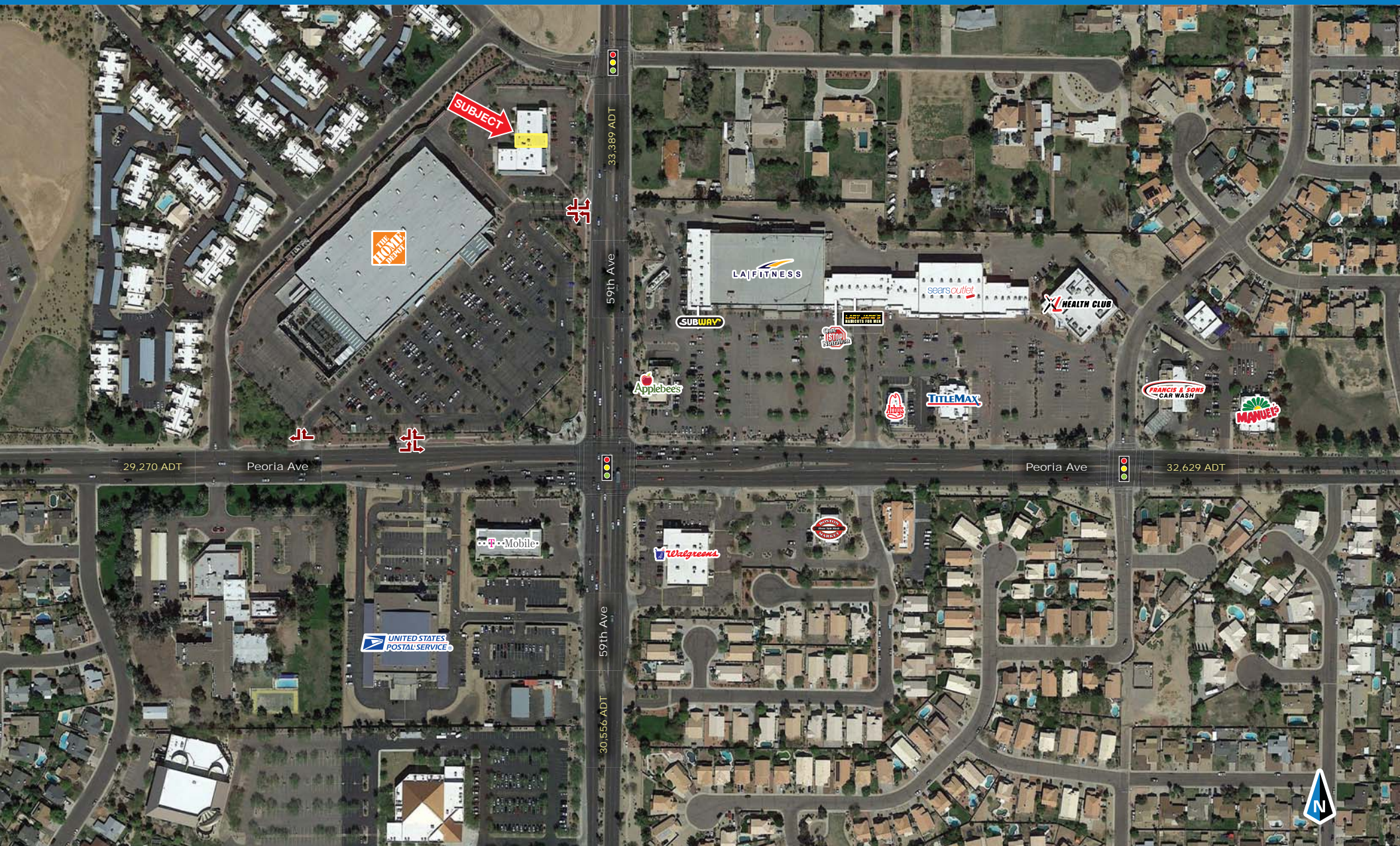

**WESTERN RETAIL ADVISORS**  
2555 E Camelback Rd, Ste 200, Phoenix, AZ 85016

The information contained within this brochure has been obtained from sources other than Western Retail Advisors, LLC. Western Retail Advisors has not verified such information and makes no guarantee warranty or representation about such information. It is your responsibility to independently confirm its accuracy and completeness. Any dimensions, specifications, floor plans and information may not be accurate and should be verified by you prior to the lease or purchase of the property.





SHOP	TENANT	SF
101	FAMILY DENTAL	2,500
102	STATE FARM	1,409
103-4	NAILS BY ANDY	1,405
105	AVAILABLE	1,408
106	KARMA TATTOO	2,500
107	PET GROOMER	
108	BARBER	1,279

	1 miles	3 miles	5 miles
<b>POPULATION SUMMARY</b>			
2018 Total Population	17,346	154,160	429,587
2023 Total Population	18,053	162,362	456,254
2018-2023 Annual Growth Rate	0.80%	1.04%	1.21%
2018 Median Age	38.2	36.3	34.4
<b>INCOME SUMMARY</b>			
Median Household Income	\$59,711	\$54,824	\$50,567
Average Household Income	\$73,437	\$68,030	\$63,358
<b>BUSINESS DATA</b>			
Total Businesses:	267	3,145	11,221
Total Employees:	2,759	40,874	145,667
Daytime Population:	11,000	120,597	376,367
<b>POPULATION 25+ BY EDUCATIONAL ATTAINMENT</b>			
Associate Degree	10.6%	9.1%	8.5%
Bachelor's Degree	16.1%	13.8%	13.3%
Graduate/Professional Degree	8.1%	6.7%	6.3%
Percent of Population with Degrees	34.8%	29.6%	28.1%
<b>EMPLOYED POPULATION 16+ BY OCCUPATION</b>			
Total	9,104	74,436	198,885
White Collar	65.8%	58.2%	55.8%
Services	15.7%	18.1%	20.7%
Blue Collar	18.5%	23.7%	23.4%
<b>HOUSEHOLD SUMMARY</b>			
2018 Households	6,058	55,257	151,632
2018 Average Household Size	2.83	2.75	2.80
2018 Average Family Size	3.25	3.30	3.42
2018 Median Home Value	\$185,410	\$180,478	\$174,431