

Schaal 1 : 200

■ = Gemeenschappelijk

Tekening bestaat uit 14 bladen

Blad 1



kelder

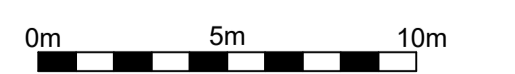

Schaal 1 : 200

■ = Gemeenschappelijk

Tekening bestaat uit 14 bladen

Blad 2

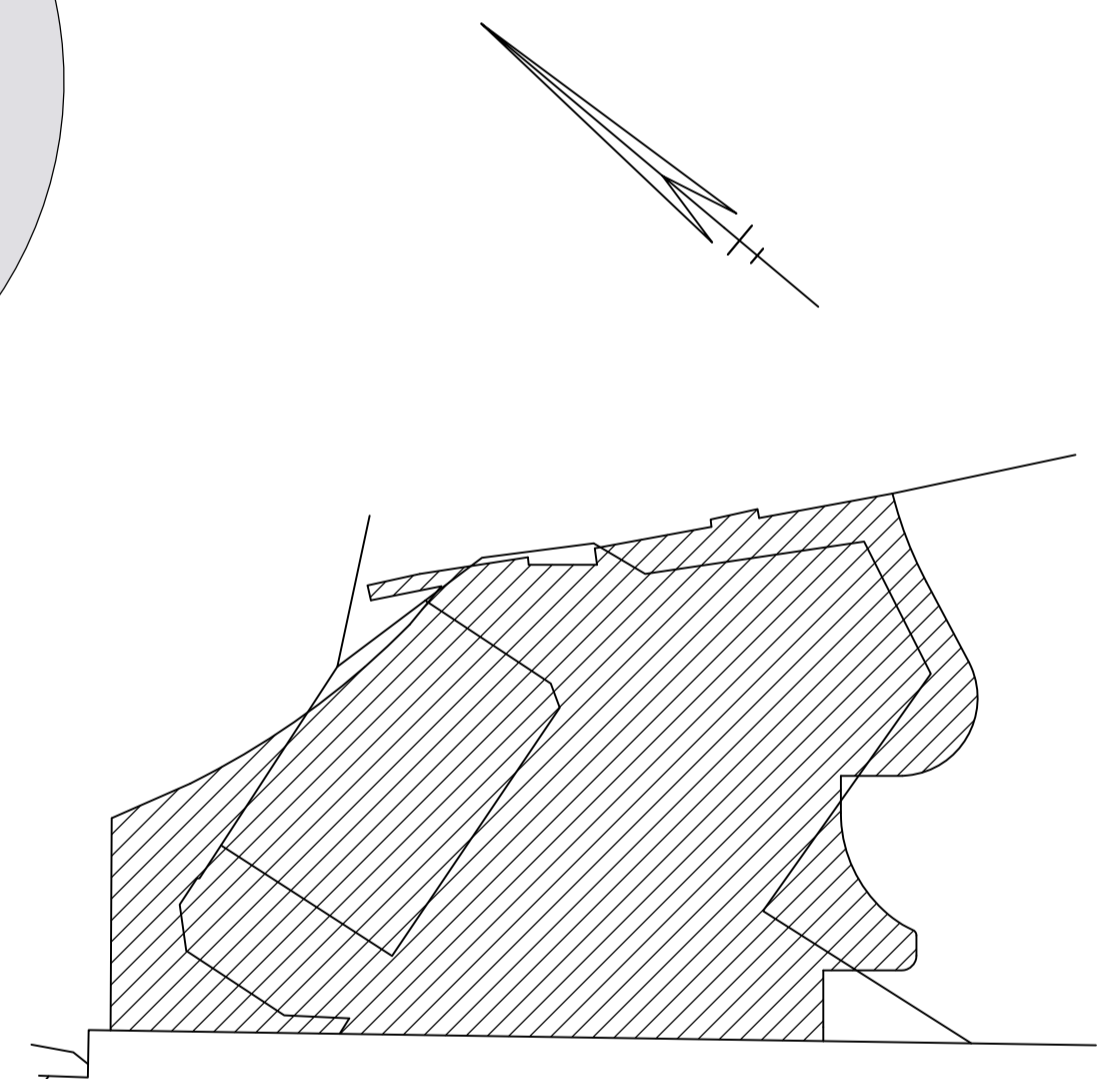
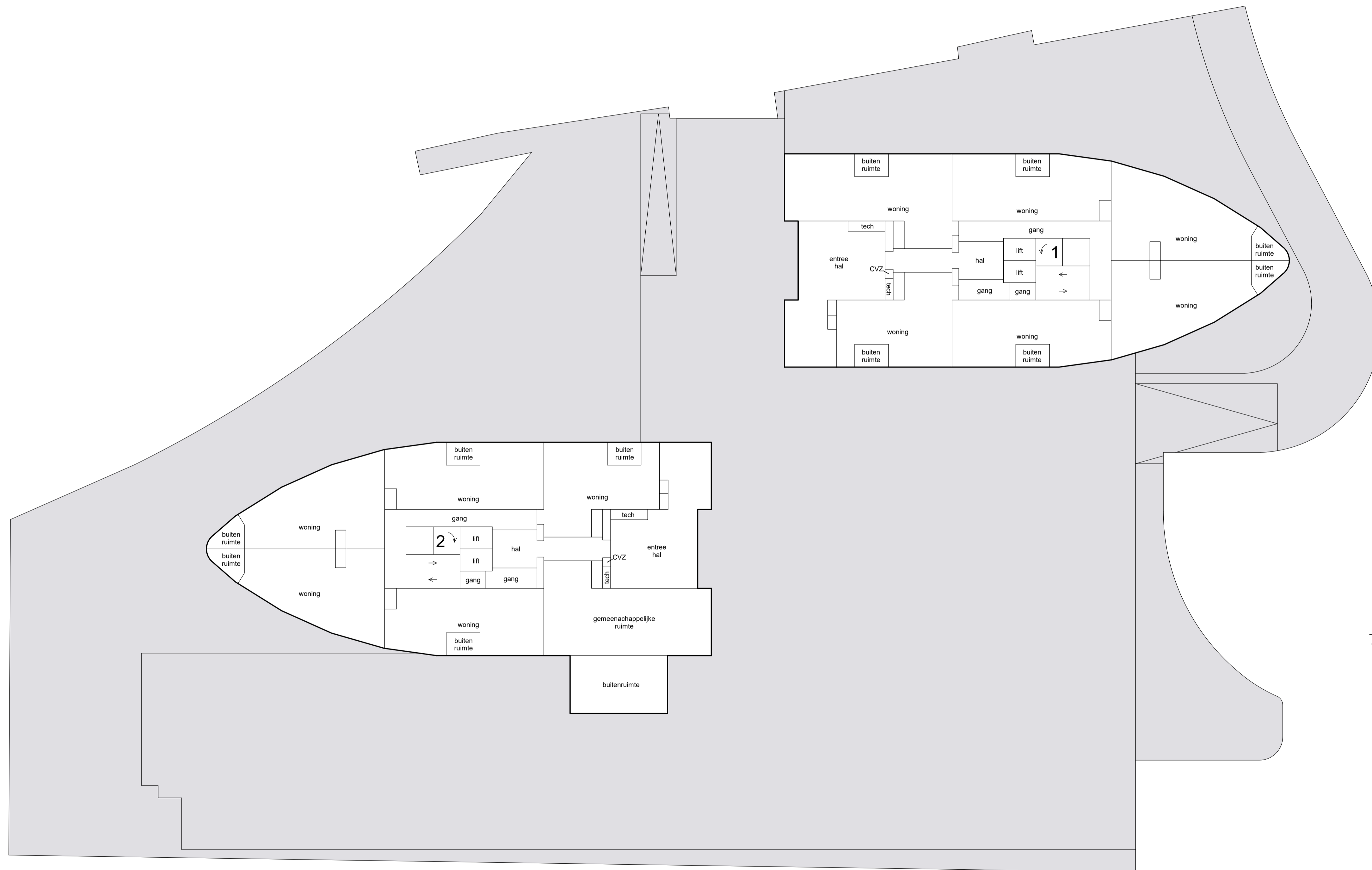

Situatie 1 : 1000 Woensel G 8884, 8886, 8887, 8889, 8890, 8895

begane grond

0m 5m 10m

Complex Sierlijke Dames in Eindhoven
versie 12 juni 2026

Voorgenomen splitsing in appartementsrechten van de kadastrale percelen: Woensel G 8884, 8886, 8887, 8889, 8890 en 8895

Schaal 1 : 200

■ = Gemeenschappelijk

Tekening bestaat uit 14 bladen

Blad 3

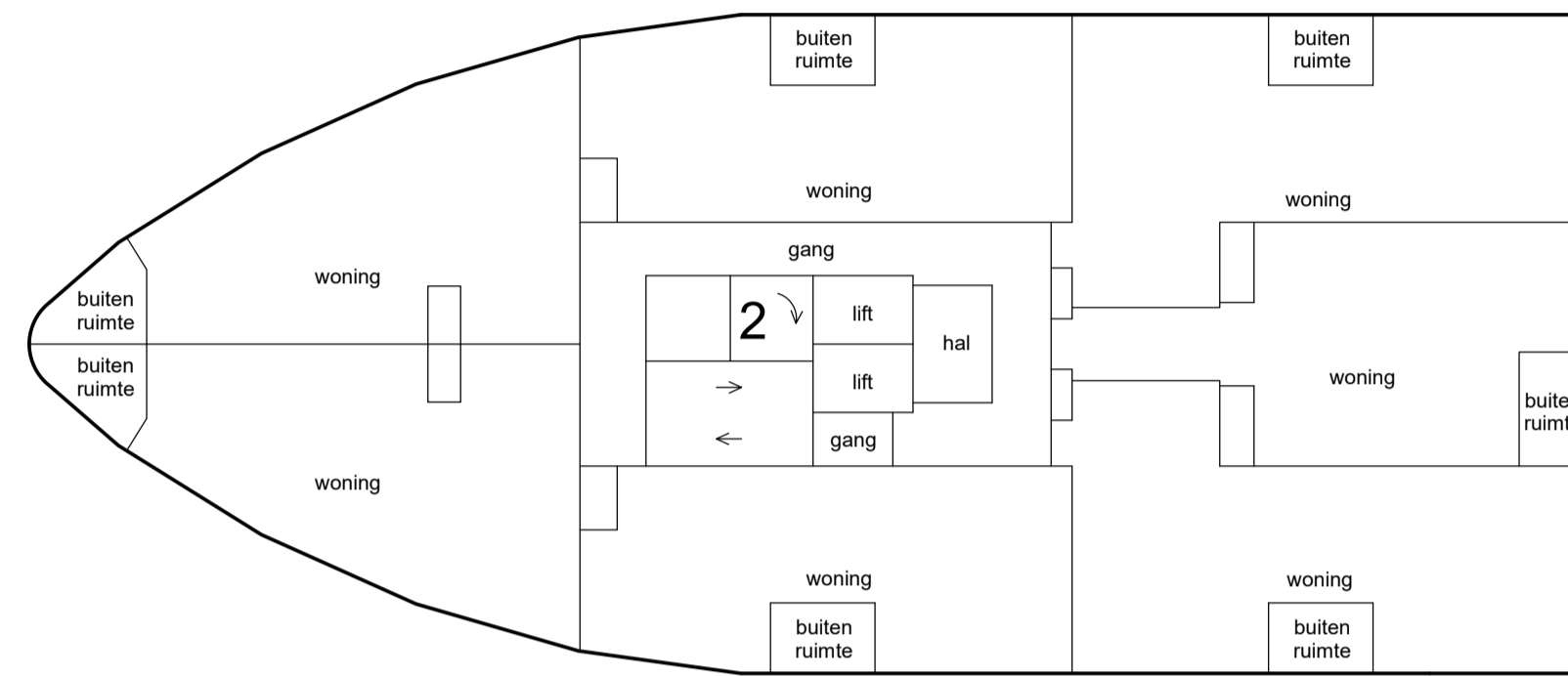
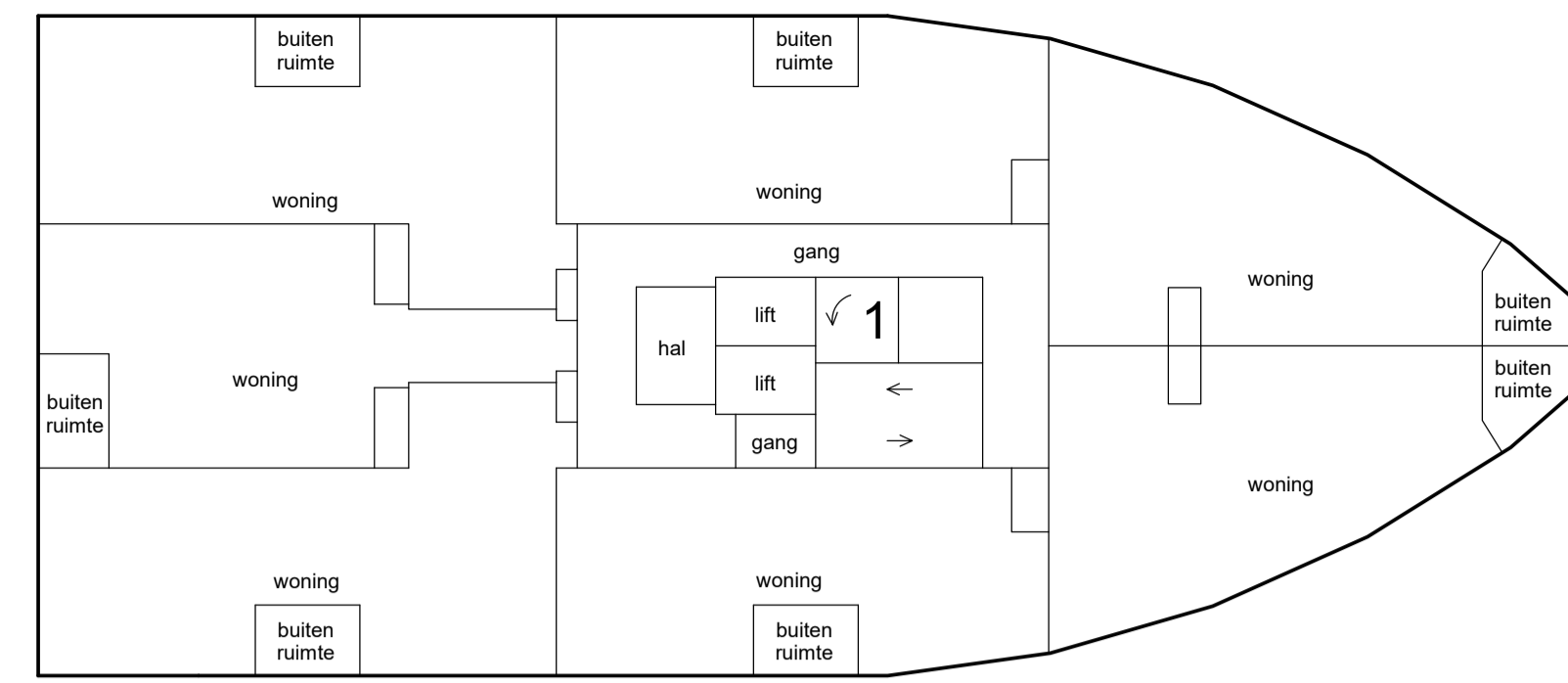

2e etage

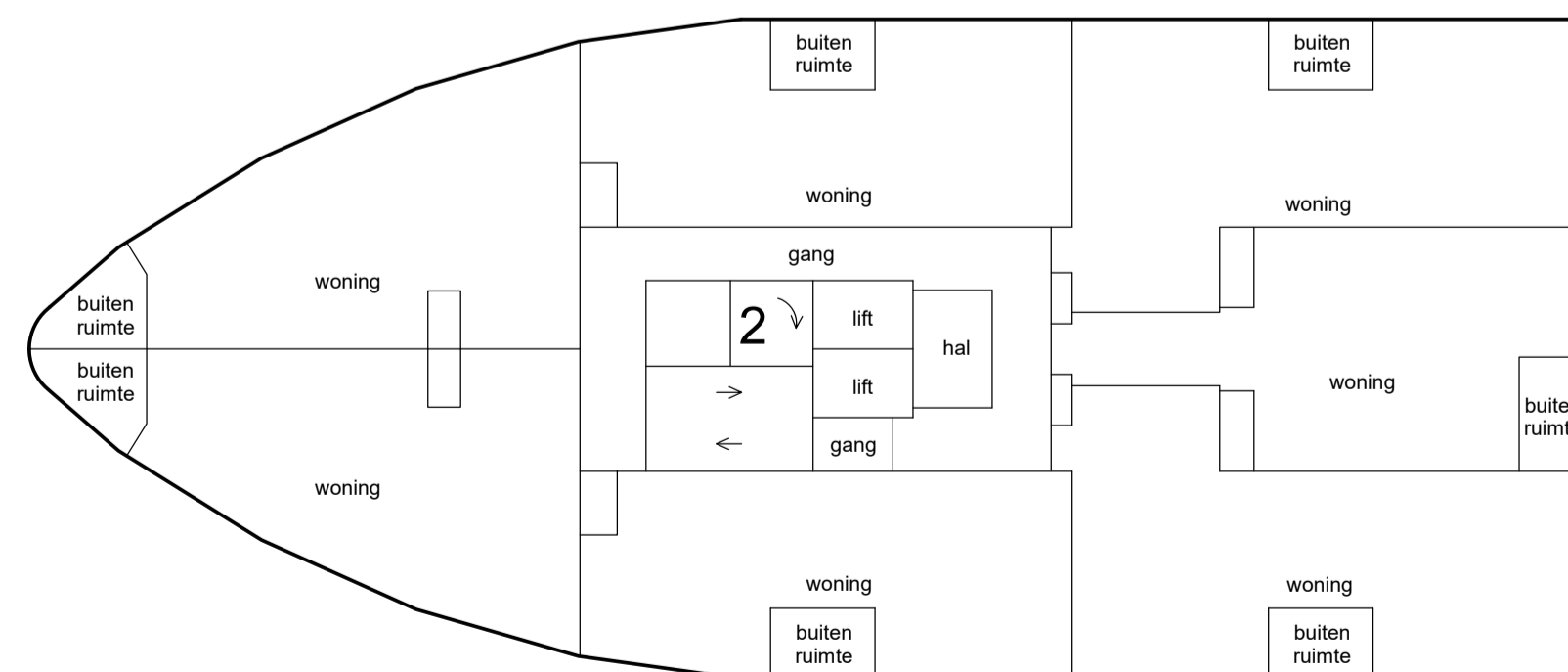
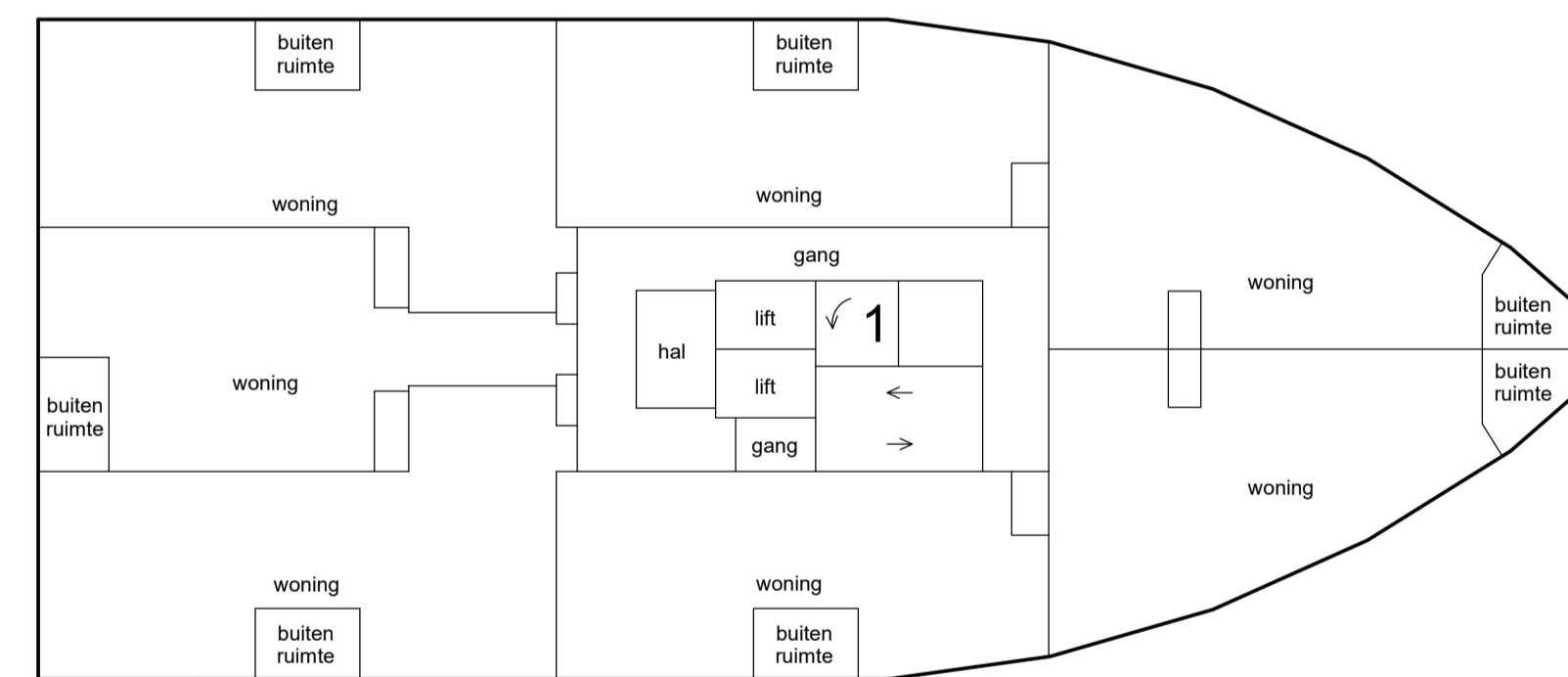

1e etage

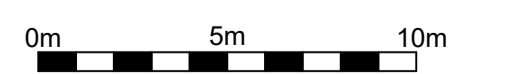
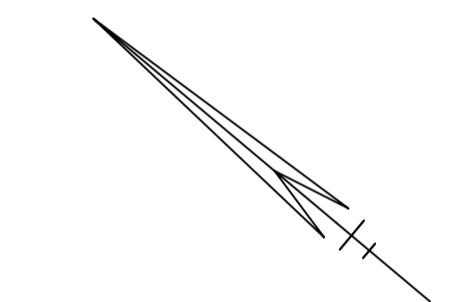

Voorgenomen splitsing in appartementsrechten van de kadastrale percelen: Woensel G 8884, 8886, 8887, 8889, 8890 en 8895

Schaal 1 : 200

■ = Gemeenschappelijk

Tekening bestaat uit 14 bladen

Blad 4

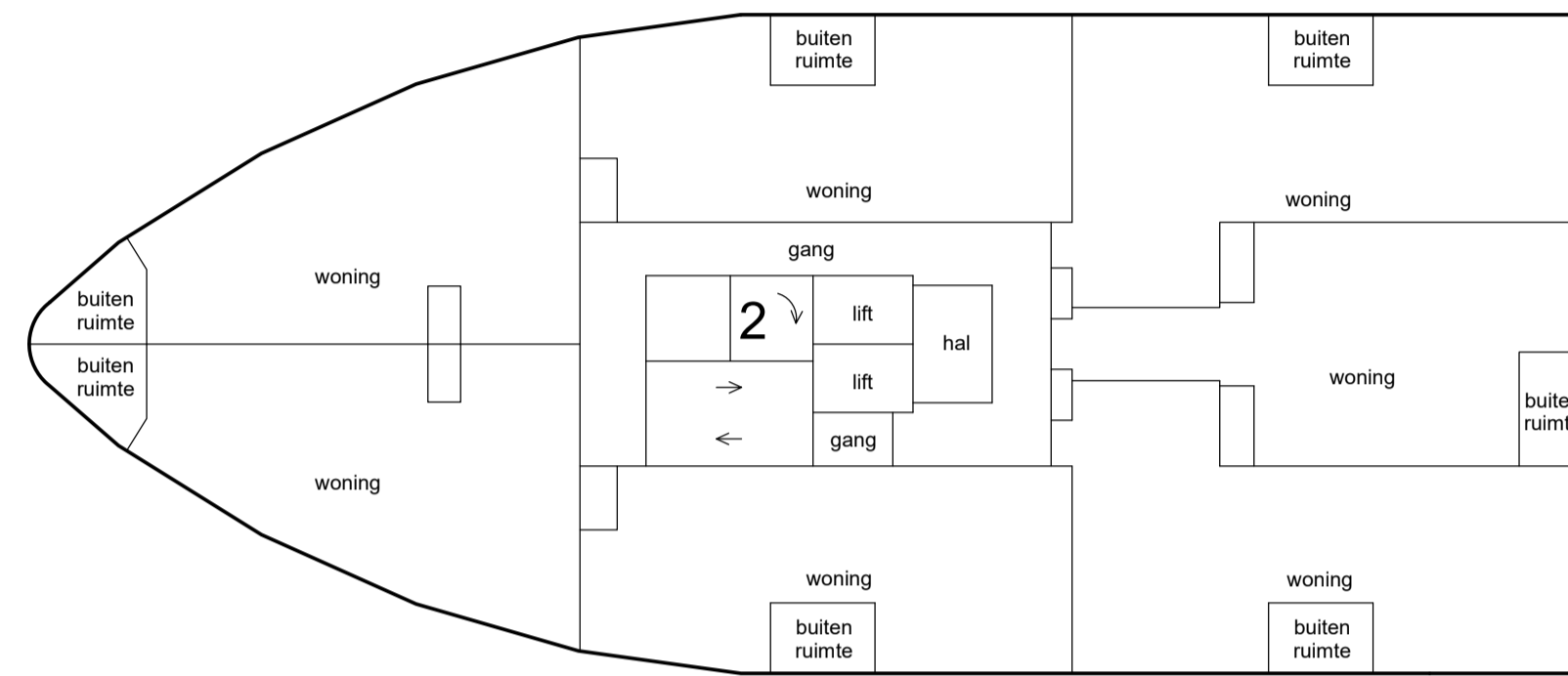
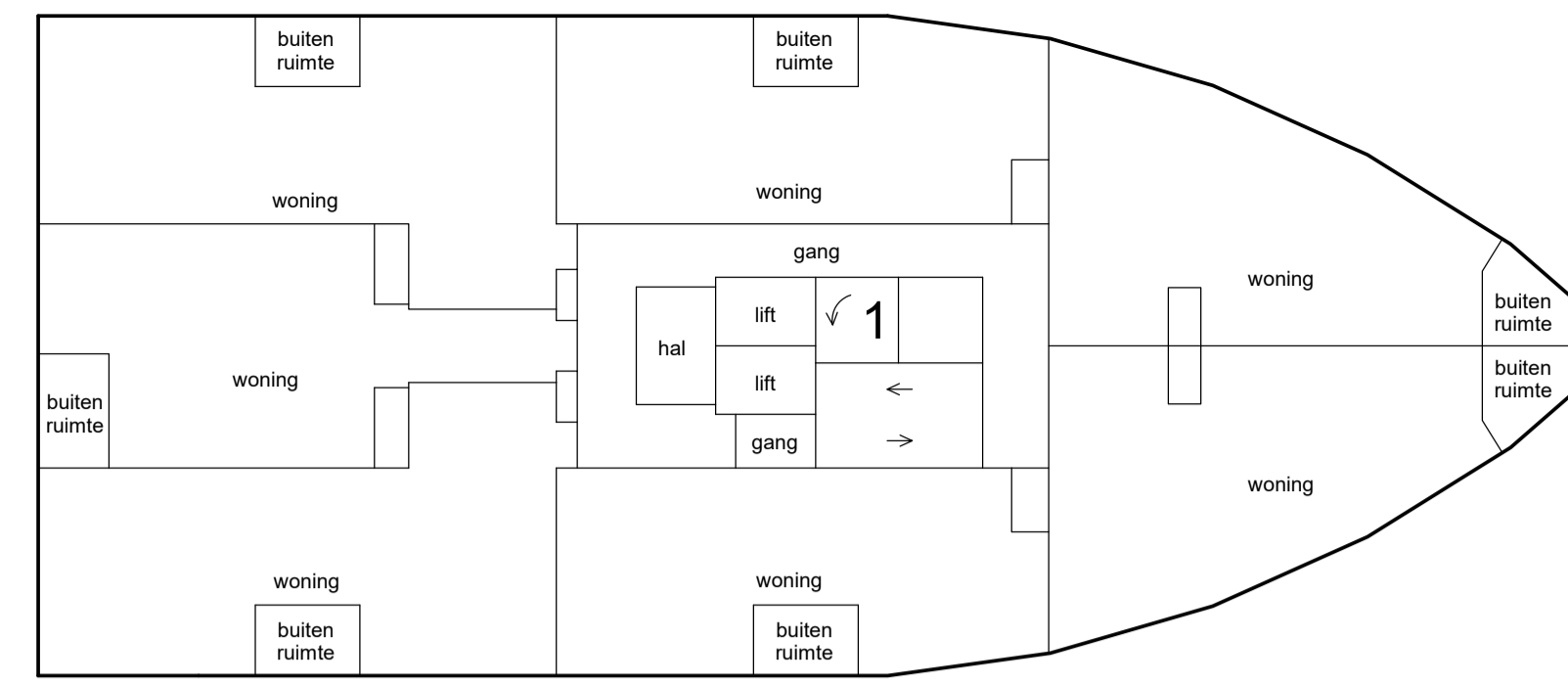

4e etage

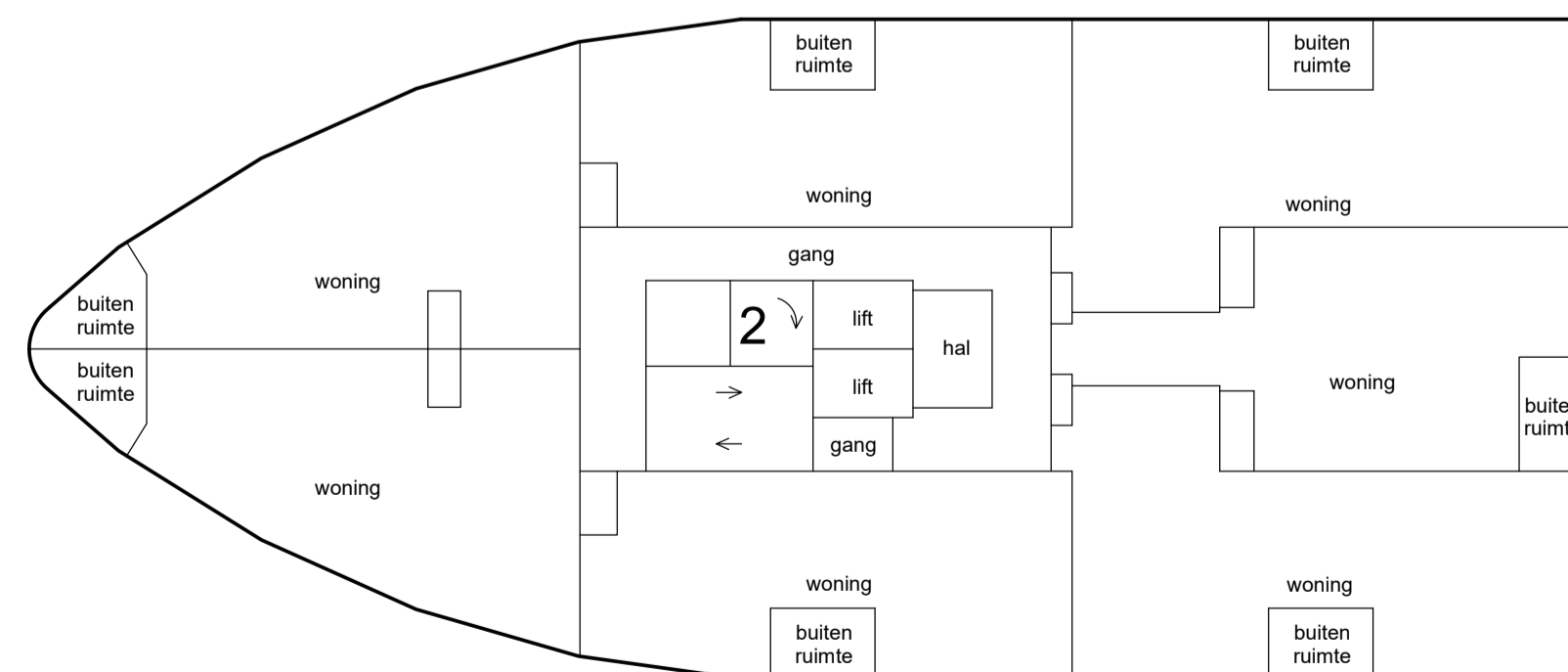
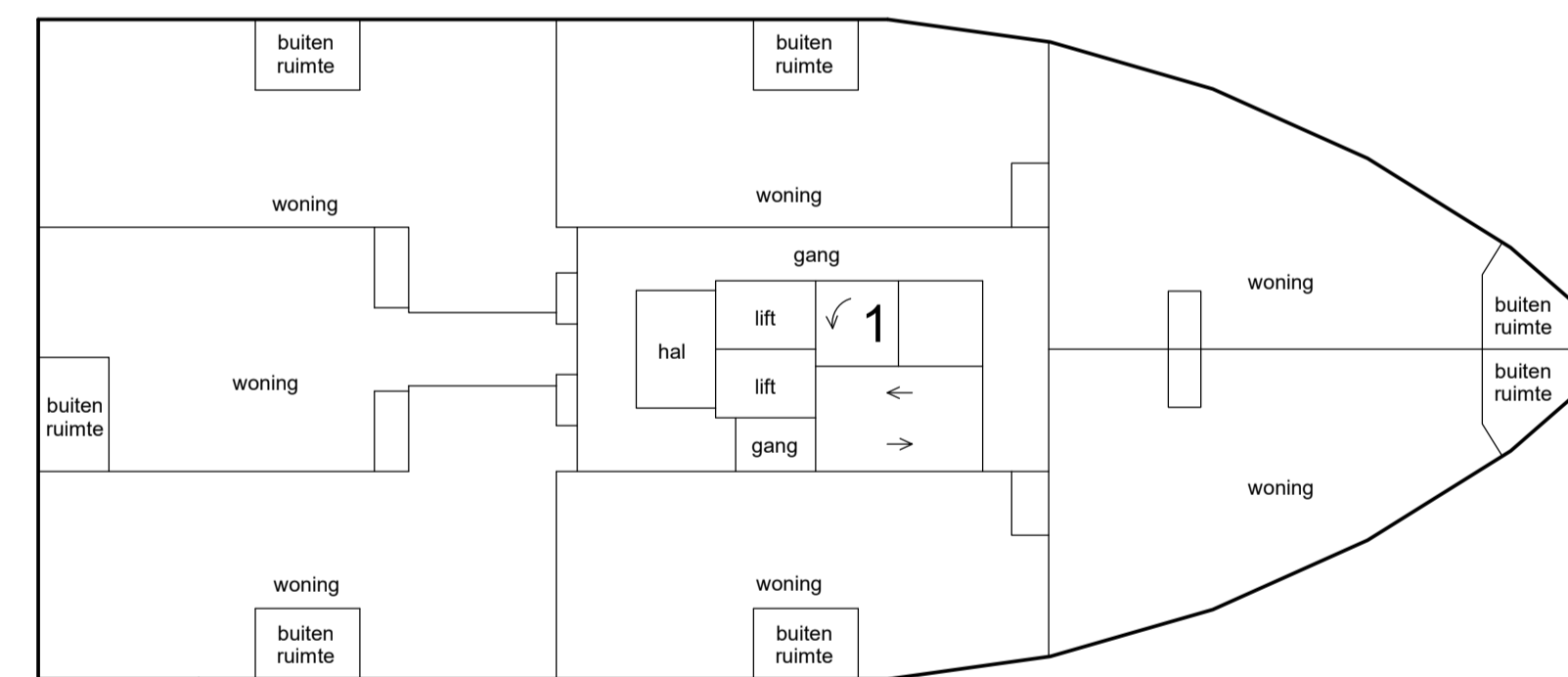

3e etage

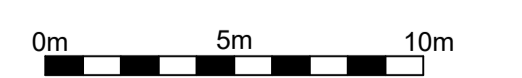
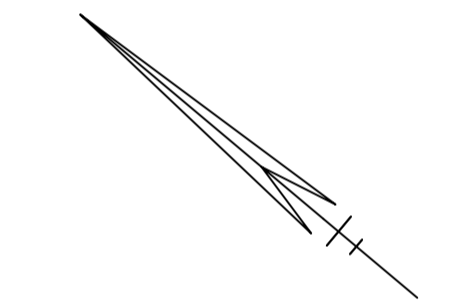

Voorgenomen splitsing in appartementsrechten van de kadastrale percelen: Woensel G 8884, 8886, 8887, 8889, 8890 en 8895

Schaal 1 : 200

■ = Gemeenschappelijk

Tekening bestaat uit 14 bladen

Blad 5

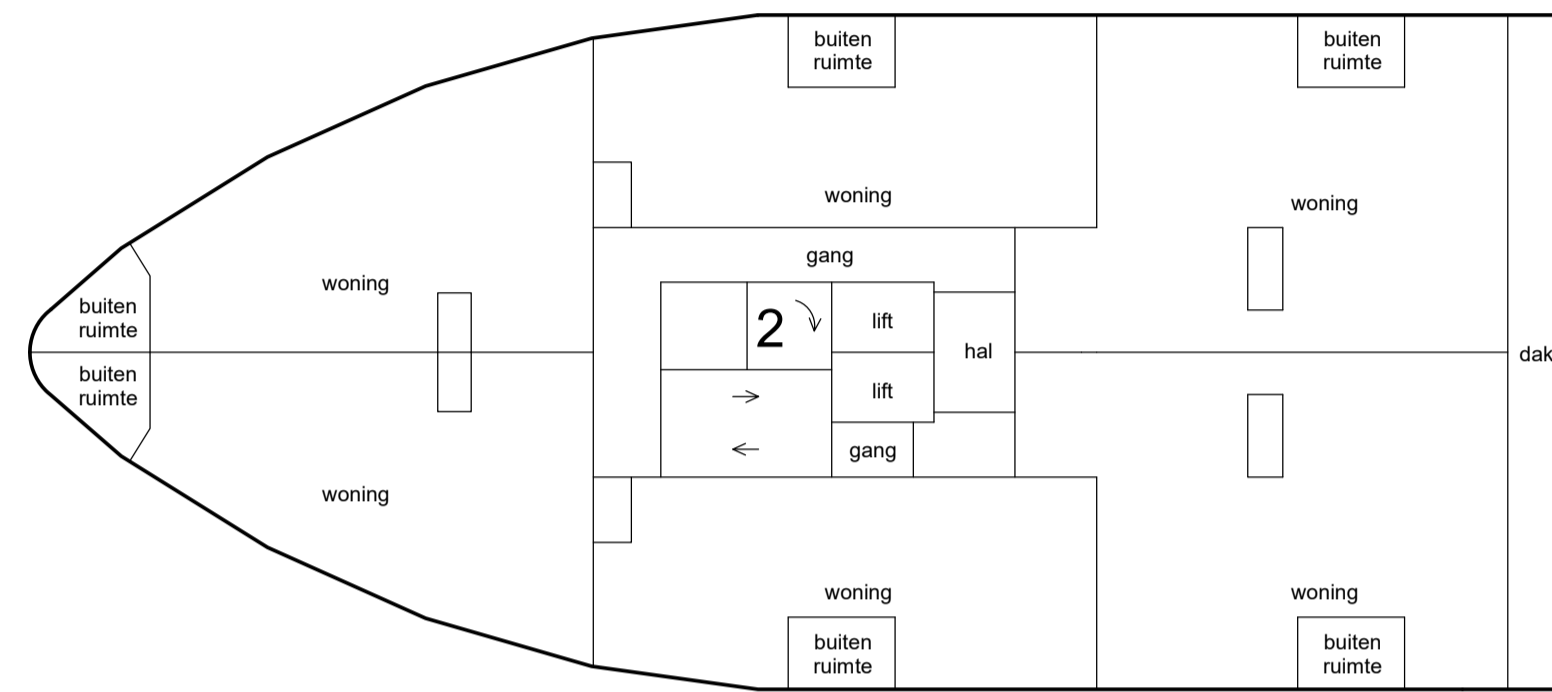
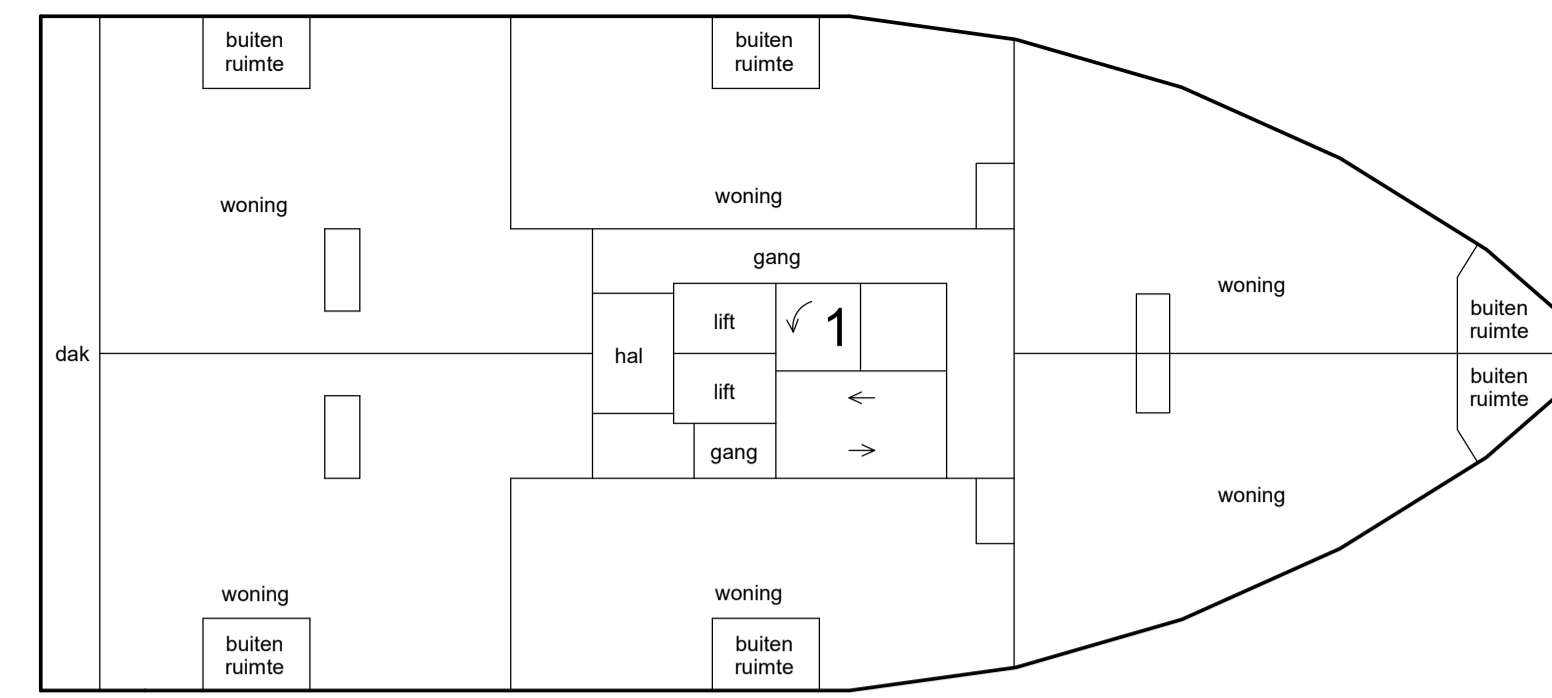

6e etage

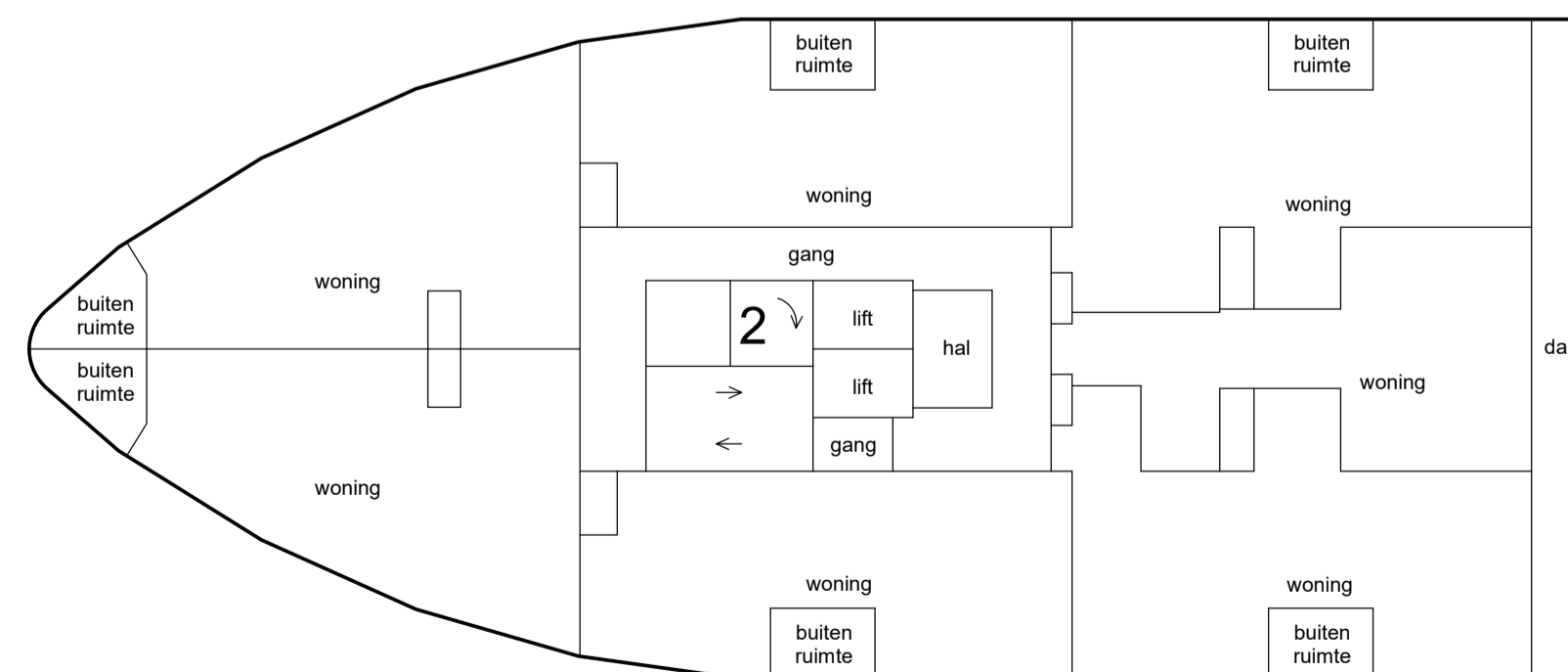
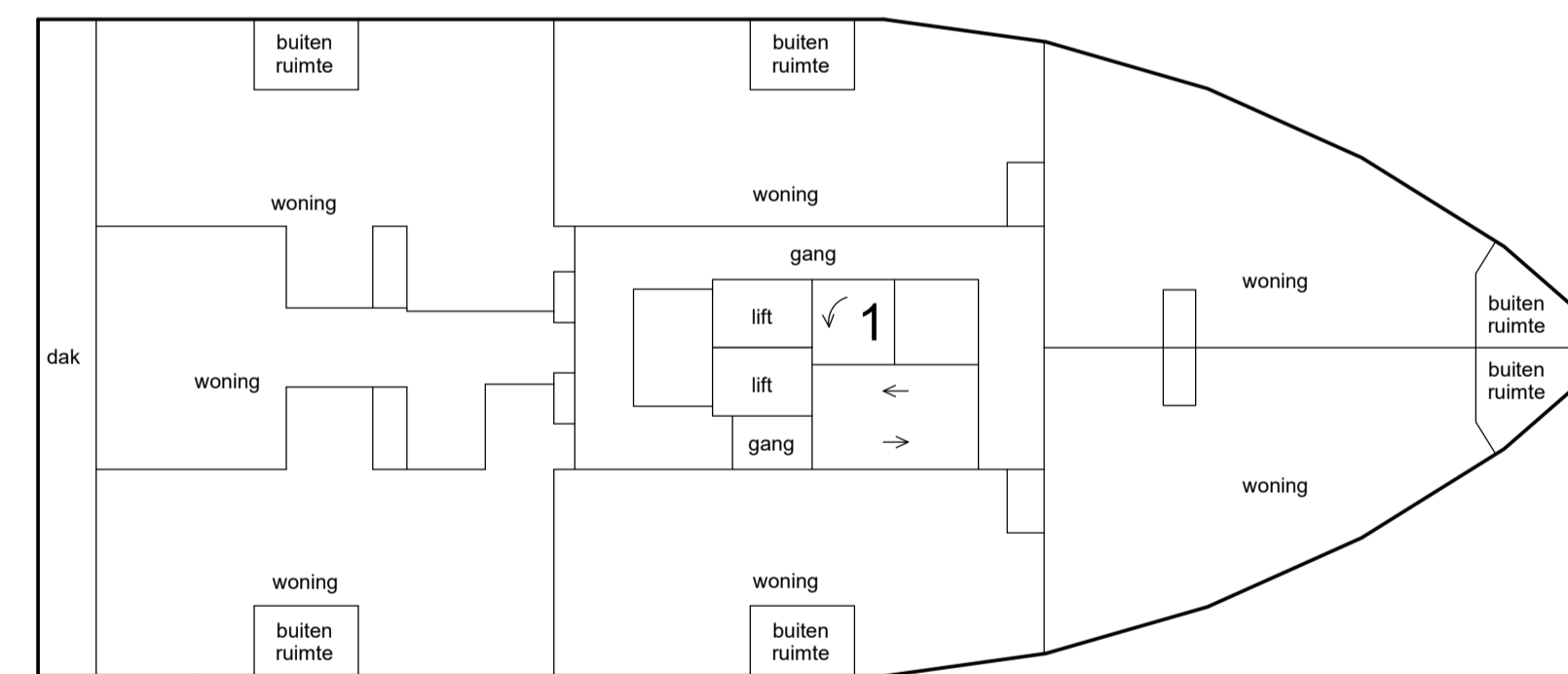

5e etage

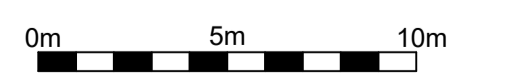

Voorgenomen splitsing in appartementsrechten van de kadastrale percelen: Woensel G 8884, 8886, 8887, 8889, 8890 en 8895

Schaal 1 : 200

■ = Gemeenschappelijk

Tekening bestaat uit 14 bladen

Blad 6

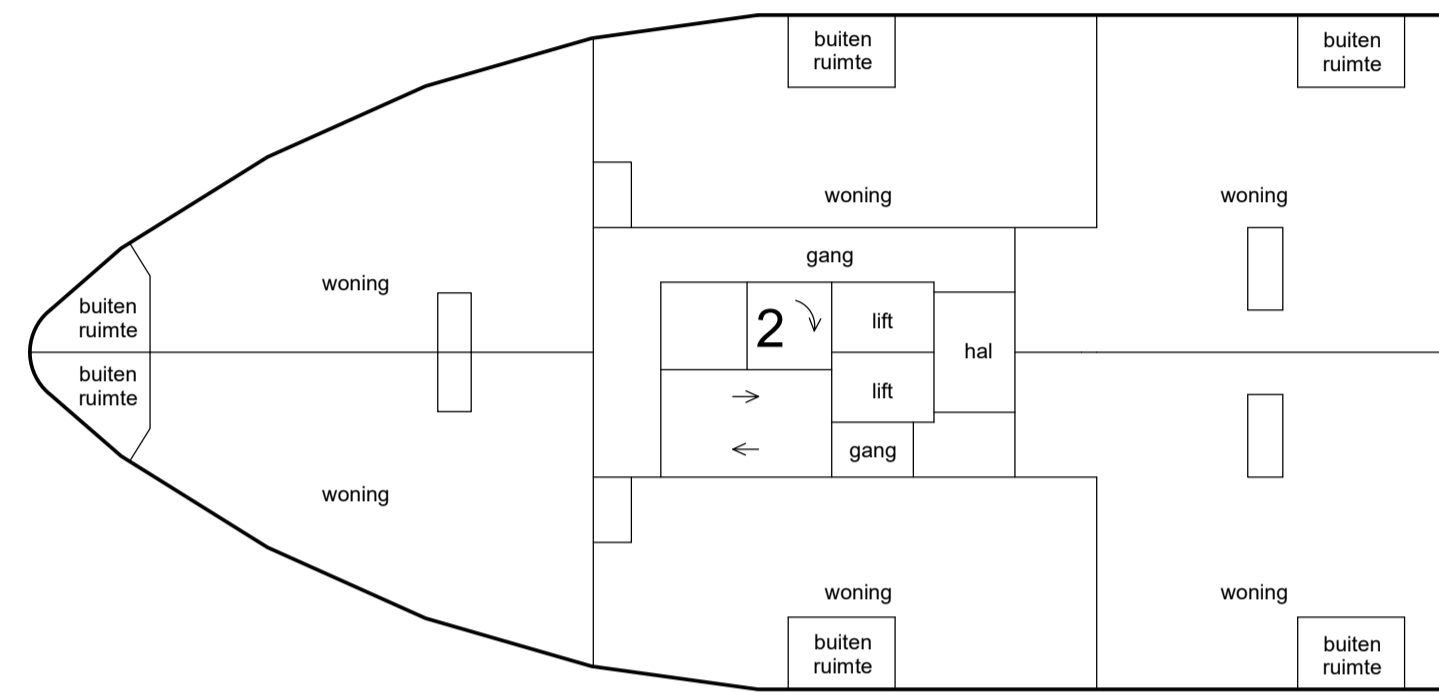
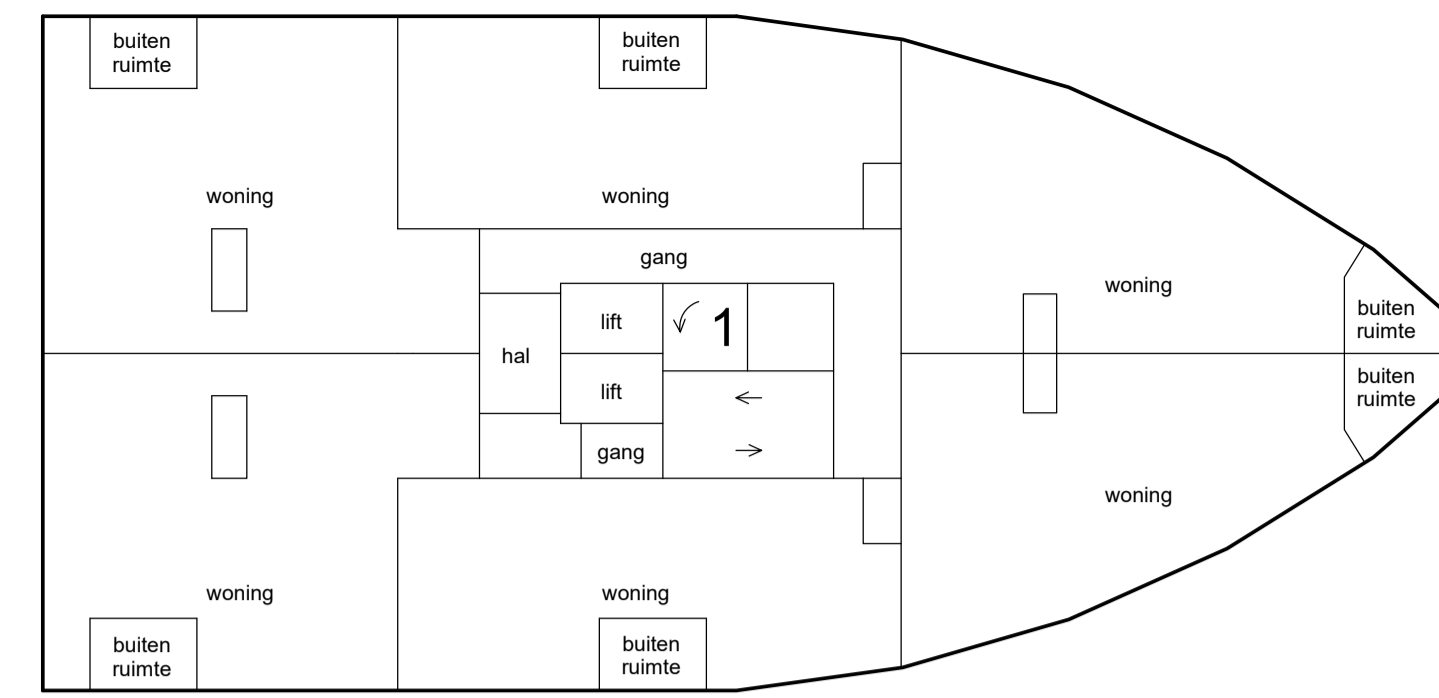

8e etage

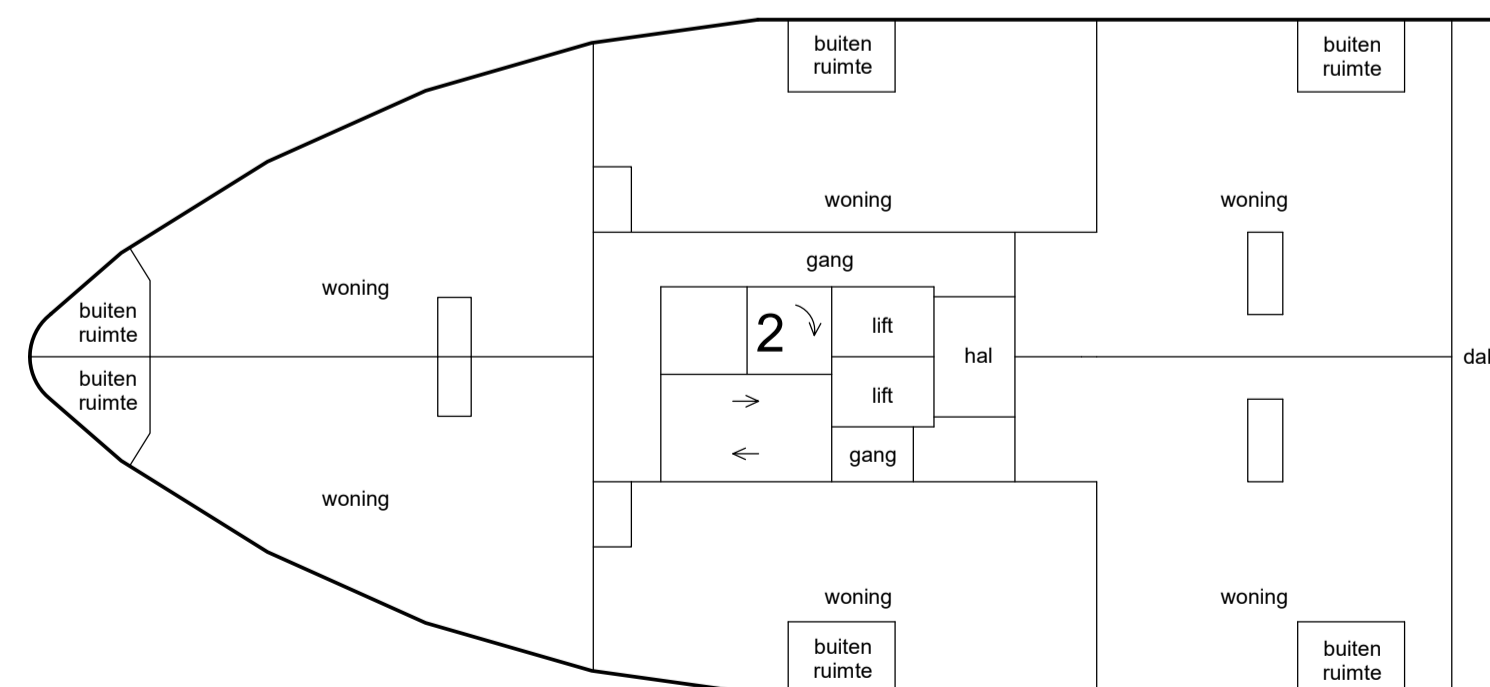
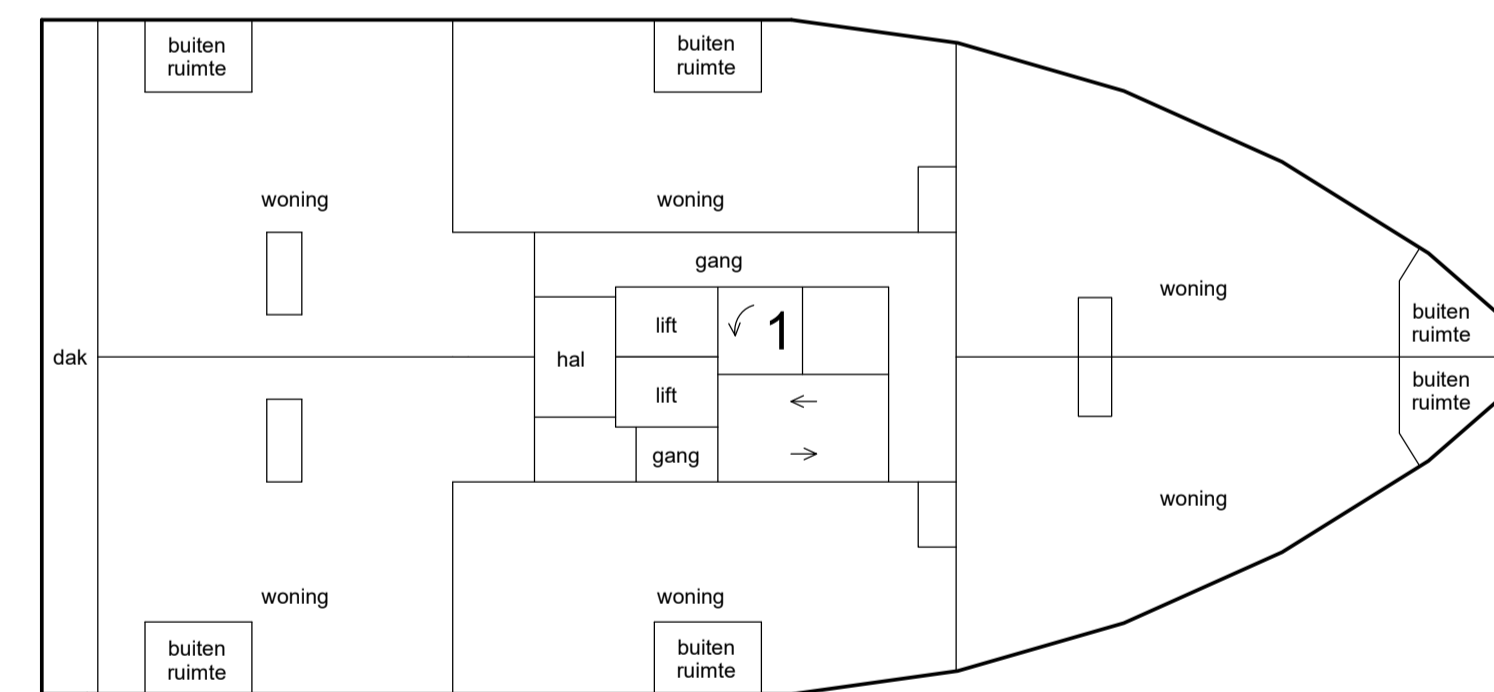

7e etage

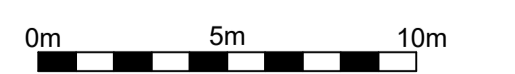

Voorgenomen splitsing in appartementsrechten van de kadastrale percelen: Woensel G 8884, 8886, 8887, 8889, 8890 en 8895

Schaal 1 : 200

■ = Gemeenschappelijk

Tekening bestaat uit 14 bladen

Blad 7

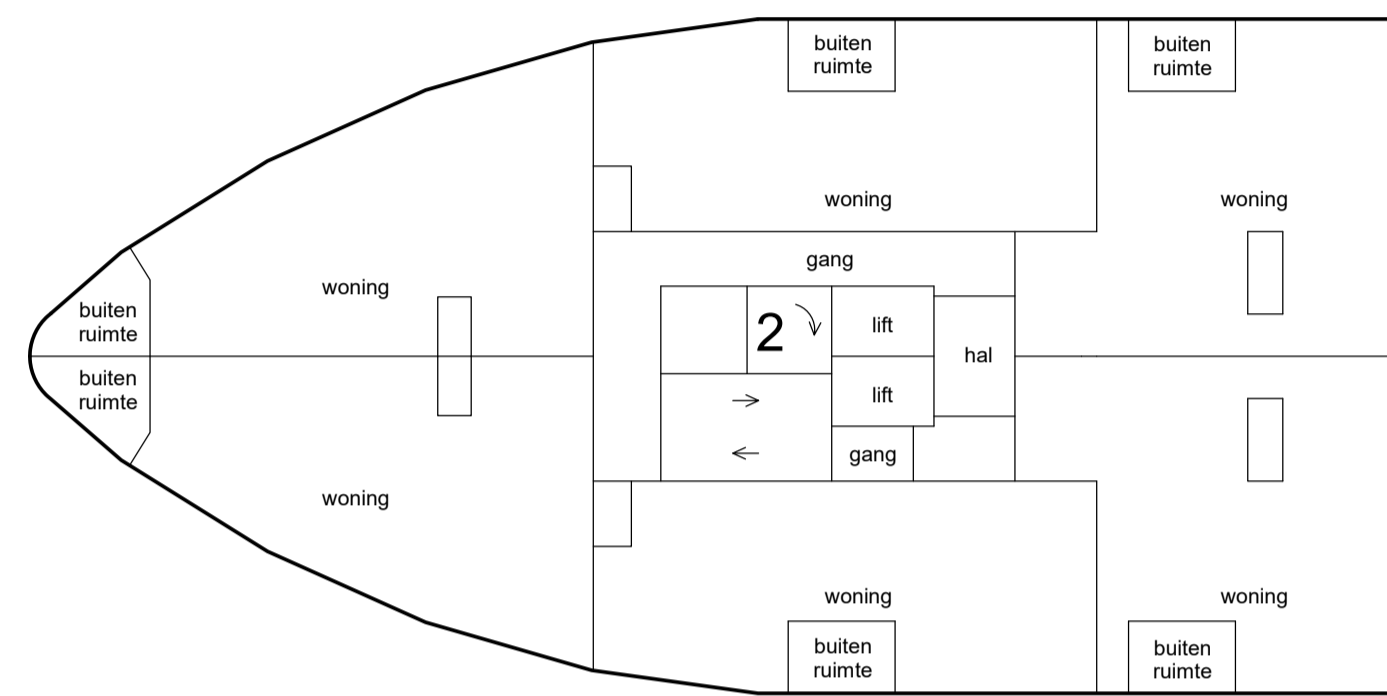
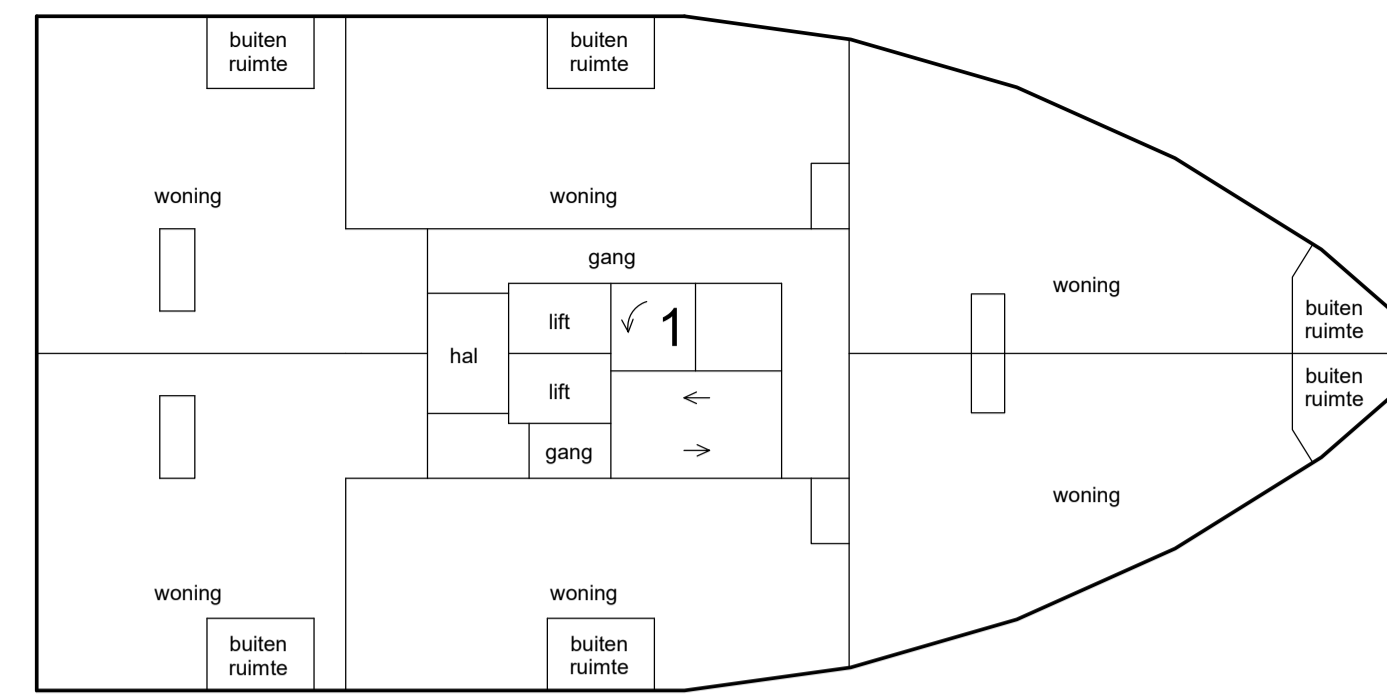

10e etage

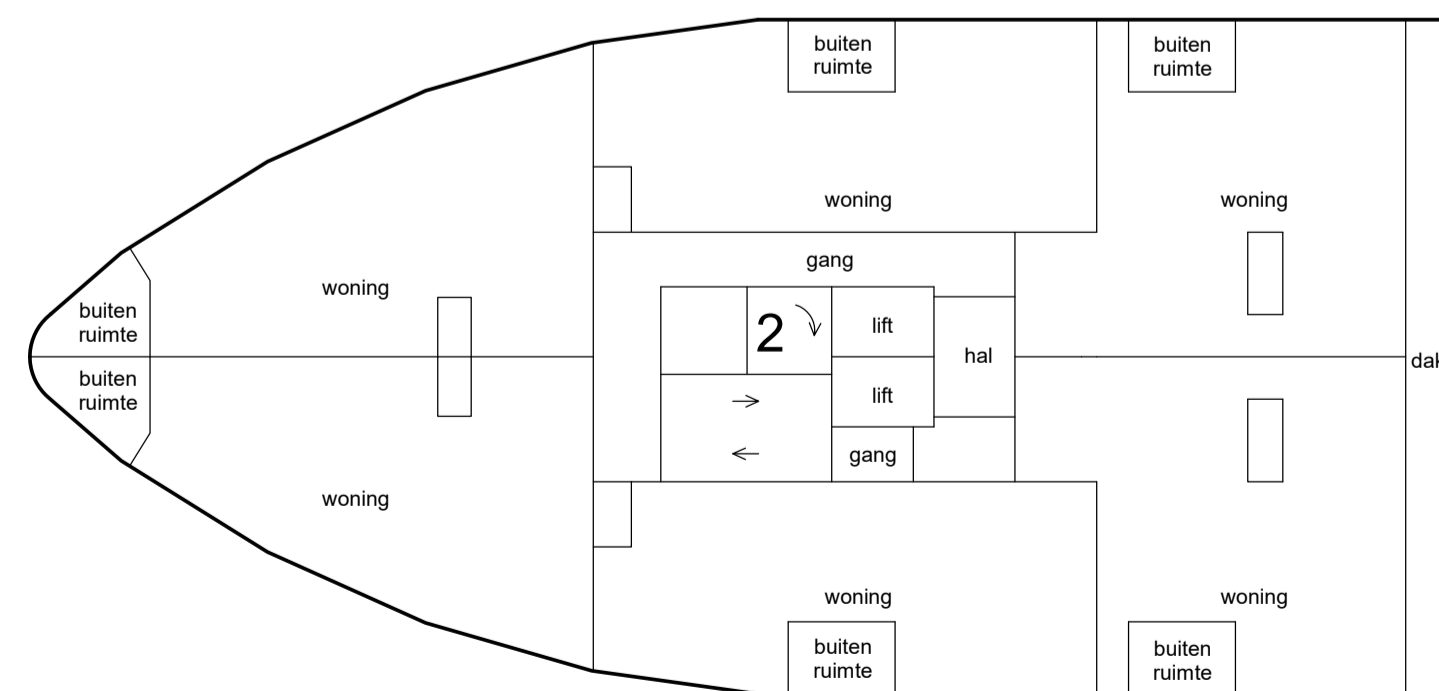
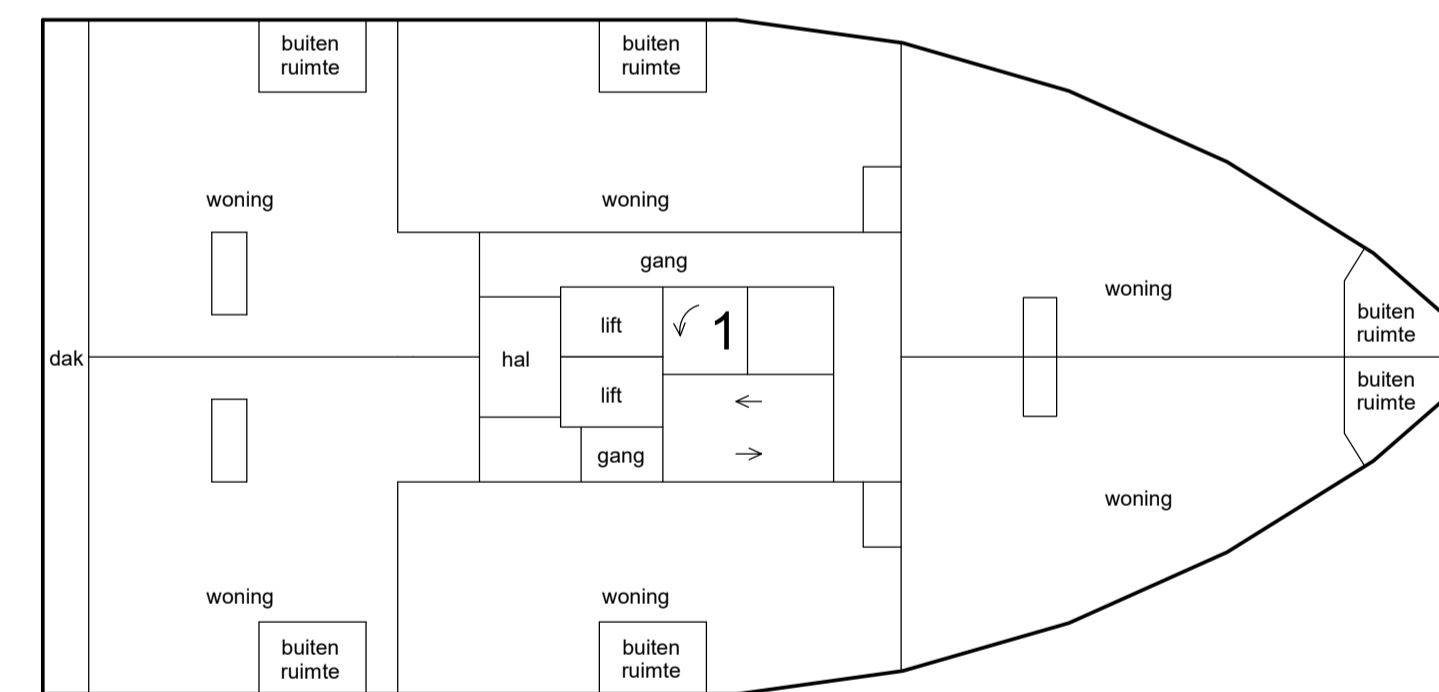

9e etage

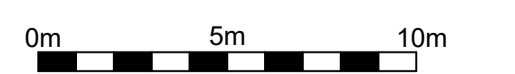

Voorgenomen splitsing in appartementsrechten van de kadastrale percelen: Woensel G 8884, 8886, 8887, 8889, 8890 en 8895

Schaal 1 : 200

■ = Gemeenschappelijk

Tekening bestaat uit 14 bladen

Blad 8

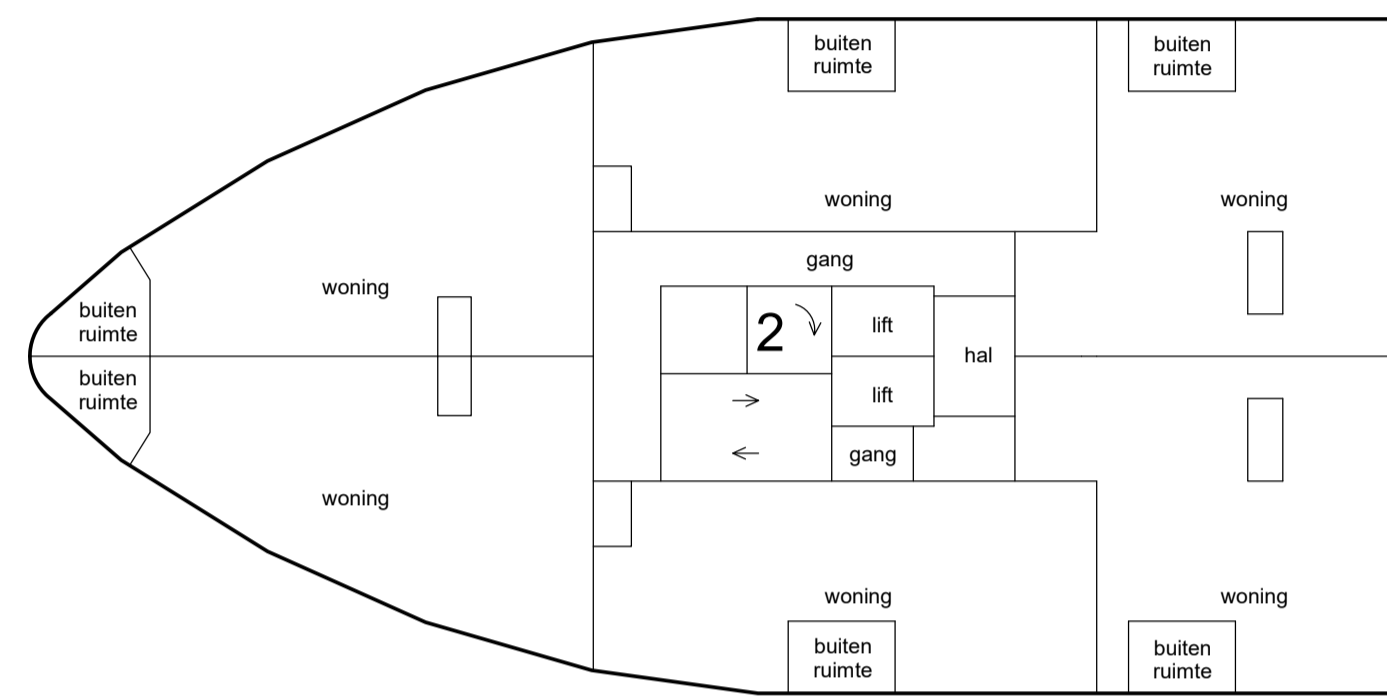
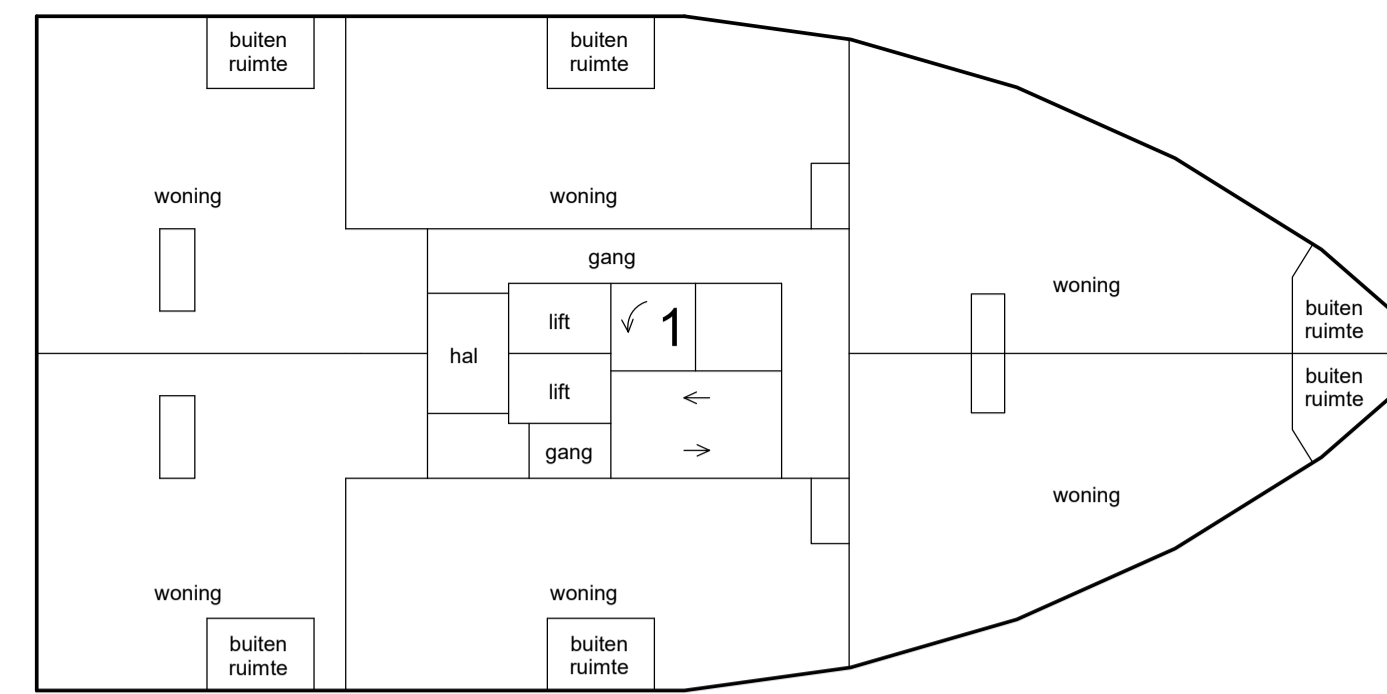

12e etage

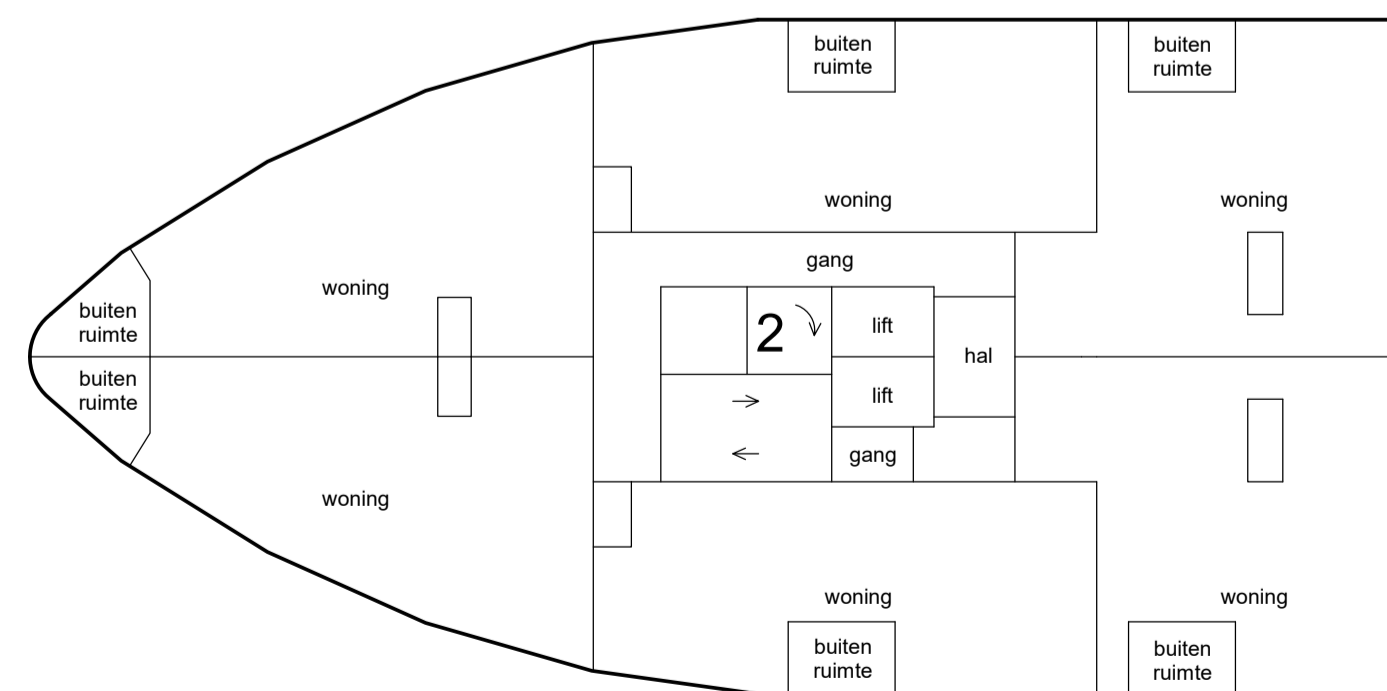
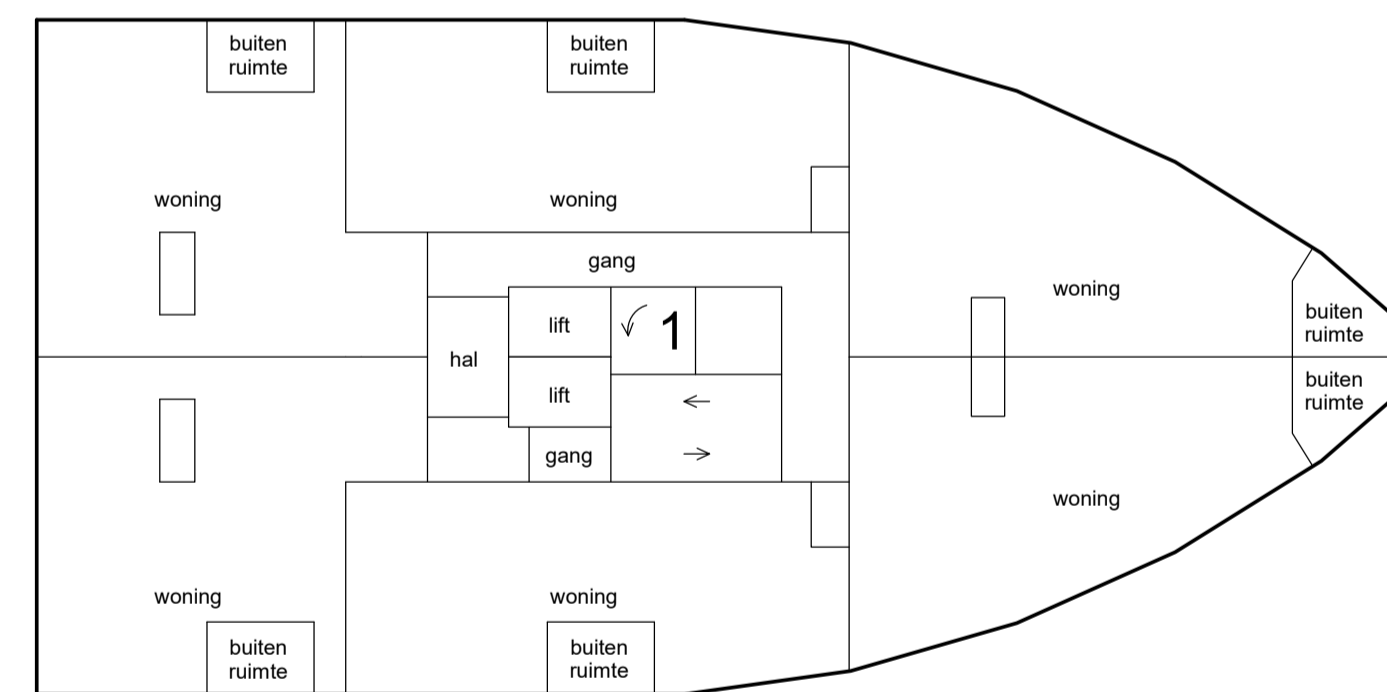

11e etage

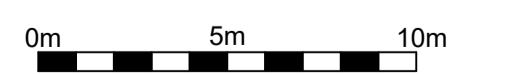
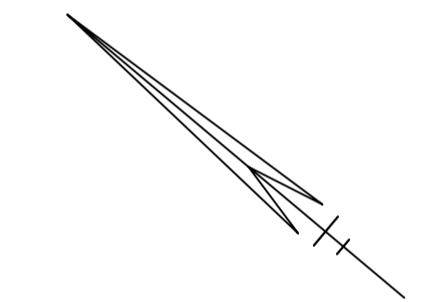

Voorgenomen splitsing in appartementsrechten van de kadastrale percelen: Woensel G 8884, 8886, 8887, 8889, 8890 en 8895

Schaal 1 : 200

■ = Gemeenschappelijk

Tekening bestaat uit 14 bladen

Blad 9

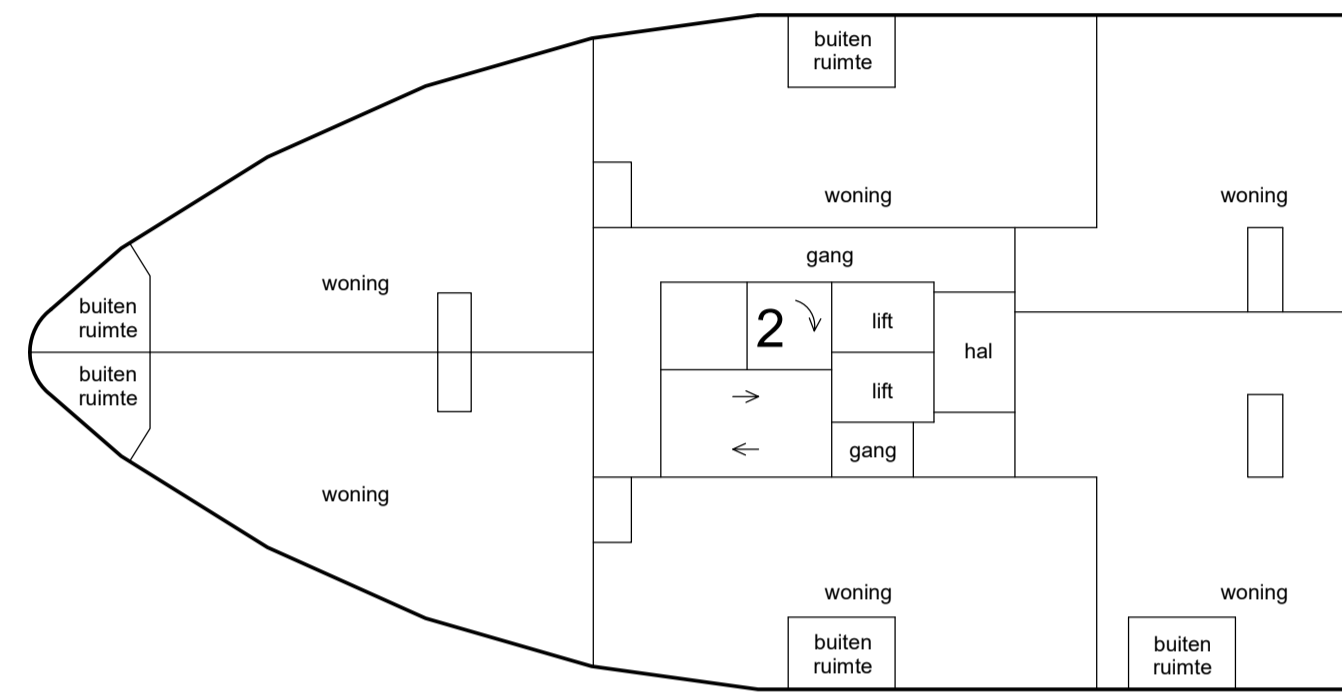
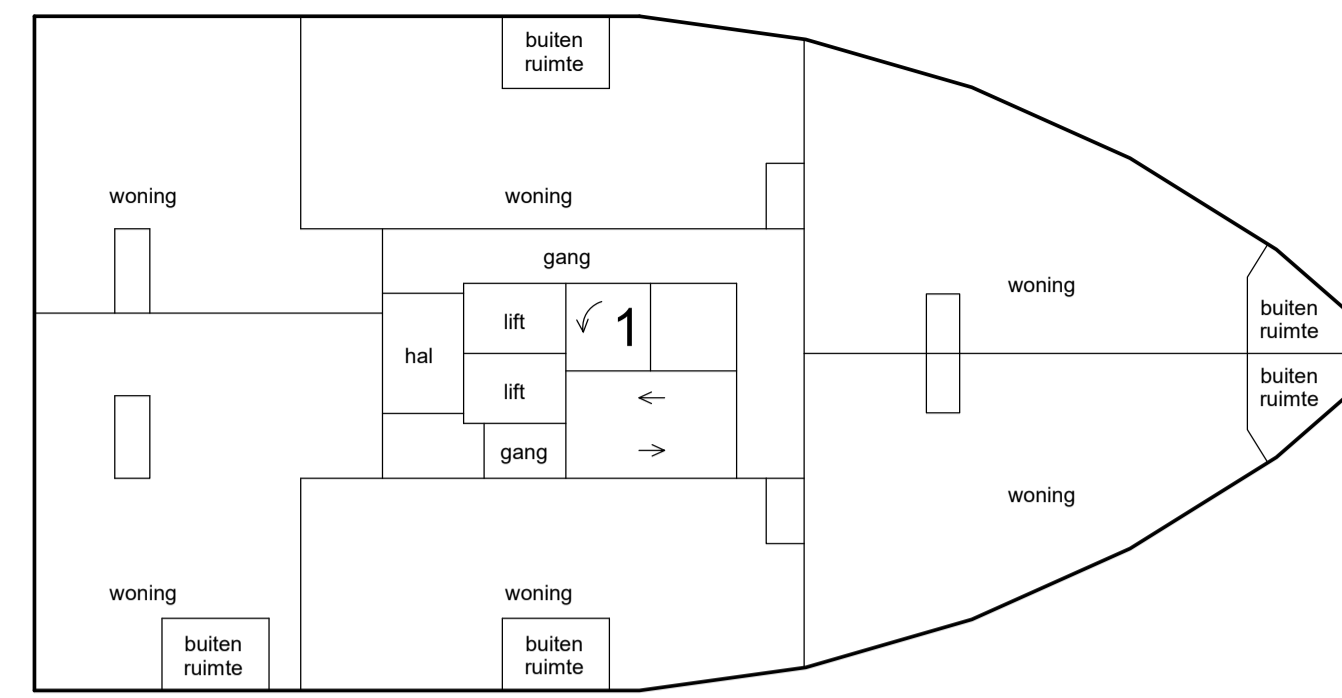

14e etage

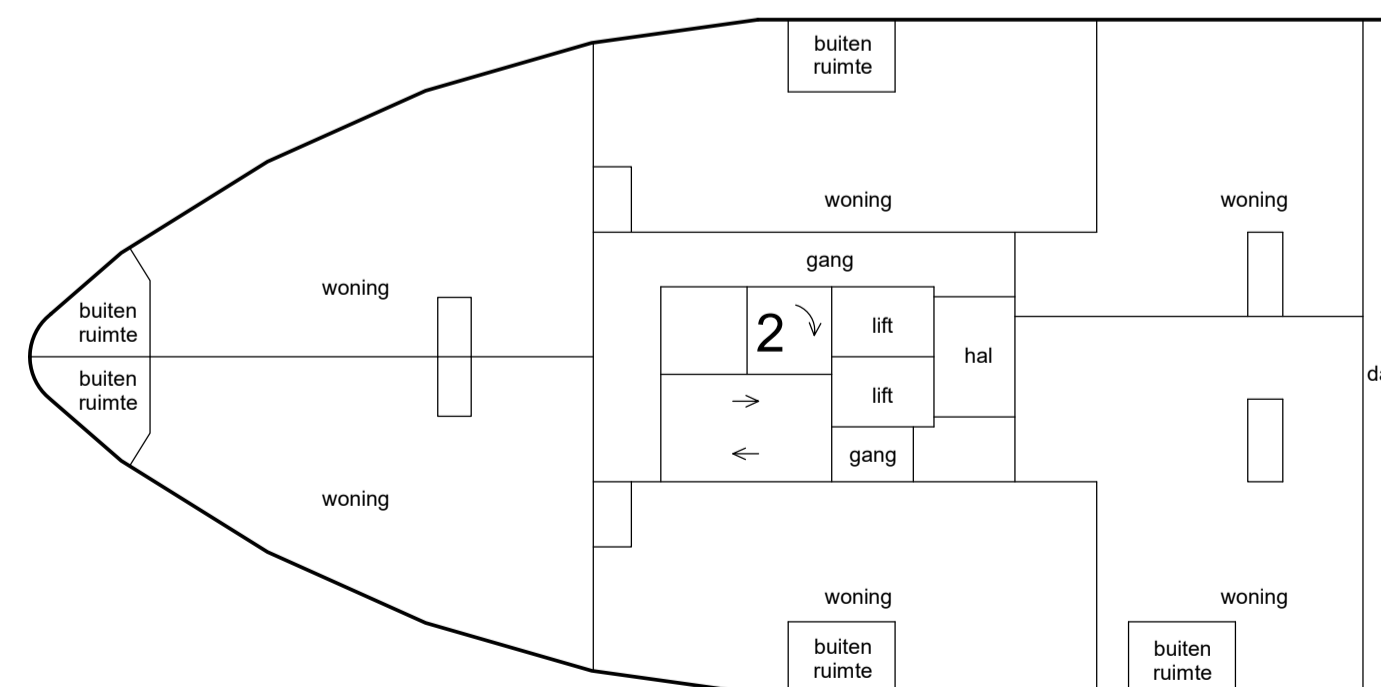
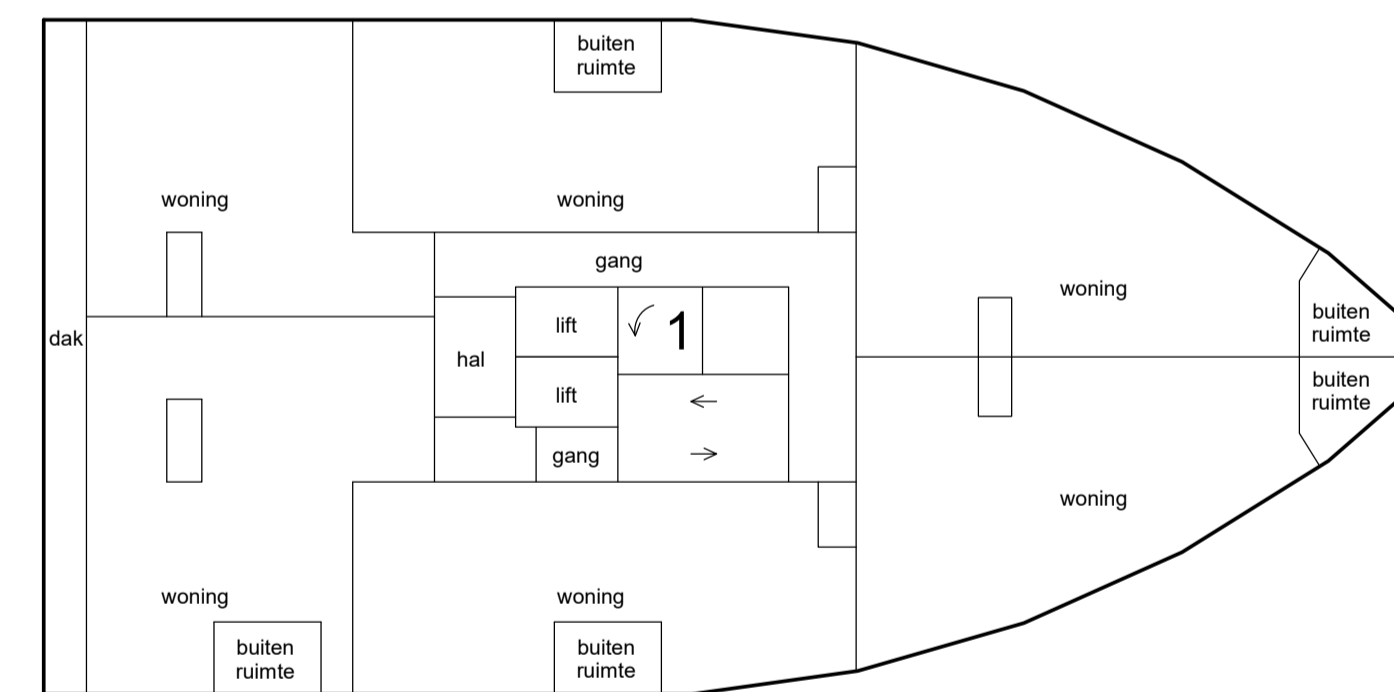

13e etage

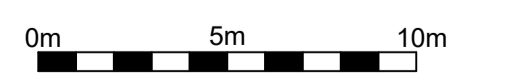
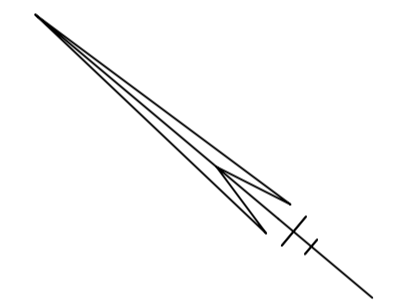

Voorgenomen splitsing in appartementsrechten van de kadastrale percelen: Woensel G 8884, 8886, 8887, 8889, 8890 en 8895

Schaal 1 : 200

■ = Gemeenschappelijk

Tekening bestaat uit 14 bladen

Blad 10

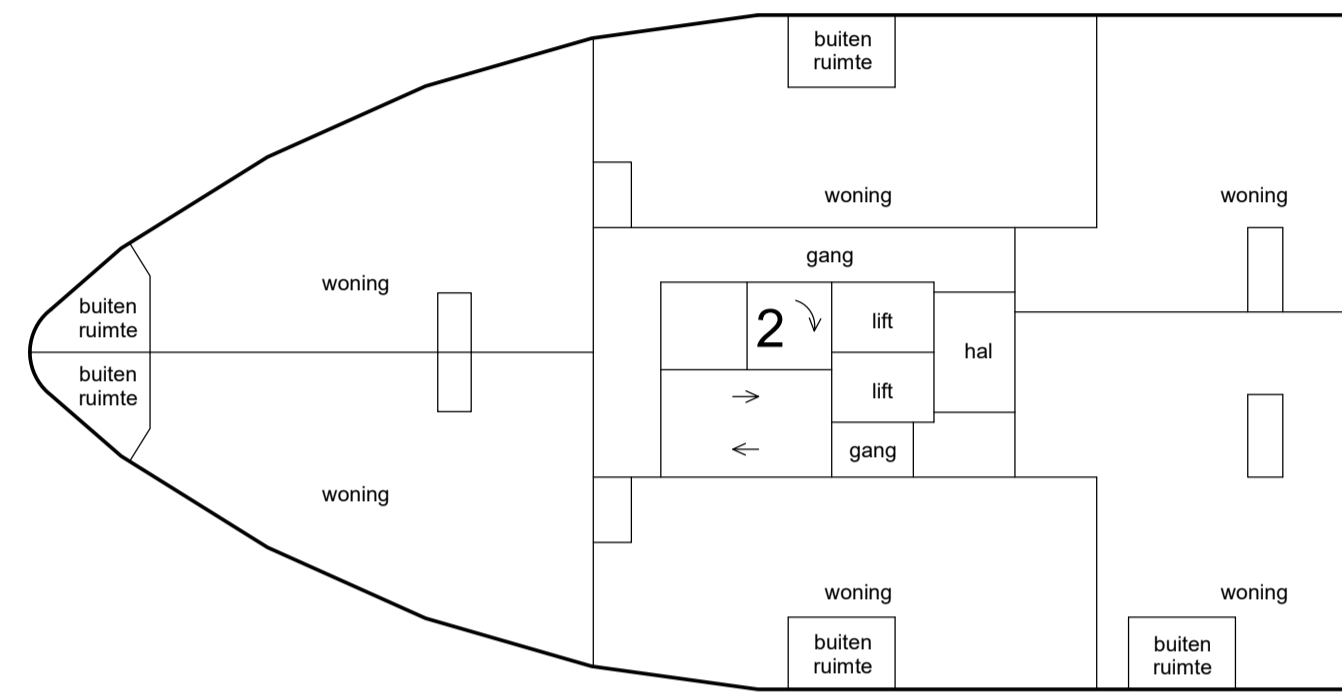
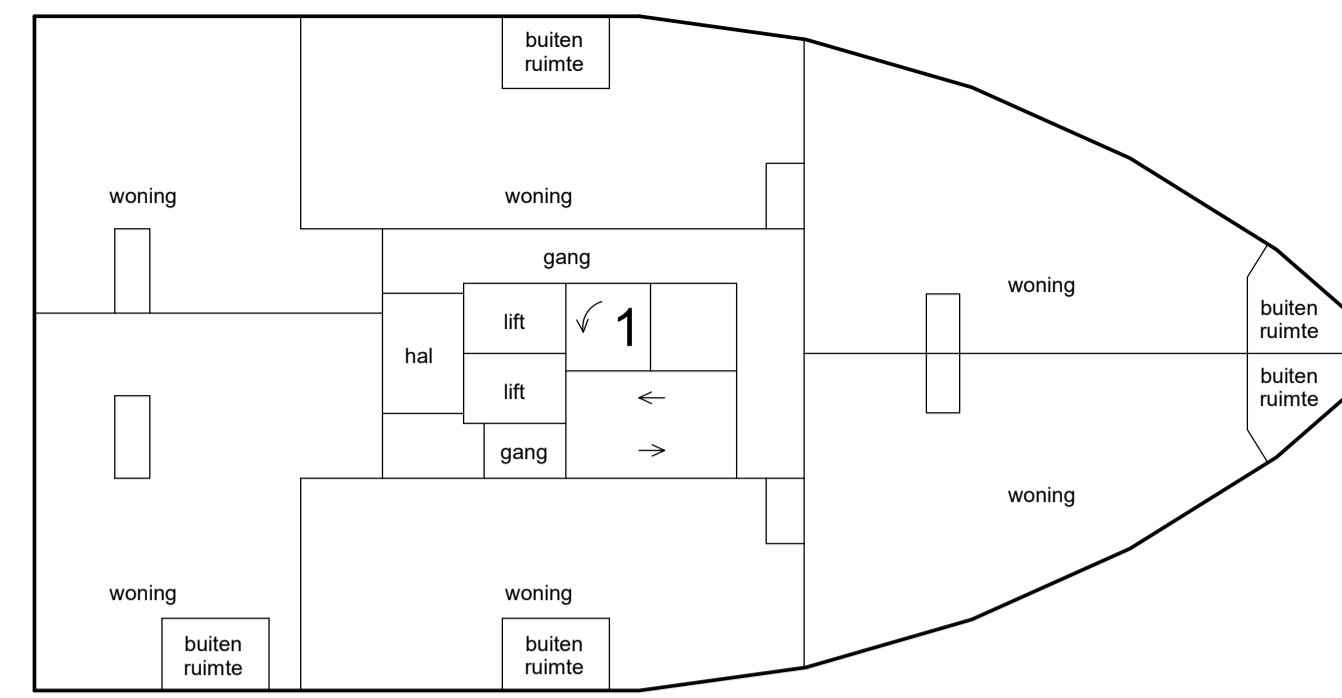

16e etage

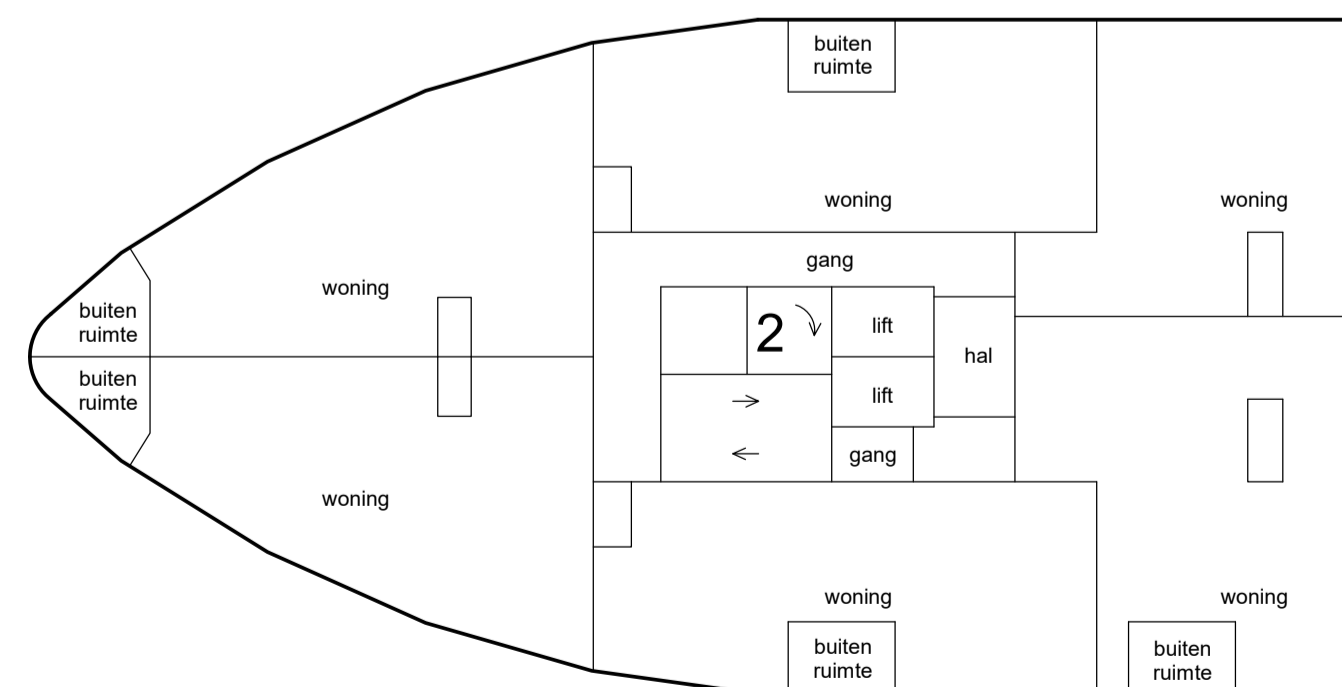
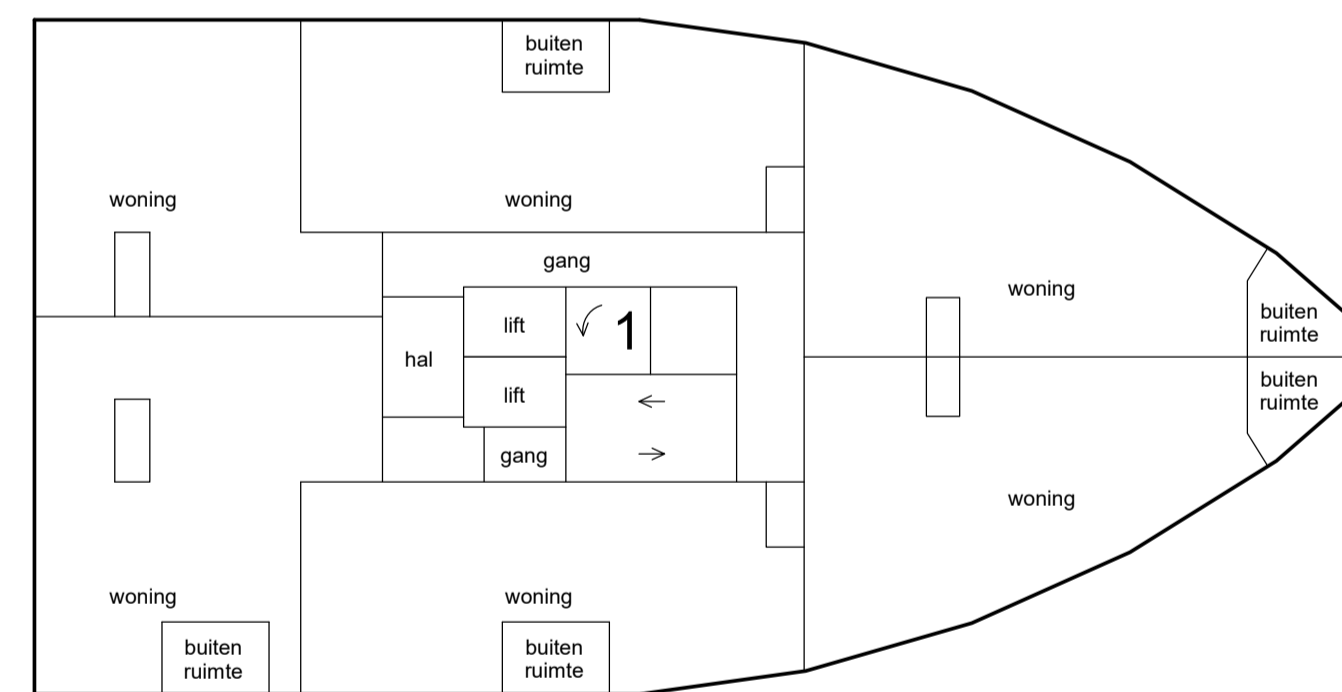

15e etage

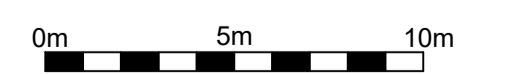
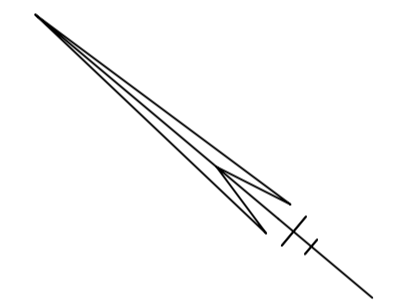

Voorgenomen splitsing in appartementsrechten van de kadastrale percelen: Woensel G 8884, 8886, 8887, 8889, 8890 en 8895

Schaal 1 : 200

■ = Gemeenschappelijk

Tekening bestaat uit 14 bladen

Blad 11

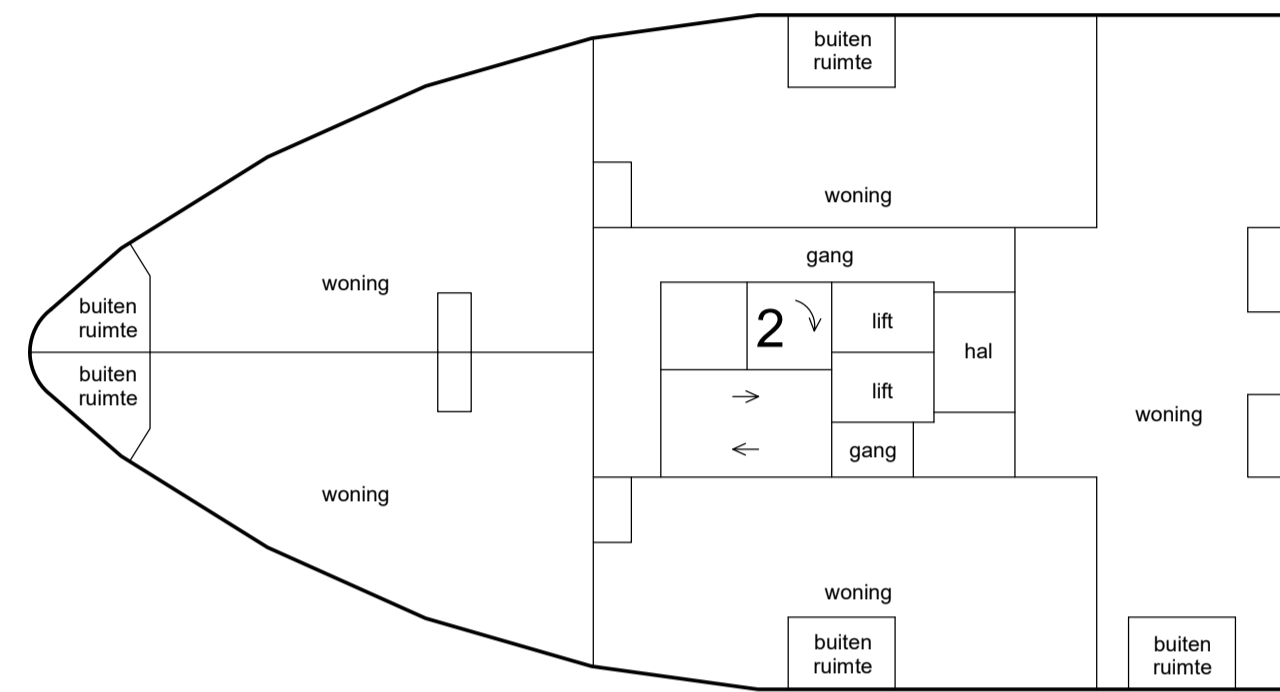
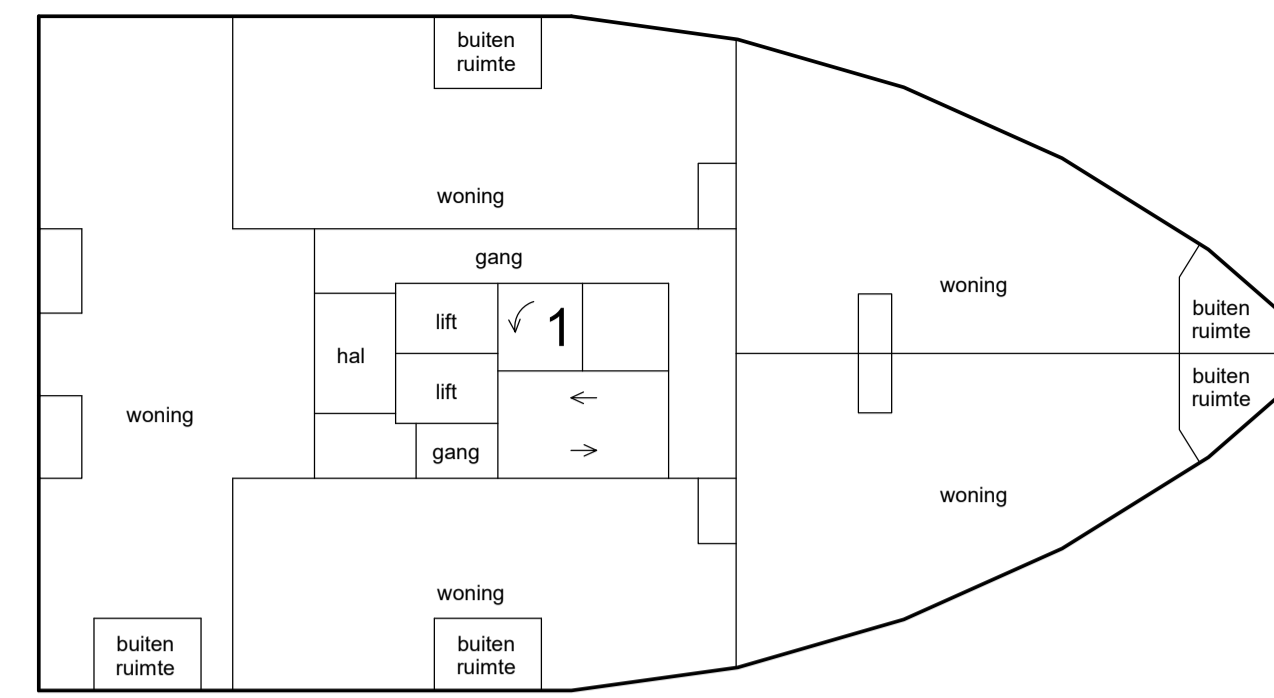

18e etage

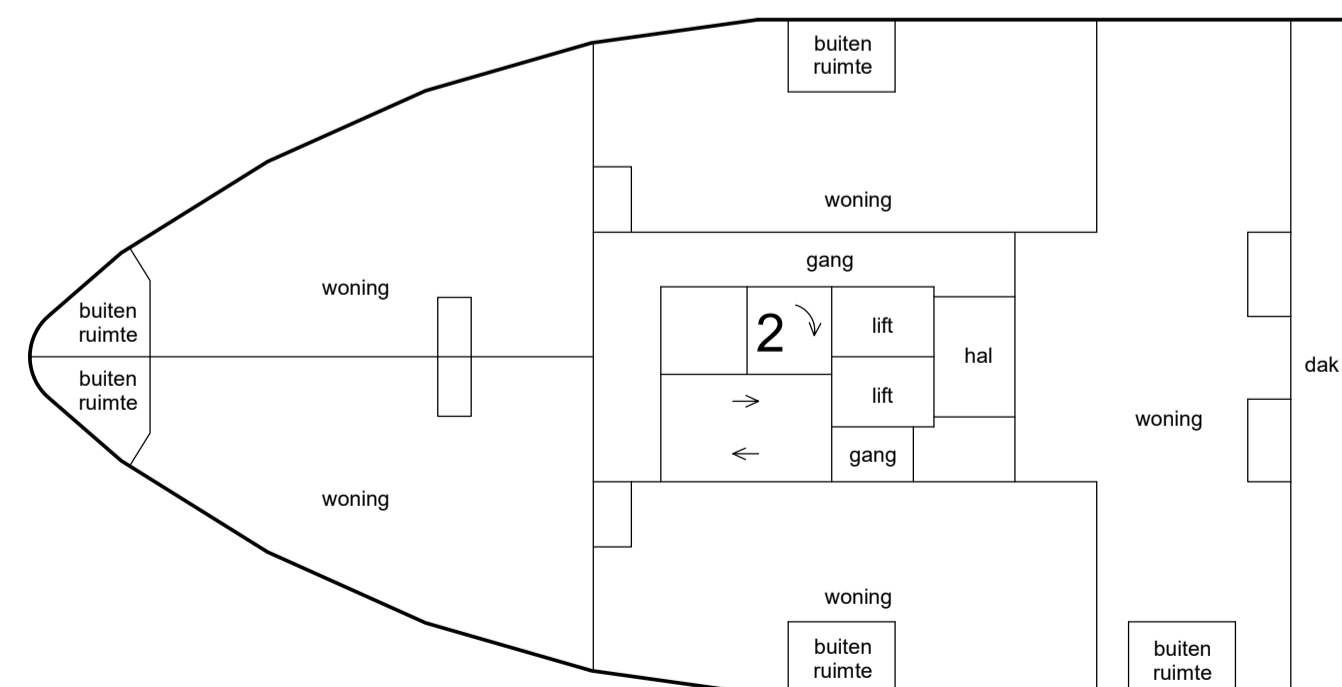
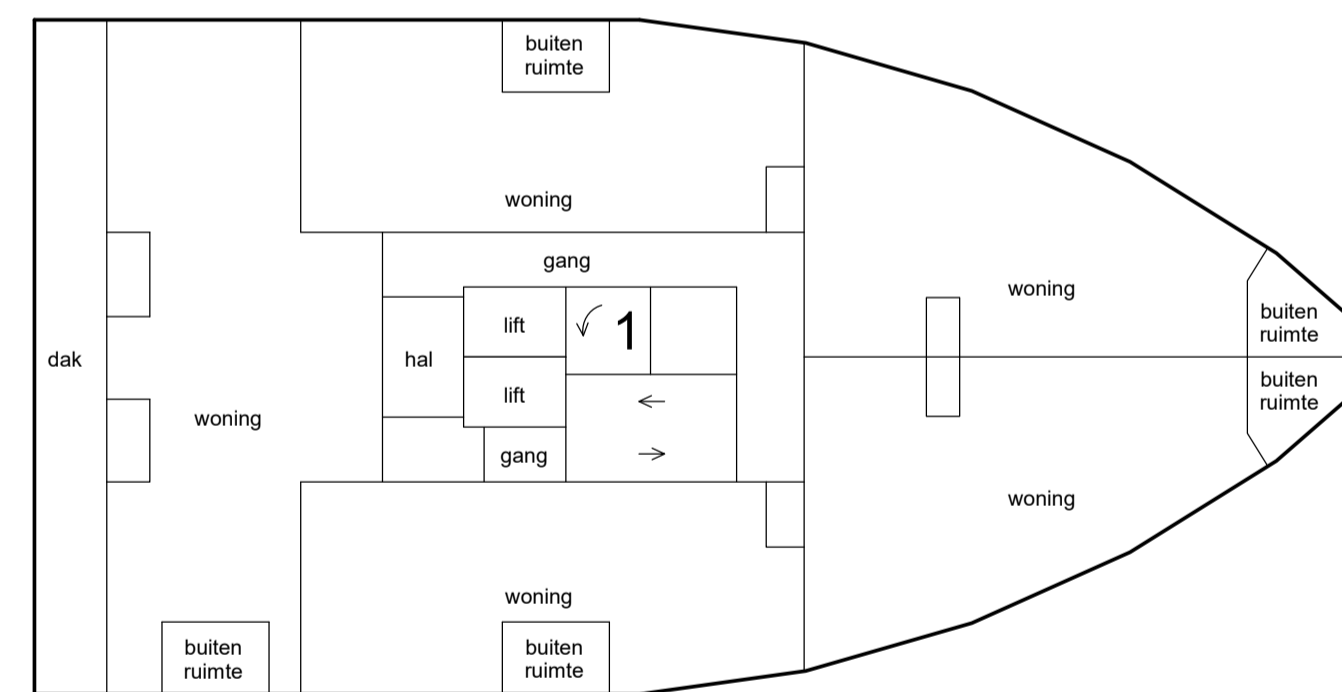

17e etage

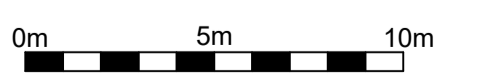

Voorgenomen splitsing in appartementsrechten van de kadastrale percelen: Woensel G 8884, 8886, 8887, 8889, 8890 en 8895

Schaal 1 : 200

■ = Gemeenschappelijk

Tekening bestaat uit 14 bladen

Blad 12

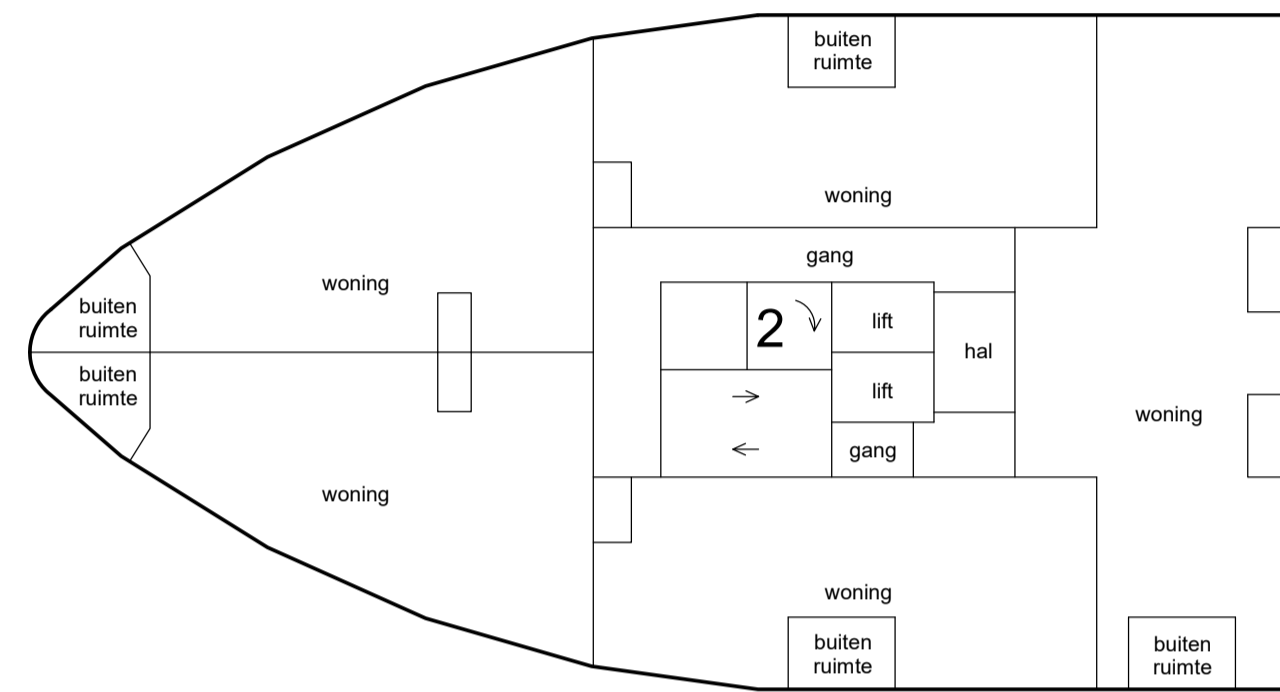
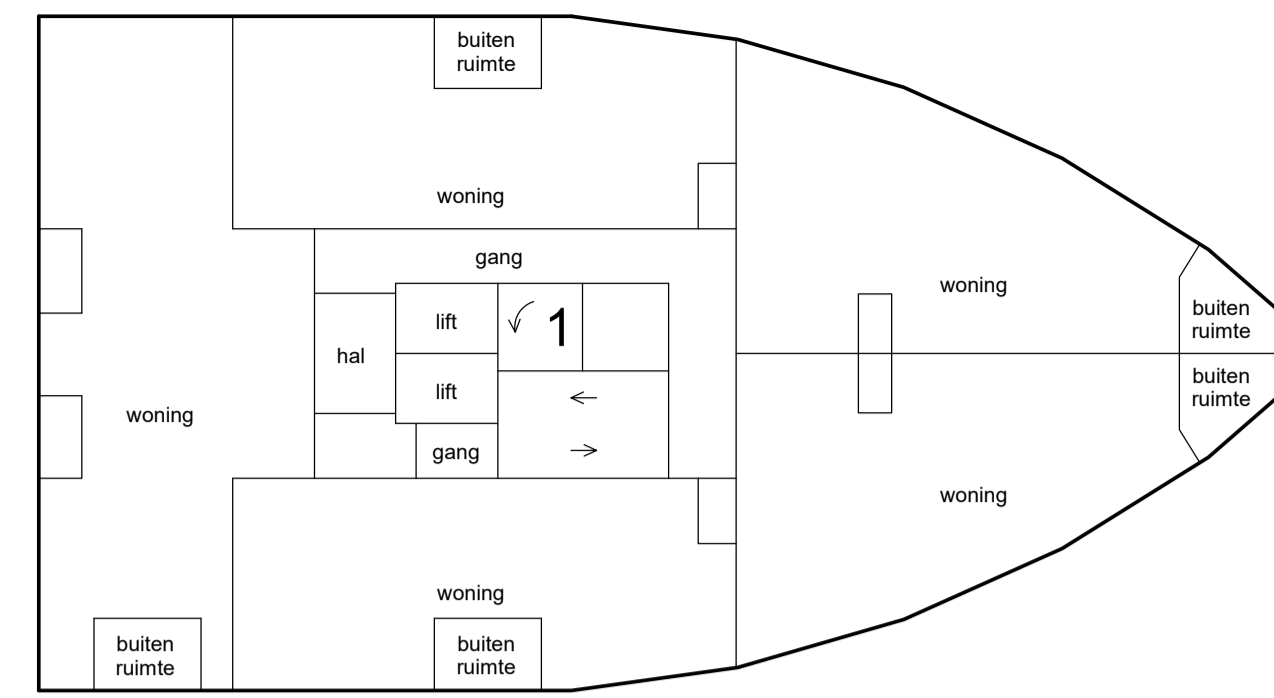

20e etage

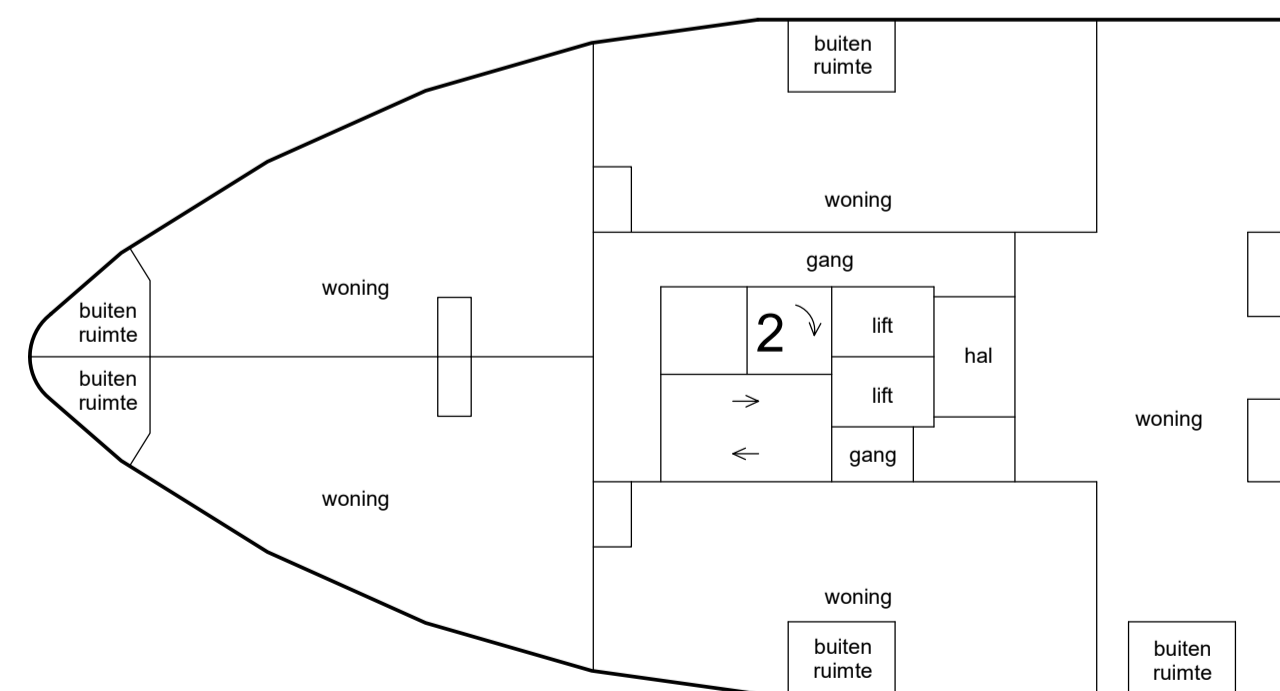
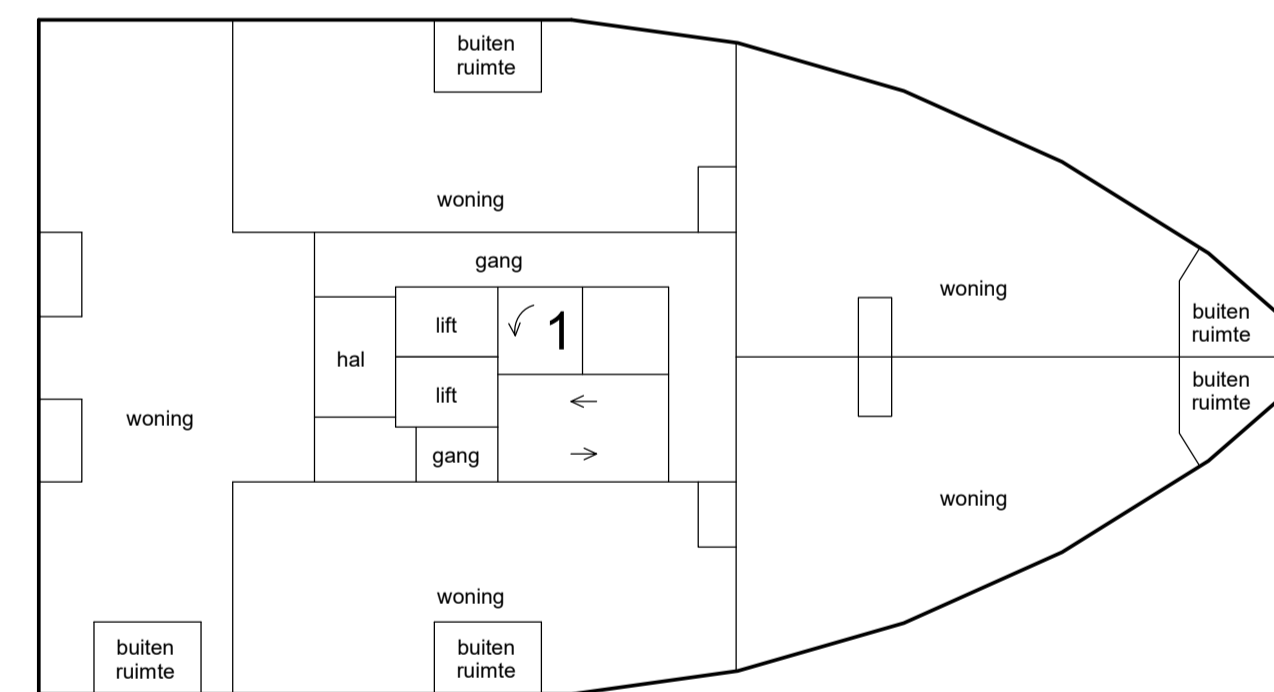

19e etage

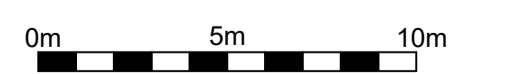
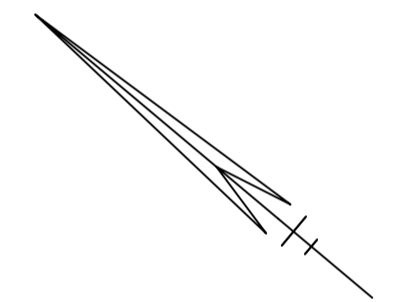

Voorgenomen splitsing in appartementsrechten van de kadastrale percelen: Woensel G 8884, 8886, 8887, 8889, 8890 en 8895

Schaal 1 : 200

■ = Gemeenschappelijk

Tekening bestaat uit 14 bladen

Blad 13

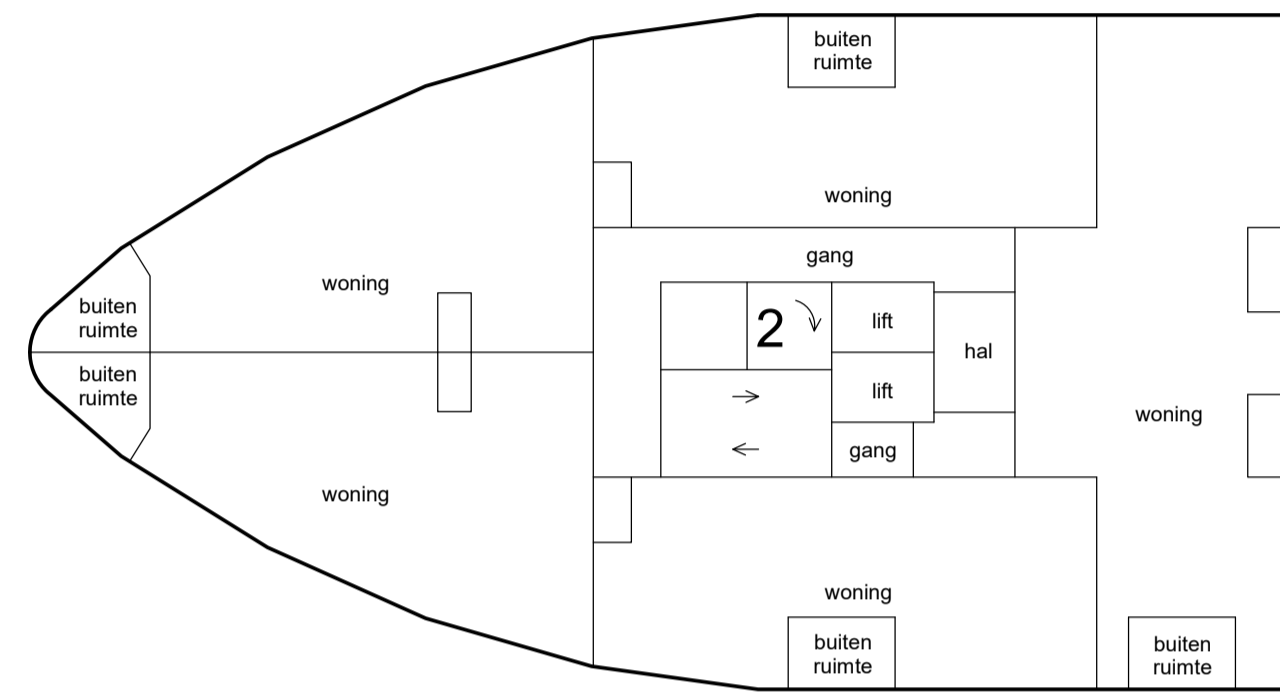
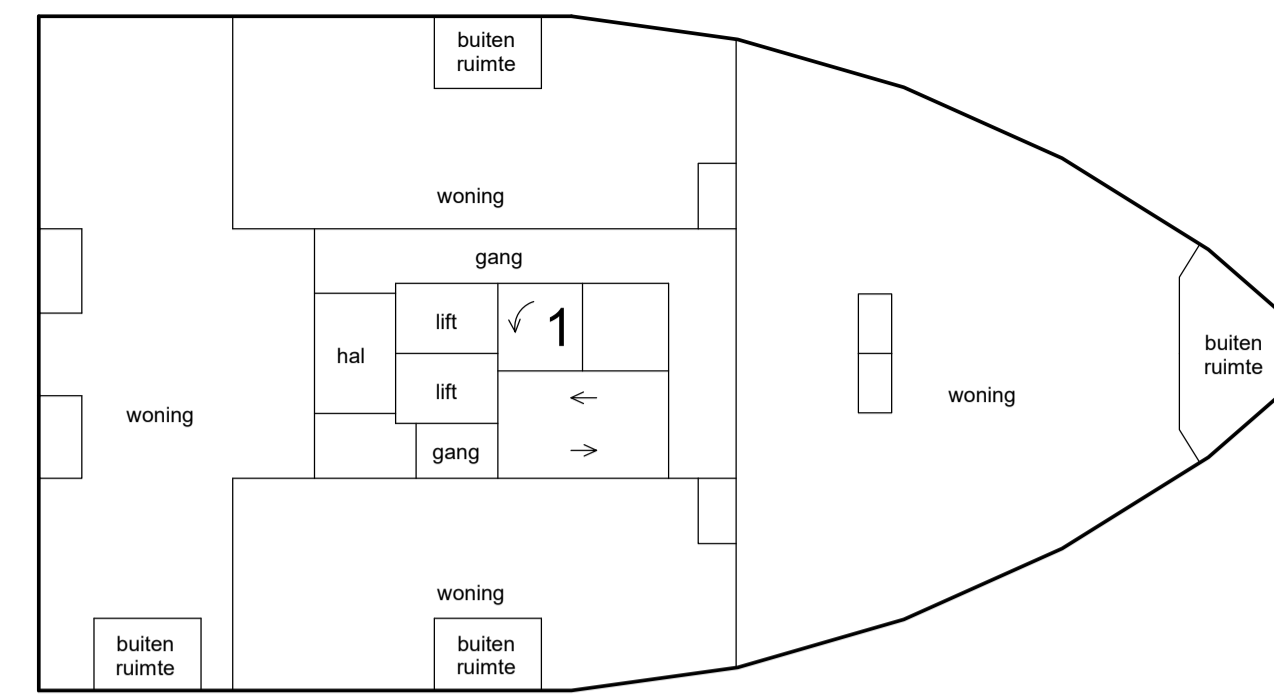

22e etage

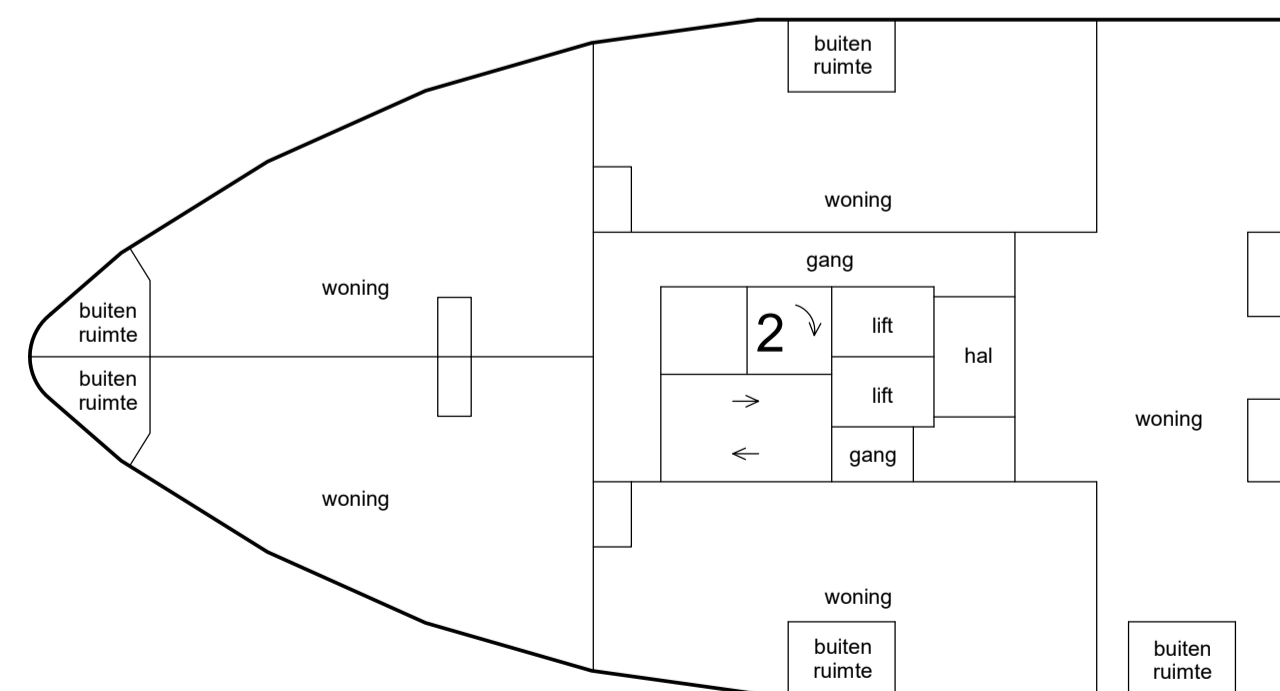
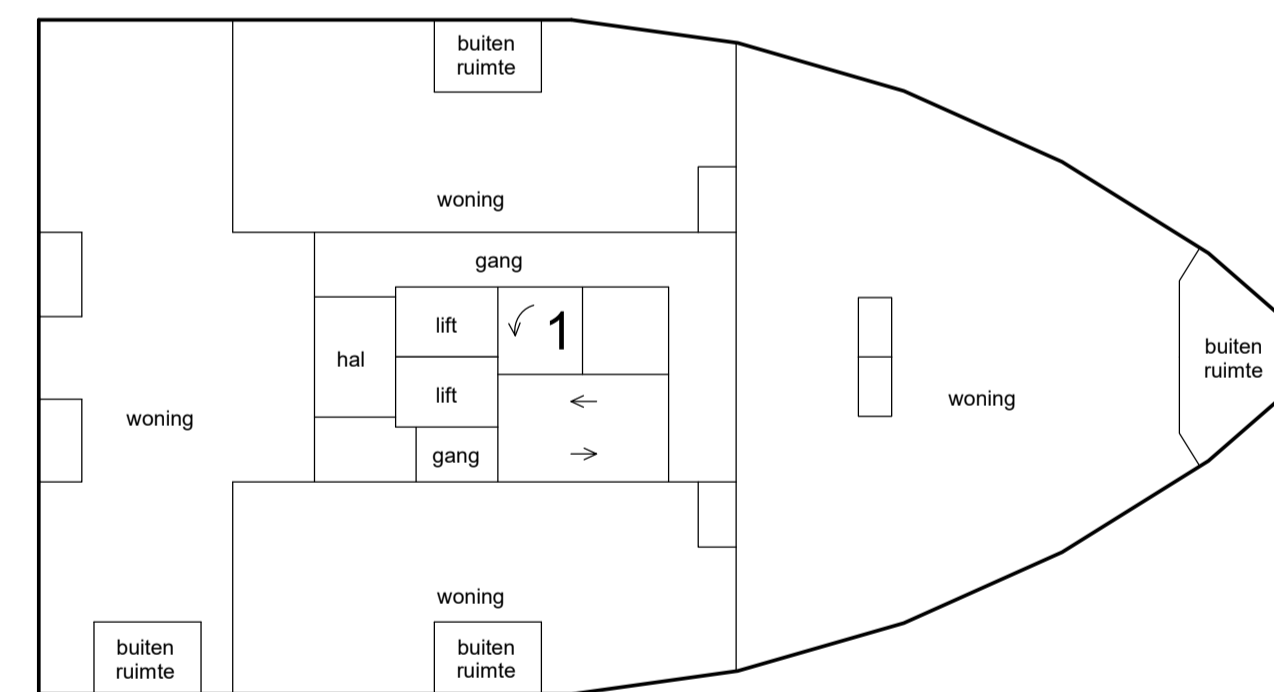

21e etage

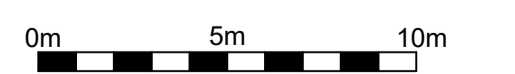
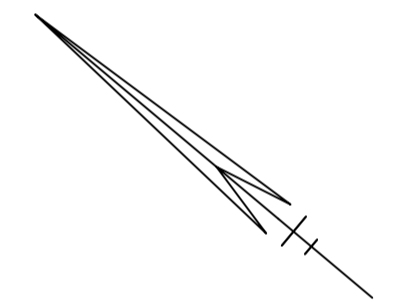

Voorgenomen splitsing in appartementsrechten van de kadastrale percelen: Woensel G 8884, 8886, 8887, 8889, 8890 en 8895

Schaal 1 : 200

■ = Gemeenschappelijk

Tekening bestaat uit 14 bladen

Blad 14

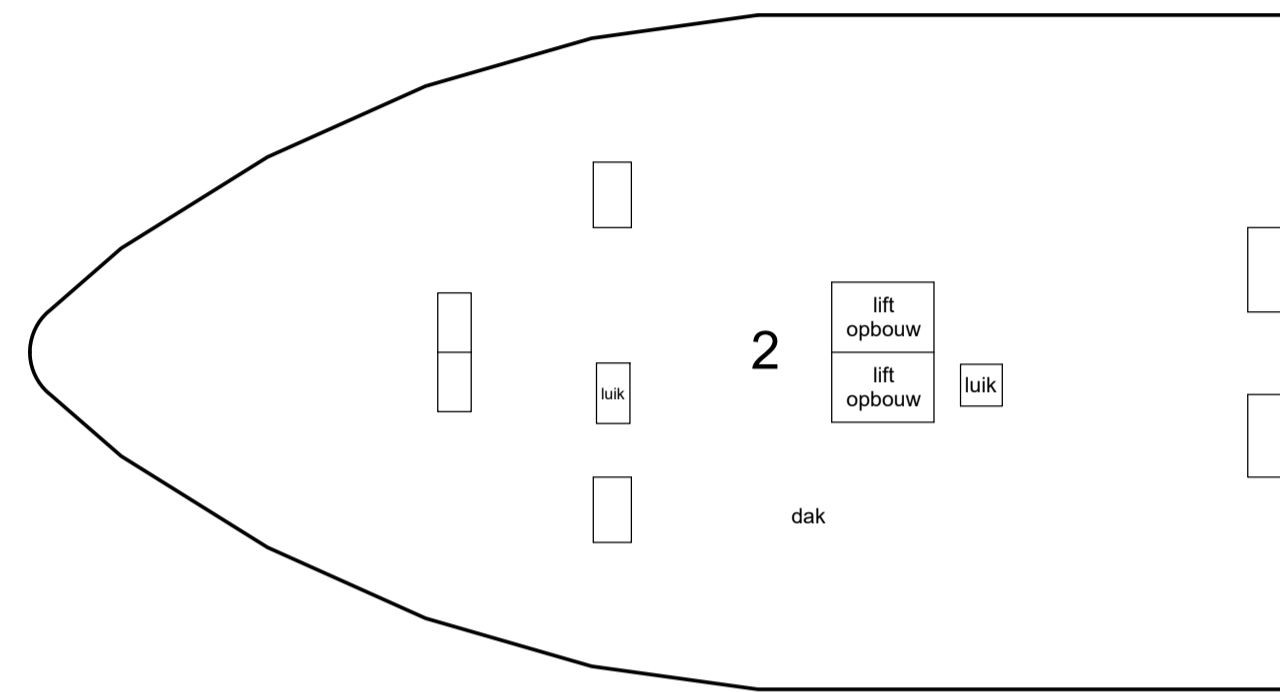
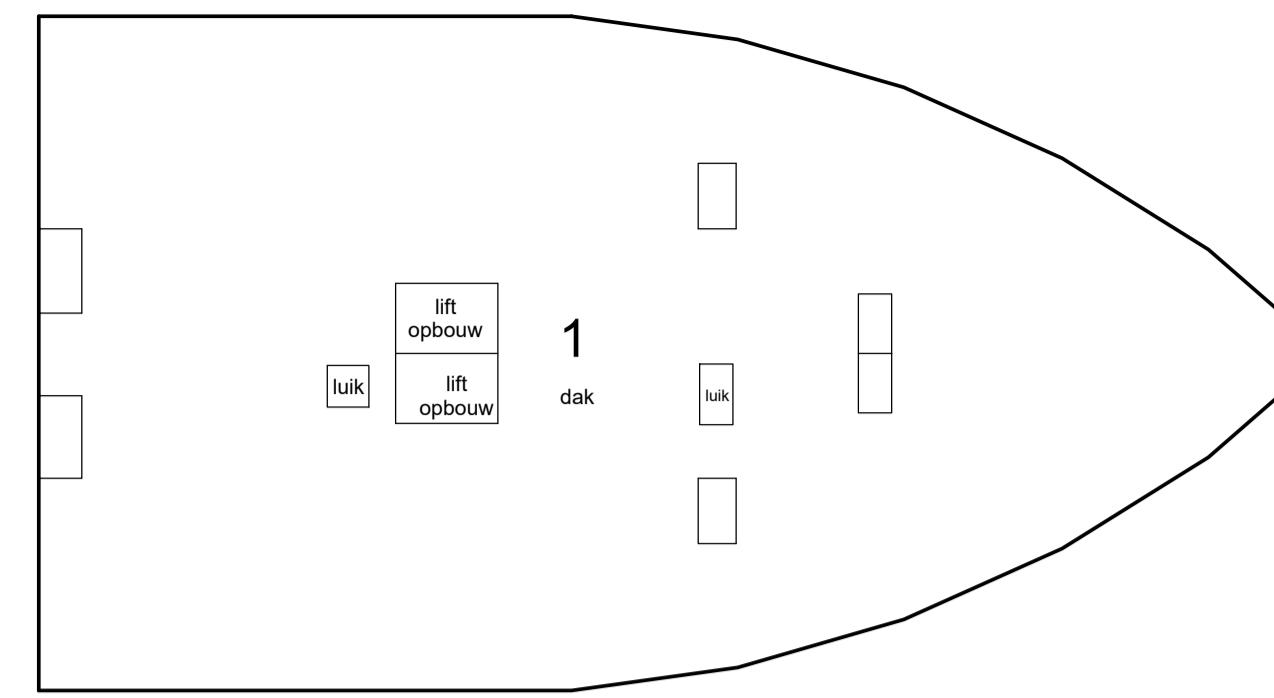

dak

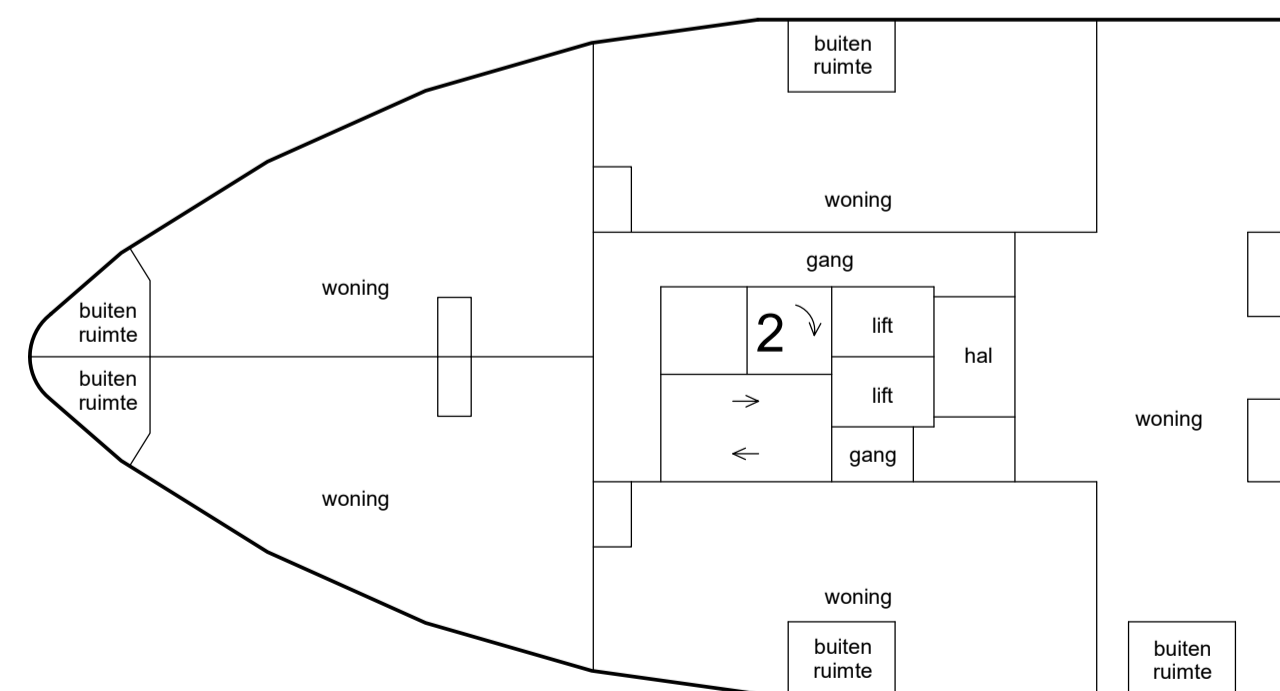
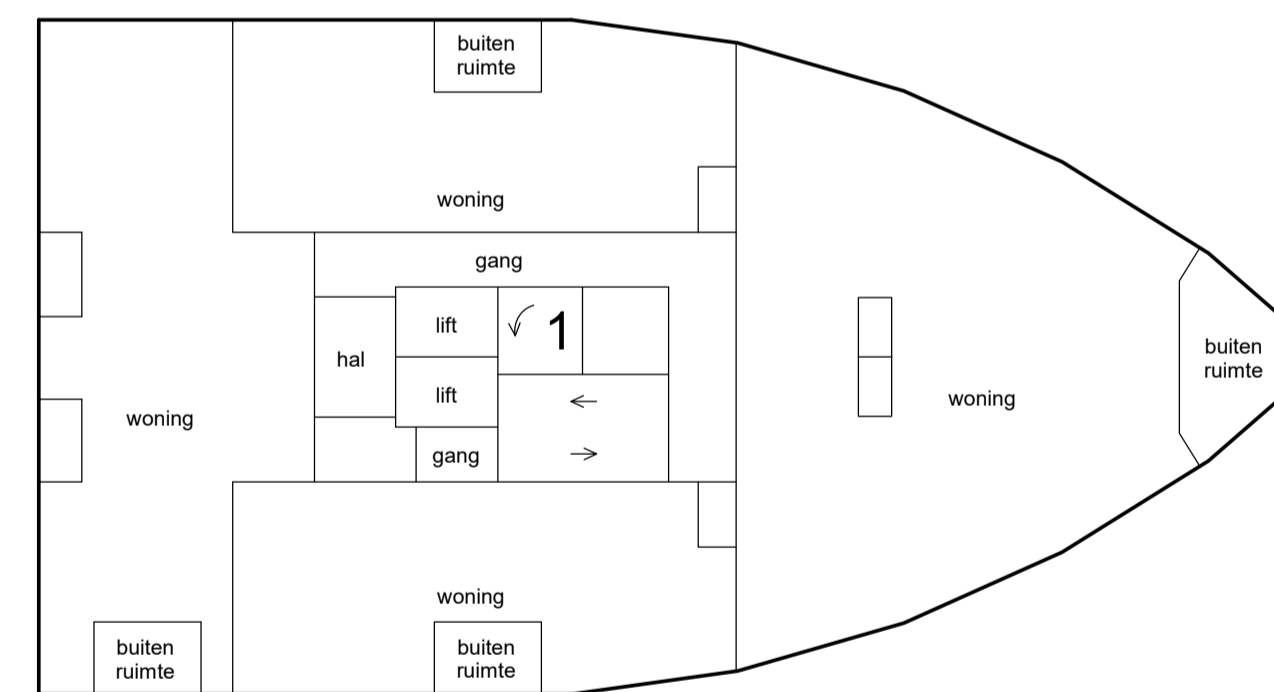

23e etage

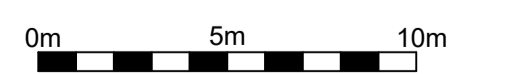

Complex Sierlijke Dames in Eindhoven
versie 12 juni 2026