

EasyLoop D.6

Vehicle detection sensor for activation or presence detection at automatic barrier systems

1

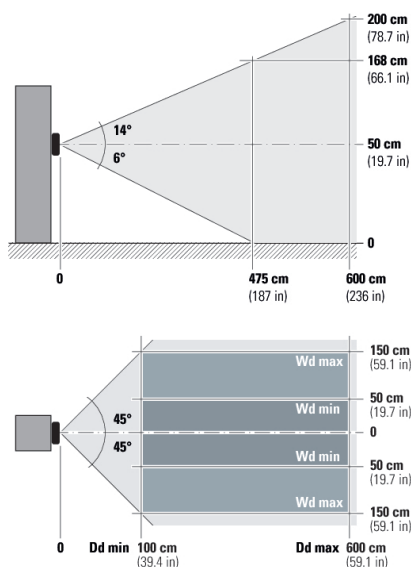

<https://www.bircher.com>

2

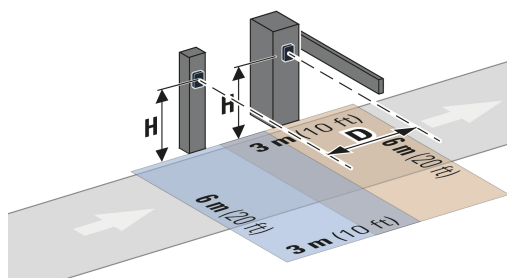

$D \geq 150 \text{ cm}$
 $D \geq 5 \text{ ft}$

$H 50 - 65 \text{ cm}$
 $H 20 - 26 \text{ in}$

3

A1

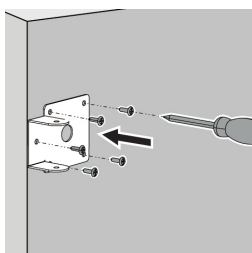

A2

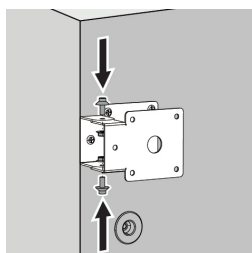

A3

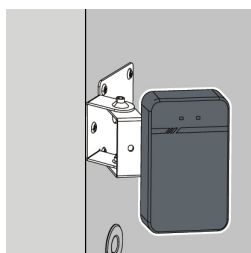

A4

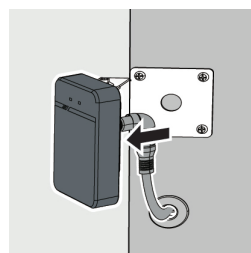

3

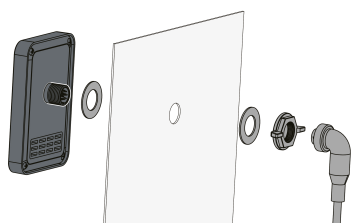

4

NC

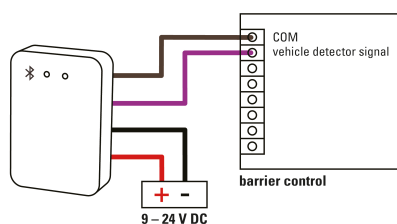

5

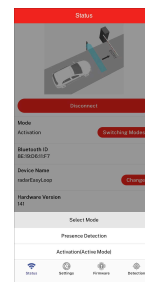

EN Safety instructions

Read the operating instructions carefully before commissioning the device. Keep the instructions for future use.

Intended use

The manufacturer is only liable for products used as intended. Only use this product for the function specified:

Vehicle detection sensor for activation or presence detection at automatic barrier systems

Personnel qualification

Only trained and qualified personnel may install and commission the device.

The installer is responsible for installing the device and the connected system in accordance with the regulations and standards.

General safety instructions

It is the responsibility of the equipment installer to carry out a risk assessment and to install the system, in compliance with applicable regulations and safety standards.

The cables must be protected against mechanical damage.

Technical data

Functional data

Function	safety (presence detection) activation (motion detection)
Transmission frequency	microwave 60 GHz
Detection depth (configurable)	90°: 1.0 – 6.0 m (3.3 – 19.7 ft) default 3 m (9.8 ft)
Detection width (configurable)	0.5 – 1.5 m (1.6 – 5.0 ft) per side
Configuration	via mobile app
Interface	Bluetooth® / RS485

Mechanical data

Housing material	PC, PBT, GF20, ABS
Dimensions (L × W × D)	108 × 74 × 18 mm (4.25 × 2.9 × 0.7 in)
Weight	131 g (4.7 oz)
Protection Class	IP66

Electrical data

Supply voltage	9 – 24 V DC (12 V / 1 A preferred)
Power consumption	< 2.5 W
Output	NO/NC dual relay
Response time	100 ms
Wiring	10 pin
Cable length	1.2 m (3.9 ft)

Ambient conditions

Operating temperature	min. -40 °C, max. 85 °C (min. -40 F, max. 185 F)
-----------------------	---

Disposal information



The product contains electrical or electronic components. Do not dispose of the product with household waste.

Notice on conformity



This device complies with Part 15 of the FCC Rules.

Operation is subject to the following two conditions:

- 1 this device may not cause harmful interference, and
- 2 this device must accept any interference received, including interference that may cause undesired operation.

Warning: changes or modifications made to this device may void the FCC authorisation to operate this device.

Technical documentation



You will find all documents on the manufacturer website
www.bircher.com

If you have any questions about the device, please contact us:

✉ salesUSA@bircher.com ☎ +1 847 952 3730

Bircher Smart Access

BBC Bircher America, Inc., 870 Pratt Avenue N.,
Schaumburg, Illinois 60193, USA
www.bircher.com