



sre

We are SRE

Building for our Sustainable Future



CEO's Message



Anna Maclean
Co-Founder & CEO

Aware of the reality of climate change and the large part the built environment contributes, my co-founder and I set up SRE in 2005. The growing climate challenge and the work we're doing to mitigate it is even more important today than it was 20 years ago.

I feel privileged to work alongside a team of talented and committed individuals and to get up each morning knowing what we are doing is making a difference.

Our shared purpose is to ensure a sustainable built environment. This, together with our values of authenticity, dedication and kindness, forms the foundation of who we are and all we do at SRE.

We are proud of the long-lasting relationships we've established with our clients in the construction and real estate sectors who are at the forefront of the drive to raise the environmental performance of buildings. Together, we are courageously leading the way in the rapidly changing sustainability landscape.

Whilst our focus has always been on delivering excellence for our clients, rather than growth, we are proud of how we've grown – not just in size, but in capability. We now deliver over 75 sustainability and building physics services and have worked on over 3,300 projects both in the UK and abroad.

I hope this portfolio gives you an overview of who we are and what we do. We've been unable to include everything here, so for more information, please visit our website www.sre.co.uk and of course, we'd love to speak with you.

An aerial photograph of a river delta, showing a complex network of channels and distributaries. The water is a light, milky color, contrasting with the darker, vegetated land. The word "Contents" is printed in a dark red, serif font in the center of the image.

Contents



1. Why SRE?

2. Team

3. Services

4. Clients

5. Projects

6. Testimonials

7. Awards



Why SRE?



SRE is a leading, independent, sustainability consultancy with a proven track record of delivering excellence. We've been supporting our UK and international clients in delivering their sustainability goals for 20 years.

Our highly trained and experienced team of sustainability and building physics specialists work with design, construction and real estate teams providing cost-effective, timely and workable solutions for their projects.

Our clients consistently comment on the positive and personable qualities of the SRE team as well as the benefits of going to a specialist consultancy for all they need to ensure their developments meet the ever more stringent requirements of sustainable design and construction.

- We deliver over 75 sustainability and building physics services.
- Over the last 20 years we've worked on over 3,300 new build and retrofit projects.
- In the last 12 months SRE has worked with 175 clients. 93% of whom were return or referral.
- We've been working with most of our clients for over 10 years.
- Our Executive Team has over 100 years of sustainability experience in the built environment!



SRE Team



Adam Tucker
Principal Sustainability Consultant



Alisha Pinheiro
Senior Building Physics Consultant



Jiale Li
Sustainability Consultant



Dominique Mole
Associate Director Operations



Manas Bane
Sustainability Consultant



Grace Boatfield
Senior Sustainability Consultant



Cara Palmer
Director



Elsa Withnell
Senior Building Physics Consultant



Jean Dib
Building Physics Consultant



Lamya Salem
Associate Director Sustainability



Miles Blagden
Sustainability Consultant



Meeradevi Kathaliyil
Senior Building Physics Consultant



Hazel Whiffen
Office and Marketing Manager



Natalie White
Head of Finance



Nikolaos Protogeros
Technical Director



Tom Martineau
Sustainability Consultant



Sophie Hopwood
Principle Consultant



Nina Craze
HR & PA to Executive Team

The background of the slide is a complex, marbled pattern in shades of brown, tan, and beige. The pattern consists of numerous irregular, wavy, and interconnected shapes that resemble a topographical map or a network of veins in a mineral. The overall effect is a dense, textured, and somewhat chaotic visual field. In the center of this pattern, the text "SRE Services" is displayed in a dark red, serif font.

SRE Services

Sustainability Standards & Methodologies

BREEAM AP

BREEAM Domestic Refurb

BREEAM International

BREEAM In-Use

BREEAM New Construction

BREEAM Refurb and Fit Out

CEMP

CRREM

DREAM

ESTIDAMA

FITWEL

Home Quality Mark

LEED

NABERS

Planning Pre-Assessment

SKA Rating

WELL

Whole Life Carbon Assessment

ESG & Net Zero

Air Quality Assessment

Carbon Baseline Report

Carbon Footprint Verification

Circular Economy Statement

Environmental Product Declaration

ESG Policy / Strategy

ESG Reporting

Green Travel Plan

Indoor Air Quality Plan

Materials Lifecycle Analysis

Net Zero Implementation Plan

Net Zero Roadmap

Nutrient Neutrality Assessment

Sustainable Procurement Plan

Sustainability Charter

Sustainability Statement

Waste Reduction Strategy

Water Neutrality Assessment

Energy & Compliance

Carbon Management Plan

Condensation Risk Analysis

Energy Statement

Energy Strategy

EPC

Heat Loss Calculation

LZC Feasibility Study

Overheating Study (Part O)

Passivhaus

Regulations Compliance

Renewable Energy Feasibility

SAP Assessment

SBEM

Thermal Bridging

U-Values Calculations

Water Assessment

Environmental Modelling

Bioclimatic Design

Dark Skies

Daylight, Sunlight & Overshadowing

Dynamic Energy Modelling

Façade Optimisation

Glint & Glare

HVAC Analysis

Internal Daylight Modelling

M&E Optimisation

M&E Specification

Microclimate Analysis

Passive Solar Design

Pedestrian Comfort

Performance Optimisation

Thermal Comfort

CIBSE TM54 Modelling

A microscopic view of plant tissue, likely a leaf, showing a network of cell walls. The cells are arranged in a somewhat regular pattern, with larger cells in the upper part and smaller cells in the lower part. The cell walls are stained a light brown color, and the overall appearance is that of a complex, interconnected network.

SRE Clients



PGIM



Precis Advisory



MORGAN CARN | ARCHITECTS

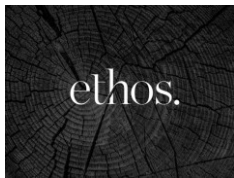

OVER 20 YEARS' ENGINEERING EXCELLENCE



Store
Property.

Brookes Architects

Hyde

H*LD
Self Storage

Matthew
Allchurch
Architects

VANGUARD

BIDWELLS

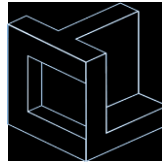

harepath

HIGHWOOD

BOUYGUES
UK

Mechanical
Services



COUNTRYSIDE
Homes

RHB
PARTNERSHIP LLP

LOVELL
PARTNERSHIPS

KINRISE

Country
Court
Our family, caring for yours

brymor
group southern

C&G
Cavendish & Gloucester



GLOBAL
SWITCH

CORDAGE
GROUP

Langtree

Dynamic
design consultants
MECHANICAL & ELECTRICAL ENGINEERS

CBRE

Legal &
General

KO
Architects

MOMENTUM

shape+

G4
PROJECTS LTD

BOWMER
KIRKLAND

Oxalis
Planning

SYSTRA

سدرة المالية
Sidra Capital

mace

LINFIELD

MATT
ARCHITECTURE





SRE Projects



Residential



Commercial



Sport



Retail

sre



Education



Industrial



Hospitality

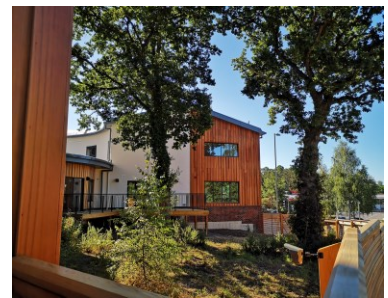

Healthcare

An aerial photograph of a complex, winding river system, likely a delta or a large estuary. The water is a light, milky color, and the surrounding land is a mix of dark and light brown tones, indicating different types of terrain and vegetation. The river channels are highly convoluted and interconnected, creating a dense network of waterways. The overall appearance is that of a natural, organic pattern. The word "Commercial" is overlaid in the center in a dark red, serif font.

Commercial



Finsbury Tower, Islington





Fenchurch Street, London





Bourn Quarter, Cambridge



Client: Aitchison Developments & Savills

Size: 305,000 sq ft

Services:

- Whole Life Carbon Assessment (WLCA)
- CIBSE TM54 Dynamic Energy Modelling
- Indoor Air Quality Plan (IAQP)
- Thermal Comfort and Overheating
- BREEAM AP
- BREEAM New Construction
- Materials Life Cycle Analysis
- Sustainable Procurement Plan
- SBEM





London Square, Guildford





Moulsecomb Way, Brighton



NTT Data Centre, Berlin



Kew Foot Road, Richmond



Wakefield Road, Richmond



Peter House, Manchester



Retail



Bremont Headquarters, Henley-on-Thames



Manor Retail Park, Rustington



Hannington Lane, Brighton

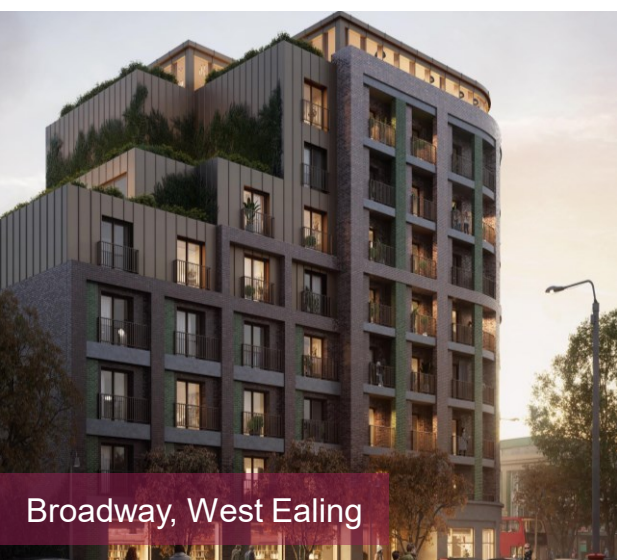

Broadway, West Ealing

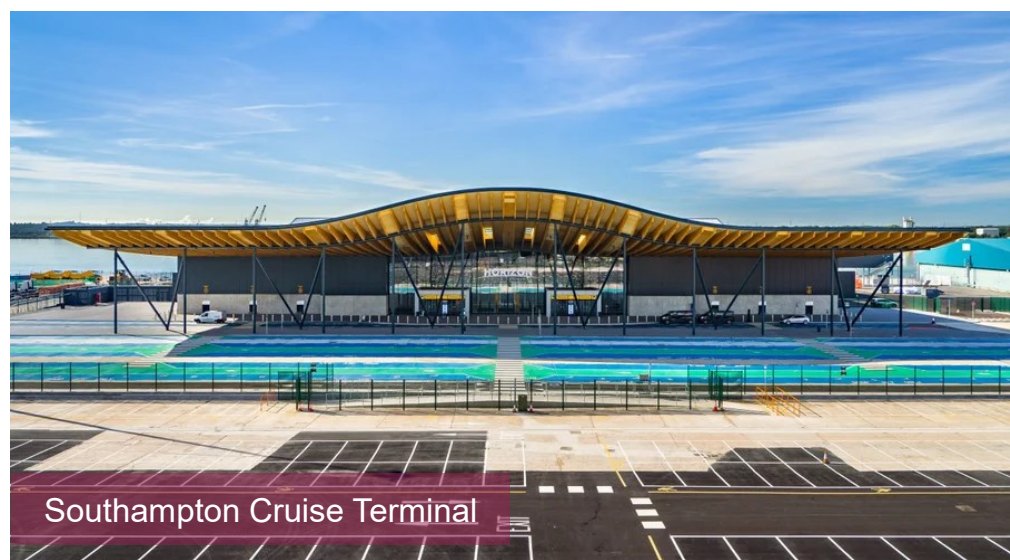

Southampton Cruise Terminal



Newhaven Marina, Brighton





Education



Eaton School. Eaton



Christ's Hospital School, Horsham



Crawley College, Sussex



Admiral Lord Nelson School, Portsmouth



Institute of Marine Sciences, Portsmouth

An aerial photograph of a complex, winding river system, possibly a delta or a large estuary. The water is a mix of light and dark tones, indicating varying depths and sediment levels. The channels are highly convoluted and interconnected. In the center of the image, the word "Industrial" is written in a bold, dark red font.

Industrial



Kiklo Spaces, Petersfield



North Circular Road, Vanguard



Storage King, Heathrow



Access Self Storage, Wandsworth



East Horton Business Park, Eastleigh



Chiltonian Industrial Estate, Lewisham



Adanac Park, Southampton



Tech Edge, Harwell



HOLD Self Storage, Chiswick



Platinum Jubilee Business Park, Ringwood



Cathedral Hill Industrial Estate, Guildford





Client: Savills

Size: 93,938 sq ft

Services:

- Whole Life Carbon Assessment (WLCA)
- Dynamic Energy Modelling
- Indoor Air Quality Plan (IAQP)
- Thermal Comfort Analysis
- BREEAM AP
- BREEAM RFO
- SBEM
- Low and Zero Carbon (LZC) Feasibility Study
- Daylight Calculations
- Climate Change Adaption Strategy
- Glint & Glare Assessment





Shinfield Studios, Reading





Client: Bidwells

Size: 929,000 sq ft

Services:

- Indoor Air Quality Plan (IAQP)
- BREEAM AP
- BREEAM New Construction
- Passive Design Analysis
- Materials Life Cycle Analysis





Hospitality



Nobu Hotel, London



Holiday Inn Express, Greenwich



Premier Inn, Sandyford



Premier Inn, Ringwood



Beach Hotel, Worthing





Sunswept Resorts, Portugal





Sport



The Nest, Hayes



Baffins Football Club, Portsmouth



Fossetts Farm, Southend-on-Sea



Hornchurch Leisure Centre, Romford



University of Brighton Sports Pavilion, Brighton



Forge Wood Sports Pavilion, Crawley



Moneyfields Sports & Social Club, Portsmouth



Gatton Manor & Golf Club, Dorking

An aerial photograph of a complex, winding river system, possibly a delta or a large estuary. The water is a light, milky brown color, and the surrounding land is a darker, textured brown. The river channels are highly convoluted and interconnected, creating a dense network of waterways. The overall appearance is that of a natural, unregulated water system. The word "Residential" is overlaid in the center in a dark red, serif font.

Residential



Godson Street, London



Fruit and Vegetable Market,
Southampton



Huf Haus, Weybridge



Market Street, Bracknell



Cambridge Road Estate, Kingston



New Malden High Street,
Kingston Upon Thames



Kingston Wharf, Shoreham by Sea



Hanneys,
Chichester



Neal Drive,
Cambridge



Boone Street,
London



Alpine Place, Brent



Root's Hall, Southend-on-Sea



Garden Road, Richmond



Chanry Quarry, Guildford



Hatch Farm, Eastleigh

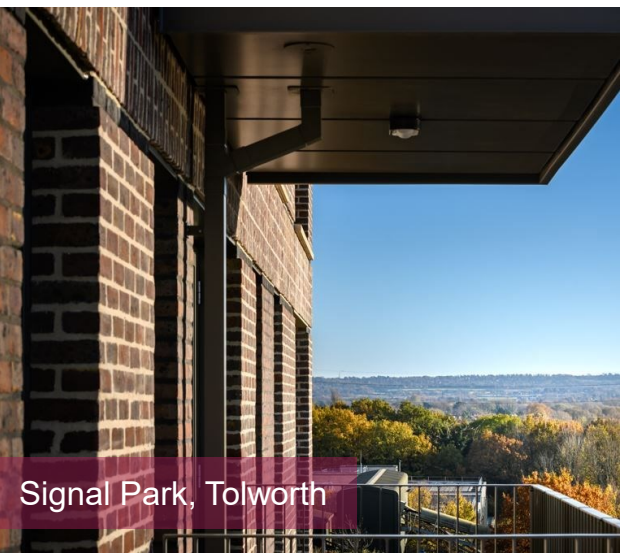
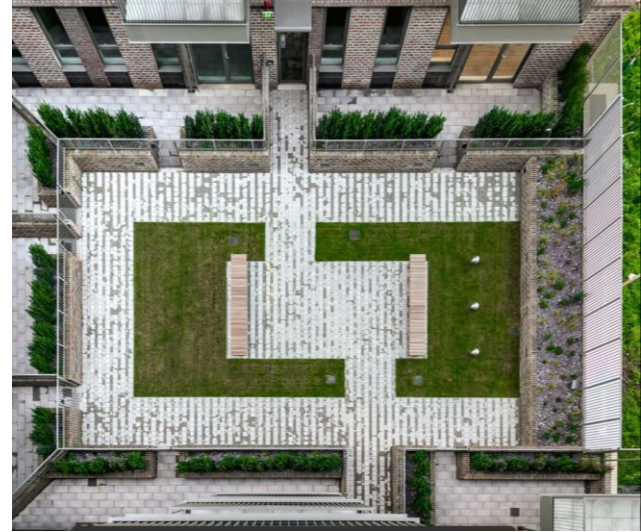

Signal Park, Tolworth

The image shows a microscopic view of plant tissue, likely a vascular bundle. The cells are arranged in a network, with some cells having thickened walls, characteristic of sclerenchyma or collenchyma tissue. The overall structure is a complex, interconnected grid of cells.

Healthcare



The Firefly Club, Bordon



Somerstown Community Centre, Portsmouth



Wellingtonvale Care Home, Waterlooville



Horndean Care Village, Waterlooville



North Stoneham Park, Eastleigh



Macmillan Hospice, Christchurch Hospital



Rivermead Court, Egham



Kingston Rehabilitation Centre, Kingston

The background of the slide is an aerial photograph of a river network, likely the Amazon basin, showing a dense web of channels and floodplains. A semi-transparent map of the same region is overlaid on the photograph, with the river channels highlighted in a light beige color. The text 'SRE Testimonials' is centered in a dark red font.

SRE Testimonials

“We have worked with SRE for many years, benefiting from their invaluable asset advice, energy reviews, comprehensive design analysis, whole life carbon assessments and ongoing performance monitoring. On our latest project – the UK’s first on-site Net Zero Carbon industrial refurbishment – SRE’s insight and strategies were pivotal in achieving A+ EPC ratings, operational Net Zero Carbon and award-winning recognition.”



Nick Ireland
Director, Savills

“SRE are an invaluable partner in achieving our sustainability objectives as they guide us through various complex retrofit projects. With unparalleled knowledge and expertise in sustainability, SRE’s advice is clear and actionable. They consistently exceed our expectations.”



Matthew Hills
Managing Director,
Sidra Capital

“Our collaboration with SRE has been invaluable. Their extensive knowledge and expertise have proven to be instrumental in tackling environmental assessments and compliance challenges. The team at SRE are highly approachable and always ready to offer valuable advice and support. We wholeheartedly recommend their services without hesitation.”



Jo Buckley
Executive Director, PGIM

“We have worked with SRE for over nine years and continue to enjoy an excellent professional relationship. SRE’s professional, friendly approach, along with extensive in-house knowledge consistently exceeds our requirements.”



Henrik Foster
Executive Director, Qiddiya

“Since 2020, SRE have offered clear and highly constructive guidance on the projects we’ve collaborated on, providing swift turnaround times crucial to the project’s success.”

Paul Henry
Director, DP9



“I have worked with SRE for over 12 years. They are consistently a safe pair of hands in respect to identifying and managing environmental risk on projects and keeping to timetables and fees, so for every job, they give me at least three less problems to worry about.”

Greg Dowden
Director, WSP



“Storage King have always been pleased by the service, professionalism and knowledge of the team at SRE. SRE have assisted us on a variety of projects since 2012 and provide clear, cost-effective advice for our schemes. We look forward to continuing our relationship with SRE on future Storage King projects.”

Emma Chesterton-Kay
Head of UK Property,
Storage King



“SRE’s team is exceptionally proactive. They always think ahead and find innovative solutions to whatever challenge we face as a design team. Their technical expertise is impressive, and they work with both precision and a positive attitude. They’re not only reliable and thorough but consistently bring a collaborative, friendly energy that makes working with them a pleasure.”

Jordan Gill
Principal Architect, SYSTRA



“We have worked with SRE for over nine years and continue to enjoy an excellent professional relationship. The team’s in-depth knowledge of sustainability, environmental technologies and the green agenda is unrivalled. SRE is a core team member from the outset of our projects, which has enabled us to achieve a 100% success rate on all our BREEAM targets.”

James Creevy
Senior Construction Manager,
McLaren Property



“We have worked with SRE on over 100 projects since 2009 and it has been an absolute pleasure. From design stage to post completion, their proactive approach is always extremely helpful. They have worked with us on a large residential development in Portsmouth and their advice was instrumental to achieving the regeneration status and winning the Regeneration Project of the Year at The South Coast Property Awards 2019.”

Stephen Cripps
Managing Director, PMC



“We have worked with SRE on numerous projects since 2009 and have found their knowledge and expertise to be both broad and useful. SRE’s early input has assisted in developing solutions to the problems faced in environmental assessments and compliance. We have found the personnel at SRE to be very approachable and helpful, offering advice and assistance where required and we would have no hesitation in recommending their services.”

Shaun Slack
Technical Director,
KSA Architects



“Having worked with SRE for over 15 years on a number of development projects, we find them to be professional, reliable and their knowledge of the sector is unrivalled. They continuously provide a thorough service, advising on all sustainability and energy matters throughout the various stages of our schemes.”

Annie Kuch
Asset Manager,
Precis Advisory



A microscopic view of plant tissue, likely a leaf or stem, showing a complex network of cell walls. The cells are arranged in a somewhat regular, grid-like pattern, with some larger, more elongated cells interspersed among smaller ones. The overall appearance is that of a dense, interconnected cellular structure.

Awards



Cathedral Hill Industrial Estate, Guildford – Guildford Design Awards 2023



Brewery House, Portsmouth – AJ Retrofit & Reuse Awards 2024



Honeypot Lane, London – Housing Design Awards 2024



Lewes Road, Brighton – Offsite Construction Awards 2018



St John's, Tunbridge Wells – Housing Design Awards 2024



Buckhold Road, Wandsworth –
International Property Awards 2020



Hannington Lanes, Brighton –
Sussex Heritage Trust Awards

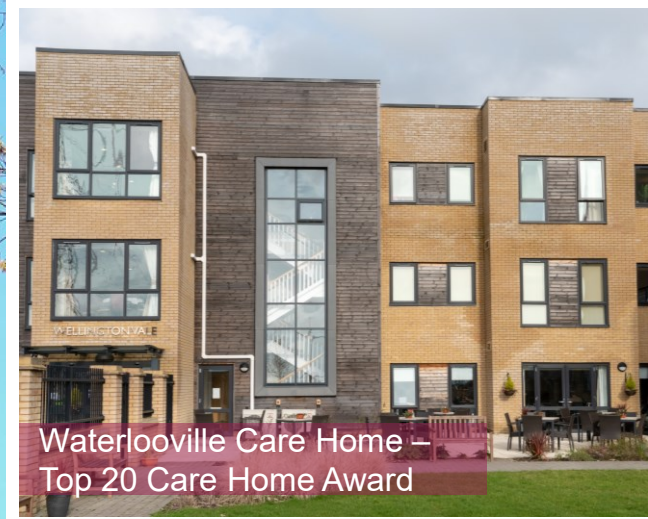

Waterlooville Care Home –
Top 20 Care Home Award



Burgess Park Care Home, Camberwell
– Leaders in Care Awards

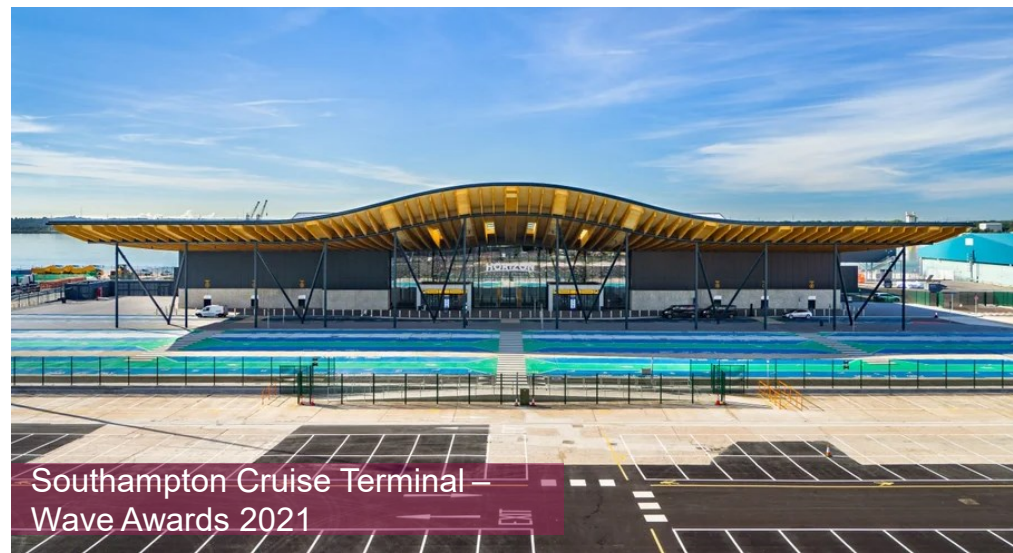

Southampton Cruise Terminal –
Wave Awards 2021



8 Bishopsgate, London – TBUH
Award of Excellence 2024



Park Farm CRCC, Stoneham –
Solent Quality Place Award 2022



Netley Court –
Top 20 Care
Homes 2020



Broadoaks, West
Byfleet –
WhatHouse?
Awards 2023



Hythe & Dibden
Hospital – AJ
Architecture
Awards 2023

A close-up photograph of a leaf, showing a complex network of veins. The veins are light-colored and form a dense, interconnected pattern against a darker background. The veins are arranged in a hierarchical structure, with larger veins branching into smaller ones. The overall appearance is that of a natural, organic structure.

Contact Us:

Email: info@sre.co.uk

Website: www.sre.co.uk

Phone: + 44 (0)1730 710044