



Introducing Sedgeby Solar Farm

September 2025

Introduction

We are introducing our proposal for Sedgeby Solar Farm, known as “Sedgeby”, a new solar farm with battery storage in North Yorkshire, near the villages of Sessay, Little Sessay, and Thormanby.

The proposed solar farm could generate up to **350 Megawatts (MW) of electricity, enough to power approximately 210,000 homes*, or just over two thirds of households in North Yorkshire.** The project would connect into the National Grid at a new substation.

Sedgeby is being brought forward by BayWa r.e UK Ltd., a trusted renewable energy developer with extensive experience in developing, building and operating solar, wind and battery storage projects across the UK.

We are still at an early stage of developing our proposal for Sedgeby and are holding our first community consultation period from **2nd October to 13th November 2025.** **All consultation information will be on our website from 2nd October,** and we are holding two public events where you can talk to us about the proposal and give us your feedback.

The dates and locations for the in-person events are:

Thursday 16th October, 4pm – 8pm
Raskelf Village Hall, York Road,
Raskelf, YO61 3SD

Friday 17th October, 4pm – 8pm
Sessay Village Hall,
Sessay, YO7 3BE

Your feedback is very important and will help to shape the proposal as they evolve. We encourage you to attend the public events and complete a feedback form by **11:59pm on 13th November.**

On the following pages, you can learn more about the proposal and how to take part in our community consultation.

***Full details on the calculations can be found on the project website**



0203 667 4503



info@sedgeby-solar.co.uk



sedgeby-solar.co.uk

Why do we need Sedgeby Solar Farm?

Energy is essential to our daily lives, powering homes, businesses, and transportation, while also driving innovation and economic growth.

Much of the UK's electricity has traditionally come from fossil fuels like coal and gas which have shown to be major contributors to climate change. The UK has already made great progress and after more than 140 years, the last coal power station at Ratcliffe-on-Soar closed last year.

However, as demand for electricity keeps rising, **more renewable energy is needed** to meet future demand and reduce reliance on imported electricity.

Battery energy storage also has a vital role to play as part of Sedgeby. The batteries allow for the storage of electricity and can then release it at times when it is most needed. That means that our homes and businesses can continue to be powered by renewable energy, even after sunset.

The UK is well suited for solar power. Modern panels can still generate electricity even on cloudy days, and rain helps keep them clean and cool.

Components of a Solar Farm

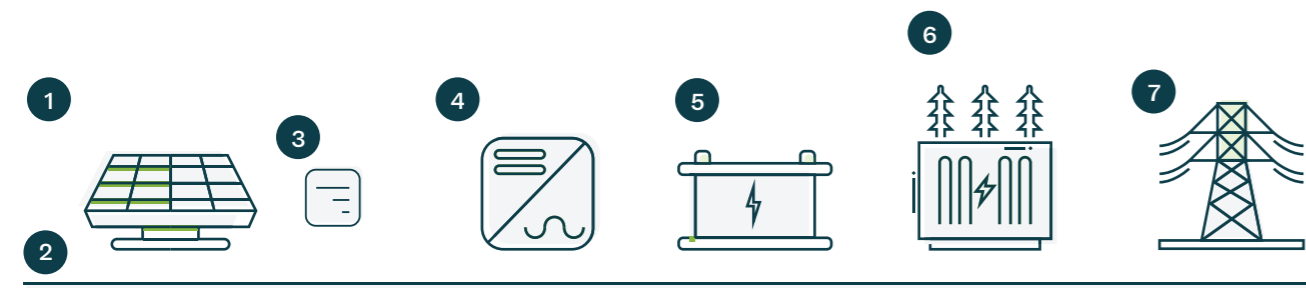

- 1 Solar Panels
- 2 Underground Cables
- 3 Inverters
- 4 Transformer
- 5 Battery Energy Storage System
- 6 Substation
- 7 National Grid Connection

This diagram shows the main elements that typically make up a solar farm. It is not to scale and for indicative purposes only.

Why here?

Connecting to the grid

One of the most important factors when choosing the location of a solar farm is how it connects to the electricity network, known as the National Grid. The National Grid links power stations and renewable projects to homes and businesses across the UK, through a network of substations and pylons.

For a project to go ahead, there must be space available on the network to connect the new power source. BayWa r.e UK Ltd. has already secured a confirmed connection agreement with National Grid at a future substation that has available capacity.

Finding the right land

Once a grid connection was secured, local landowners were approached to identify sites that would be suitable for solar. This means sites with gentle slopes, good levels of sunlight and minimal impacts on food production.

None of the land proposed for Sedgeby currently grows crops for direct human consumption. Most of the land is used to grow crops for two nearby biomass plants, with the rest grown for animal feed.

Together, these factors (and many others) make the location of Sedgeby a **good site for a solar farm** — with the right land, the right conditions, and a guaranteed connection to the grid.

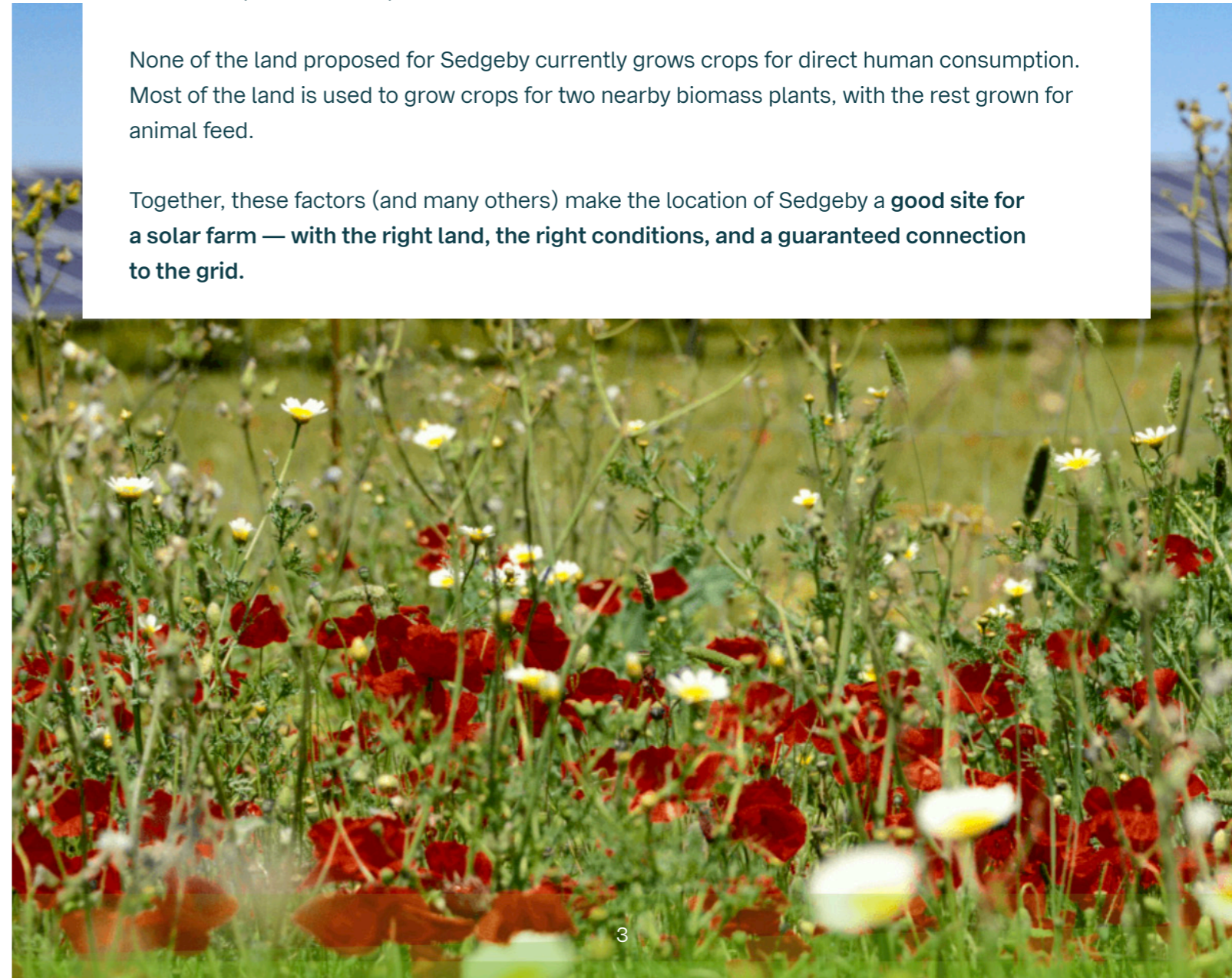

Sedgeby Solar Farm location

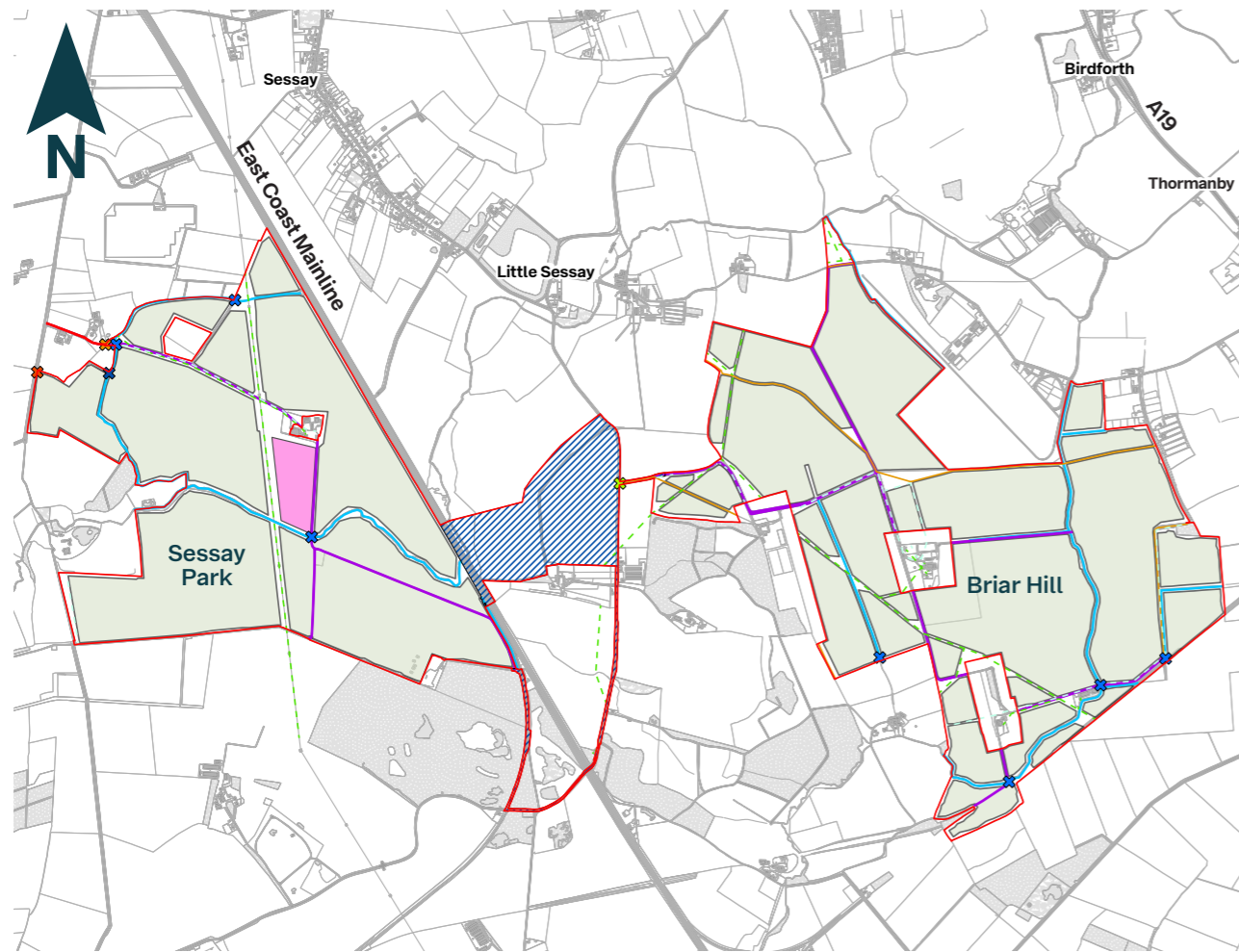

The plan shows the area currently being considered for Sedgeby. Not all of this land will be used for solar panels, battery energy storage or further infrastructure. Parts of the site will be set aside to protect and enhance local wildlife and improve biodiversity, and buffers will be created around homes and public rights of way.

We are at an early stage of development. We're working closely with independent technical experts across a range of environmental disciplines, and will listen to feedback from the local community — both of which are essential in shaping a design that respects the local landscape.



Our approach to design

Sedgeby will be designed sensitively, respecting both the local environment and community. Solar farms can provide space for wildlife to thrive, as they are quiet, chemical-free, and require minimal maintenance. There is also potential for continued agricultural use, such as sheep grazing around and under the solar panels.

A series of environmental surveys have been undertaken to help shape the design, ensuring the project supports biodiversity and respects its surroundings. Opportunities to improve existing footpaths are also being explored, **with proposals guided by community feedback.** These steps aim to ensure the project not only generates clean electricity but also delivers lasting benefits for both people and nature.

- Some of the key environmental matters that we are investigating include:
- Agricultural land and soils
 - Ecology
 - Ornithology
 - Heritage and archaeology
 - Glint and glare
 - Landscape and visual amenity
 - Noise
 - Socio-economics and health
 - Traffic and transport
 - Hydrology



Understanding the EIA process

A full **Environmental Impact Assessment (EIA)** will support the project. This is a detailed study of the potential effects of the solar farm on people, wildlife, and the environment.

- An EIA Scoping Report is currently being prepared by independent, qualified experts. This document sets out the surveys and methods that will be used, following industry standards.
- The Scoping Report will be submitted to the Planning Inspectorate (PINS).
- PINS will then consult statutory bodies such as the Environment Agency and Natural England. Initial discussions have already been held with these bodies to gauge their views on the proposal.
- Their feedback, called a Scoping Opinion, will guide the content of the full EIA.
- A full EIA will be submitted as part of the DCO (Development Consent Order) application.

The EIA process ensures that any potential effects are properly understood and addressed before the project can go ahead.

Planning process

As Sedgeby has an agreed grid connection over 100 MW, it is classed as a **Nationally Significant Infrastructure Project (NSIP)**. For projects of this size an application for a DCO is required and decided by the Secretary of State for Energy Security and Net Zero. North Yorkshire Council will also play a role as a consultee.

Consultation is central to the NSIP process. We will be engaging with local communities, statutory consultees and technical experts at North Yorkshire Council throughout the project's development. There will be two rounds of community consultation before the DCO application is submitted. We will use the feedback we receive in Stage One to develop our plans presented in Stage Two.

Current project timeline:

These dates are subject to change.

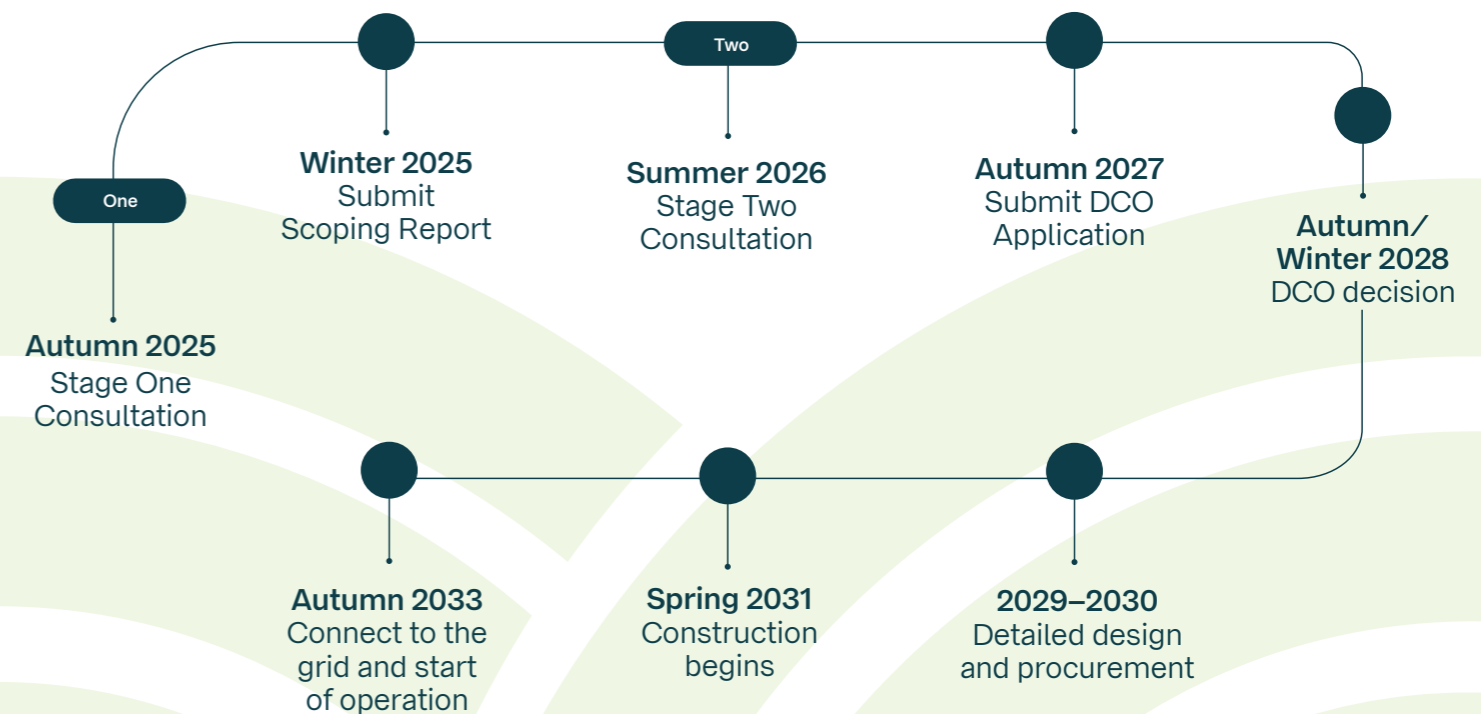

For more information about the planning process for NSIPs on PINS visit, please scan the QR Code:



Community consultation

The Stage One Consultation for Sedgeby Solar Farm is open from **Thursday 2nd October to Thursday 13th November 2025**. During this time, you can learn more about our early proposal, how we plan to assess environmental impacts, and the potential benefits for the community, including details of a community benefit fund.

All consultation materials will be available on the project website from 2nd October:
sedgeby-solar.co.uk

The dates and locations for the in-person events are:

Thursday 16th October, 4pm – 8pm
Raskelf Village Hall, York Road,
Raskelf, YO61 3SD

Friday 17th October, 4pm – 8pm
Sessay Village Hall,
Sessay, YO7 3BE

Following the in-person events, the consultation period will continue for several weeks, giving everyone the opportunity to provide feedback on the early plans.

Get in touch:



0203 667 4503 (Monday to Friday, 9am - 5pm)



info@sedgeby-solar.co.uk



sedgeby-solar.co.uk



FAO Sedgeby Solar Farm, FREEPOST SEC Newgate UK Local



sedgeby-solar.co.uk