

It is recommended to place a strip of masking tape across any area where you will be marking the door or drawer so that it can be easily removed if you make a mistake.

drawer drilling instructions

1.

Mark the middle point of the drawer on the previously applied masking tape.

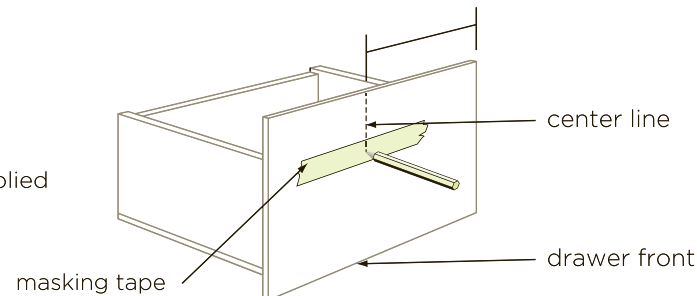

2.

Place the template on the drawer so the lip of the template is sitting on the top of the drawer panel. Line up the centre line on the template with the line you have marked on the tape.

For a cutlery drawer use the holes marked 'Cutlery Drawer', for a pot drawer use the holes marked 'Pot Drawer'.

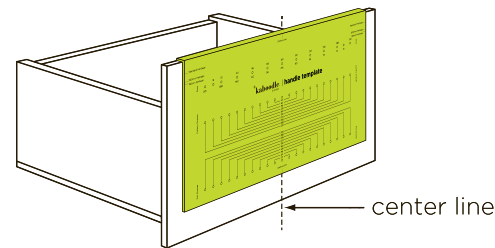

3.

Find the size of your handle on the list running across the middle of the template, the lines guide you to which holes to use. Mark both holes with a pen.

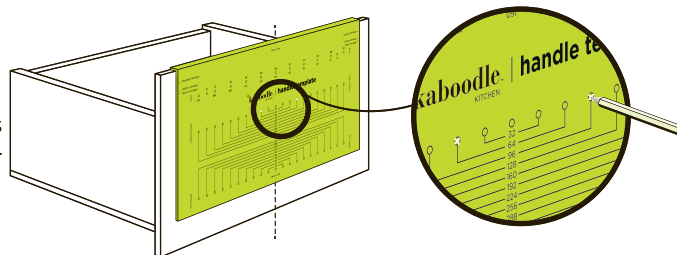

4.

Remove template and use a 4.5mm drill bit to drill a hole through both points marked on the door.

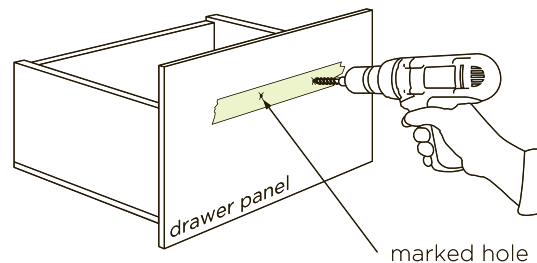

modern door drilling instructions

1.

Place the lip of the template against the side of the door of which you want to install the handle.

Note: Make sure the top of the template is flush with the top of the door.

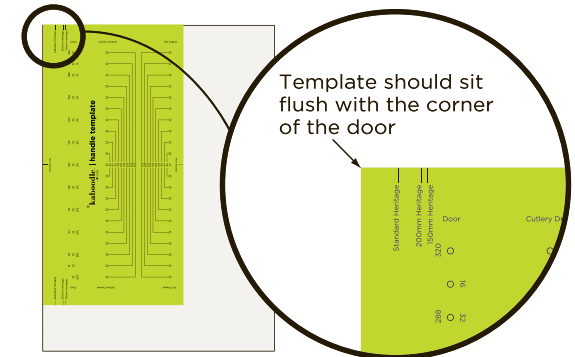

2.

Using the line of holes marked 'Door', mark the top hole and the hole marked with the measurement of your handle with a pen.

Note: The size of the handle is the measurement between the 2 screw holes.

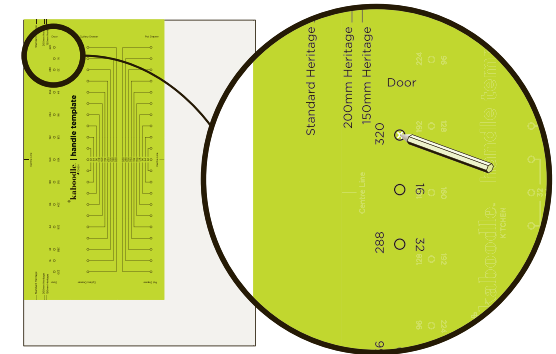

3.

Remove the template and use a 4.5mm drill bit to drill a hole through both points marked on the door.

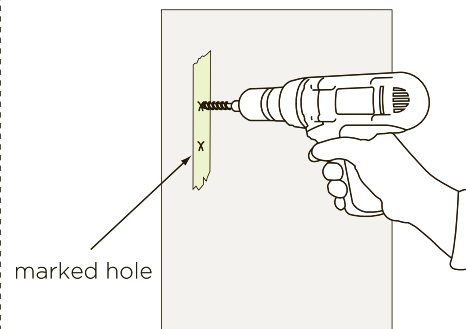

4.

If installing a handle on a wall cabinet door, line up the bottom of the template with the bottom of the door and use the bottom hole as your first marking point.

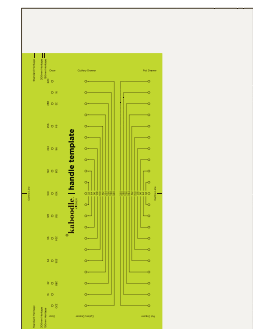

It is recommended to place a strip of masking tape across any area where you will be marking the door or drawer so that it can be easily removed if you make a mistake.

heritage door drilling instructions

1.

Move the template along so that the edge of the door is even with the lines at the top and bottom of the template. If you are installing a handle on a 150mm heritage door use the lines marked '150mm Heritage', on a 200mm heritage door use the lines marked '200mm Heritage' and for any other size use the line marked 'Standard Heritage'.

Make sure the top of the template is flush with the top of the door.

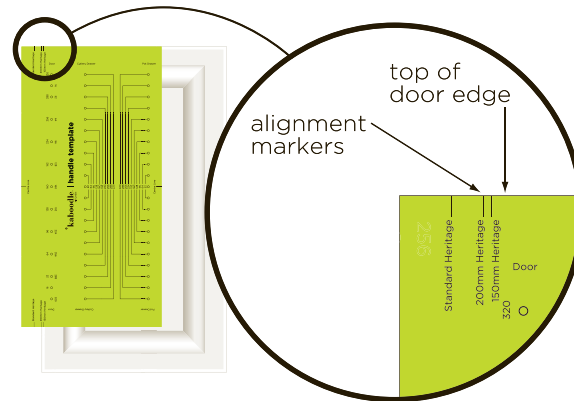

2.

Using the line of holes marked 'Door', mark the top hole and the hole marked with the measurement of your handle with a pen.

Note: The size of the handle is the measurement between the 2 screw holes.

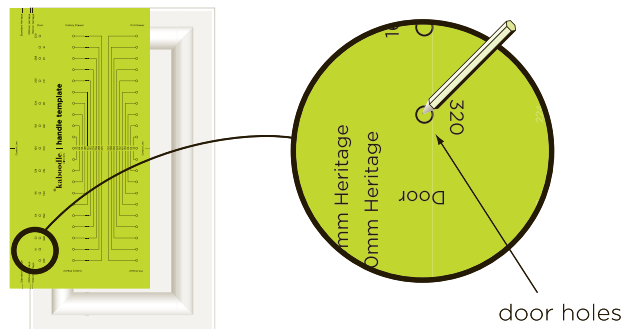

3.

Remove template and use a 4.5mm drill bit to drill a hole through both points marked on the door.

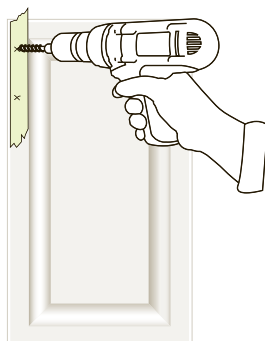

4.

If installing a handle on a wall cabinet door, line up the bottom of the template with the bottom of the door and use the bottom hole as your first marking point.

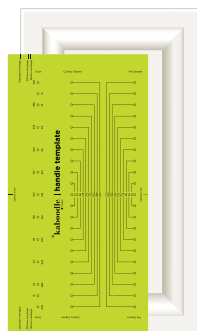

horizontal overhead door drilling instructions

1.

Mark a line across the door, 40mm from the bottom of the door.

Mark the middle point at the bottom of the door.

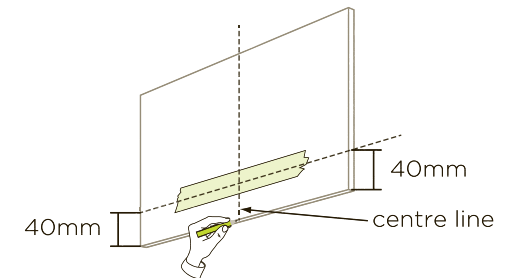

2.

Place the template on the door so that the centre line on the template is in line with the centre line you marked on the door. Move the template until the line you marked across the door is in line with the holes on the template marked 'cutlery drawer'.

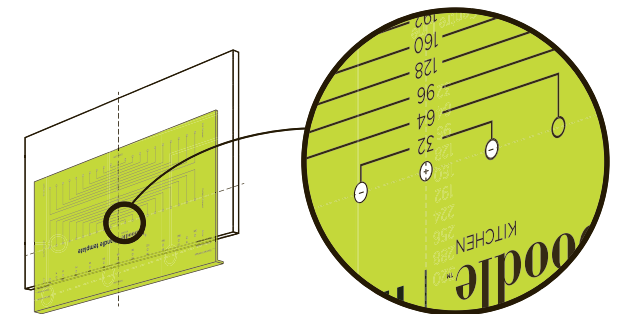

3.

Find the size of your handle on the list running down the middle of the template; the lines guide you to which holes to use. Mark both holes with a pen.

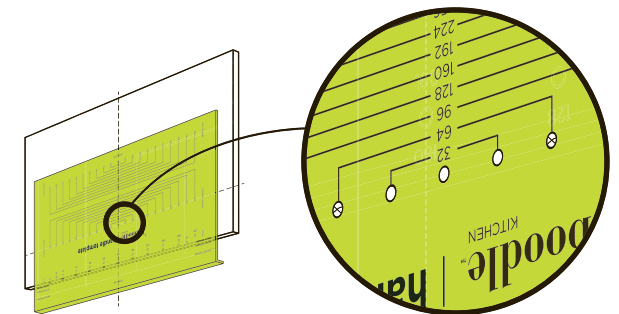

4.

Remove template and use a 4.5mm drill bit to drill a hole through both points marked on the door.

