

for step by  
step instructions  
please turn over ➡

## step 2

Follow these instructions to install your bins.

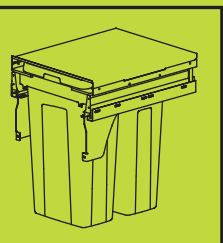

**kaboodle**  
KITCHEN

# 450/600 pullout bins to suit metal sided drawers

### Things you need to know

- Always read the full instructions prior to installation.
- Consider possible obstructions to your parts & accessories, like hinges inside the cabinet or adjacent cabinet doors and handles, prior to installation.
- Make sure you leave plumbing and electrical work to qualified trades people. Never try this yourself.

- Make sure you always use safety gear like a mask, ear muffs and glasses when using tools.

**Tip:** After marking out the pre-drill holes as per the instructions, take the part that is to be installed and align the appropriate holes with the markings to ensure they match up prior to pre-drilling the holes.

### Caring for your kaboodle parts and accessories

- Hinges, runners and other parts and accessories should be kept dry at all times.
- To keep the mechanisms performing at their best, regularly wipe them with a dry cloth removing any dust and grime that may build up.

### Customer service

We offer a dedicated customer service line for advice or any questions you may have on kaboodle products.

Call customer service on:  
Australia: **1800 666 078** Monday to Friday between 8.00am and 6.00pm AEST  
New Zealand: **0800 522 663** Monday to Friday between 8.00am and 5.00pm NZST or email: [info@kaboodlegroup.com.au](mailto:info@kaboodlegroup.com.au)

### Tools you will need

To put your kaboodle kitchen waste bins together you will need the following tools.

Cordless drill with:  
• Number 2.5 screw tip  
• 2.5mm drill bit

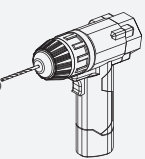

Tape measure



Pencil

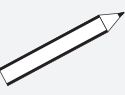

Screw driver

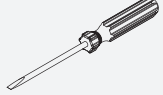

Safety gear



Adjustable square

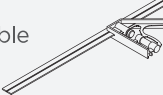

Spirit level (optional)

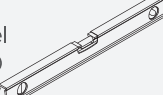

### Hardware included

**note:** bin & tray will vary between models.

Door support brackets are not supplied with all models. If not supplied, skip step 13.

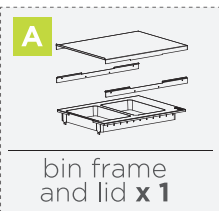

bin frame and lid **x 1**

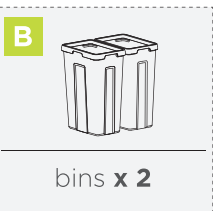

bins **x 2**

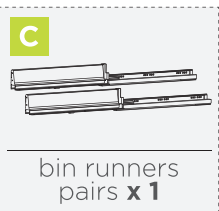

bin runners pairs **x 1**

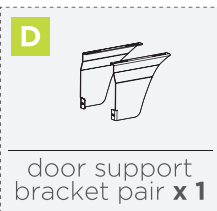

door support bracket pair **x 1**



4.5mm screws **x 8**



4.5mm stepped screws **x 4**

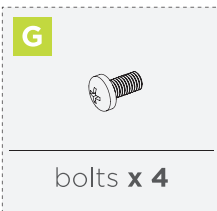

bolts **x 4**

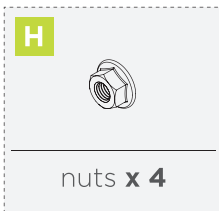

nuts **x 4**

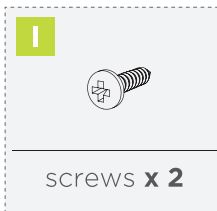

screws **x 2**

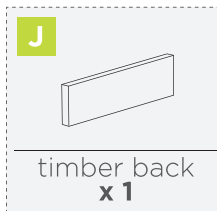

timber back **x 1**

suitable for following cabinet widths

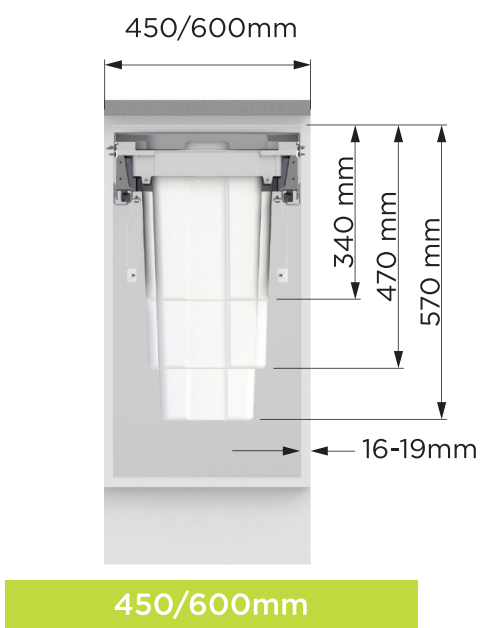

### mark locator holes for brackets

1.

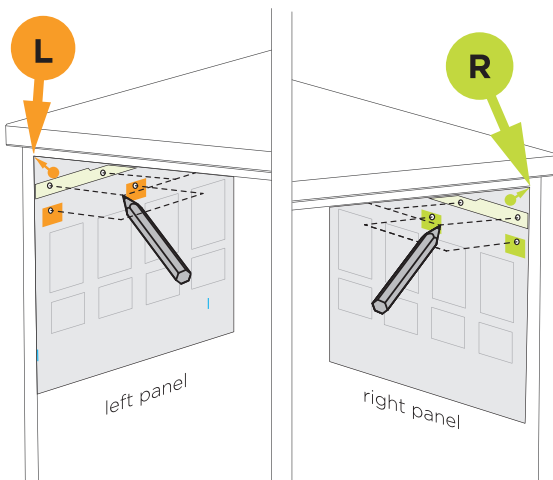

Use above template to mark drilling holes for lid brackets and drawer runner mounting position on left and right cabinet sides.

### drill locator holes

2.

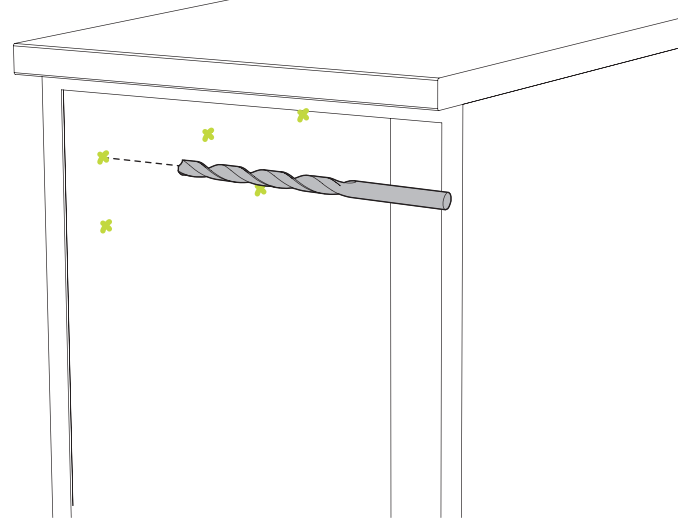

Pre-drill marked holes using 2.5mm drill bit. There will be 12 holes in total.

### attach brackets to cabinet sides

3.

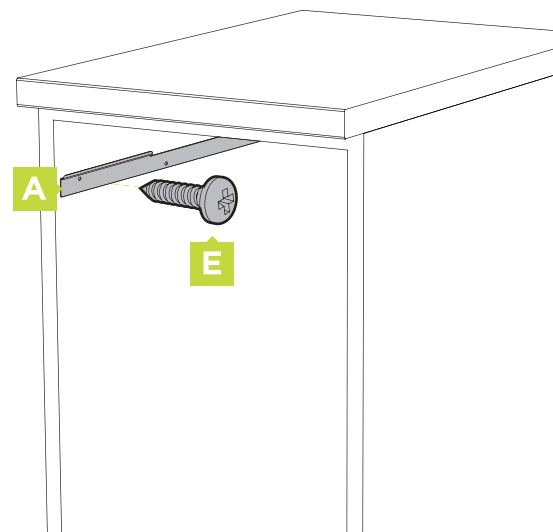

Attach both brackets using 4.5mm screws.

### attach metal sided drawer runners to cabinet

4.

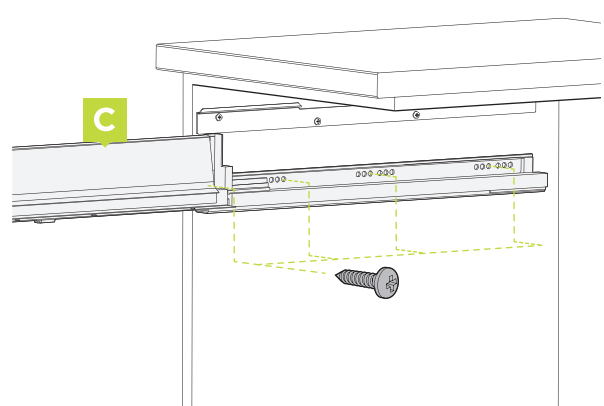

Mount metal sided drawer runners in marked positions below brackets using screws provided with runners.

### measure and mark cabinet door

5.

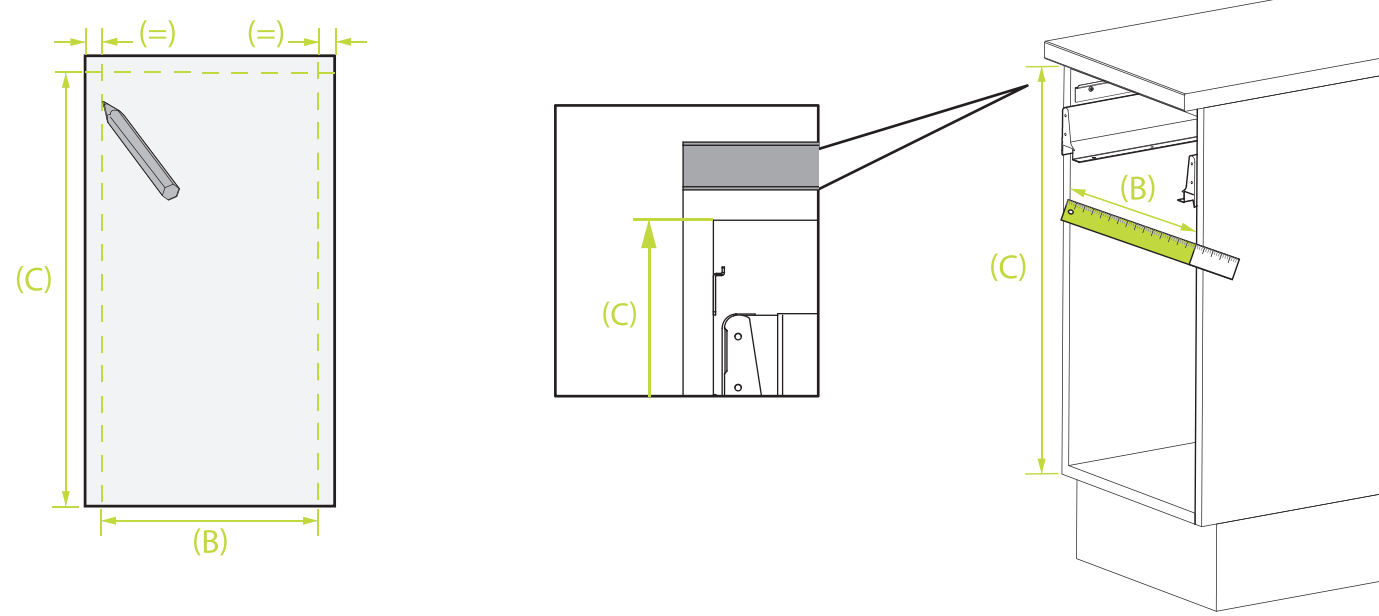

Measure the cabinet width (b), and the top inside cabinet height (c), mark on the door.

### measure and mark drawer bracket positions

6.

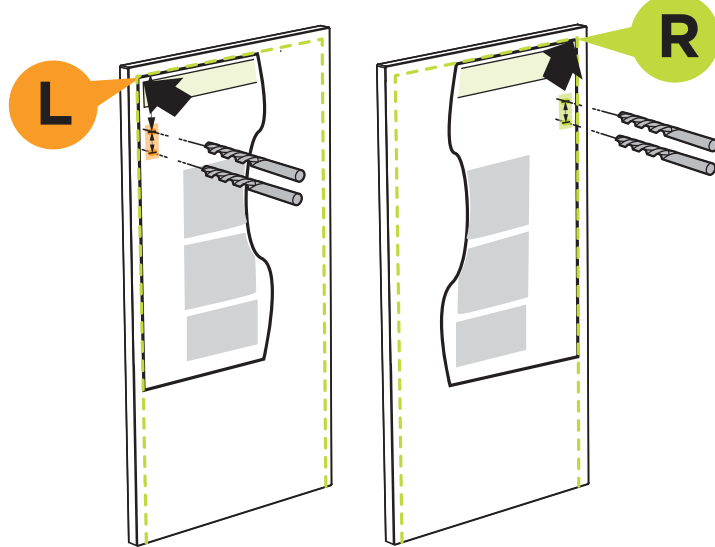

Align instructions and use side templates to mark front bracket positions. Once marked, pre-drill using 2.5mm drill bit.

### attach drawer front clips and drawer front

7.

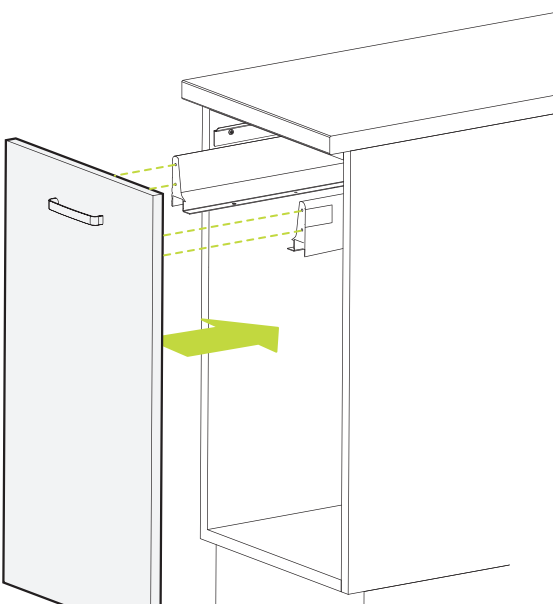

Mount drawer front brackets to rear of door. Clip brackets into place on metal sided drawer.

### remove drawer sides from runners

8.

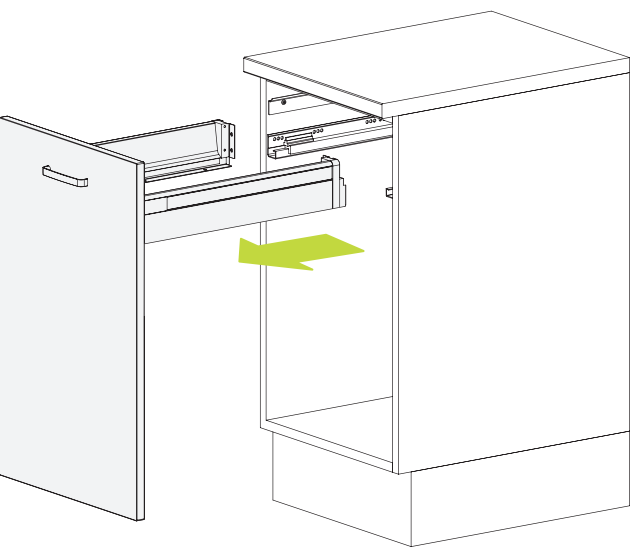

Remove drawer sides as per metal sided drawer instructions.

### attach drawer back panel

9.

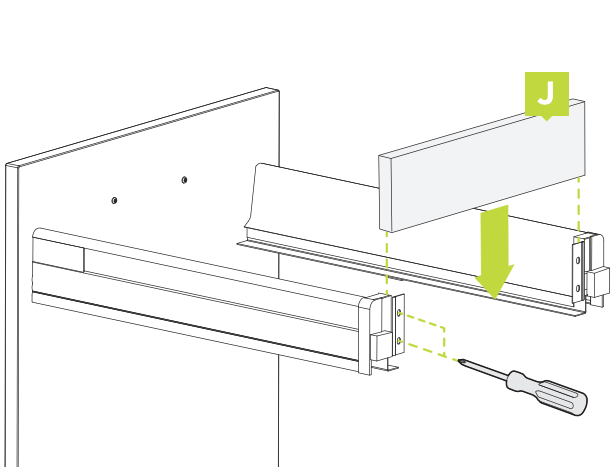

Attach drawer back panel as per metal sided drawer instructions

### insert drawer and door assembly and adjust

10.

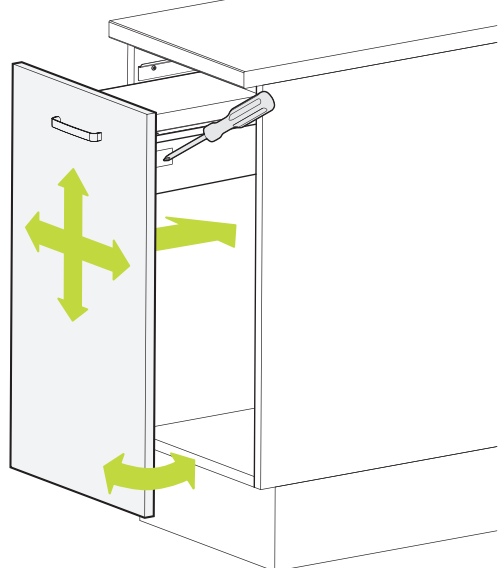

Insert drawer and door assembly and adjust door front as per metal sided drawer instructions.

### attach door support brackets

11.

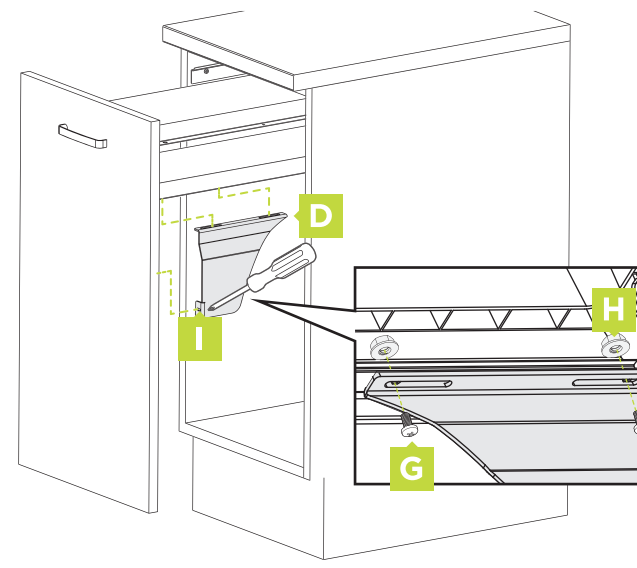

Attach door brackets if supplied.

### insert tray

12.

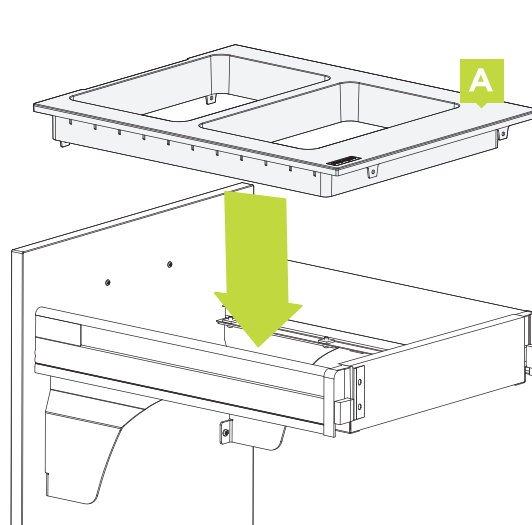

Install tray.

### mark tray fixing holes

13.

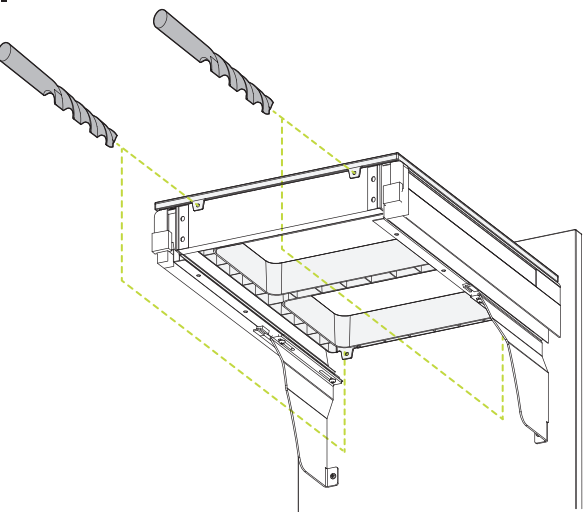

Centre tray and mark fixing position of brackets on rear of drawer front and drawer back. Pre-drill using 2.5mm drill bit.

### fix tray

14.

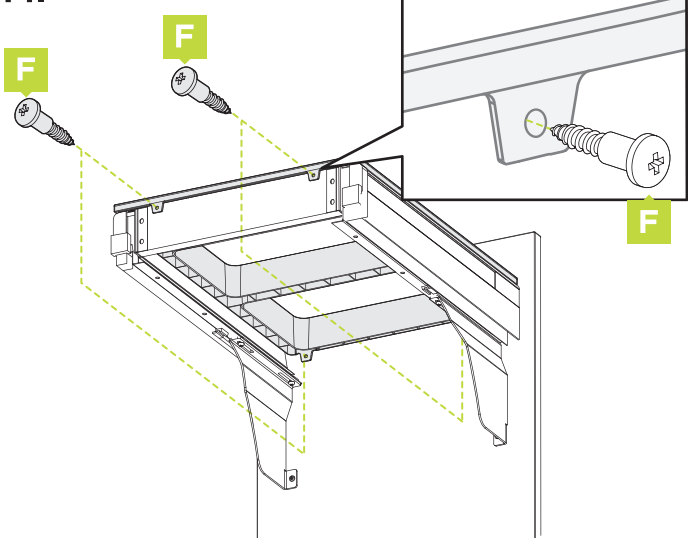

Fix tray to drawer assembly using 4 x 4.5mm stepped screws.

### re-install drawer

15.

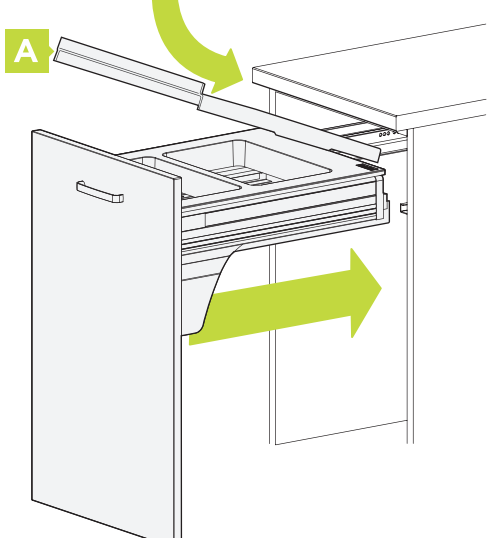

Re-install drawer assembly on drawer runners. Insert metal lid on brackets.

### insert bins

16.

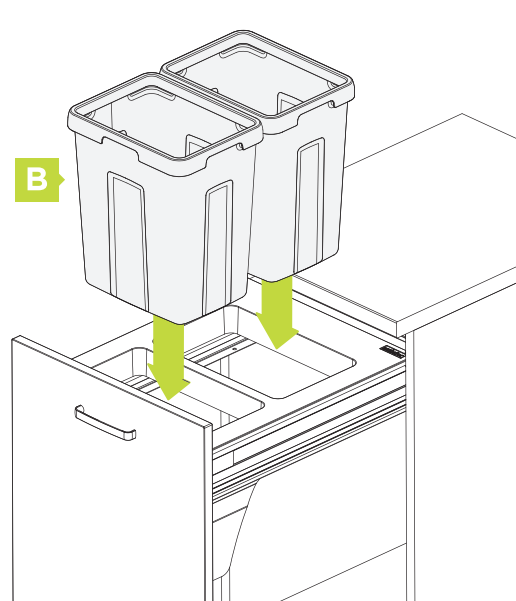

Insert bins in tray.

<b>step 1</b> ✓ Your Kaboodle cabinet is now complete.		<b>step 2</b> ✓ You've finished adding your parts and accessories.	
<b>step 4</b> Finish off your Kaboodle Kitchen by installing your benchtop.			
<b>step 3</b> Next, follow the instructions to fit your doors and panels.			