

## step 2

Follow these instructions to install your parts and accessories.

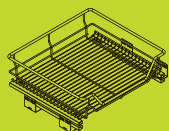

**+** **kaboodle**<sup>®</sup>  
KITCHEN

# pullout basket soft close

## installation guide

### Things you need to know

- Always read the full instructions prior to installation.
- Consider possible obstructions to your parts & accessories, like hinges inside the cabinet or adjacent cabinet doors and handles, prior to installation.
- Make sure you leave plumbing and electrical work to qualified trades people. Never try this yourself.
- Make sure you always use safety gear like a mask, ear muffs and glasses when using tools.
- **Tip:** After marking out the pre-drill holes as per the instructions, take the part that is to be installed and align the appropriate holes with the markings to ensure they match up prior to pre-drilling the holes.
- If you have any questions, contact us on:  
Australia: **1800 666 078** Monday to Friday between 8:00am and 6:00pm AEST, New Zealand: **0800 522 663** Monday to Friday between 8:00am and 5:00pm NZST or email: **info@kaboodlegroup.com.au**.

### Hardware included

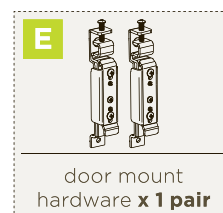
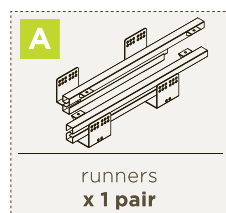

### Tools you will need

To put your kaboodle kitchen accessory together you will need the following tools.

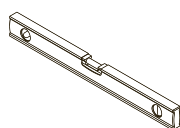
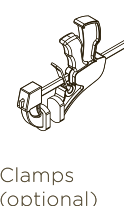
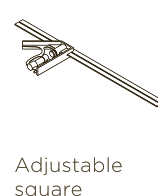
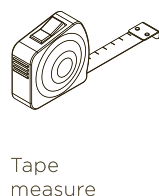
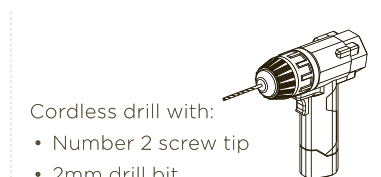

# step 2

## hardware key



**kaboodle**  
KITCHEN

## pullout basket soft close

### pre-drilling for runners

1.

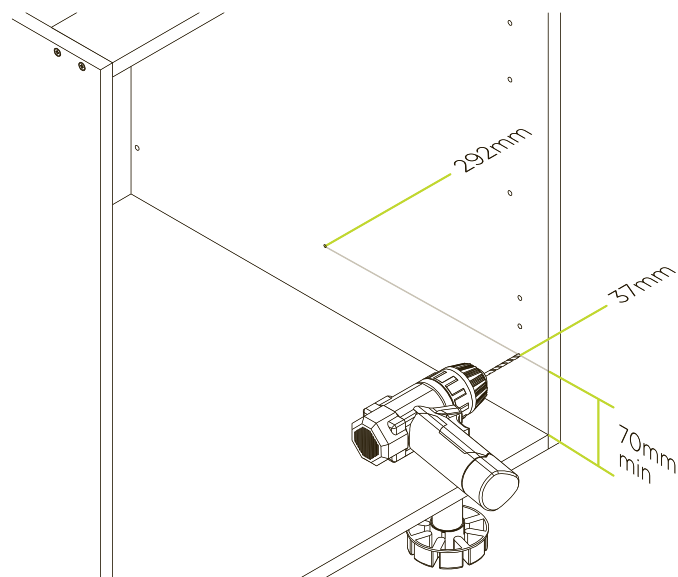

Calculate the desired height of your basket and runners. Mark out and pre-drill two holes on each side panel of the cabinet as pictured above. Use a 2mm drill bit to pre-drill holes to a depth of roughly 2.5mm. **Note:** Ensure the operation of the pullout basket will not be affected by any obstructions in the cabinet like hinges prior to pre-drilling holes.

### attaching runners

2.

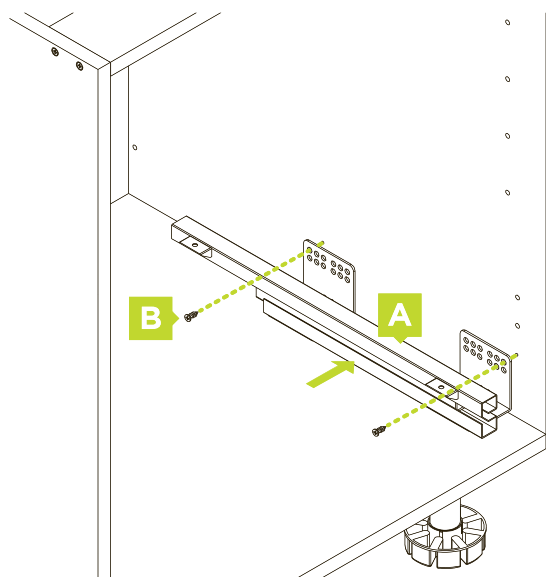

Align the runners (A) with the pre-drilled holes and using 4 x wood screws (B), fix the basket runners to the cabinet sides. Use a further 8 x 16mm wood screws to secure runners, ensuring the screws are spaced evenly on both runners and are mirrored from the left to right side.

### securing runners

3.

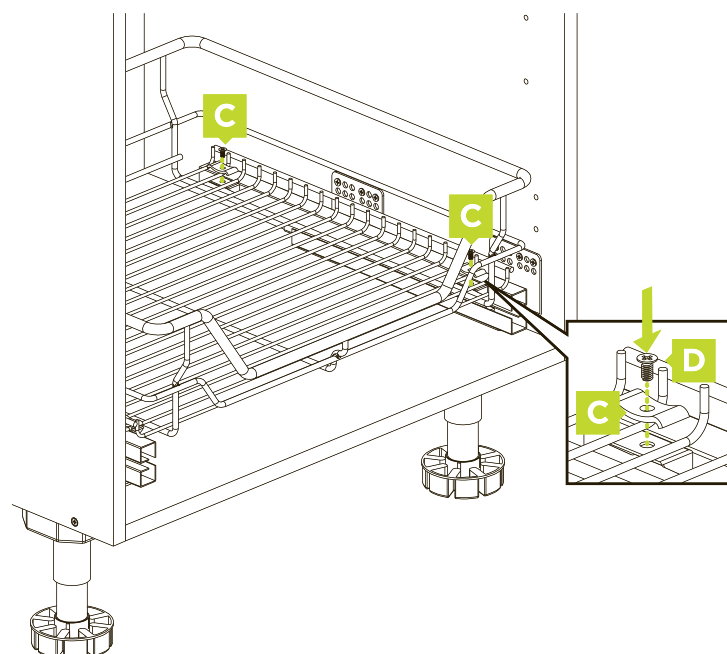

Place wire basket onto the runners, ensuring the metal supports are placed between the 2nd and 3rd wires at the front and back of the basket. Align the basket clips (C) and fix into place using the basket clip screws (D) and a hand held screw driver.

### installing multiple baskets

4.

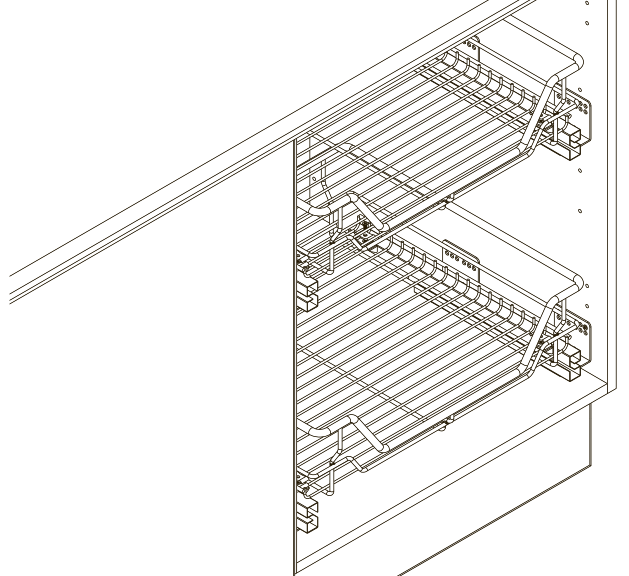

If you are installing multiple baskets in the same cabinet or pantry, repeat steps 1-3 ensuring you leave enough clearance between the baskets to accommodate the desired items. **Note:** If you intend to use the door mount hardware to attach a cabinet door, pot drawer or slimline door, take into consideration their size, weight and positioning as well (see steps 5-11). The maximum weight capacity for the basket includes the weight of the cabinet door or pot drawer panel if installed.

W-50543 / W-50544 / W-50545 / W-50546 / W-50547  
Ver. 1 | p. 2

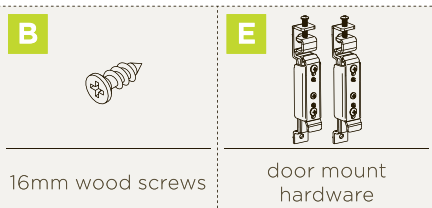

### door mount hardware

#### 5.

If you intend to use the door mount hardware to attach a cabinet door, pot drawer panel or slimline door, take into consideration their size, weight and positioning as well (see steps 5-11). The maximum weight capacity for the basket includes the weight of the door or panel if installed. **Note:** Cutlery drawer panels are not suitable due to the height of the basket.

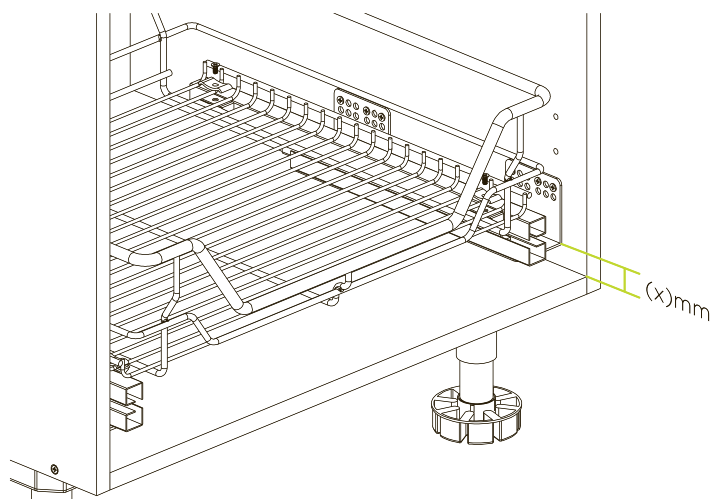

Measure from the base of the cabinet to the bottom of the basket runners (x).

### pullout basket soft close

#### pre-drilling for door mount hardware

#### 6.

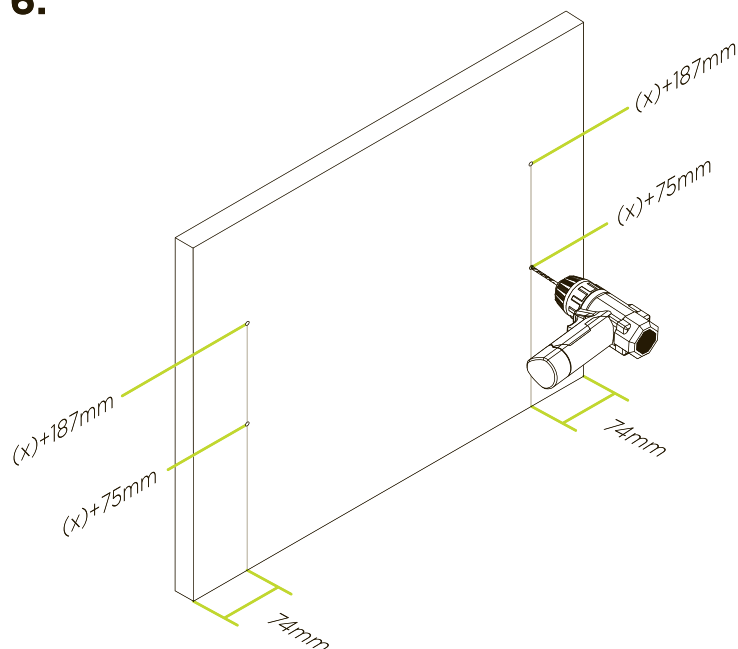

On the inside of your cabinet door, slimline door or pot drawer panel, mark out and pre-drill four holes as per the diagram above, using measurement (x) from step 5. Use a 2mm drill bit to pre-drill holes to a depth of roughly 2.5mm.

### installing door mount hardware

#### 7.

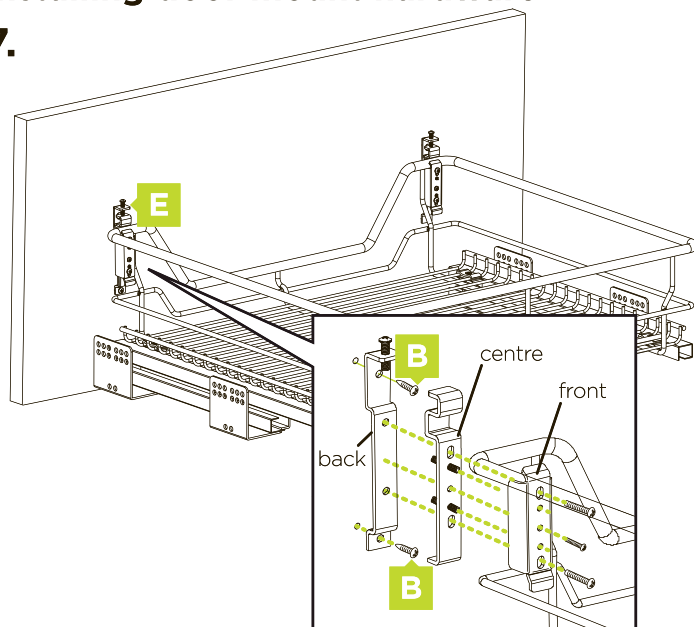

Disassemble the door mount hardware (E), as per the diagram above, by removing the three screws from the front piece.

Take the back piece, align with the pre-drilled holes on the door and secure into place using 2 x wood screws (B). Ensure the single screw at the top is loose for the next step.

Take the centre piece, slide the recessed section over the top front rail of the basket. Once in place, take the front piece and align with holes of the centre piece through to the back piece and screw back together, as pictured above.

### adjusting door mount hardware

#### 8.

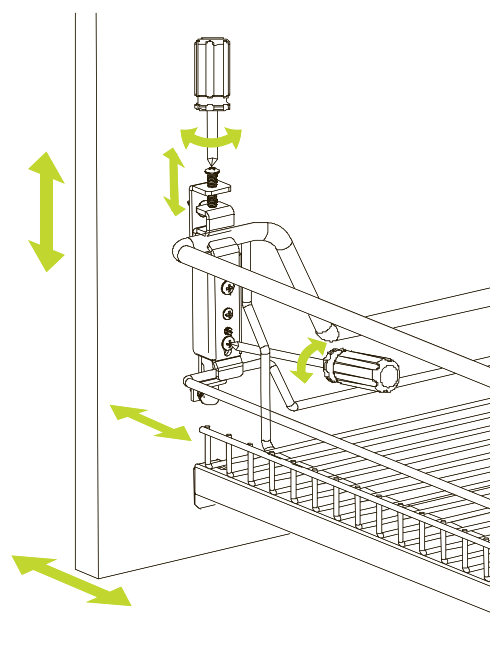

If required, adjust the height of door by tightening or loosening the top screw. Adjust the angle of the door by tightening or loosening the screws on the front piece. **Note:** To adjust the door panel left or right, loosen screws on the door mount hardware front piece, slide along the basket to desired position and re-tighten all screws.

## measuring for top drawer panel use 9.

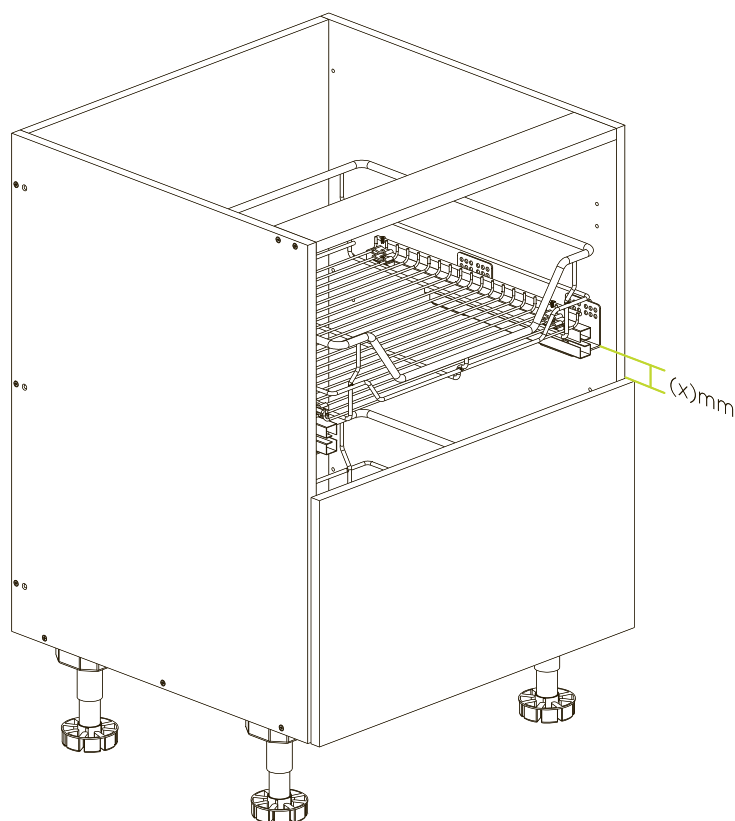

When installing a second slimline door or pot drawer panel, measure from the top of the bottom door or panel to the bottom of the runner to get (x).

## pullout basket soft close pre-drilling for top drawer panel use 10.

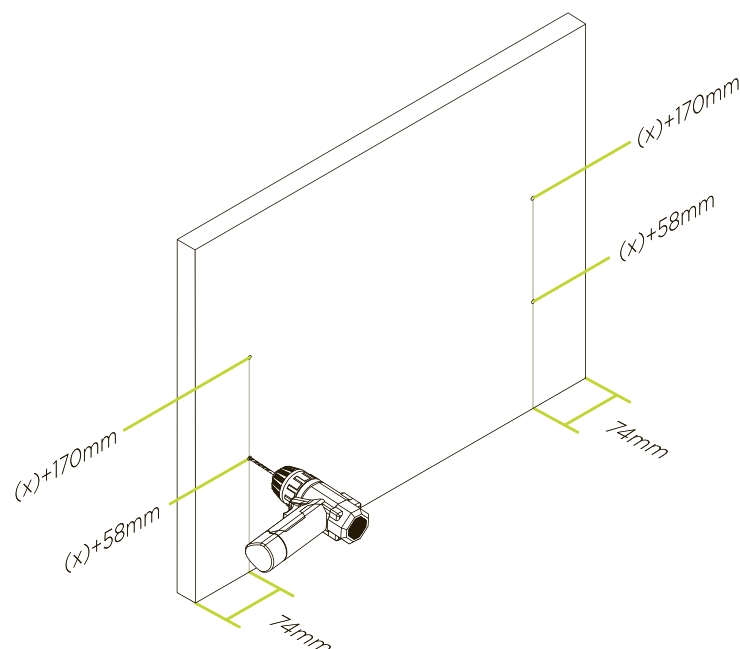

On the inside of your slimline door or pot drawer panel, mark out and pre-drill four holes as per the diagram above, using measurement (x) from step 9. Use a 2mm drill bit to pre-drill holes to a depth of 2.5mm and fix into place using wood screws (B) provided.

## installing & adjusting door mount hardware 11.

Follow steps 7 and 8 to complete installation.

### Caring for your kaboodle cabinets

Looking after your cabinets is really easy and with the right care and maintenance they will last you for many years. Just follow these simple steps and if you need any more information you can contact us: Australia: **1800 666 078** Monday to Friday between 8:00am and 6:00pm AEST. New Zealand: **0800 522 663** Monday to Friday between 8:00am and 5:00pm NZST or email: **info@kaboodlegroup.com.au**.

**Caring for your kaboodle parts and accessories:** Looking after your parts and accessories is really easy and with the right care and maintenance they will last you for many years. Just follow these simple steps. Hinges, runners and other parts and accessories should be kept dry at all times. To keep the mechanisms performing at their best, regularly wipe them with a dry cloth removing any dust and grime that may build up. In case of spills, clean immediately with a dry cloth. Do not use harsh abrasives.

We offer a dedicated customer service line for advice or any questions you may have on kaboodle products.

Call customer service on:  
Australia: **1800 666 078** Monday to Friday  
between 8:00am and 6:00pm AEST

New Zealand: **0800 522 663** Monday to Friday  
between 8:00am and 5:00pm NZST or email:  
**info@kaboodlegroup.com.au**

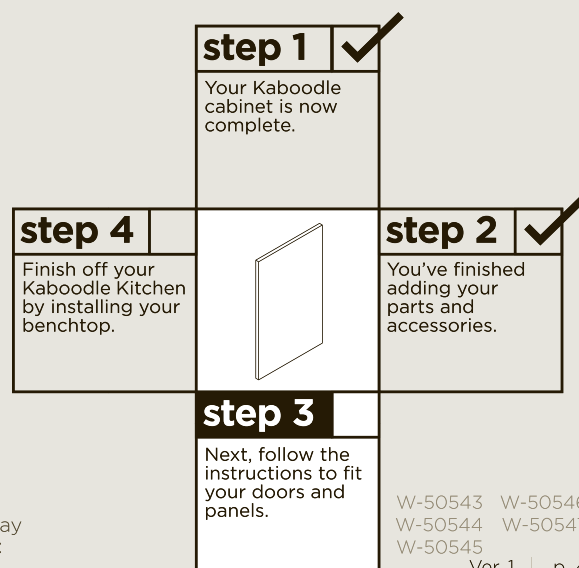

W-50543 W-50546  
W-50544 W-50547  
W-50545

Ver. 1 | p. 4