

- ✓ No penetration of the roof membrane
- ✓ Even distribution of wind load
- ✓ Up to 30% fewer fixing requirements
- ✓ Efficient installation
- ✓ Custom-made membranes
- ✓ Fast protection from ingress after Moisture

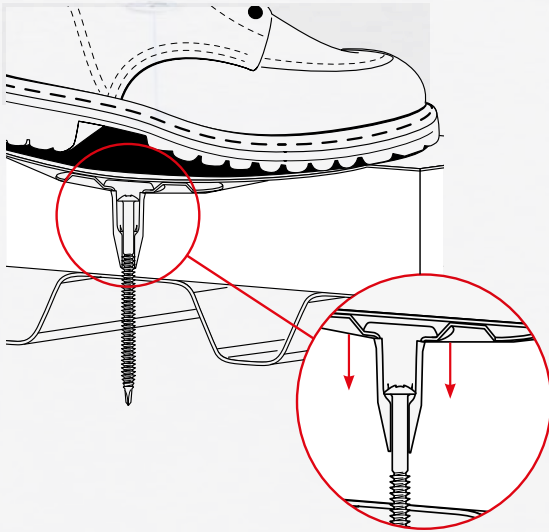

#### With Foot Traffic

The TreadSafe® system counteracts normal loads when walked on and thereby minimises the risk of the fixing breaking through the roof sheeting.

**CARLISLE®**  
Construction Materials Ltd.

#### United Kingdom

Lancaster House | Concorde Way  
Millennium Business Park | Mansfield  
Nottinghamshire | NG19 7DW

T +44 (0)1623 62 72 85  
E [info.uk@ccm-europe.com](mailto:info.uk@ccm-europe.com)

VISIT US ON:



[www.ccm-europe.com](http://www.ccm-europe.com)

## CARLISLE® Induction System

ELECTROMAGNETIC INDUCTION  
WELDING



## A strong bond

Experience the new dimension of fixing with the CARLISLE® Induction System and our HERTALAN® EASY COVER membranes and SURE-WELD® TPO. This system uses induction-compatible plates to secure EPDM or TPO membranes and insulation to the roof construction without having to breach the membrane.

### Innovative technology

The induction device is activated directly over the specially coated fastening plate. Through induction, the coating on the fastening plates is heated to around 280 °C and liquefied in the process. The heating process takes only around five seconds if the device is calibrated to the ambient temperature, the film thickness and the power source.

Immediately after welding, firm pressure from the magnetic cooling rods on the pre-welded fastening plates within 45 seconds creates a permanent bond with the EPDM or TPO.

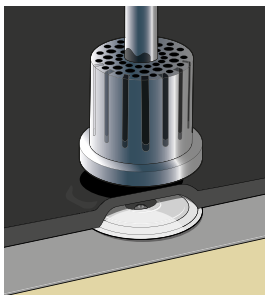

Several million square metres of roof surface have already been permanently sealed in the USA with this mechanical fixing system.

## Even distribution of wind load

In contrast to traditional methods involving seam fixing, field fixing with the induction process distributes the wind load evenly over the EPDM or TPO. This prevents any asymmetrical force impact on the fastening plates and seams.

### Field fixing

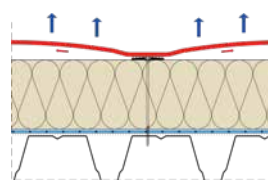
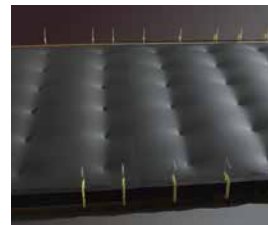

The position of the fastening plate is defined based on the wind load calculations for the property and distributed in the roof system. As a result, despite mechanical fixing, larger membranes can be used and a clear reduction achieved in the seam proportions and seam overlap compared to conventional systems fixed in place by mechanical means.

### Seam fixing

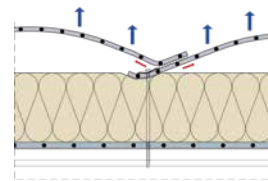
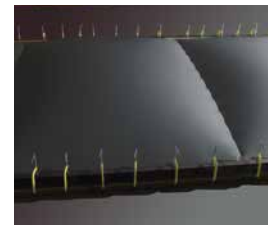

Since the fixing points are distributed like a grid across the entire roof and not just placed on the membrane joints, the wind forces are supported more evenly. As a result, the point load per fixing element is less and the system can handle higher wind forces with fewer fixing requirements.

## The CARLISLE® Induction System

The CARLISLE® Induction System comprises perfectly coordinated components: Induction welding device, specially coated fastening plates for HERTALAN® EPDM-membranes and SURE-WELD® TPO and magnetic cooling rods.



### We support you with design and installation

- Calculation of drainage, tapered insulation and wind uplift
- Calculation and design of membranes required for the roof
- Creation of waterproofing specifications
- Product training by CARLISLE® Academy
- Dimensions of membranes (for your first project or any complex installation, the CARLISLE® Technical Department will assist you)