



2012 Leaders Conference
AGRICULTURE FUTURE OF AMERICA

AFA exists to be a catalyst in the preparation
of a new generation of agriculture leaders.

Follow Passion. Take Action.



Ranging from doubling global food needs in the next 50 years to an increasing rate of retiring leadership from production, public and private sectors and a dwindling number of young people with agricultural backgrounds, the agriculture community has a variety of challenges and opportunities ahead.

Despite these evolving challenges, past and present leaders of this great industry continue to be linked by a common thread. Passion for agriculture transcends generations and takes an inexplicable hold on those who live it.

As more Americans become removed from agriculture, we must find a way to ignite a similar passion in those who haven't experienced agriculture in a traditional way and encourage those who have to follow this passion. The future of the industry depends on our ability to show these young people agriculture can provide a rewarding and fulfilling career.

Agriculture Future of America is dedicated to helping students define their passion for the agriculture and food industry and inspiring them to turn that passion into action. AFA delegates have been identified as leaders with talent the industry needs for the future. As seekers of opportunities, their involvement in AFA is a testament to their commitment to invest in themselves as leaders and their desire to contribute to future solutions.

Whether your tool is a tractor, computer, test tube, calculator or simply your voice, it's time for you to take action. Every segment of the agriculture and food industry has a role in providing the solution to current and future challenges.

Together, as a network of dedicated leaders, we must turn our passion into action and propel the industry into the future.

Welcome to AFA Leaders Conference



Congratulations! You have chosen to prepare for a career in one of the world's most vital professions: Agriculture.

This is truly an exciting time to be an agriculturist.

As global demand for food, feed, fuel and fiber grows and consumer expectations increase, the need for more sustainable practices and the ever expanding role of technology make agriculture a dynamic career choice.

It is my pleasure to welcome you to AFA Leaders Conference. Agriculture Future of America is committed to assisting young leaders prepare for their futures. The AFA Leaders Conference is designed to provide each attendee with training and personal development experiences needed to enter the work force and succeed. If you are a returning delegate, welcome back. If this is your first AFA Leaders Conference, I encourage you to become engaged in the experience. You are all here because your record of academic and leader achievement demonstrates high motivation, talent and commitment.

The 2012 AFA Student Advisors and Ambassadors, Board of Directors, partner organizations and staff are eager to meet each of you. One of the most exciting aspects of AFA Leaders Conference is the opportunity to connect with peers and professionals who share your passion and excitement for agriculture. Regardless of your desired career path, AFA Leaders Conference is a place to refine your vision for the future.

Enjoy AFA Leaders Conference,

K. Russell Weathers
President and CEO

AFA Staff

K. Russell Weathers
President and CEO

Nancy Barcus
Vice President of Leader
and Organization Services

Mark Stewart
Vice President of Development
and Communications

Julie Beilke
Administrative Coordinator

Emily Page
Program Manager

Derek Mulhern
Program Coordinator

Suzanne Smith
Administrative Assistant

Megan Karlin
Marketing and Development
Coordinator

Angela Grojean
Event Consultant

Volunteers

AFA would like to express its sincere appreciation to the numerous volunteers who give their time, effort and support to make the AFA Leaders Conference possible. Thank you for aiding in the growth and development of hundreds of young leaders.

AFA Ambassadors

The AFA Student Advisory Team and Campus Ambassadors are collegiate men and women who serve as ambassadors for the AFA vision and mission. They are the voice of the AFA student stakeholders and collaborate to provide programs that expand a student's academic, leader and work experiences.

AFA Student Advisory Team



Back to Front, Left to Right:

Student

Nathan Johnston	Iowa State University
Michael Baird	Purdue University
Ty Littau	South Dakota State University
Jackson Troxel	Purdue University
Shannon Watson	Oklahoma State University
Lydia Manson	University of Missouri
Mark Avilla	Kansas State University
Carolyn Gehrke	University of Illinois
Jon Calhoun	Oregon State University

Internship

Dow AgroSciences
Purdue Horticulture Farm
K Bar J Leather Company
South Dakota State University Dairy Processing Plant
Missouri Farm Bureau
Farmland Foods
Fleishman-Hillard
Kuhn North America
Pendleton Grain Growers

AFA Campus Ambassadors



Back to Front, Left to Right:

Hilary Morris, Iowa State University
Seth Erwin, The Ohio State University
Amanda Sumerix, Michigan State University
Dennis Kinkad, Southeast Missouri State University
Danielle Smith, University of Arkansas
Katie Nickels, Washington State University
Jocelyn Clemons, Kansas State University
Kayla Petree, University of Missouri

Sarah Sample, South Dakota State University
Tanner Rohloff, North Dakota State University
Jessica Vazquez, California State University – Chico
Emma Likens, University of Nebraska
Kate Maertens, University of Minnesota
Charlie Wilson, Clemson University
Cheyenne Lentz, University of Wisconsin
Paige Warren, Oklahoma State University

AFA Organizational Partners

AFA extends its appreciation to the following individuals, businesses, corporations, institutions and associations who contribute to the success of the AFA organization as crucial partners in the preparation of new industry leaders. Their support is vital to the ongoing success of this Conference and the many other programs and services provided by AFA.

Investments \$100,000 to \$249,999



MONSANTO



Geraldine and R.A. Barrows Foundation

Kearney Womall Charitable Trust

Investments \$50,000 to \$99,999



Arvin Gottlieb Charitable Foundation

R.C. Kemper Charitable Trust

Carter Community Memorial Trust, Inc.

William T. Kemper Foundation

Enid and Crosby Kemper Foundation

Investments \$25,000 to \$49,999



LEWMAR Foundation



AFA Leaders Conference Sponsors

AFA would like to express its sincere appreciation for the support of the following Conference and delegate sponsors:

\$10,000 to \$24,999

Boehringer Ingelheim Vetmedica, Inc.
Cerner Corporation
CGB Enterprises Inc.
DuPont Crop Protection
Farmland Foods
GROWMARK
National Crop Insurance Services
National Pork Board
Bob Richter
Seaboard Foods
The Scoular Company
The Sosland Foundation
The Stone Family Foundation

\$1,000 to \$4,999

AgCareers.com
AgriBank
Ash Grove Charitable Foundation
Central Valley Ag
Ceva
National Dairy Shrine/Dairy Management Inc.
Farmer, Lumpe + McClelland
First Iowa State Bank
GROWMARK
Michelle Hayes Family
Heartland Acres
Kansas Cooperative Council
Carol Keiser-Long
Kuhn North America

\$5,000 to \$9,999

AgriBank, FCB
AgReliant Genetics
Harry and Clara Cleberg
Dairy Farmers of America
Dairy Management Inc.
Elanco
FCS Financial
Illinois Soybean Association
Missouri Soybean Merchandising Council
SFP

Landis Ag Placement
Livestock Marketing Association
MFA Foundation
Midwest Dairy Association
Minnesota Pork Board
Minnesota Soybean Growers
Missouri Department of Agriculture - AgriMissouri
Missouri Soybean Association
National Association of Farm Broadcasting
National FFA Organization
Thomas and Betty Scott
U.S. Premium Beef
Wells Fargo Bank
West Central Cooperative

University Partners

University Partners have committed financial resources to sponsor delegates to AFA Leaders Conference:

Butler County Community College
California Polytechnic State University
Colorado State University
Cornell University
Fort Hays State University
Illinois State University
Iowa State University
Kansas State University
Michigan State University
Missouri State University
North Dakota State University
Northeast Community College
Northwest Missouri State University
The Ohio State University

Oklahoma State University
The Pennsylvania State University
Purdue University
South Dakota State University
Southeast Missouri State University
University of Arkansas-Fayetteville
University of Wisconsin-River Falls
University of California-Davis
University of Florida
University of Illinois
University of Minnesota
University of Tennessee
University of Missouri

In-Kind

These partners provided in-kind support to promote and execute the 2012 AFA Leaders Conference:

AgriTalk
Bill's Tropical Greenhouse
Cerner Corporation
National Association of Farm Broadcasting

Radio Works LLC
RFD-TV
Ricoh USA, Inc.
Sheraton Kansas City Hotel at Crown Center

AFA Opportunity Fair



During the AFA Opportunity Fair, students learn about available internships and full-time employment opportunities, as well as graduate school and international study programs. Company recruiters are eager to share their definitions of agriculture and explore opportunities to help students create stronger personal and professional portfolios through internships or full-time employment.

I am continuously impressed with the enthusiasm, talent, interpersonal skills and diversity of the AFA Leaders Conference delegates and participants. The access to students is probably a highlight of the conference for me, with time set-aside to allow for dialogue between company leaders and students. The caliber of such interaction is superb, with sufficient time for company representatives to discuss agricultural business strategies and how future leaders can impact those strategies. I look forward to AFA Leaders Conferences each year and my only regret from participation is that we can't spend even MORE time with individual students.

**Kent Martin, Manager NA C&S Field
Production and Seeds Processing
Syngenta**

The AFA Opportunity Fair is designed to give participating organizations a competitive edge in the identification of human capital. AFA, a year-round resource, links students and employers based on individual interests.

AFA Opportunity Fair Participants

Ag Processing Inc.	ICM, Inc.
AgCareers.com	John Deere
AgReliant Genetics	Kansas Cooperative Council
agriCAREERS, Inc.	Kansas Department of Agriculture
Agriculture Future of America	Kansas State University Master of Agribusiness
AgriGold Hybrids	Kuhn North America, Inc.
AgVenture	Land O'Lakes, Inc.
American Phytopathological Society	Landis AG Placement & Consulting, Inc.
American Royal Association	Lansing Trade Group
Archer Daniels Midland	MachineryLink
Bader Rutter & Associates	Monsanto Company
Bartlett and Company	National Association of Agricultural Educators
Boehringer Ingelheim Vetmedica, Inc.	National Association of Farm Broadcasting
Bunge North America	National FFA Organization
Cargill	National Pork Board
CBYX (Cultural Vistas, Inc.)	NEW Cooperative
Central Valley Ag	Osborn Barr
CGB Enterprises	Progressive Agriculture Safety Days®
CHS Inc.	Purdue University
CoBank ACB	Seaboard Foods
ConAgra Foods, Inc.	SFP
Crop Production Services	Sigma Alpha Sorority
Dairy Farmers of America, Inc.	Skyland Grain, LLC
Dow AgroSciences	South Dakota Wheat Growers
DuPont Crop Protection	Syngenta
DuPont Pioneer	The Andersons, Inc.
Edward Jones	The Maschhoffs
Elanco	The Scoular Company
Farm Credit	Trans Ova Genetics
Farm Safety 4 Just Kids	Union Pacific Railroad
Farmland Foods	UNB
Gavilon	UNL Doctor of Plant Health
Great Plains Manufacturing, Inc.	Water Street Solutions
GROWMARK	Wells Fargo
Helena Chemical Company	West Central
Hog Slat, Inc.	

AFA Leaders Conference (#AFALC12)



Identified as leaders on campus, in organizations and in the community, we are here as a new generation of young professionals in the agriculture industry. We are the driving force behind the change that will define agriculture's future. Through this conference, we will be challenged to find our place in the vast network of agriculture and through collaboration, dedication and shared passion, forge a stronger, more unified industry.

AFA believes the future leadership of agriculture cannot be left to chance. The evolving business and production structure, influenced by science, technology, globalization and consolidation will require excellent business skills, international understanding and leadership qualities.

AFA Leaders Conference is a key component of AFA's leader and career development training program. This forum provides students an opportunity to develop key competencies to enhance their marketable skills. Agricultural businesses, organizations, associations, institutions and individuals invest in this program as a means to develop human capital for our industry.

At AFA Leaders Conference, students participate in one of four program tracks with the following emphases:

Track 1 – Personal assessment and career preparation

Track 2 – Communication and relationship-building skills

Track 3 – Managing change and preparing to live and work in a global marketplace

Track 4 – Lifelong learning and industry awareness

Learn more about each specific track in the next pages. All AFA delegates, industry professionals and volunteers are invited to share their thoughts about the 2012 AFA Leaders Conference on Twitter via [@AgFutureAmerica](#) and [#AFALC12](#).

Building Capacity for Our Future



R. Crosby Kemper
Emeritus, UMB Financial Corporation

In 1996, R. Crosby Kemper's vision of an organization that identifies rural college men and women, passionate about agriculture and aspiring to be leaders, took root.

Mr. Kemper, with his son Alexander 'Sandy' Kemper, founded Agriculture Future of America to provide rural youth with academic scholarships, personal and professional training and career development experiences. Many local and regional agricultural leaders embraced this vision and joined the Kempers to launch AFA.

"The goal was to provide some of the best and brightest young people an advantage with their education and career preparation," said Mr. Kemper.

Since 1997, AFA has awarded in excess of \$7.5 million in academic and leader scholarships and nearly 9,000 collegiate men and women and young professionals have participated in AFA leader and career development experiences.

Thank you, Mr. Kemper, for your vision, leadership and investment in America's future leaders.

Thursday, November 1

1:30 p.m.	Registration	Lobby
4:00 p.m.	Welcome Session Russell Weathers, Agriculture Future of America Sandy Kemper, AFA Board of Directors "Mega Trends in Agriculture" Dr. Jay Lehr, Heartland Institute	Exhibit Hall B
5:30 p.m.	Dinner Track 1-3 Track 4	Gillham Hall Chouteau A
6:30 p.m.	Welcome Session (continued) "It's Showtime... and THIS isn't a Dress Rehearsal!" Jon Petz, Bore No More	Exhibit Hall B
7:45 p.m.	Track Orientation and Group Discussion Track 1 Track 2 Track 3 Track 4	Chicago New York Atlanta Chouteau B



Alexander C. Kemper
Chairman, Agriculture Future of America

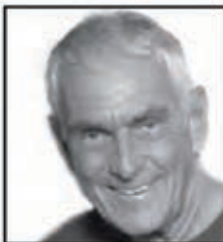

Dr. Jay Lehr
Heartland Institute



Jon Petz
Bore No More



K. Russell Weathers
President & CEO, Agriculture Future of America

Track 1 Student Advisory Team



(L-R) Shannon Watson, Jackson Troxel, Nathan Johnston

“Promoting self awareness while preparing to discover passion in agriculture”

The pillar of the Track 1 program is self assessment. Understanding ourselves — talents, skills, values and motivations — is important to following our passion to the right career and helping us communicate what we have to contribute in our workplaces, communities and families. Self awareness, constantly reviewed, leads to a higher level of cognition and ability to work with others.

The Track 1 program focuses on essential career skills and pathways, lifestyles and recognition of possibilities. Session topics cover time management, resume development, innovation, dining etiquette and other important professional and life skills.

Thank you to all presenters, many of whom volunteer their services to help make this program possible for the next generation of agriculture leaders.

Share your thoughts about AFA Leaders Conference and Track 1 via Twitter using [@AgFutureAmerica](#) and [#AFALC12](#).

Not Pictured:
Gigi Lane

Track 1 Speakers



Nancy Barcus
Agriculture Future
of America



Mark Berry
ConAgra Mills



Christina Bowen
Farm Credit Services



Tom Brand
National Association
of Farm Broadcasting



Howard W. Buffett
Howard G. Buffett
Foundation



Emily Chappie
Union Pacific
Railroad



Morgan Dawson
Purdue University



Sara Decker
Monsanto Company



Tina Domer
CHS Inc.



Jim Emanuel
Water Street Solutions



Mike Gaul
Iowa State University



Gary Grant
Bunge North America



John Hill
LinkedIn



Samantha Hoerr
Archer Daniels
Midland



Laura Hunt
Cargill



Jay Jackman
National Association of
Agriculture Educators



Dr. L.G. Jett, Ph.D.
University of Missouri



Nick Koewler
Land O'Lakes, Inc.



Dennis Landis
Landis Ag Placement
& Consulting



Todd Long
Leadership
Innovations



Joel Mathiowetz
Corn Capital
Innovations



Megan McQuoid
Asgrow & DEKALB



Sandra Musgrave
The Andersons, Inc.



Emily Page
Agriculture Future of
America



Matt Peterson
Farmland Foods



Deanna Pieper
Crop Production Svcs.



Drew Ratterman
Dow AgroSciences



Rachel Robinson
Osborn Barr



Azure Ryerson
Bader Rutter & Assoc.



Linsey Sander
John Deere



Matt Schlueter
Hurst Greenery



Bill Smith
Helena Chemical
Company



Barbara Stahl
Syngenta



Jacob Sukalski
Dow AgroSciences



Theresa Swaim
DuPont Pioneer



Jason Tatge
Farms Technology



Ellen Thompson
National Association of
Agriculture Educators



Susie Thompson



Russ Weathers
Agriculture Future
of America



Rodd Whitney
Monsanto Company



Sara Wyant
Agri-Pulse



Greg Young
Helena Chemical Co.

Track 1 – Friday, November 2

7:00 a.m.	Breakfast	Exhibit Hall B
7:45 a.m.	Morning Message	Chicago
8:00 a.m.	Resume, Career Fair & Interview Skills Facilitator: Mike Gaul, Iowa State University Mark Berry, ConAgra Mills Christina Bowen, Farm Credit Services Emily Chappie, Union Pacific Railroad Sara Decker, Monsanto Company Tina Dörner, CHS Inc. Jim Emanuel, Water Street Solutions Gary Grant, Bunge North America Samantha Hoerr, Archer Daniels Midland Nick Koewler, Land O'Lakes, Inc. Dennis Landis, Landis Ag Placement & Consulting Megan McQuoid, Asgrow & DEKALB Sandra Musgrave, The Andersons, Inc. Matt Peterson, Farmland Foods Deanna Pieper, Crop Production Services Drew Ratterman, Dow AgroSciences Rachel Robinson, Osborn Barr Azure Ryerson, Bader Rutter & Associates Bill Smith, Helena Chemical Company Linsey Sander, John Deere Barbara Stahl, Syngenta Theresa Swaim, DuPont Pioneer Jacob Sukalski, Dow AgroSciences Ellen Thompson, National Association of Agriculture Educators Rodd Whitney, Monsanto Company	Chicago
10:30 a.m.	Break	
10:45 a.m.	Opportunity Fair	Exhibit Hall A
12:00 p.m.	Professional Etiquette in Dining Dr. L.G. Jett, Ph.D., University of Missouri	Chicago
1:30 p.m.	Break	
1:45 p.m.	Unleashing the Most Positive You Susie Thompson	San Francisco
2:50 p.m.	Break	
3:00 p.m.	Executive Panel: Unearthing a New Agricultural Perspective Moderator: Tom Brand, National Association of Farm Broadcasting Howard W. Buffett, Howard G. Buffett Foundation Jay Jackman, National Association of Agriculture Educators Jason Tatge, Farms Technology Sara Wyant, Agri-Pulse	Chicago
4:45 p.m.	Track Meeting	Chicago
5:00 p.m.	Break	
6:00 p.m.	Reception	Exhibit Hall Foyer
7:00 p.m.	Leader in Agriculture Award Dinner *See page 24 for more information	Exhibit Hall B

Track 1 – Saturday, November 3

7:00 a.m.	Breakfast	Exhibit Hall B
7:45 a.m.	Morning Message	Chicago
8:00 a.m.	Cultivating Creativity Todd Long, Leadership Innovations	Chicago
9:30 a.m.	Are You O.K. with Average? Russ Weathers, Agriculture Future of America	Chicago
10:00 a.m.	Break	
10:30 a.m.	5 Choices Nancy Barcus, Agriculture Future of America Joel Mathiowetz, Corn Capital Innovations Gigi Lane	Empire A Empire B Empire C
12:00 p.m.	Lunch	
1:00 p.m.	5 Choices (Cont.)	
2:30 p.m.	Break	
3:00 p.m.	5 Choices (Cont.)	
4:30 p.m.	Track Meeting	
5:30 p.m.	Track 1 Departs Hotel	
6:15 p.m.	Dinner, Service & Entertainment	Finnigans / AMF

Track 1 – Sunday, November 4

6:30 a.m.	Continental Breakfast	Exhibit Hall B
7:00 a.m.	Fellowship (optional)	Van Horn
8:00 a.m.	Morning Message	Chicago
8:30 a.m.	Your Road to Success Matt Schlueter, Hurst Greenery	Chicago
9:45 a.m.	Break	
10:00 a.m.	It's All in the Experience Moderator: Emily Page, Agriculture Future of America Morgan Dawson, Purdue University Laura Hunt, Cargill Greg Young, Helena Chemical Company	Chicago
11:00 a.m.	Discussion and Evaluation Emily Page & Student Advisory Team	Chicago
11:50 a.m.	Break	
12:00 p.m.	Lunch & Closing Session John Hill, LinkedIn	Exhibit Hall B
1:30 p.m.	Adjourn	

Track 2 Student Advisory Team



(L-R) Mark Avilla, Jon Calhoun, Lydia Manson

“Improving our communication and mobilizing our talents to action”

Communication skills can make or break a personal or professional relationship. Be it written, verbal or non-verbal communication or listening skills, employers want a young professional who can communicate with the broadest array of co-workers, clients and others. Effective communication starts with knowing how we communicate and learning to understand communication styles of others.

The Track 2 program supports a student's personal and professional development by focusing on communication proficiency. You will leave Conference with new skills in personal and group communications and be better equipped to communicate messages of the agriculture industry. Hone your communication skills by taking part in sessions about marketing yourself in an online setting, professional writing, dressing for success, presentation skills, ethics and relationships.

You will also have the opportunity to move forward with communication trends by utilizing Twitter throughout the Conference program. You will be provided time to interact via [@AgFutureAmerica](#) and [#AFALC12](#). If you are not familiar with Twitter, or don't use it often, we encourage you to explore this communication channel for future use in your professional career.

Thank you to all presenters, many of whom volunteer their services, for your time, enthusiasm and determination to help prepare the next generation of agriculture leaders.

Track 2 Speakers



Melanie Acklin
SFP



Laurie Bedord
Successful Farming



Adam Carroll
National Financial
Educators



Ashley Collins
AgCareers.com



JD Frailley
FranklinCovey



Janis Gandy
Successful Farming



Darin Grimm
Producer and AgChat
Foundation



Brooke Hansen
Cargill



Jan Hargrave
Jan Hargrave &
Associates



John Hill
LinkedIn



Rhett Laubach
YourNextSpeaker



Jana McGuire
Center for Food Integrity



Derek Mulhern
Agriculture Future of
America



Sherri Schott
Ann Taylor



Matt Schumacher
Monsanto Company



Jared Spader
Fleishman-Hillard



Dr. Jim Spain
University of Missouri



Mark Stewart
Agriculture Future of
America



Todd Wangsgard
FranklinCovey

Thank you also to our Track 2 AFA Alliance volunteers

Brad Blaha, South Dakota State University
Krista Bock, Monsanto Company
Emily Chappie, Union Pacific Railroad
Melissa Chesnut, Second Harvest Community Food Bank
Megan Crudup, Osborn Barr
Katie Dogs, Didion Milling
Ashlee Hespen, McCormick Company
Sarah Hill, Morgan & Myers
Ryan Hrubes, Dow AgroSciences
Paul Kirbach, Monsanto Company
Joel Mathiowetz, Corn Capital Investments

Megan McQuoid, Asgrow and DEKALB
Jessica Nicholson, Land O'Lakes, Inc.
Justin Patterson, American AgCredit
Erica Seitzer, DuPont Pioneer
Erica Shoe, John Deere
Jeff Sorenson, Northstar Genetics
Blake Stowers, Farm Credit
Jacob Sukalski, Dow AgroSciences
Dorothy Tate, McCormick Company
Heather Thompson, GROWMARK
Zane Unrau, Dell Engineering Services

Track 2 – Friday, November 2

7:00 a.m.	Breakfast	Exhibit Hall B
7:45 a.m.	Morning Message: Professional Communications	New York
8:00 a.m.	YOUR Online Presence Moderator: Ashley Collins, AgCareers.com Melanie Acklin, SFP Darin Grimm, Producer and AgChat Foundation Matt Schumacher, Monsanto Company	New York
9:00 a.m.	Break	
9:15 a.m.	Money Talks! Adam Carroll, National Financial Educators	New York
10:30 a.m.	Break	
10:45 a.m.	Professional Writing Impressions Laurie Bedord, Successful Farming Janis Gandy, Successful Farming	New York
12:00 p.m.	Lunch	Exhibit Hall B
1:00 p.m.	Opportunity Fair	Exhibit Hall A
3:00 p.m.	Conversations with Impact: Using Values to Connect Jana McGuire, Center for Food Integrity	New York
5:00 p.m.	Track Meeting	New York
5:30 p.m.	Break	
6:00 p.m.	Reception	Exhibit Hall Foyer
7:00 p.m.	Leader in Agriculture Award Dinner * See page 24 for more information.	Exhibit Hall B



Track 2 – Saturday, November 3

7:00 a.m.	Breakfast	Exhibit Hall B
7:45 a.m.	Morning Message	New York
8:00 a.m.	Actions Speak Louder than Words Jan Hargrave, Jan Hargrave & Associates	New York
9:45 a.m.	Break	
10:00 a.m.	The Public Victory: 7 Habits of Highly Effective People JD Frailey, FranklinCovey Todd Wangsgard, FranklinCovey	Chicago San Francisco
12:00 p.m.	Lunch	
1:00 p.m.	The Public Victory: 7 Habits of Highly Effective People (continued) JD Frailey, FranklinCovey Todd Wangsgard, FranklinCovey	Chicago San Francisco
3:00 p.m.	Dressing for Success Sherri Schott, Ann Taylor Jared Spader, Fleishman-Hillard	Chicago New York
3:50 p.m.	Break	
4:00 p.m.	Ethics in the Workplace Brooke Hansen, Cargill	New York
5:00 p.m.	Track Meeting	New York
5:45 p.m.	Track 2 Departs Hotel	
6:15 p.m.	Dinner, Service & Entertainment	Finnigans / AMF

Track 2 – Sunday, November 4

6:30 a.m.	Continental Breakfast	Exhibit Hall B
7:00 a.m.	Fellowship (optional)	Van Horn
7:45 a.m.	Morning Message	New York
8:00 a.m.	Authenticity Rules: How to be a Real (and Real Good) Presenter Rhett Laubach, YourNextSpeaker	New York
9:45 a.m.	Break	
10:00 a.m.	Taking Your Leadership With You Moderator: Dr. Jim Spain, University of Missouri Brad Blaha, South Dakota State University Krista Bock, Monsanto Company Emily Chappie, Union Pacific Railroad Melissa Chesnut, Second Harvest Community Food Bank Megan Crudup, Osborn Barr Katie Dogs, Didion Milling Ashlee Hespen, McCormick Company Sarah Hill, Morgan & Myers Ryan Hrubes, Dow AgroSciences Paul Kirbach, Monsanto Company Joel Mathiowetz, Corn Capital Investments	New York Megan McQuoid, Asgrow and DEKALB Jessica Nicholson, Land O'Lakes, Inc. Justin Patterson, American AgCredit Erica Seitzer, DuPont Pioneer Erica Shoe, John Deere Jeff Sorenson, Northstar Genetics Blake Stowers, Farm Credit Jacob Sukalski, Dow AgroSciences Dorothy Tate, McCormick Company Heather Thompson, GROWMARK Zane Unrau, Dell Engineering Services
11:30 a.m.	AFA Discussion - Question and Answer Mark Stewart & Derek Mulhern, Agriculture Future of America	New York
12:00 p.m.	Lunch & Closing Session John Hill, LinkedIn	Exhibit Hall B
1:30 p.m.	Adjourn	

Track 3 Student Advisory Team



(L-R) Ty Littau, Carolyn Gehrke, Michael Baird

“Pursuing passion with eyes wide open”

Managing and being adaptive to change is one thing. Being an agent of change is another. As young men and women getting ready to make the leap from 16 years of an academic-focused life to a professional life, we must discuss what will change in our lives as well as how to be an agent of that change. Likewise, today's agriculture and food industry is global and complex. In order to be competitive as a business or an individual, this must be recognized and embraced. Track 3 focuses on managing change and working in a global marketplace to ensure college juniors and seniors are prepared for and equipped with the tools needed to make their mark in their future organizations and communities.

Get ready to engage in conversations that cover everything from how to evaluate job offers to family dynamics in agriculture and business. Also, be prepared to participate in discussions with top industry executives about current topics in agriculture, as well as sessions on investment knowledge, mentorship and creating a positive impact.

Be sure to share your thoughts about AFA Leaders Conference and Track 3 via Twitter using [@AgFutureAmerica](#) and [#AFALC12](#).

Thank you to all presenters, many of whom volunteer their services, for making this Track 3 program possible!

Track 3 Speakers



Dr. Jay Akridge
Purdue University



Brad Allen
ConAgra Mills



Jim Banachowski
The Andersons, Inc.



Joe Barker
CHS Inc.



Justin Chesnut
Elanco



Stephanie Chipman
University of Missouri



John Chrosniak
DuPont Crop Protection



Tom Drake
DuPont Pioneer



Dan Dye
Horizon Milling, Cargill



Richard Fagerlin
Peak Solutions



Darren Frye
Water Street Solutions



Mark Garrett
Farmland Foods, Inc.



Jon Hagler
Mo. Dept. of Agriculture



Kevin Hahn
Hill's Pet Nutrition, Inc.



Paul Hammes
Union Pacific Railroad



Dr. Ron Hanson
Univ. of Nebraska



Spencer Harris
Crop Production Svcs.



Gordon Hibbard
Kansas 4-H Foundation



John Hill
LinkedIn



Doug Hofbauer
Frontier Farm Credit



Stan Howell
Dow AgroSciences



Nathan Jones
AgLocal



Les Kaschner
FranklinCovey



Leslie Kaufman
Kansas Cooperative Council



Greg Krissek
ICM, Inc.



Dan Leibfried
John Deere



Jill Leitzen
Kuhn North America



Diane Loiselle
Hill's Pet Nutrition, Inc.



Kent Martin
Syngenta



John McKinney
Helena Chemical Co.



Tyler Osby
The Tyler Osby Team



Justin Patterson
2013 AFA Alliance Chair



Daryl Pint
Ceva



Lura Roti
Freelance Writer



Haydn Shaw
FranklinCovey



Mark Stephens
Archer Daniels Midland



Kay Stinson
Seaboard Foods



Bill Stouffer
ConAgra Mills



Pamela Striffler
Monsanto Company



Gary Swango
GRCWMARK



Jake Underwood
Crop Production Svcs.



Mike Vande Logt
Land O'Lakes, Inc.



Craig Wallace
Ceva



Russell Weathers
Agriculture Future of America



Jim Welch
Growth Leader

Track 3 – Friday, November 2

7:00 a.m.	Breakfast	Exhibit Hall B
7:45 a.m.	Morning Message	Atlanta
8:00 a.m.	Influencers of Change Across Generations Jim Welch, Growth Leader	Atlanta
9:00 a.m.	Opportunity Fair	Exhibit Hall A
11:00 a.m.	Follow Passion. Take Action. Moderator: Stephanie Chipman, University of Missouri Brad Allen, ConAgra Mills Gordon Hibbard, Kansas 4-H Foundation Naithan Jones, AgLocal Lura Roti, Freelance Writer	Atlanta
12:00 p.m.	Lunch	Exhibit Hall B
1:00 p.m.	You Have A Job Offer...Do You Take It? Tom Drake, DuPont Pioneer	Atlanta
2:00 p.m.	Break	
2:15 p.m.	Executive Forum: Introduction and Moderator: Dr. Jay Akridge, Purdue University Jim Banachowski, The Andersons, Inc. Joe Barker, CHS Inc. Justin Chesnut, Elanco John Chrosniak, DuPont Crop Protection Dan Dye, Horizon Milling, Cargill Darren Frye, Water Street Solutions Mark Garrett, Farmland Foods, Inc. Jon Hagler, Missouri Department of Agriculture Paul Hammes, Union Pacific Railroad Kevin Hahn, Hill's Pet Nutrition, Inc. Spencer Harris, Crop Production Services Doug Hofbauer, Frontier Farm Credit Stan Howell, Dow AgroSciences Leslie Kaufman, Kansas Cooperative Council Greg Krissek, ICM, Inc.	Atlanta Dan Leibfried, John Deere Jill Leitzen, Kuhn North America Diane Loiselle, Hill's Pet Nutrition, Inc. Kent Martin, Syngenta John McKinney, Helena Chemical Company Daryl Pint, Ceva Mark Stephens, Archer Daniels Midland Kay Stinson, Seaboard Foods Bill Stoufer, ConAgra Mills Pamela Striffler, Monsanto Company Gary Swango, GROWMARK Jake Underwood, Crop Production Services Mike Vande Logt, Land O'Lakes, Inc. Craig Wallace, Ceva
5:15 p.m.	Track Meeting	
5:30 p.m.	Break	
6:00 p.m.	Reception	Exhibit Hall Foyer
7:00 p.m.	Leader in Agriculture Award Dinner *See page 24 for more information	Exhibit Hall B

Track 3 – Saturday, November 3

7:00 a.m.	Breakfast	Exhibit Hall B
7:45 a.m.	Morning Message	Atlanta
8:00 a.m.	Investment Knowledge Tyler Osby, The Tyler Osby Team	Atlanta
9:45 a.m.	Break	
10:00 a.m.	Leadership: Great Leaders. Great Teams. Great Results Haydn Shaw, FranklinCovey Les Kaschner, FranklinCovey	Atlanta New York
12:30 p.m.	Lunch	
1:30 p.m.	Leadership: Great Leaders. Great Teams. Great Results (continued) Haydn Shaw, FranklinCovey Les Kaschner, FranklinCovey	Atlanta New York
3:00 p.m.	Break	
3:15 p.m.	Family Dynamics in Agriculture and Business Dr. Ron Hanson, University of Nebraska	Atlanta
5:15 p.m.	Track Meeting	
5:45 p.m.	Track 3 Departs Hotel	
6:15 p.m.	Dinner, Service & Entertainment	Finnigans/AMF

Track 3 – Sunday, November 4

6:30 a.m.	Continental Breakfast	Exhibit Hall B
7:00 a.m.	Fellowship (optional)	Van Horn
8:00 a.m.	Morning Message	Atlanta
8:15 a.m.	Making a Positive Impact Richard Fagerlin, Peak Solutions	Atlanta
10:30 a.m.	AFA and Your Future Russell Weathers, Agriculture Future of America Justin Patterson, 2013 AFA Alliance Chair	Atlanta
11:45 a.m.	Break	
12:00 p.m.	Lunch & Closing Session John Hill, LinkedIn	Exhibit Hall B
1:30 p.m.	Adjourn	

Track 4



“Lifelong learners in action”

Being a lifelong learner is integral to career success. It means constant evaluation, reinvention and innovation. After spending 16 years in a formal academic environment, college men and women must begin learning in new ways each day in our ever changing world.

The Track 4 program is a unique capstone experience for seniors who have been involved in multiple tracks of the AFA program. Building on the competency development of previous tracks, Track 4 is a highly interactive, participant-directed program. Sessions focus on making the transition from college to career, future work skills and discussing individual and collective impacts to global agricultural issues. Discussion groups, participant-led facilitation and pre-conference preparation add value to the experience. Extensive executive mentoring is an integral part of Track 4.

Thank you to all our presenters, many of whom volunteer their services, for making this Track 4 program possible.

Don't forget to share your thoughts about AFA Leaders Conference and Track 4 on Twitter via [@AgFutureAmerica](#) and [#AFALC12](#).

Track 4 Speakers



Nancy Barcus
Agriculture Future of America



Howard G. Buffett
Howard G. Buffett
Foundation



Barry Flinchbaugh
Kansas State University



Geri Hayes
Bunge North America



Annie Hernandez
The Lumpkin Family
Foundation



John Hill
LinkedIn



Ryan Hrubes
Dow AgroSciences



Ed Ide
CGB Enterprises, Inc.



Carol Keiser-Long
CBAR Cattle Company & C-
ARC Enterprises



Joel Mathiowetz
Corn Capital Innovations



Jeff Miller
Innovative Leadership
Solutions, Inc.



Erica Shoe
John Deere



Josh Sosland
Sosland Companies, Inc.



Jared Spader
Fleishman Hillard



Kevin Stiles
Midwest Dairy Association



Tom Traub
CHS Inc.



Karen Wishart
Monsanto Company

Track 4 – Friday, November 2

7:00 a.m.	Breakfast	Exhibit Hall B
8:00 a.m.	Building the New Leader Jeff Miller, Innovative Leadership Solutions, Inc.	Chouteau B
9:30 a.m.	Opportunity Fair	Exhibit Hall A
11:00 a.m.	Lunch Overview Staff, Agriculture Future of America	Chouteau B
11:45 a.m.	AFA Board of Directors Luncheon Lunch with AFA Board of Directors and Special Guests	Empire
1:00 p.m.	Transition to Work Geri Hayes, Bunge North America Tom Traub, CHS Inc. Karen Wishart, Monsanto Company	Chouteau B
2:15 p.m.	Break	
2:30 p.m.	Open Mic: The Role of Policy on Global Agriculture & Hunger Moderator: Josh Sosland, Sosland Companies, Inc. Howard G. Buffett, Howard G. Buffett Foundation Barry Flinchbaugh, Kansas State University	Chouteau B
4:00 p.m.	Classifieds: Leaders Looking for Leaders Ed Ide, CGB Enterprises, Inc. Carol Keiser-Long, CBAR Cattle Company & C-ARC Enterprises Kevin Stiles, Midwest Dairy Association	
5:00 p.m.	Track Meeting	Chouteau B
5:30 p.m.	Break	
6:00 p.m.	Reception	Exhibit Hall Foyer
7:00 p.m.	Leader in Agriculture Award Dinner 2012 Leader in Agriculture Award Recipients <div><div>Howard G. Buffett Farmer and President Howard G. Buffett Foundation Decatur, Illinois</div></div> <div><div>Dr. Barry Flinchbaugh Professor of Agricultural Economics Kansas State University Manhattan, Kansas</div></div>	Exhibit Hall B

Track 4 – Saturday, November 3

7:00 a.m.	Breakfast	Exhibit Hall B
8:00 a.m.	Leadership Skills to Get You There Annie Hernandez, The Lumpkin Family Foundation	Chouteau B
12:00 p.m.	Lunch	
1:00 p.m.	Servant Leadership Jeff Miller, Innovative Leadership Solutions, Inc.	Chouteau AB
5:00 p.m.	Track Meeting	Chouteau B
5:30 p.m.	Break	
6:30 p.m.	Depart hotel	
7:00 p.m.	Dinner and Entertainment with AFA Alliance Negro League Baseball Museum	

Track 4 – Sunday, November 4

6:30 a.m.	Continental Breakfast	Exhibit Hall B
7:00 a.m.	Fellowship (optional)	Van Horn
8:00 a.m.	Pursuing Lifelong Leadership Ryan Hrubes, Dow AgroSciences Joel Mathiowetz, Corn Capital Innovations Erica Shoe, John Deere Jared Spader, Fleishman-Hillard	Chouteau B
9:30 a.m.	Future of the AFA Alliance Joel Mathiowetz, Corn Capital Innovations	
10:00 a.m.	Break	
10:15 a.m.	Track 4 Decompressed Nancy Barcus, Agriculture Future of America Jeff Miller, Innovative Leadership Solutions, Inc.	Chouteau B
12:00 p.m.	Lunch & Closing Session John Hill, LinkedIn	Exhibit Hall B
1:30 p.m.	Adjourn	

The AFA Alliance



The final pillar of AFA's leader development program is lifelong learning. This particular life skill presents itself through AFA in a program for young professionals called the AFA Alliance.

The Alliance is a personal and professional organization for men and women in the beginning years of their careers. Like AFA collegiate programs, the Alliance is a program offered by Agriculture Future of America (AFA).

Alliance members believe agriculture is an exciting and dynamic industry and want to be part of a national network of professionals prepared for roles of leadership in their respective organizations and communities.

The Alliance website, www.afaalliance.com links you to the AgriNetwork. You can become an Alliance member for \$50 annually, or a lifetime member for \$475.

Member Benefits include:

- ▶ Membership in the Alliance AgriNetwork
- ▶ Discounted rate to attend annual AFA Alliance Forum
- ▶ Lifetime professional development (forum, webinars, etc.)
- ▶ Monthly e-newsletter
- ▶ Lifetime professional network

Alliance Giving Back

The AFA Alliance annually sponsors two future leaders in agriculture to participate in the Leaders Conference. This sponsorship is funded through the Brian Perry Leaders Conference fund. The recipients of the 2012 Brian Perry Sponsorships are:



Will Miller
University of
Nebraska-Lincoln



Ellen Gilliland
The Ohio State University

AFA Board of Directors



Daniel Cosgrove
Vice President, Biotech
Business Development,
DuPont Ag Biotech



Daniel Dye
President, Horizon Milling,
Cargill



Pete Goetzmann
Vice President, ADM Grain
Company



Geralyn Hayes
Vice President, Human
Resources, Bunge North
America



Stan Howell
Vice President, North America,
Dow AgroSciences



Carol Keiser-Long
President, C-BAR Cattle
Company and C-ARC
Enterprises



Alexander Kemper
Chair & Founder, The
Collector's Fund and Chair
& CEO, Pollenware



J. Mariner Kemper
Chairman & CEO, UMB
Financial Corporation



R. Crosby Kemper
Emeritus, UMB Financial
Corporation



Timothy J. Merrett
Vice President, Global Platform -
Turf & Utility, Agriculture and Turf
Division, Deere & Company



Dr. Thomas L. Payne
Vice Chancellor and CAFNR
Dean, University of Missouri



Orion Samuelson
Agricultural Service Director,
WGN Radio and RFD-TV



L. Joshua Sosland
Vice President, Sosland
Companies, Inc.



Kevin Stiles
Sr. Vice President, Marketing
and Industry Coordination,
Midwest Dairy Association



Thomas Traub
Vice President, Human
Resources, CHS Inc.



Mike Vande Logt
Executive Vice President &
COO Seed, Land O'Lakes, Inc.



David Vander Griend
President & CEO, ICM, Inc.



K. Russell Weathers
President & CEO, Agriculture
Future of America



Karen Wishart
Vice President, Human
Resources, Monsanto Company

Sheraton Kansas City Hotel at Crown Center

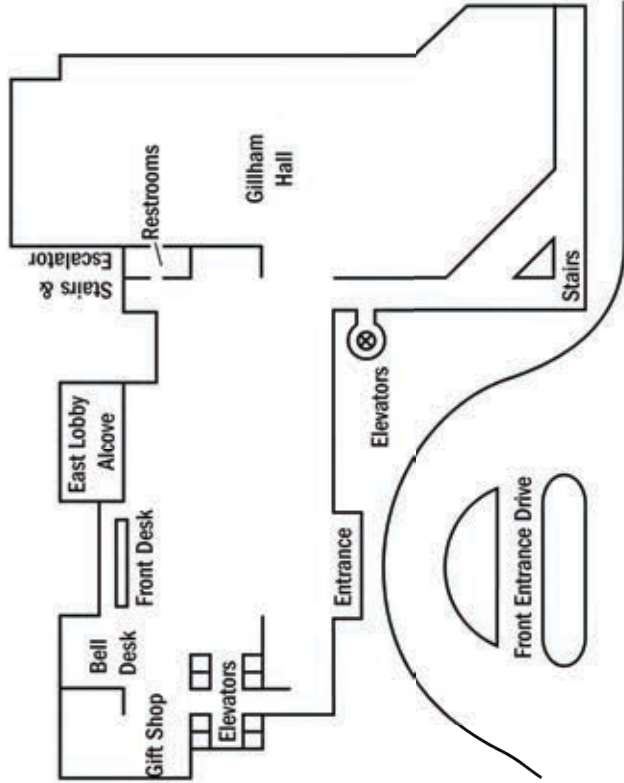

Lobby Level - 1st Floor

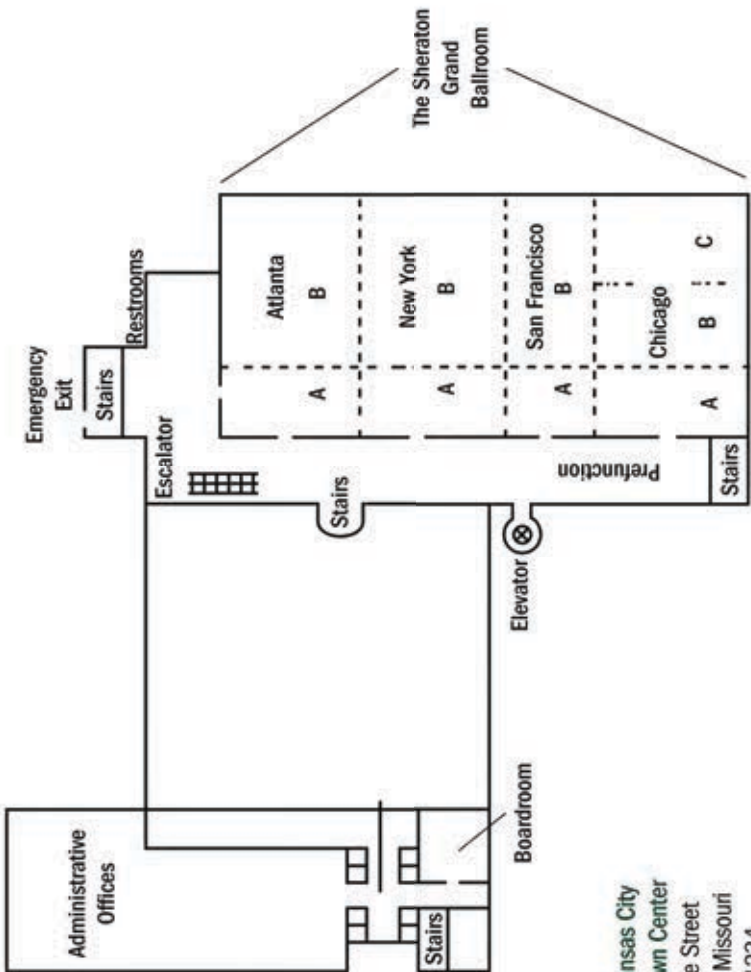

Ballroom Level - 3rd Floor

Sheraton Kansas City
Hotel at Crown Center
2345 McGee Street
Kansas City, Missouri
(816) 421-1234

AFA Conference Office
East Lobby Alcove

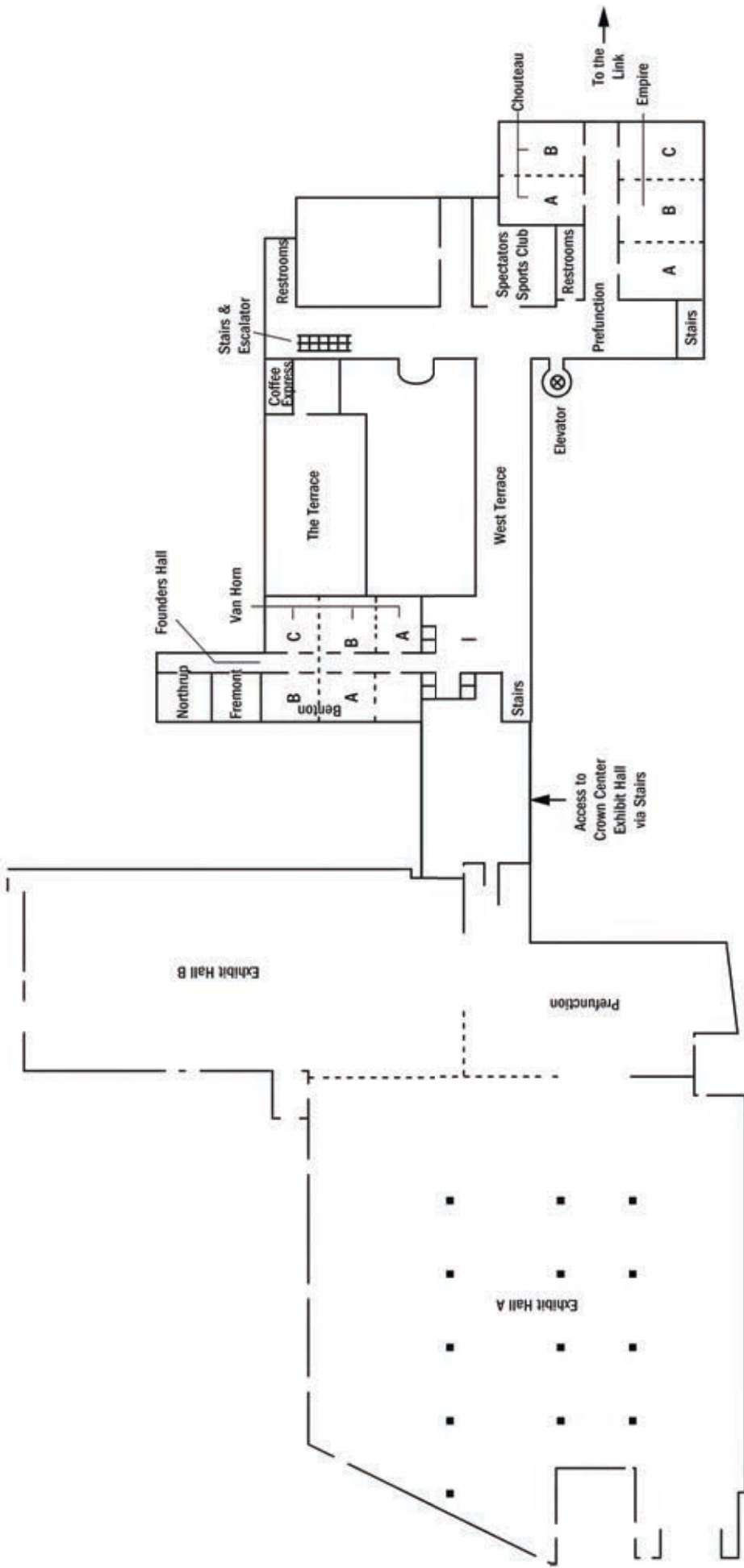

Mezzanine Level - 2nd Floor



AFA creates partnerships that identify,
encourage and support outstanding
college men and women preparing for
careers in the agriculture and food industry.



Agriculture Future of America

www.agfuture.org

www.afaalliance.com

[@AgFutureAmerica](https://twitter.com/AgFutureAmerica)

[#AFALC12](https://twitter.com/AgFutureAmerica)