

Running Board Installation Instructions 2010

Ram Promaster Cargo Van (2014-C) 159WB

YouTube video link of installation

(www.youtube.com/watch?v=GcScgcK-TfE)

Read all instructions before beginning installation.

INSTALLATION PACKAGE

Running Board	2
Brackets Front (Middle Height & Length)	2
Brackets Middle (Tallest & Longest)	2
Brackets Rear (Shortest)	6
Support Plates (Tall)	10
Support Plates (Short) (Used on front brackets only)	2
Rubber Gap Strip (Trim-Lok x135BTSingle) 36" & 95"	2
Bolt Pack (Boards & Brackets)	2

Necessary Tools

Combination wrenches or Sockets with 3/8", 1/2" deep well, 9/16"
Phillips Head #2 Screw Driver (Drill or Impact driver works best)
Safety glasses

Bolt Pack Brackets

5/16" Bolts	12
5/16" Serrated Nuts	14
5/16" Flat Washers	26
10-24 x 1 1/4" Phillips head screws	6
10-24 Jack Nuts (Fastenal # 0162808)	6
1/4" Flat Washer	6
3/8" Bolts (Black Finish)	12
Bolt Plates (1833-m)	2
Pinch Weld Clamps	12

Bolt Pack Running Boards

5/16" x 3/4" Hex Bolt	20
5/16" Serrated Flange Nut	20

Step 1: Start by assembling 10 of the clamps to each tall support plate and 2 of the clamps to each short support plates using the 3/8" Black finish bolts. Be sure to assemble as shown. (Fig 1)

Fig 1

3/8" Black bolts

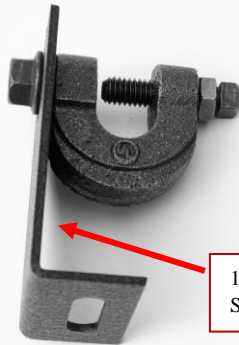

10 Tall & 2 Short Support plates

Step 1: Start with the rear brackets. There will be 2 or 3 support gussets on each side depending on the wheelbase of the vehicle as shown. (Fig 2)

Fig 2

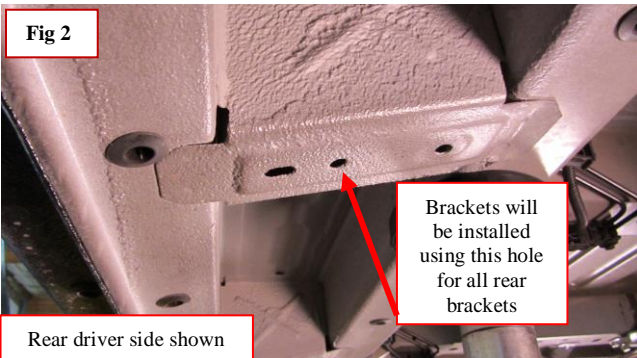

Brackets will be installed using this hole for all rear brackets

Rear driver side shown

Step 3: Next obtain 1 of the short rear brackets. Take 10-24 x 1 1/4" bolt with a 1/4" washer and place it through the very end hole of the bracket and screw on the jack nut (Collapsible insert) until snug with bracket. Now put the bracket up into the mounting hole as shown (Fig 2 & 3) with the bracket pushed up against the vehicle body and screw in place with #2 Phillips screw driver until fully tightened.

Fig 3

Before tightening make sure bracket is pushed up against vehicle

Rear driver side shown

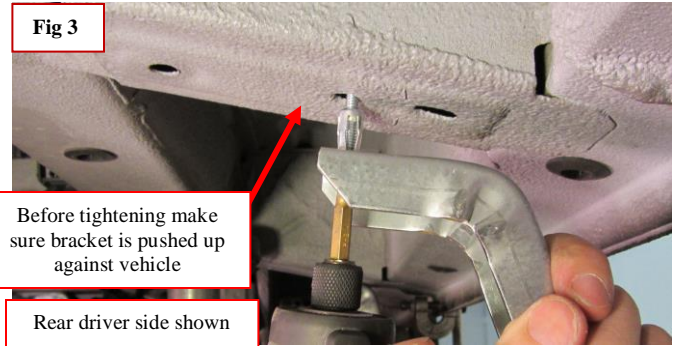

Step 4: Now install clamp with tall support plate on center of pinch weld. It should be in line with the top of the bracket just installed or 90 degree to the vehicle after installation. Fully tighten with 3/8" wrench and lock nut with 9/16" wrench. (Fig 4)

Fig 4



Fully tighten clamp against center of pinch weld.

Step 5: Next loosen 3/8" bolt and push support plate up until it touches the vehicle and then retighten 3/8" bolt to hold plate in place. (Fig 5)

Fig 5

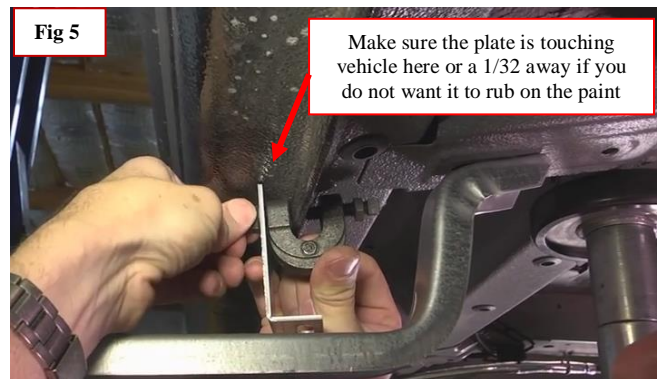

Make sure the plate is touching vehicle here or a 1/32 away if you do not want it to rub on the paint

Step 6: Place a 5/16" bolt with washer through support plate and bracket. Then loosely secure with washer and serrated nut to hold in place. Only tighten nut until the head of bolt is through the nut. Repeat these steps for all rear brackets with the same mounting. (Fig 6)

Fig 6

Leave loose to add with installation of boards



For installation help please call our Tech Support at 888-855-4621, or Email us at Service@AutoCustoms.com

Step 7: Next install the middle bracket in front of the rear brackets just installed. Obtain one of the bolt plates and insert it into the hole as shown.

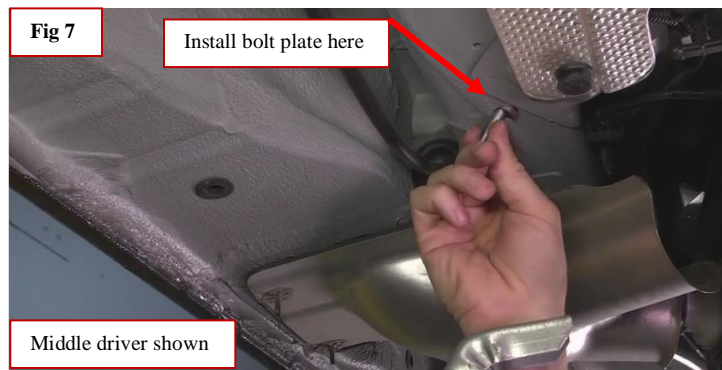

Step 8: Next we need the tallest and longest bracket to install. Place the bracket on the very front hole and secure with 5/16 washer and nut. Leave snug not tight. (Fig 8)



Step 9: Next install the tall support plate and clamp as was done for the rear brackets in (Fig 4, 5 & 6)

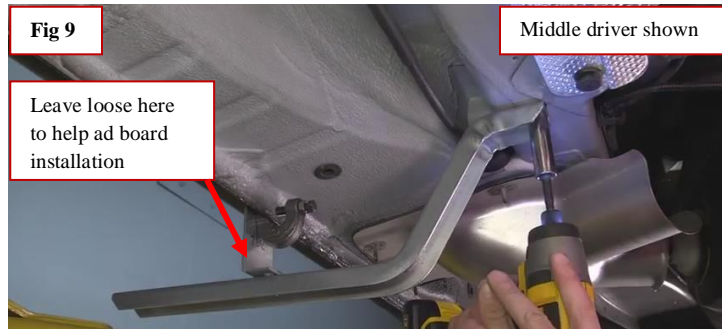

Step 10: Next we will install the front bracket. First we want to mark the locations. Measure back 13" on the pinch weld from the front wheel well opening as shown. (Fig 10)

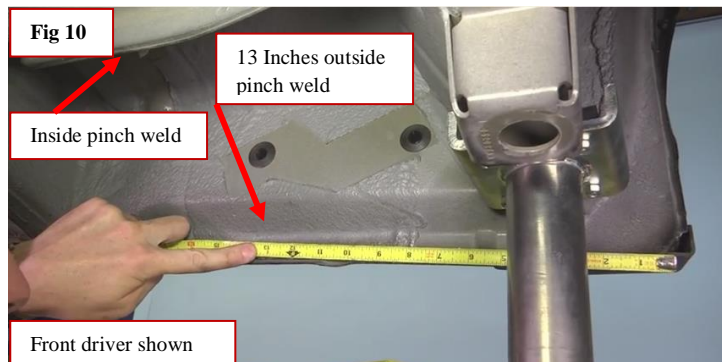

Step 11: Next we need to mark the inside pinch weld at 3 1/4". This is shown in (Fig 11) on the passenger side and is also indicated on the driver side picture in (Fig 10)



Step 12: Next install support plates with clamp to the pinch welds the same as all the other brackets. Tall plate on outside pinch weld and short support plate on inside pinch weld. Then install bracket to both support plates using a 5/16" bolt with washer and secure with washer and nut.

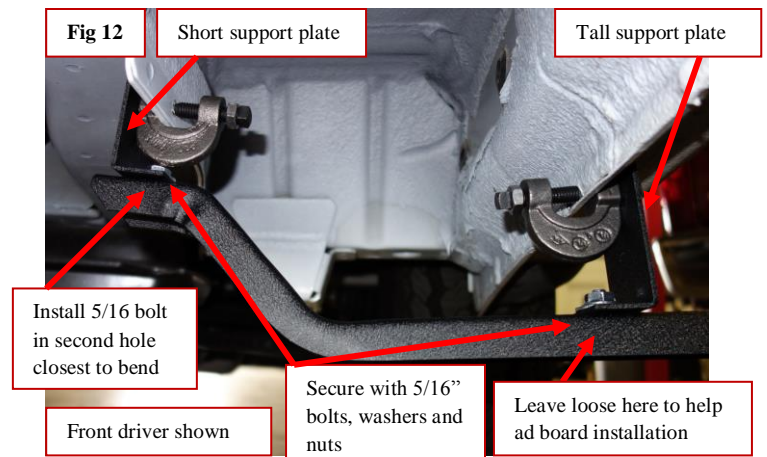

Step 13: Next install the rubber gap strip on the running boards. Start with the front rubber gap strip even with raised ribs on running board and the rear will end 3" after the raised ribs. (Fig 13 & 14)

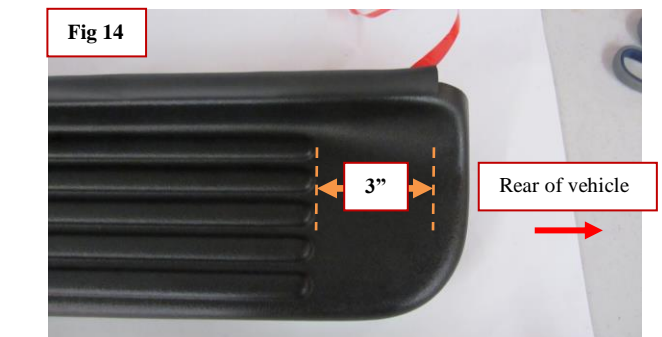
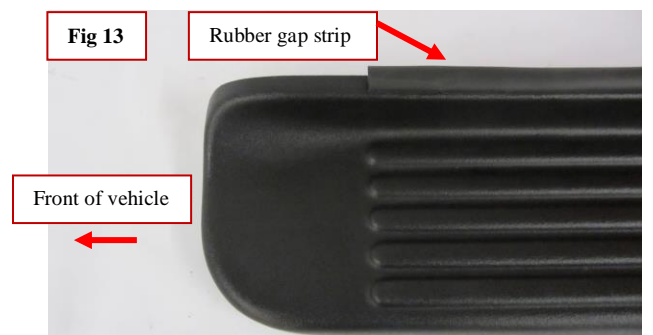

Step 14: This will show you the location and what the brackets should look like after you have them installed on the vehicle for the 100" board. The driver and passenger will look the same. If you are installing the shorter 39" board on the driver side you will only need the front 2 brackets installed.

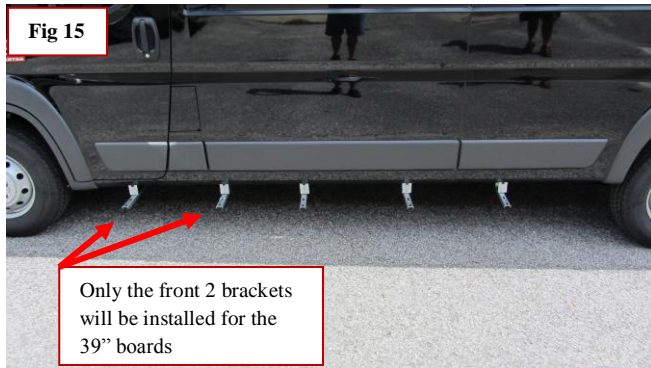

Step 15: Now install running boards on brackets. You may have different boards than shown. However, they will have the same type of mounting unless additional instructions are provided. Obtain the bracket to board bolt pack. Take out the provided 5/16" x 3/4" bolts. Slide the head of the bolts down the channels on the underside of the board. (Fig 15)



Step 16: Place the board on the installed mounting brackets. Align the bolts with the holes on the brackets and drop them into place. Next thread the provided 5/16" flange nuts loosely onto the bolts to secure brackets to the board

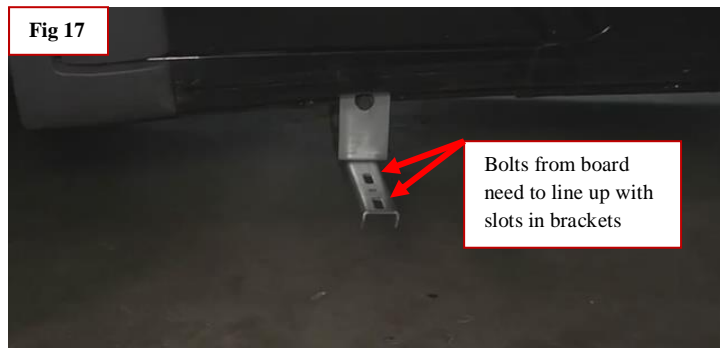

Step 17: Next adjust 100" board only to the end of the aluminum under the board to the edge of the last bracket on the back of vehicle.



Step 18: Next tighten all fasteners that were left loose to ad in board installation. Then make any adjustments up or down by loosening support plate bolt to adjust in slot. Once the boards are in place to your liking, tighten all fasteners on the boards and brackets. This will complete your installation. Enjoy!

