

A new icon in the making



Spring 2023

KM
YACHTBUILDERS

Start battery bank	1x 2.5kW AGM service battery (buffer), 12V
Battery chargers/ inverters	1 x Victron Isolated 48 DC/ 12 V DC 30 A (360 W)
Solar regulator	Victron MPPT solar charge controller
Solar cells**	Solbian SP @48V flexible on pilothouse, additional solar cells on salonroof*
Navigation/ Communication	
Analog compass + Depth, Wind, Log instruments B&G Triton	Std
Additional navigation package 1*	VHF + AIS - Vesper, Plotter + GPS - B&G, Auto Pilot - Jefa LD100
Additional navigation package 2*	Radar set on mast or stern pole
Safety	
Additional safety package*	Liferaft 4 pers - Viking RescYou + Jonbuoy MK5 + Floating device + line - Emergency signals
Miscellaneous	
Additional Dingy package*	Zodiac Cadet 270 Aero + Torqueedo Travel 604
Additional cockpit tent package*	

* Optional ** Partly Optional

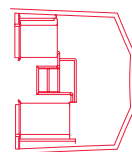
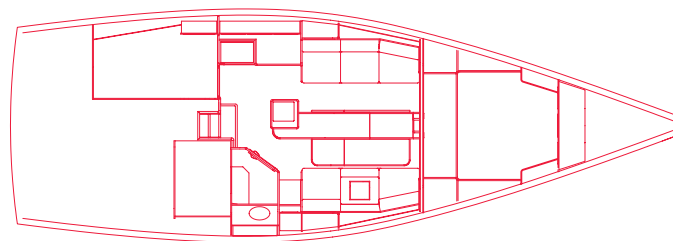

VAT has to be paid in the country of residence of the buyer.
Delivery is in the water at KM Yachtbuilders, Makkum, the Netherlands

July 2022 - Prices/materials/specification are subject to change without further notice

Sailing the dream

Introducing the Bestevaer 36 S/Y. Compact size, big attitude. The perfect yacht to be sailing single or double-handed, dry out on the Wadden Sea. Or sail around the world.

The BV 36 will be everything you expect from a Bestevaer: high performance, strength, and a beautiful design. But with this new kid in town, we're also on a mission to develop our most sustainable yacht yet. Come and join our expedition, let's go places.



When legendary high latitude sailor and naval architect Gerard Dijkstra set out to design his own dream yacht, he had a crystal clear vision: a yacht offering excellent performance, even in the toughest of conditions. A yacht that he could comfortably sail single-handedly. A strong yacht. And: a gorgeous yacht. That yacht was the very first Bestevaer, the mother ship of the now legendary Bestevaer range.

Navigate shallow waters. Dry out.

Today Gerard Dijkstra has set his mind to designing himself a new dream yacht: a smaller-sized Bestevaer. Same comfort, strength, and performance. Just smaller. A yacht for him to explore the places he never got to explore before: coastlines, lakes, shallow waters. A yacht that would allow him to moor in smaller marinas. Also, with the gorgeous Wadden Sea nearby, he wanted a yacht that was able to dry out. And if all that wasn't enough in itself, he also wanted this Bestevaer to be as sustainable as possible. That yacht is currently in development in close collaboration with our shipyard. It is the Bestevaer 36 S/Y.

KM Yachtbuilders

Bestevaer 36 S/Y

36 S/Y

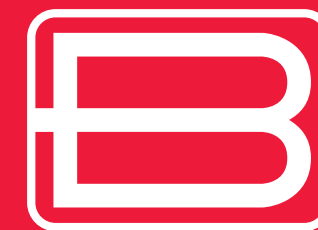

Bestevaer.com

Preliminary specifications

Specifications (Preliminary)

Bestevaer 36 S/Y

Starting Prices
Bestevaer 36 S/Y - €475.000 excl. VAT

General	
Type	Bestevaer 36 S/Y
Naval architect	Dykstra Naval Architects
Builder	KM Yachtbuilders
Flag state	EU
Classification	CE-catagory A (Ocean Going, centre board locked in down position)
Dimensions	
Length over deck	10,95 m (36 ft)
Length over all	11,80 m
Length on design waterline	10,65 m
Beam over all	3,80 m
Draft	0,70 m / 2.40 m
Displacement light ship	7.8 T
Air draught	16.00 m
Headroom	1,90 m
Aluminium Construction	
Hull & superstructure	Recycled aluminium H321-5083 ≤ 8 mm New aluminium H321-5083 > 9 mm
Centreboard	2000 kg Galvanized Steel fin ballasted with lead. Centerboard can be locked in down position. Electric/ Hydraulic operated.
Deck and coaming deck	Grit blasted anti skid
Cockpit floor	Grit blasted anti skid
Topsides superstructure	Pearl blasted
Internal ballast	300 kg TBD
Rudder	Transom rudder with centerboard, tiller steering
Watertight compartments	3, collision bulkhead & engine room bulkhead
Swimming / boarding platform*	Folding platform

	Extra opening Hatch for for external acces to pilot berth compartment*
Fuel tanks	1 x 140L Diesel (Blue) (polyethylene)
Fresh water tanks	2 x 100L (polyethylene)
Black tank	1x 50 L (polyethylene), 1x flush deck suction
Radar/antenna pole	*aluminium on stern
Paint/Wrapping System	
Hull outside	Bare aluminum, waterline red stripe
Antifouling	Yes. Wrapped silicone foil TBD
Pilot house	Bare aluminium (Std.) Wrapped color of choice*
Superstructure deck	Bare aluminum

General Arrangement	
General Layout	
Foward cabin	Double berth 2.05 x 1.65 m
	Ample storage under the bed, space along the sides
Pilot house	SB Seat 80 cm with wet locker under seat
	PS seat 50 cm seat, folding
	Central sliding door moving down,Removable sideboards with window*
Salon	PS setter 1.90 m to expand to double bed
	SB setter 1.90 m
	Fixed table with two folding side tops
Galley Gimballled	2 burner induction heater - Gimballled
	Build-in elect. oven - 230V
Fridge	Integrated under pilot berth near galley, drawer model
SB Toilet	Blake Lavac manual operated vacuum toilet
	Small sink
	Warmwater system & shower* (only in combi with gen set or shore power)
PS Pilot berth	Spacious bed with compact storage space

Int. material & finishes	
Interior	Modern (Std.)
	Vintage interior*
	Classic interior*

Deck Equipment	
Anchor System	
Bow anchor	1 x 25 kg Galvanised steel anchor, Epsilon
Windlass	Maxwell 48 V or equal
Chain stopper	Yes
Chain	1x 50 m, 8 mm, galvanised
Stern / spare anchor	15 kg, Epsilon*
Rigging	
Mast	Selden alu C208 fractional, deck stepped, silver anodized
Spreaders	Sweep back 22 dgrs 2 pair
Standing rigging	Nitronic rod
Boom	Alu boom silver anodized
Hoyt boom*	KM Yachtbuilders alu silver Anodized
Furlers	Jib, Furllex 304S
	Code Sail, continuous line furler*

Sails	
Material	Sustainable and circular (TBC Elvstrom or OneSails)
Mainsail	38 m² pinhead and single fixed backstay with bridle (Std.)
	41 m² Square head, Running backstays
	2x single line reefing, 1x slab reefing
105% Jib	28 m² , roller furling, UV strip
Hoyt jib*	23 m², roller furling, UV strip
Code zero*	50 m² ,roller furling, UV strip
Staysail*	10 m² ,roller furling, set flying, UV strip, Runners
Storm jib*	5 m² “Storm Bag”
Gennaker*	TBD m², & top down roller furling, short “bowsprit”

Winches	
Manual drum winches	2x Antal #40 Alu ST, drum pearl blasted (cockpit)
	2x Antal #48 Alu ST, drum, pearl blasted (cockpit)Electric*
	1x Antal #44 Alu ST, drum, pearl blasted (deck)

Systems	
Propulsion	
E -Drive	15 kW, 48V, Oceanvolt SP 15
Cooling system	Internal bilge cooling and external water flow
Propellor	Folding prop.(Std) Pitch prop*
Max speed under E-drive	7.0 kts
Cruising speed on E-engine	5.5 kts (5 hrs on 29kWh Battery Bank)
Generator	
Generator*	Fisher Panda 6000 5kW (Range extender)
Range with gen. set only	450 Nm at 5 kts
Fuel filters *in combi with gen set	Double Racor filter system
Bilge System	
Electric bilge pump	1 x bilge pump with automatic switch for engine room, 1x salon, fwd. cabin
Manual bilge pump	1 x in cockpit (for salon and lazarette)
Fire Fighting System	
Fire extinguishers	2 x 2 kg foam
	1 x extinguisher opening to engine room
	1x fire blanket
Electrical Installations	
Wiring	Double pole 48V DC + 12V DC installation
Switchboard	12V instrument panel pilothouse
Propulsion battery bank (mid range*)	14kWh battery (Std) 29 kWh* 43 kWh* (only possible without gen. set)