



# **RControl iOS App Overview v3.2**

# LOGIN

Get the RControl app from the App Store.

Once you've downloaded and installed the app, use the credentials from the quick install manual to log in to your account.

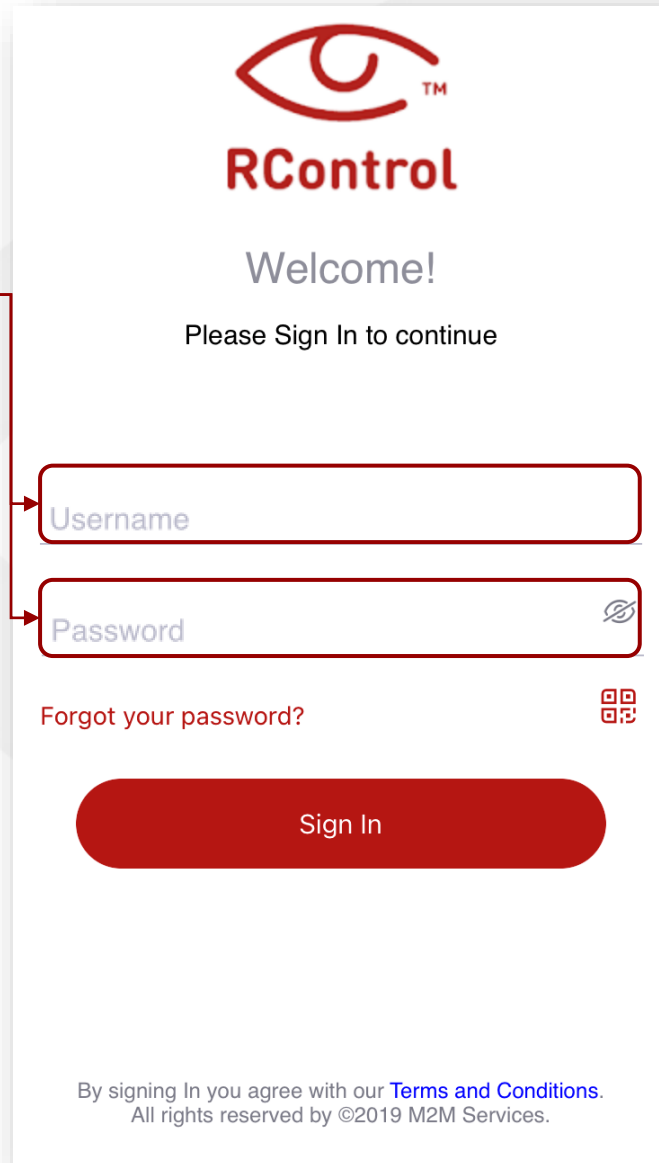

The image shows a mobile app login screen for RControl. At the top is the RControl logo, which consists of a stylized red eye icon with a 'G' inside, followed by the text 'RControl' in a bold, red, sans-serif font. Below the logo, the text 'Welcome!' is displayed in a grey, sans-serif font, followed by 'Please Sign In to continue' in a smaller, grey, sans-serif font. There are two input fields: the first is labeled 'Username' and the second is labeled 'Password'. The password field has a small eye icon to its right, indicating a toggle for password visibility. Below the password field, there is a link that says 'Forgot your password?' with a small icon of four squares to its right. A large, rounded red button with the text 'Sign In' is centered below the input fields. At the bottom of the screen, there is a small line of text: 'By signing In you agree with our [Terms and Conditions](#). All rights reserved by ©2019 M2M Services.'

  
**RControl**  
Welcome!  
Please Sign In to continue

Username

Password 

Forgot your password? 

Sign In

By signing In you agree with our [Terms and Conditions](#).  
All rights reserved by ©2019 M2M Services.

# FIRST LOOK

Upon first start, the only active functionality will be the events log.

To access the account menu, click here.

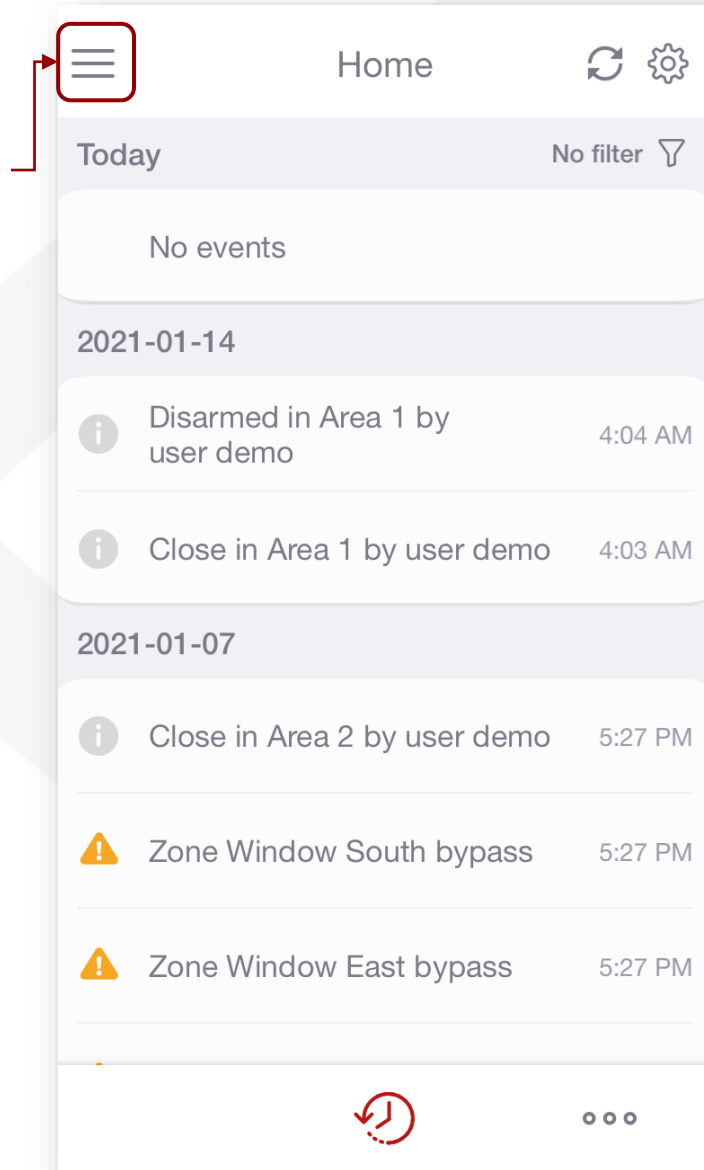

Go to settings to configure the App.

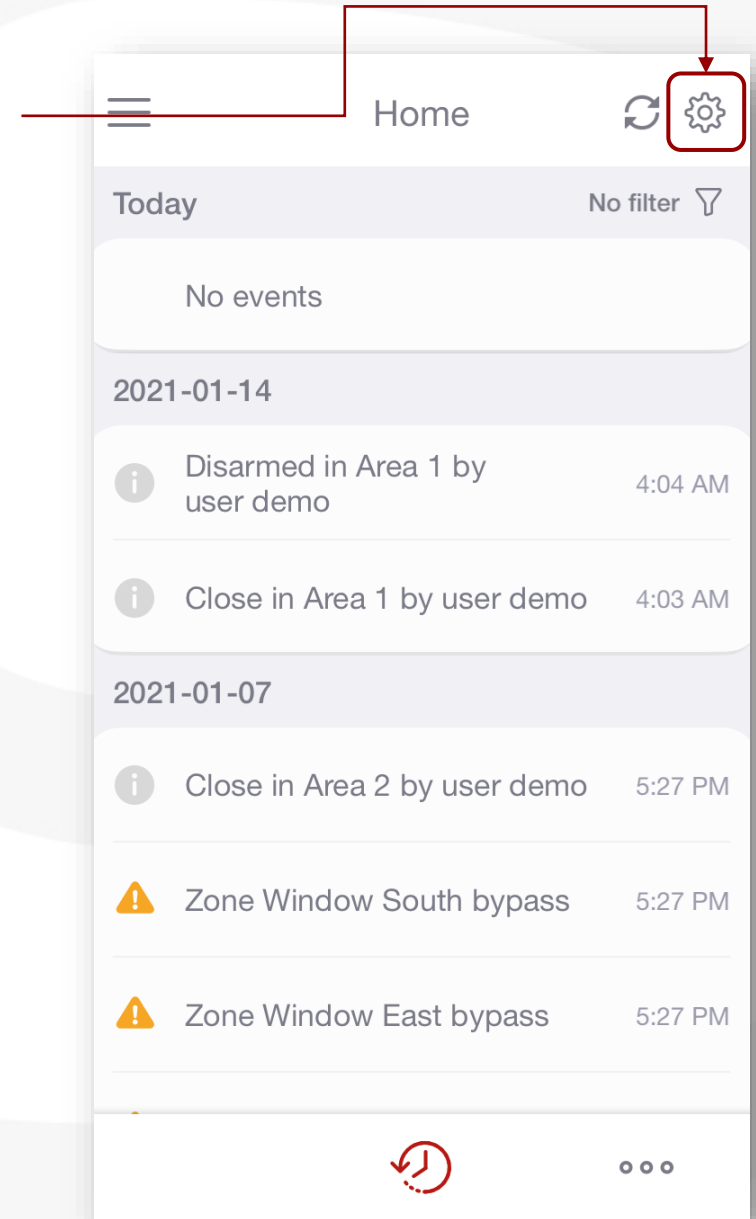

# USERNAME AND PASSWORD

Go to the "My Account" icon if you want to change your username and password.

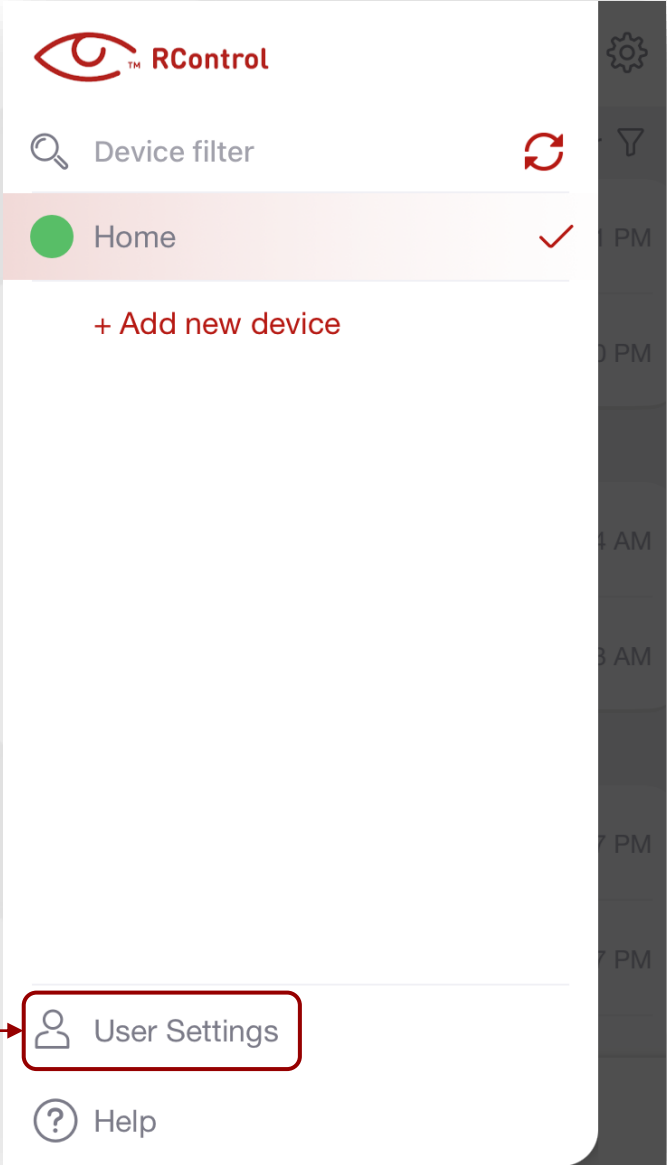
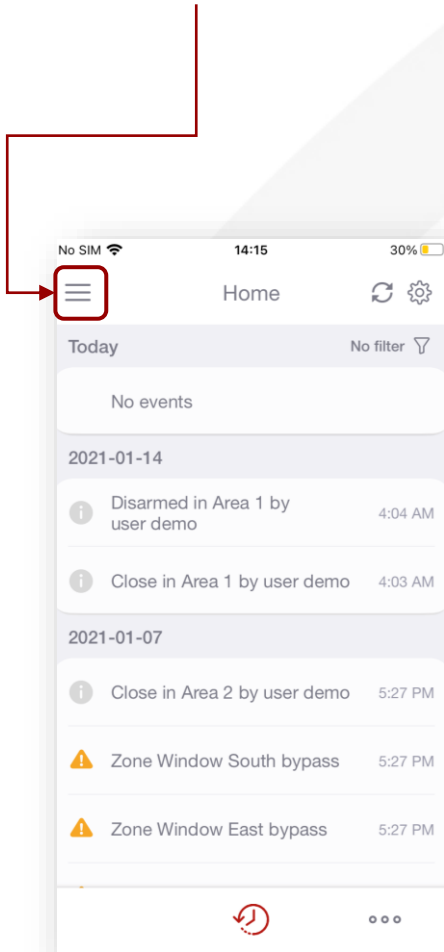

Press "Edit" in the User settings menu.

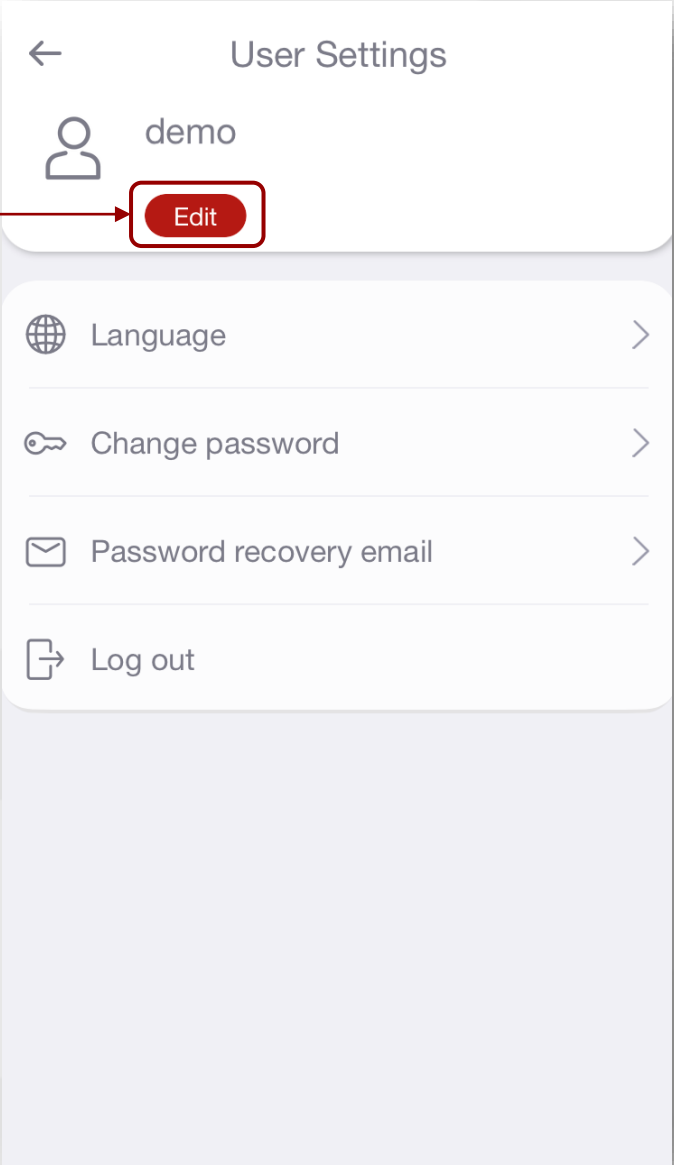

# USERNAME AND PASSWORD

← Edit user name

Full Name  
demo

Login Name  
demo

Save



Fill in the desired fields and press "Save" when done.

← Change password

Old password

New password

Confirm password

Save

# NOTIFICATIONS

Go to "Notifications" and choose how you would like to receive different events on your smartphone.

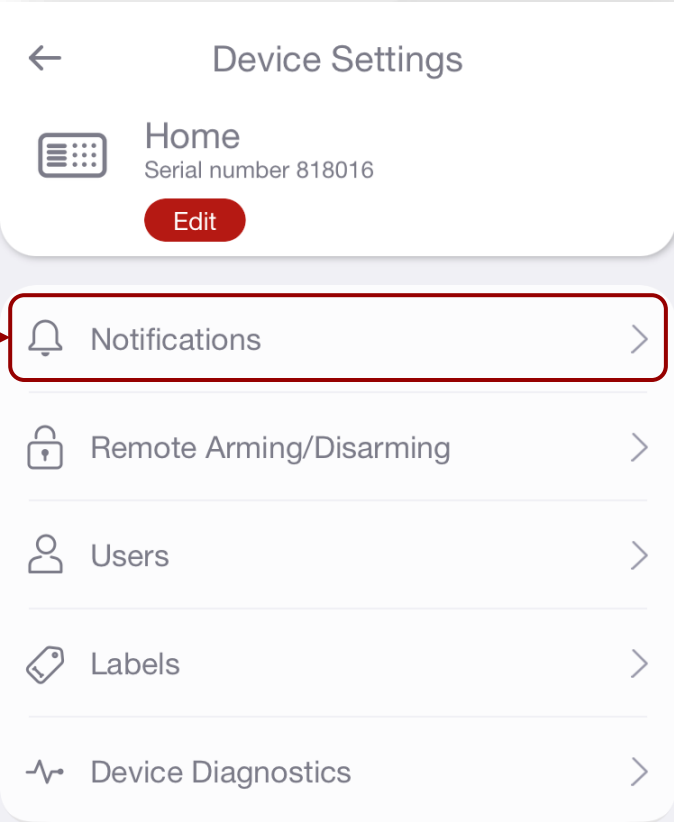

Select the "+ Add" button for your preferred way of notification.

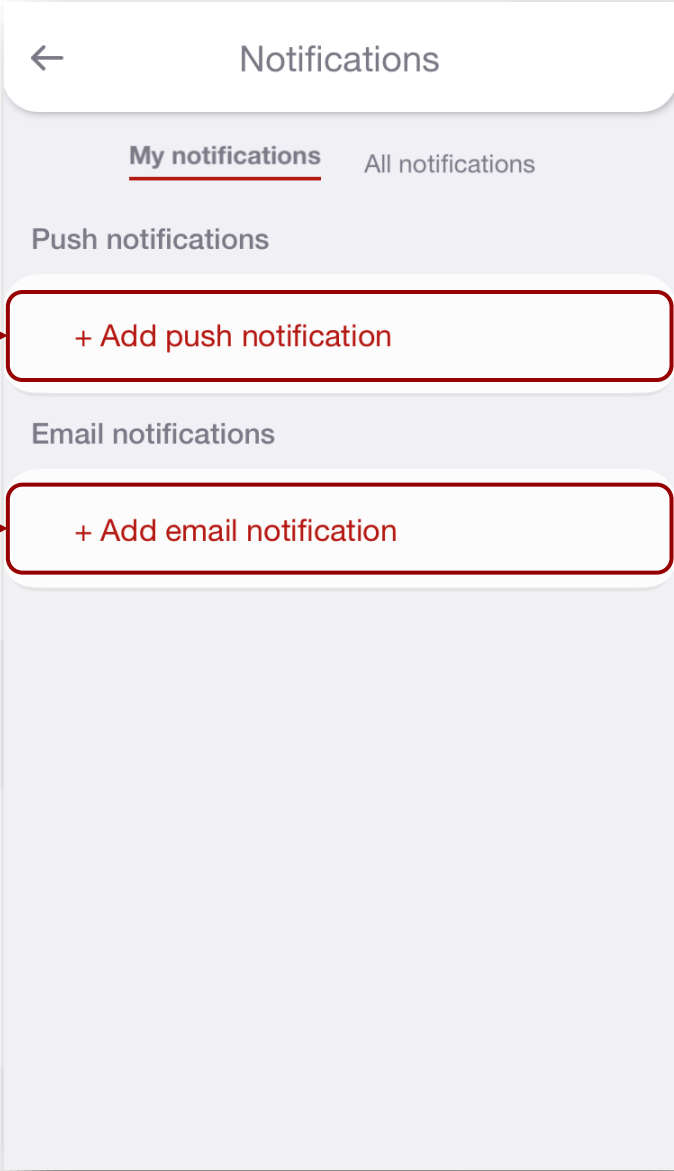

# NOTIFICATIONS

Select type of events to be reported for each notification channel.

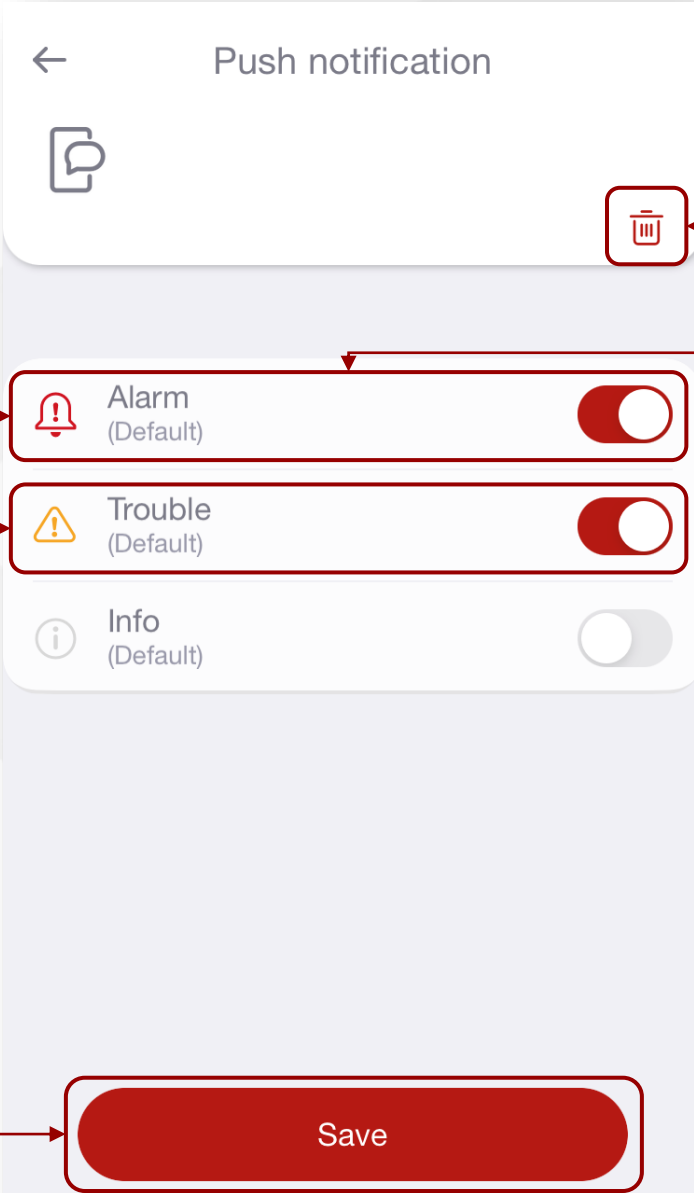

Can be used when your phone is in "vibrate" mode and you want to be sure that you won't miss something.

Your notification channels will be displayed as a list.

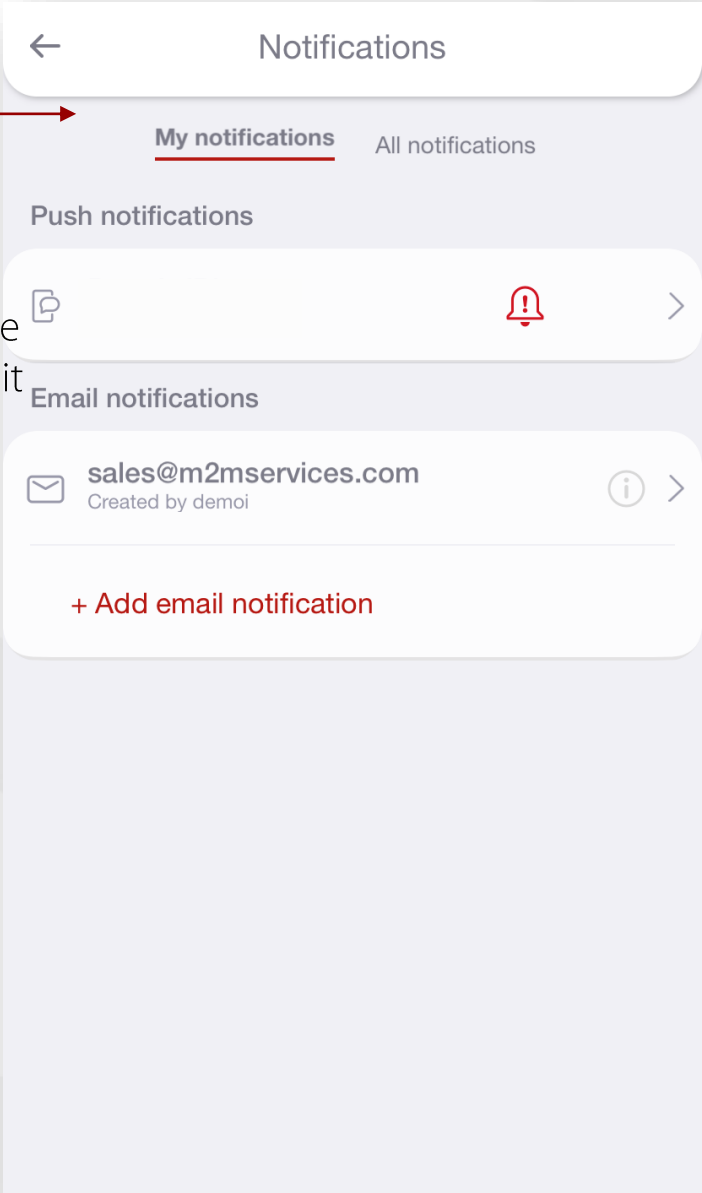

To make changes, select the notification you'd like to edit or remove. Thus, returning to the previous screen.

# HOW TO ENABLE REMOTE ARMING/DISARMING

*To enable this functionality, additional wiring and configuration of the alarm panel must be done by your installer.*

Go to "Remote Arming/Disarming" to setup this functionality.

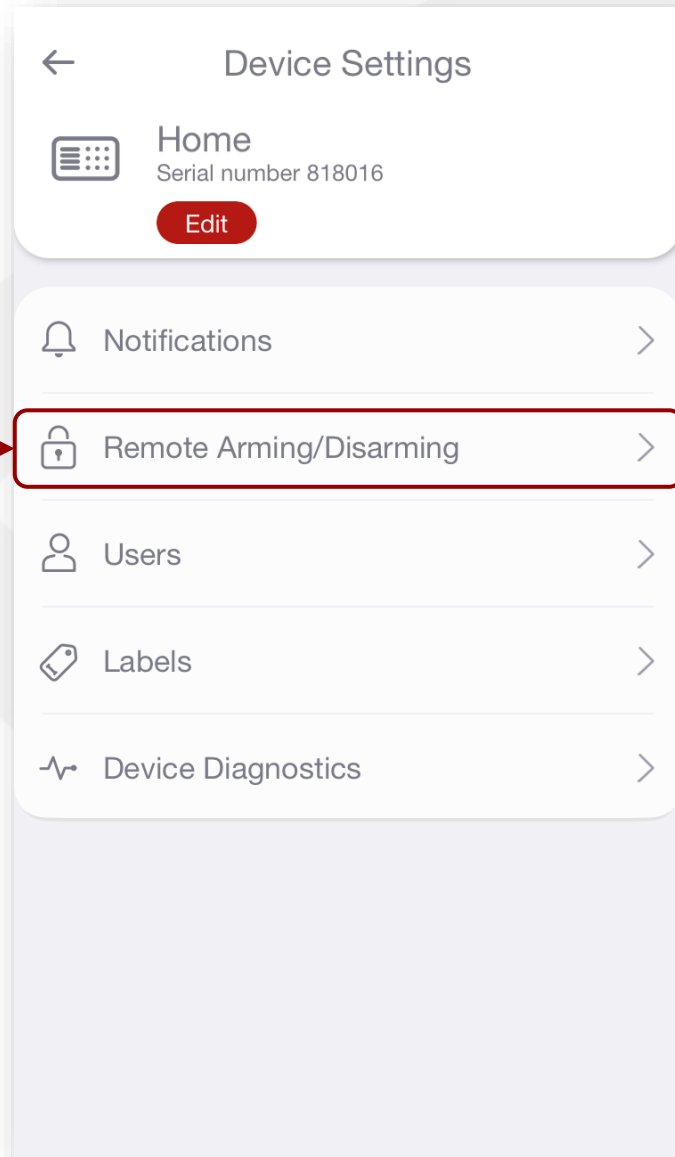

Slide to enable the Remote arming/disarming.

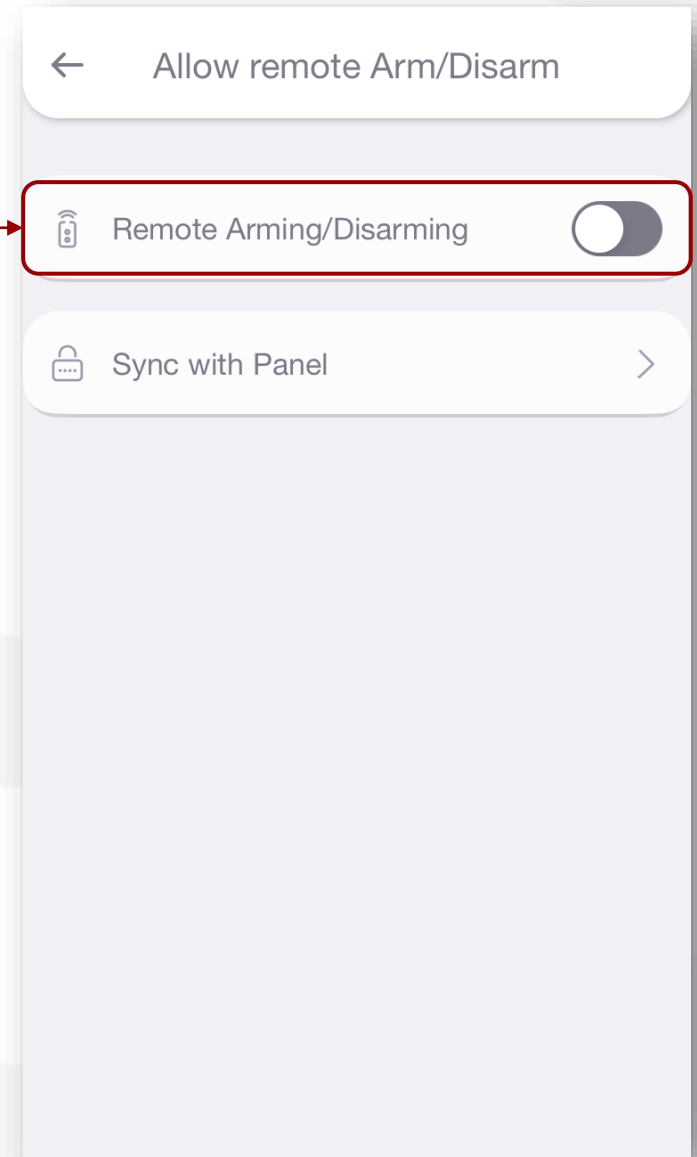



# REMOTE ARMING/DISARMING (KEYBUS WIRING – DSC PANELS)

To enable this functionality, additional wiring and configuration of the alarm panel must be done by your installer.

Confirm to enable the functionality.

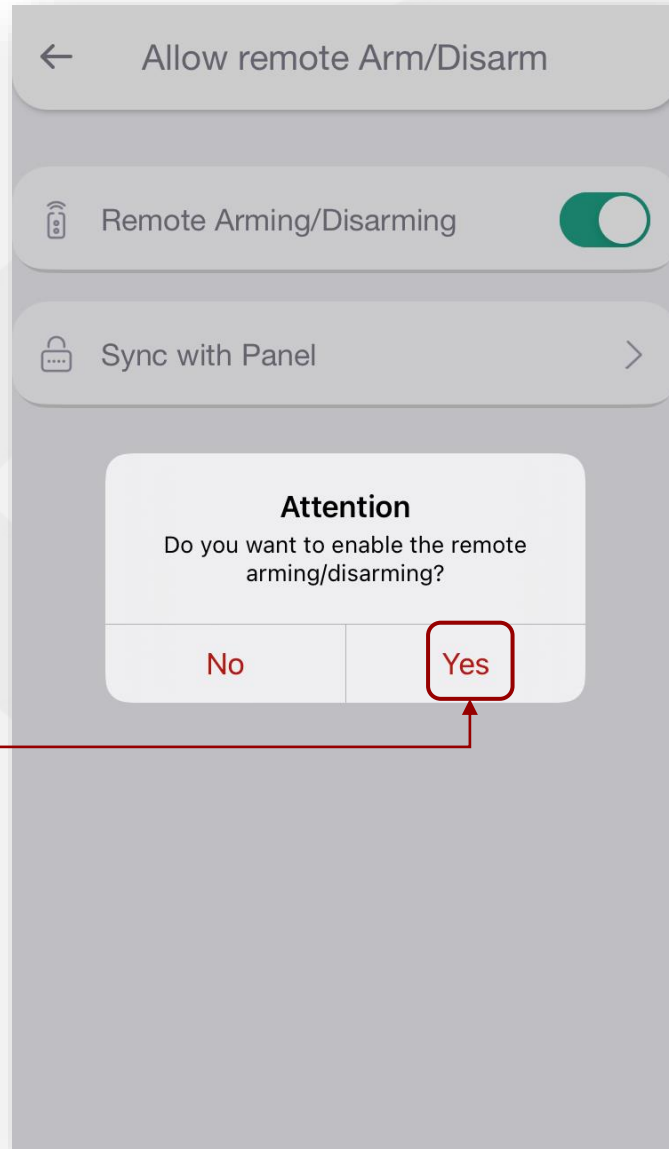

After confirmation, the Remote Arming/Disarming feature will be available at the homepage.

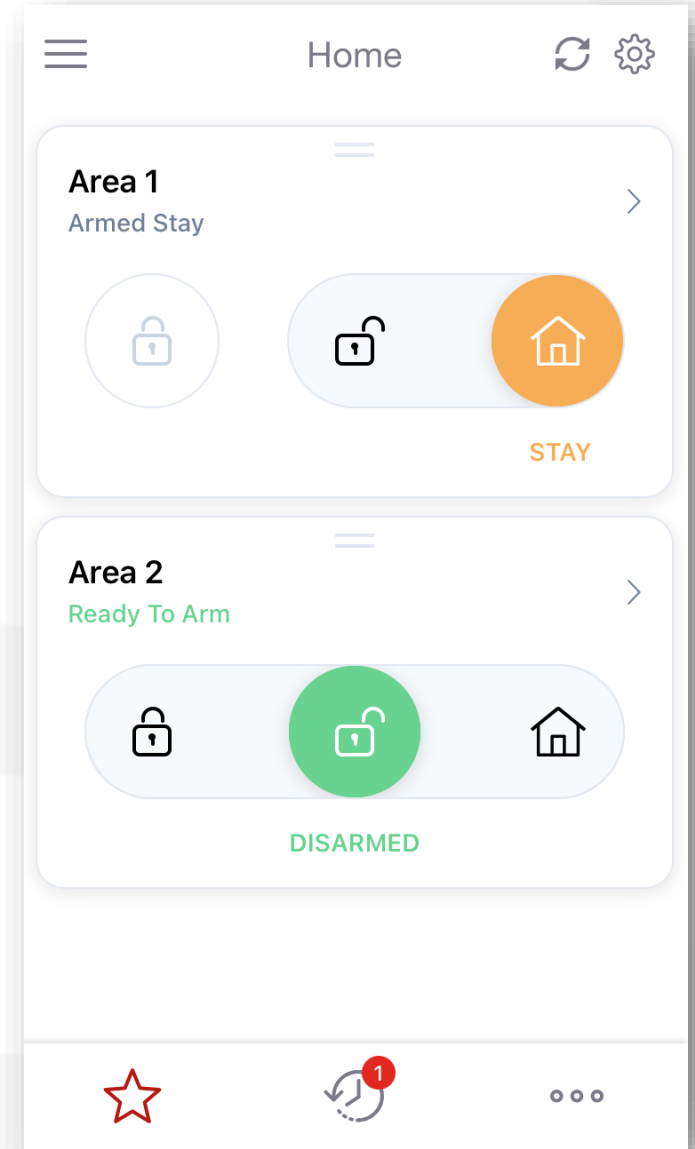

# REMOTE ARMING/DISARMING (KEYBUS WIRING – HONEYWELL PANELS)

To enable this functionality, additional wiring and configuration of the alarm panel must be done by your installer.

Confirm to enable the functionality.

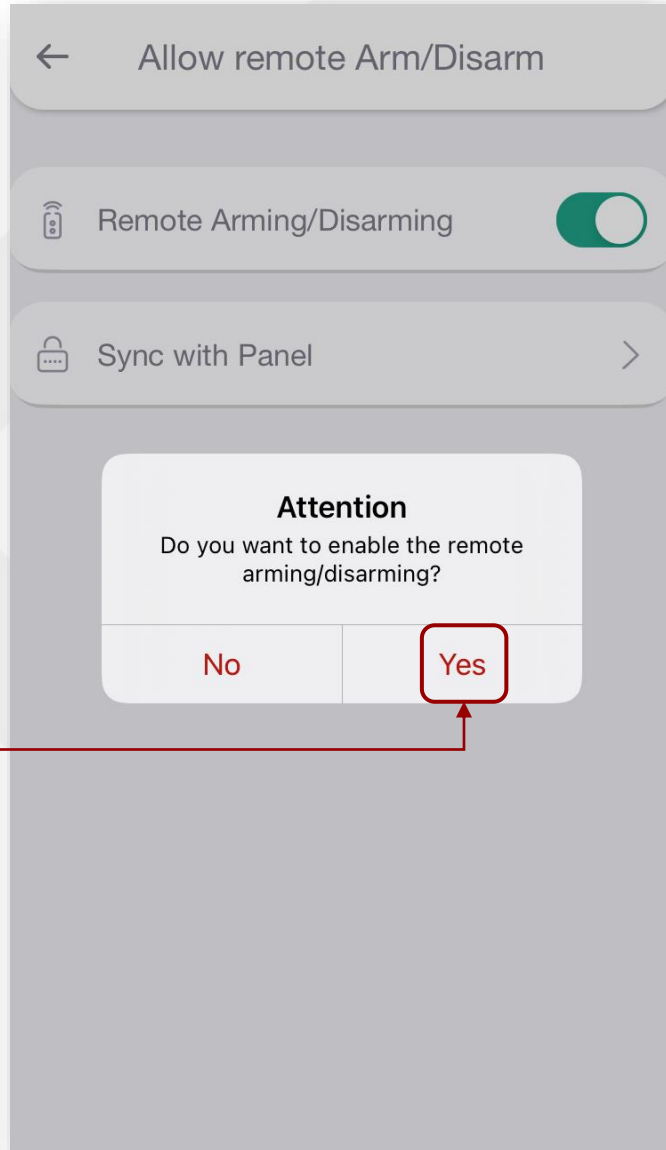

In order to synchronize the settings from the panel ask your alarm installer to enter and exit programming mode from the keypad of your alarm panel.

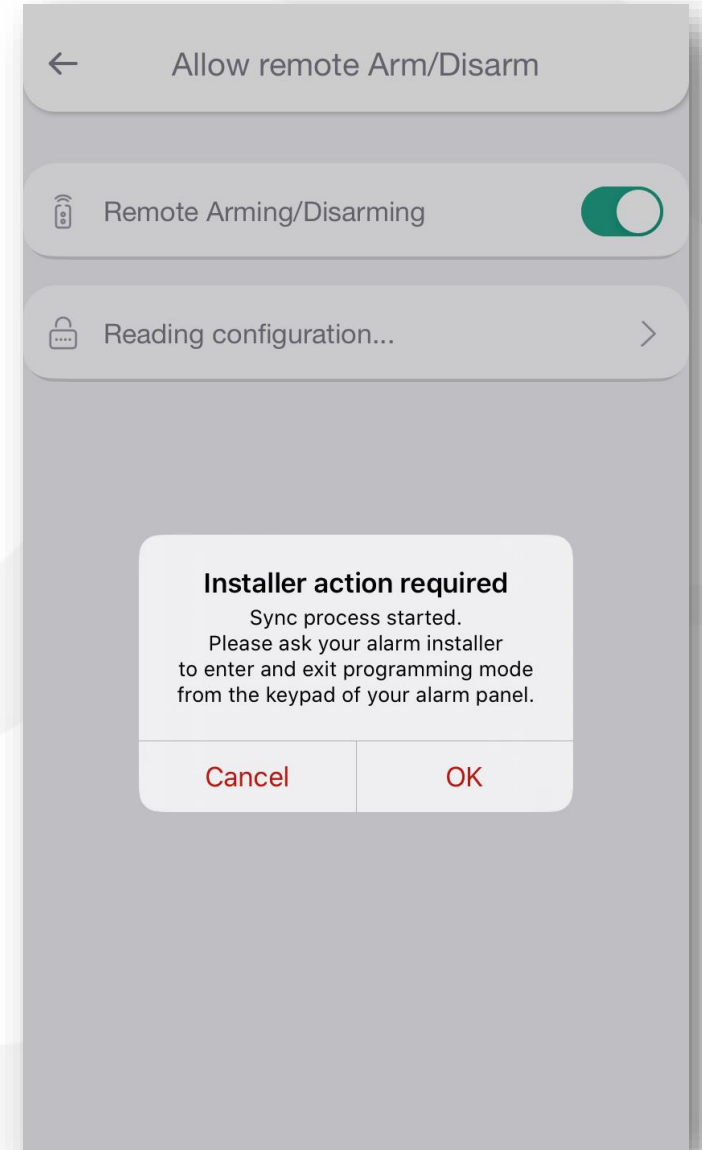

# REMOTE ARMING/DISARMING (KEYBUS WIRING – HONEYWELL PANELS)

To enable this functionality, additional wiring and configuration of the alarm panel must be done by your installer.

The installer should enter and exit programming mode within the timeframe specified in the mobile app.

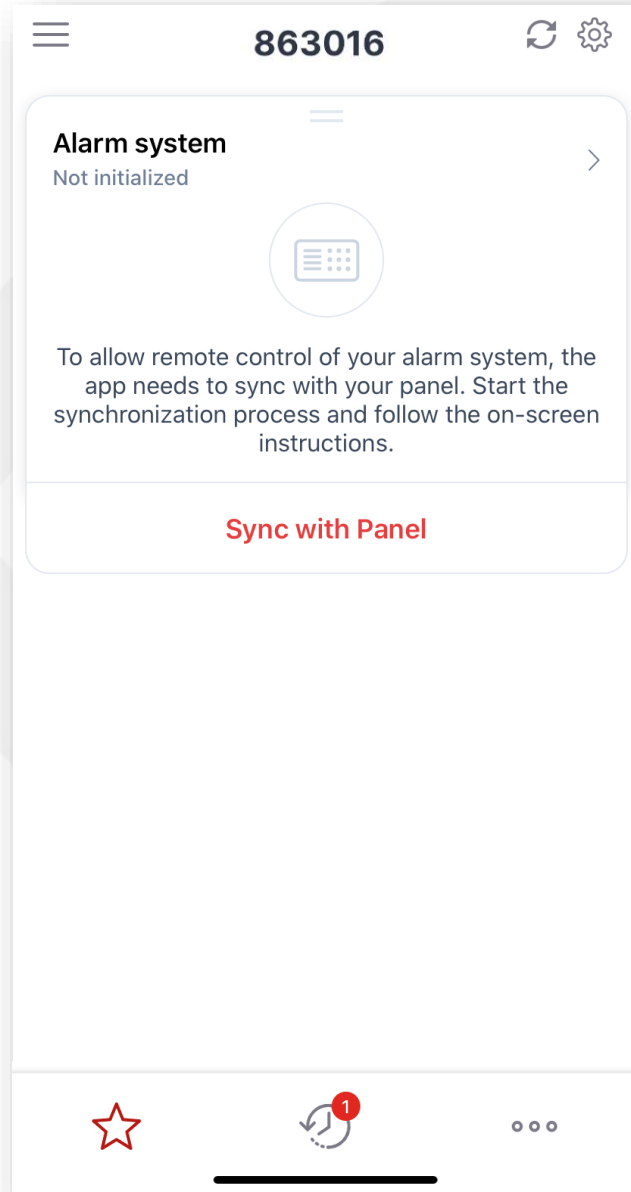

Wait for the app to synchronize with your alarm panel.  
*Do not operate the keypad during the sync process.*

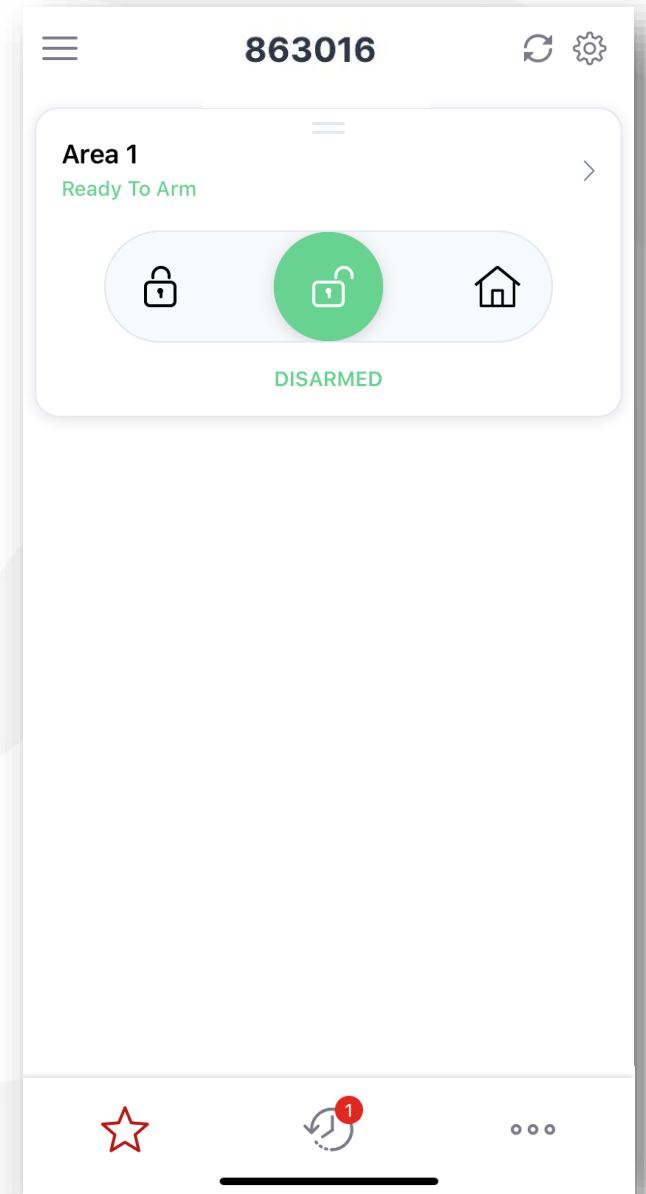
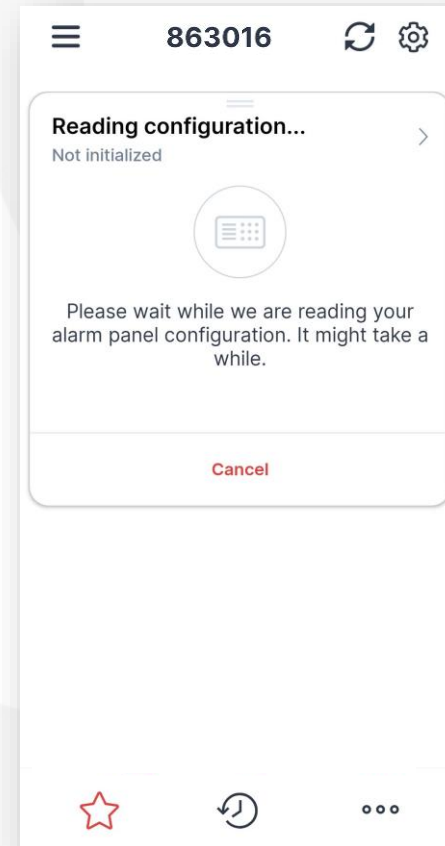

## REMOTE ARMING/DISARMING (SYNCH WITH PANEL)

*To enable this functionality, additional wiring and configuration of the alarm panel must be completed by the installer.*

If panel programming is changed after the initial synchronization you need to select "Sync with Panel" and follow the instructions in the app.

*DO NOT operate the keypad during the sync process.*

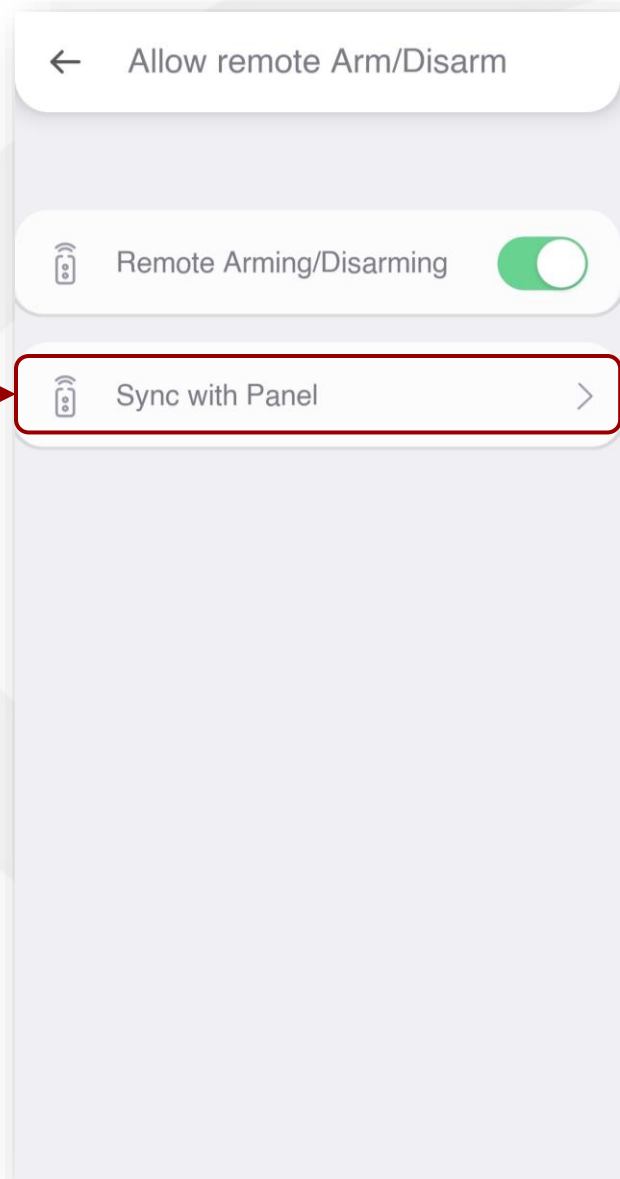

# REMOTE ARMING/DISARMING (KEYSWITCH WIRING)

To enable this functionality, additional wiring and configuration of the alarm panel must be completed by the installer.

Upon first activation, you will be asked to set the PIN for the remote ARM/DISARM.

Enter and confirm your 4-digit PIN then press "Continue"

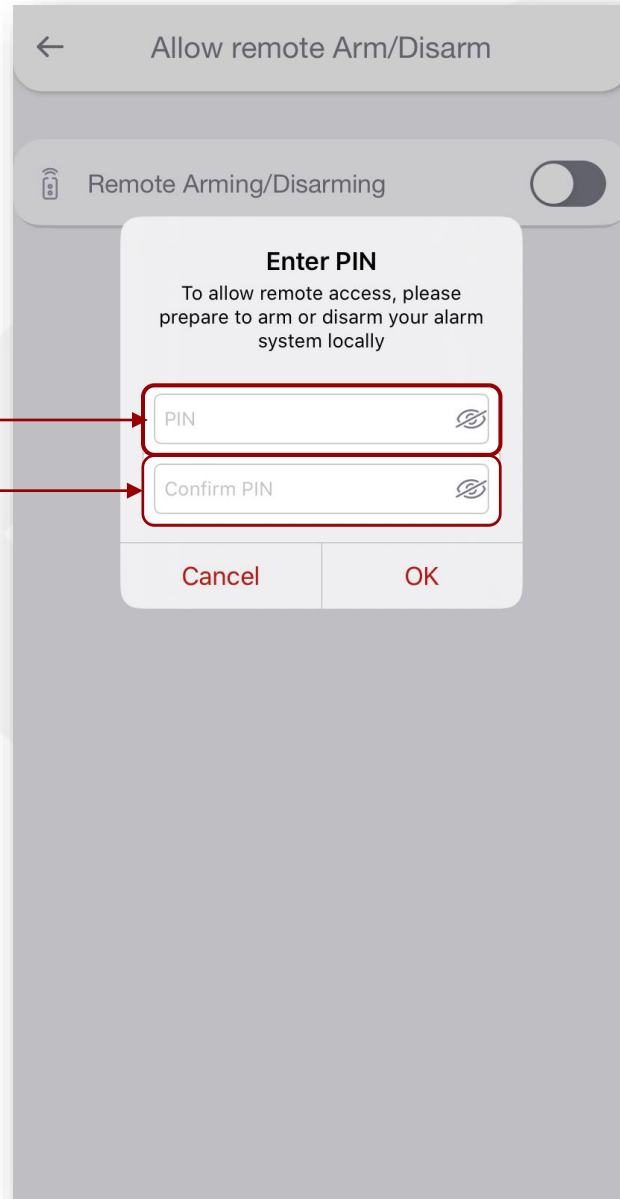

To complete the initial pairing procedure, you must arm and disarm the alarm panel locally (from the keypad) within 2 minutes.

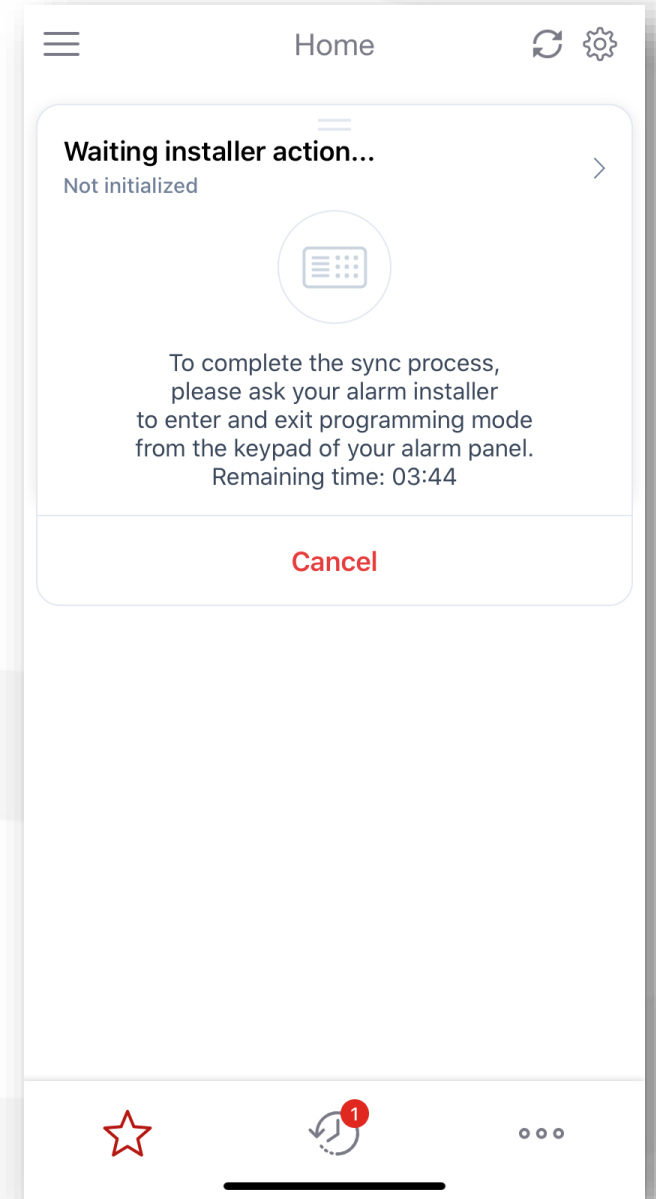
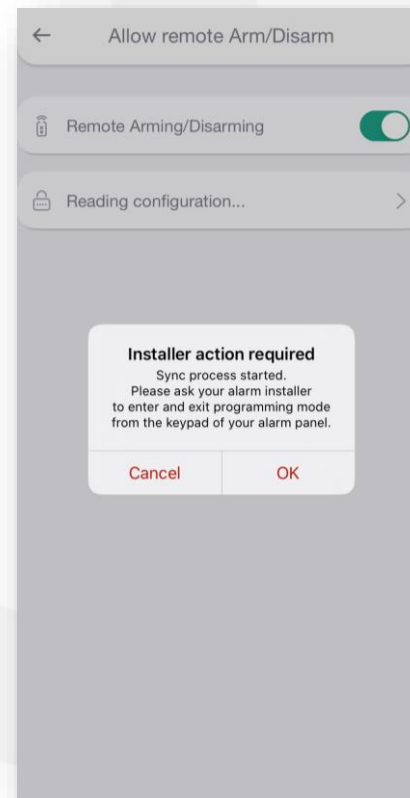

# REMOTE ARMING/DISARMING (PIN CHANGE)

*To enable this functionality, additional wiring and configuration of the alarm panel must be completed by the installer.*

In case you want to change your PIN, you can change it by selecting "Change the remote PIN".

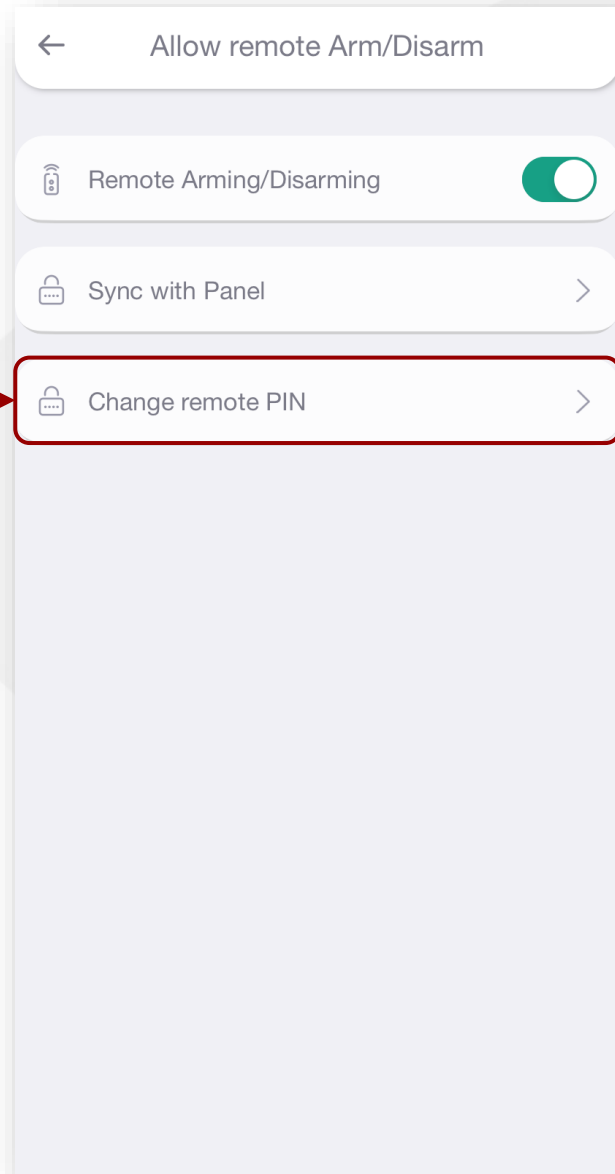

Enter the old PIN, followed by the new one twice and press "Save" to confirm.

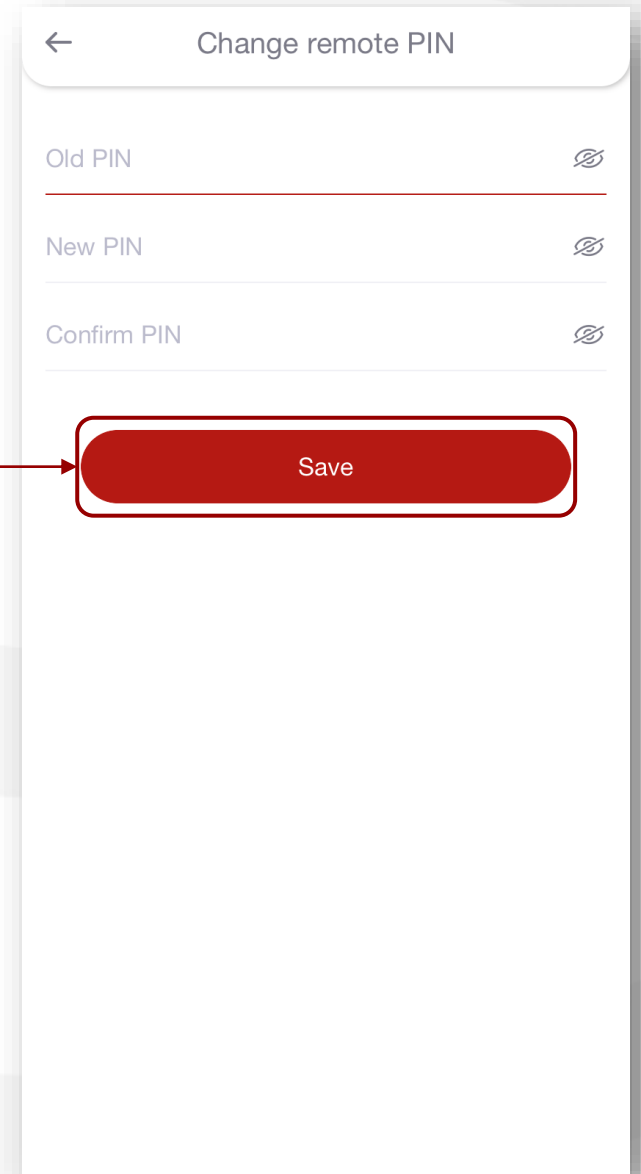

# REMOTE ARMING/DISARMING (PARTITIONS)

To enable this functionality, additional wiring and configuration of the alarm panel must be completed by the installer.

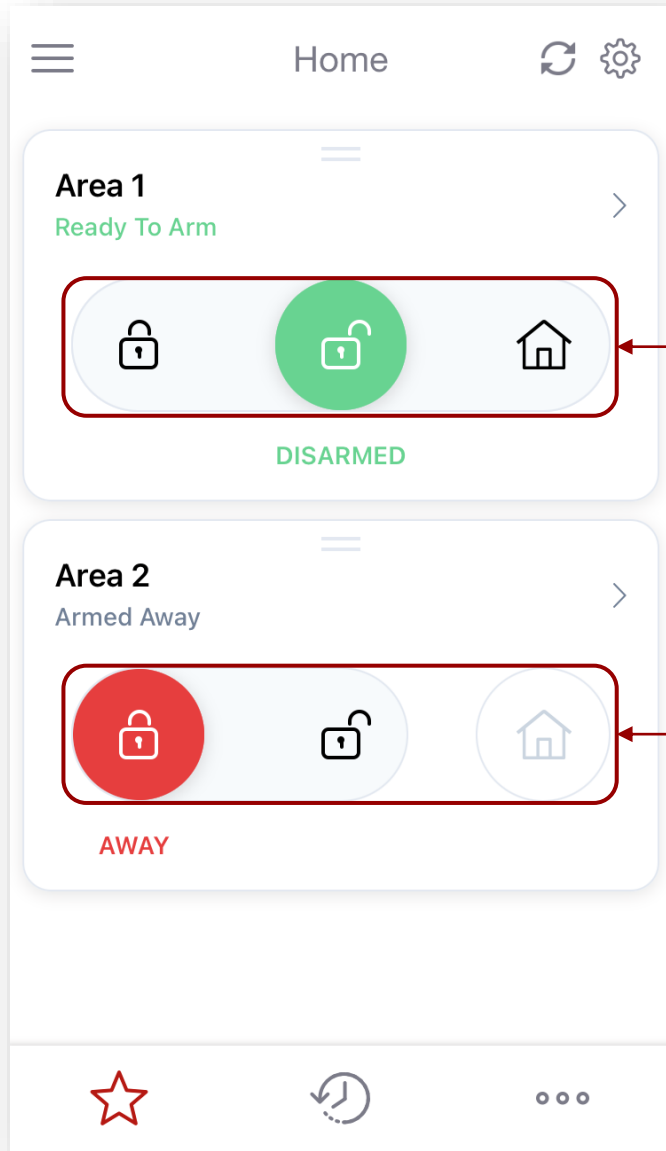

Use the slider to quickly "Stay", "Away" or "Disarm" desired partition.

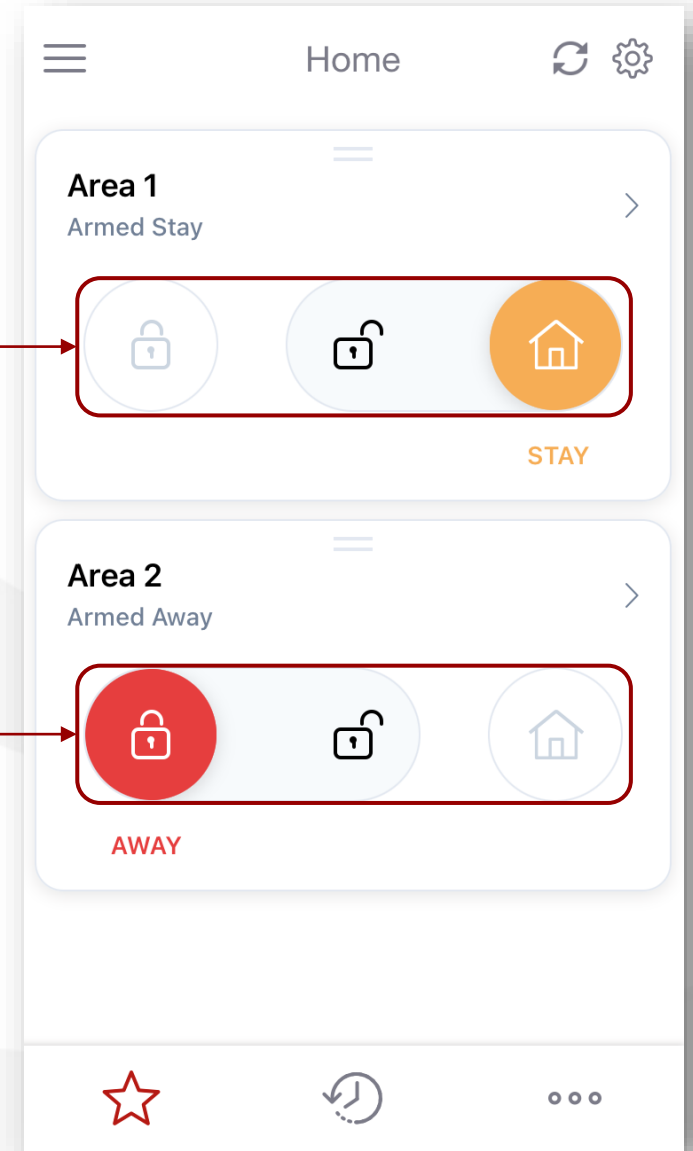

# REMOTE ARMING/DISARMING (ZONES)

To enable this functionality, additional wiring and configuration of the alarm panel must be completed by the installer.

Use the arrow button to see the zones status and bypass a specific zone.

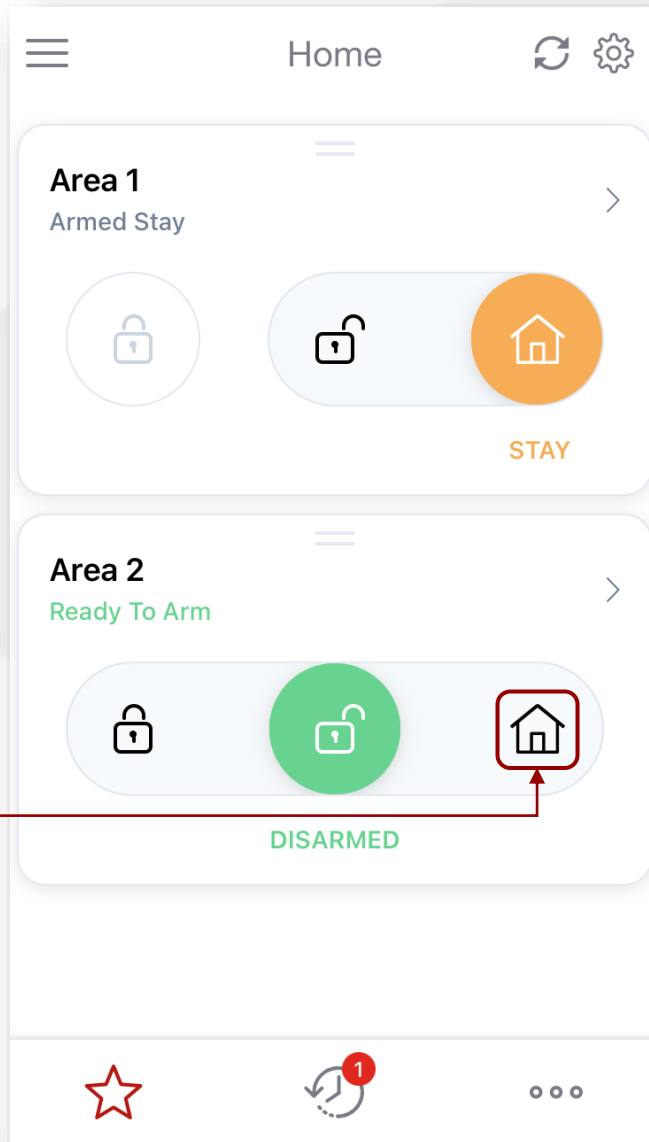

Slide the button to bypass/ unbypass the zone.

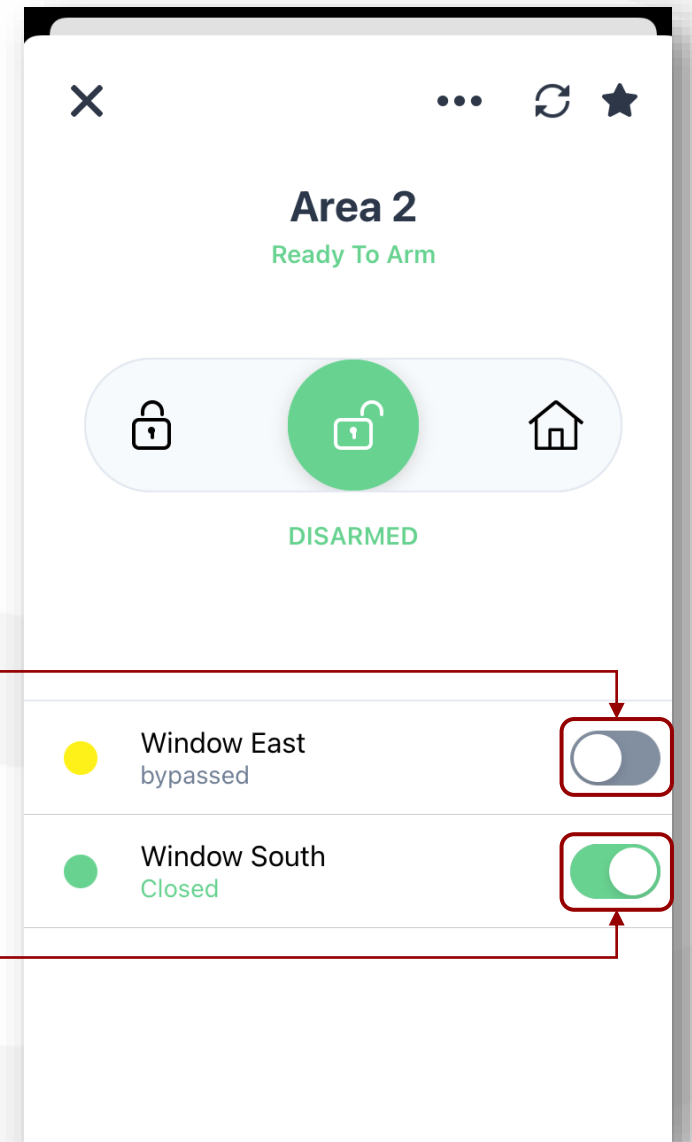



# USERS

Go to "Users" menu if you want to add, remove, or edit the users.

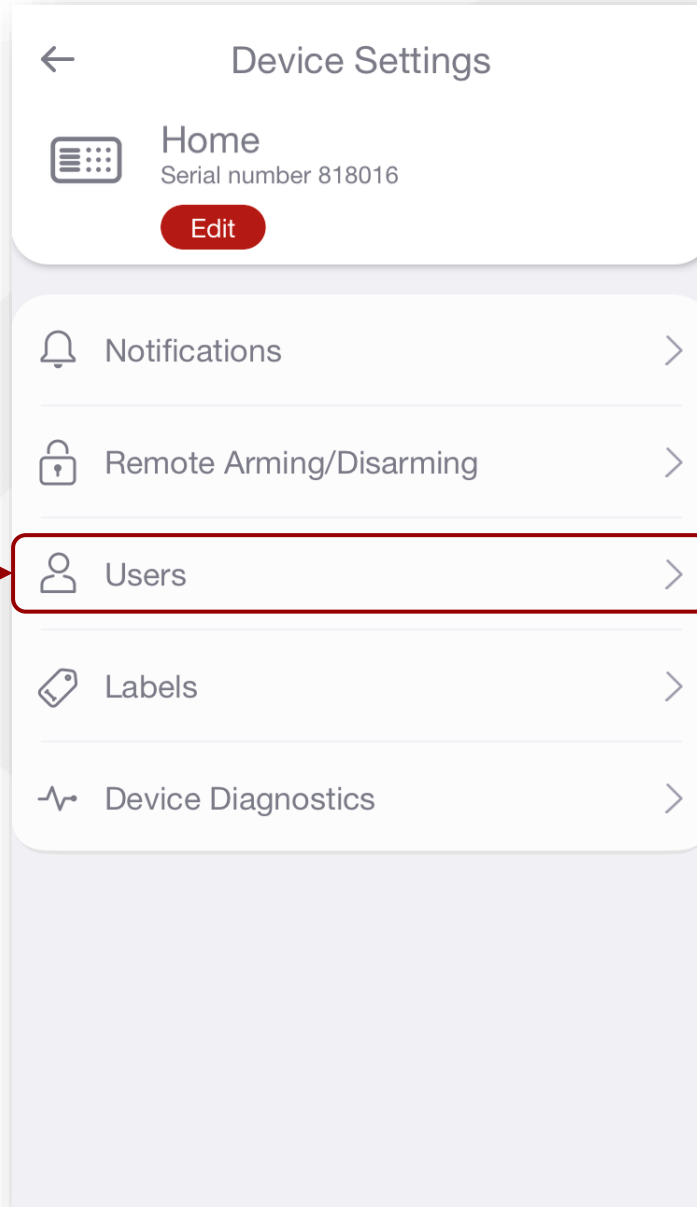

Select "Add new user" if you want to add additional user account to this device (e.g., spouse, kids, relatives).

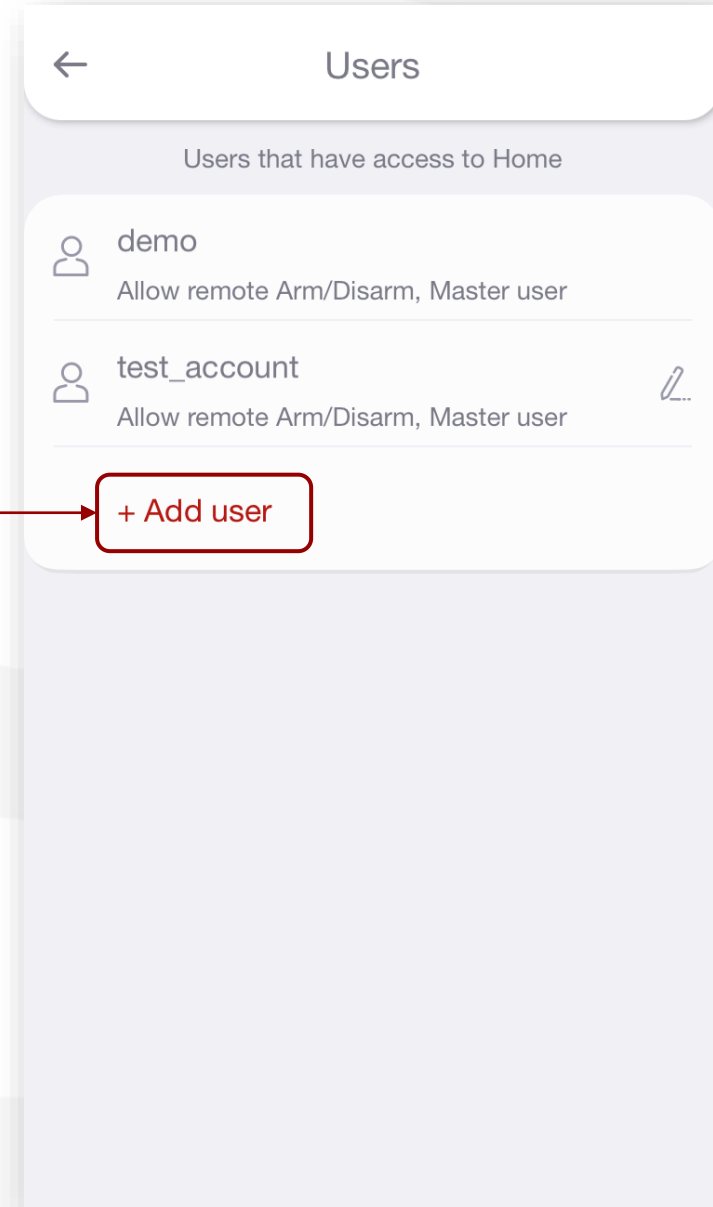

# USERS

Populate the required information in the following fields.

Only "Master user" accounts can add new users, additional devices and label partitions, zones and users.

*\*For security reasons, we recommend that you create only one master user.*

The screenshot shows a mobile application interface for adding a user. The form is titled "Add user" and has a back arrow on the left. It contains several input fields: "Full Name", "Login Name", "Password" (with an eye icon), "Confirm password" (with an eye icon), and "Email address". Below the email field is a note: "\* This email will only be used for password recovery." There are two toggle switches: "Allow remote Arm/Disarm" and "Master user", both of which are currently checked. At the bottom of the form is a red "Save" button. Red arrows point from the text on the left to the "Full Name", "Login Name", "Password", "Confirm password", "Email address", and "Master user" fields. A red arrow points from the text on the right to the "Allow remote Arm/Disarm" toggle switch.

To allow the remote-control permissions select "Allow remote Arm/Disarm" option.

# LABELS

Navigate to “Labels” menu if you want to name your partitions, zones and users.\*

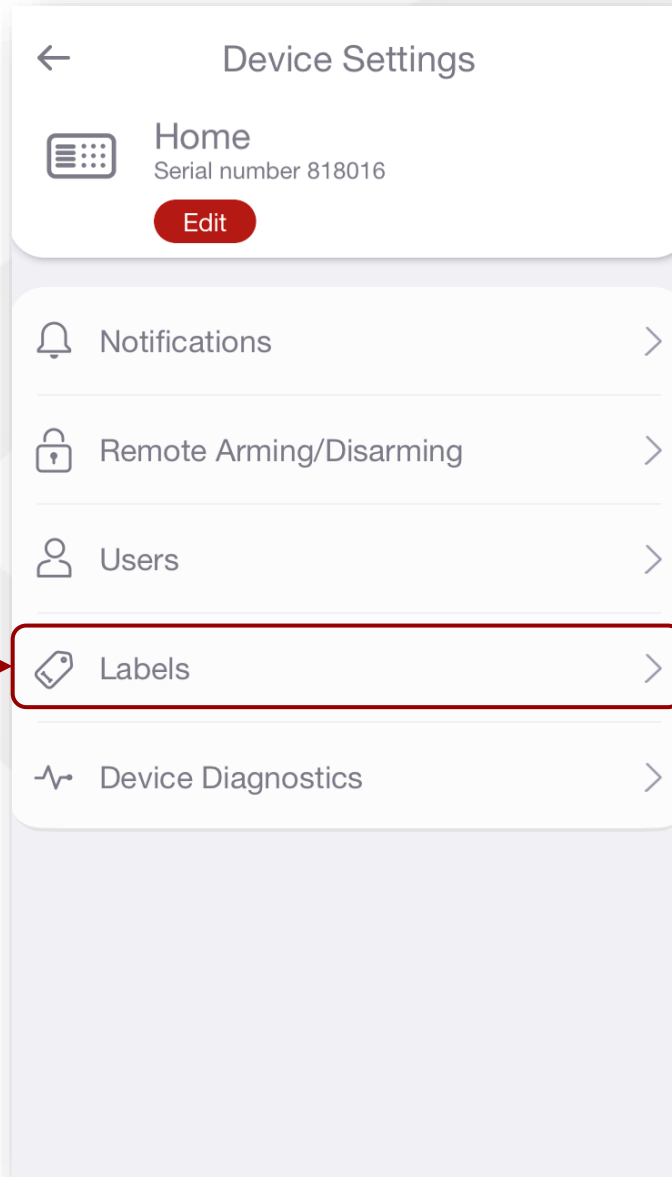

To label a partition, select “Add Label”.

To label a zone or user use the respective tabs.

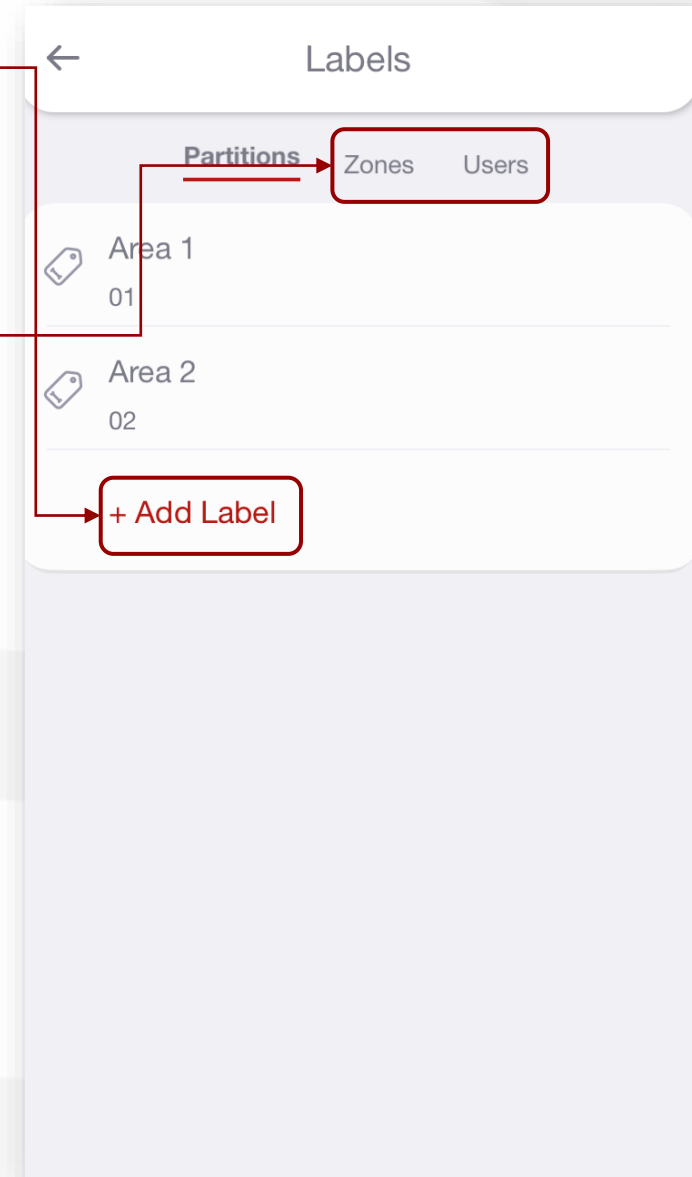

*\*To label partitions, zones and users you need to have a “Master User” account*

# LABELS

Select the specific label to edit it.

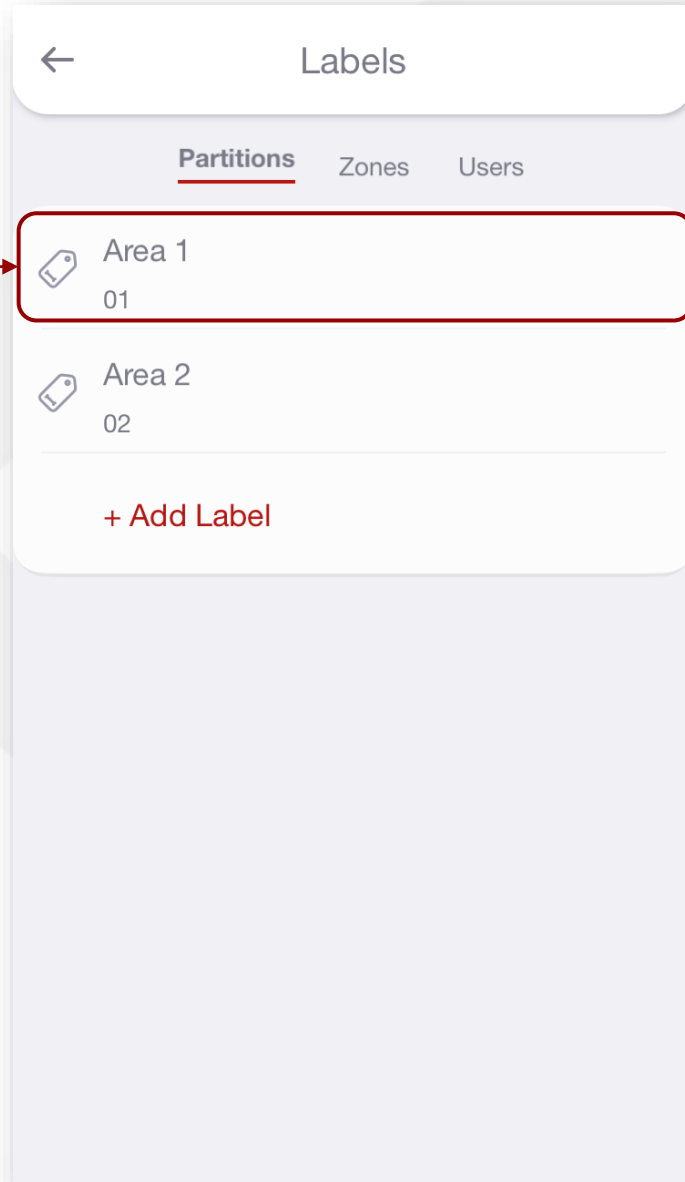

Fill in the fields and press "Save" to save the changes.

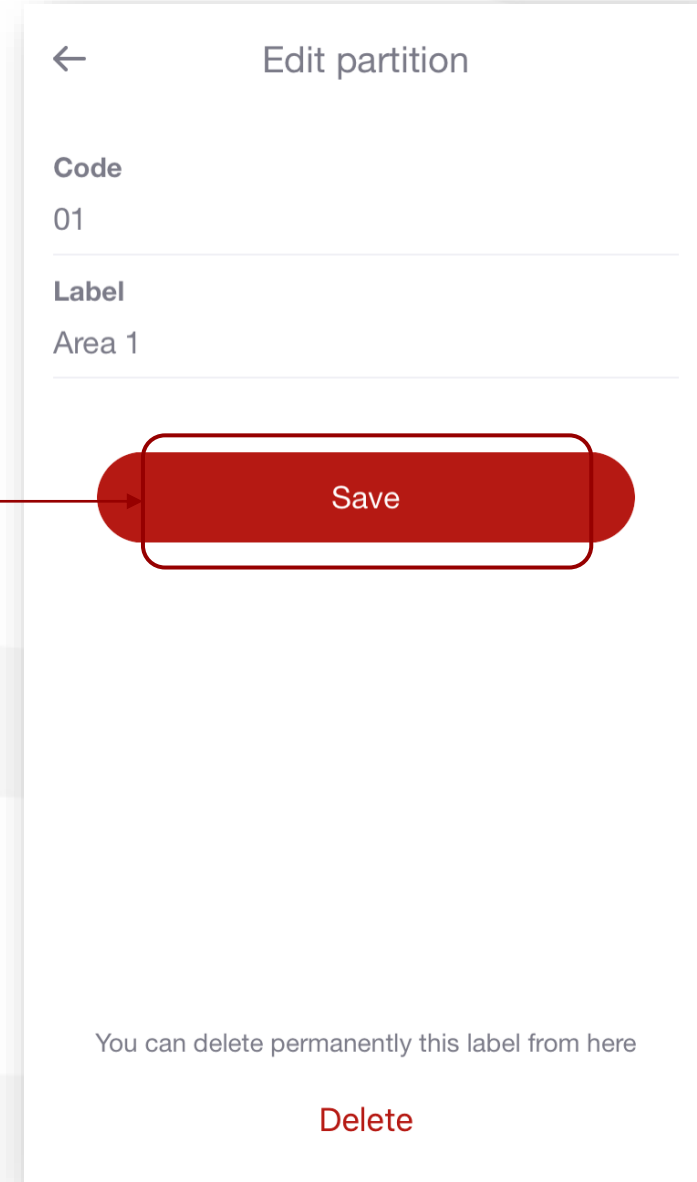

# LABELS (SHORTCUT)

Select the arrow button to edit a specific partition.

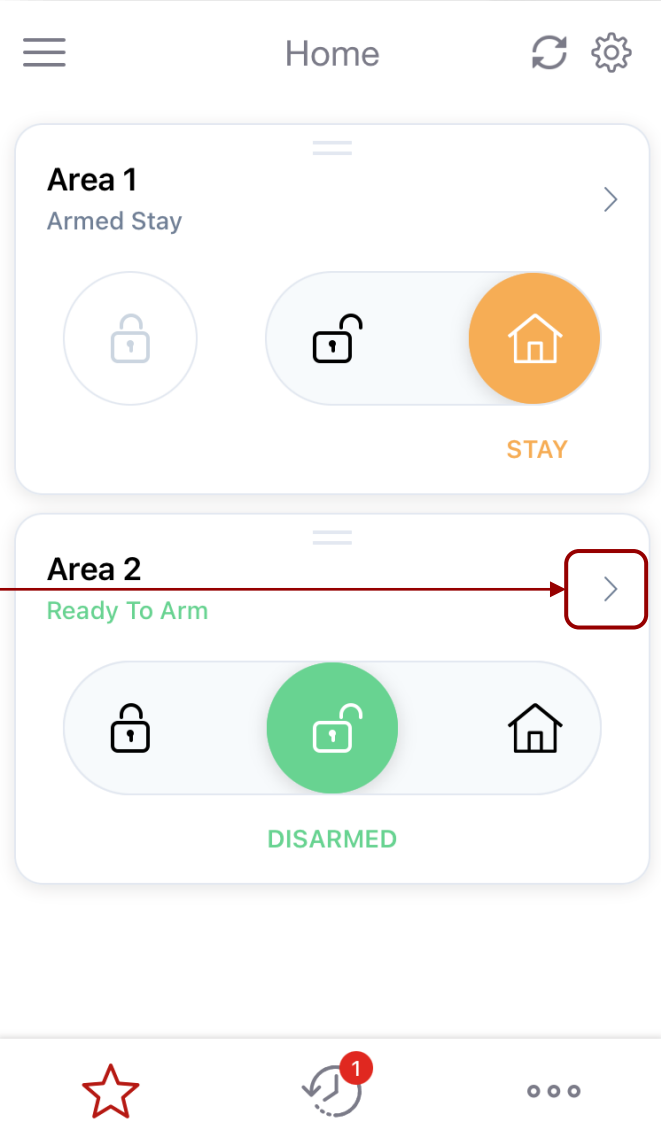

Select the "Edit" button to edit the labels of the partition.

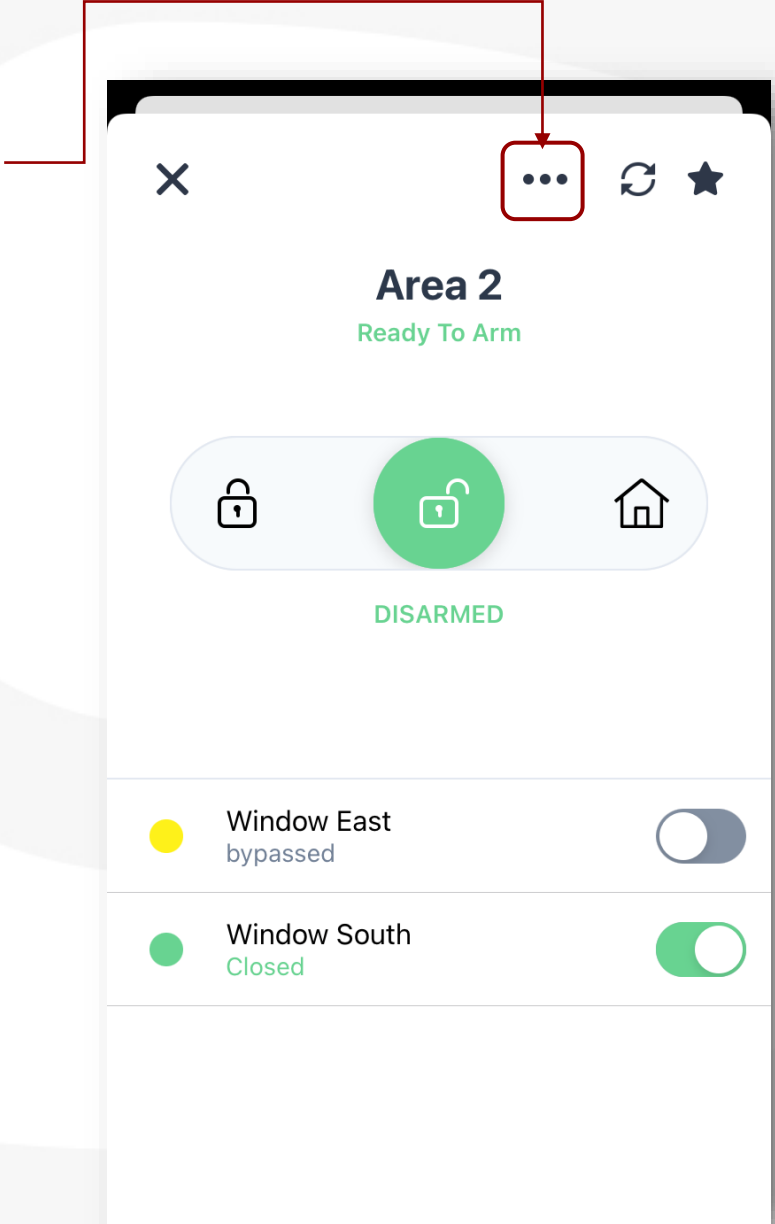

# LABELS (SHORTCUT)

Press "Edit labels" to confirm you want to edit them.

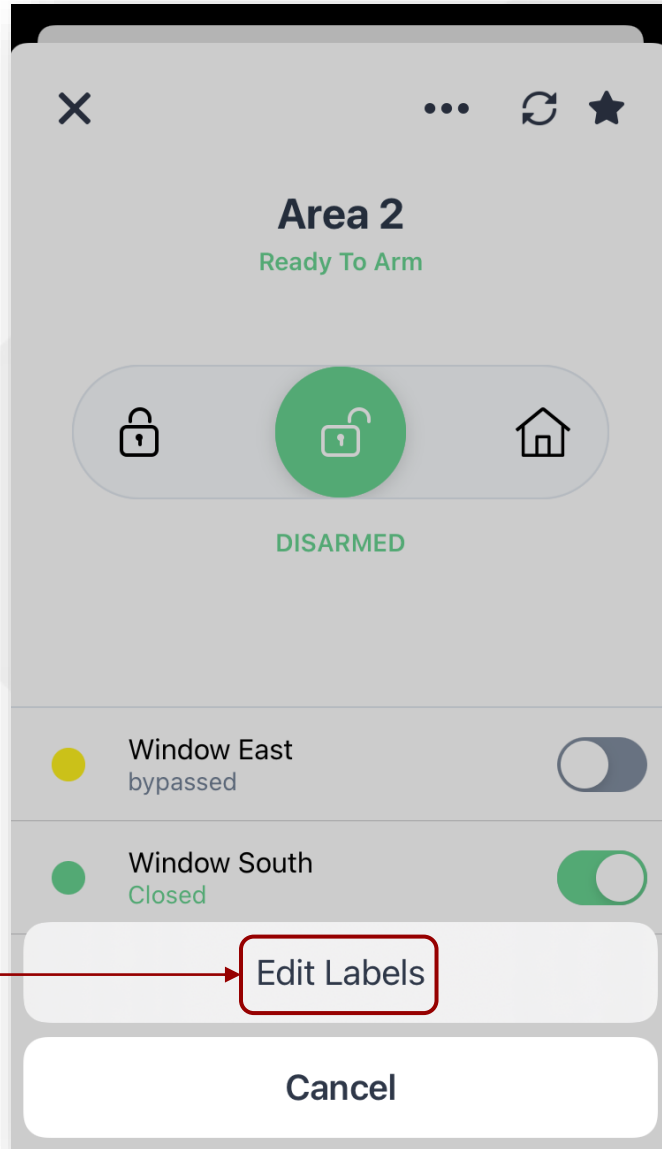

Type the changes and press "Done" to save them.

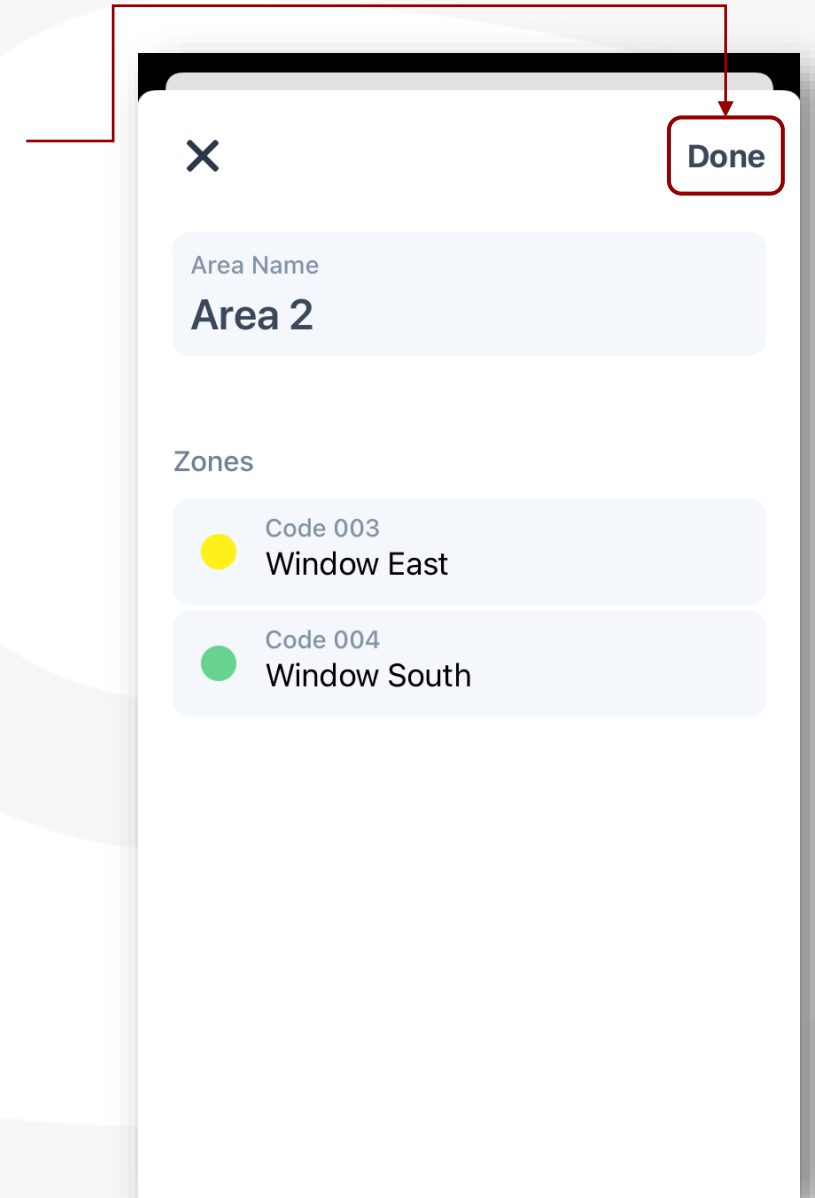

# HISTORY OF EVENTS

Select "Events" from the main screen to see a list of the events back in time.

*The history of events is kept for 12 months.*

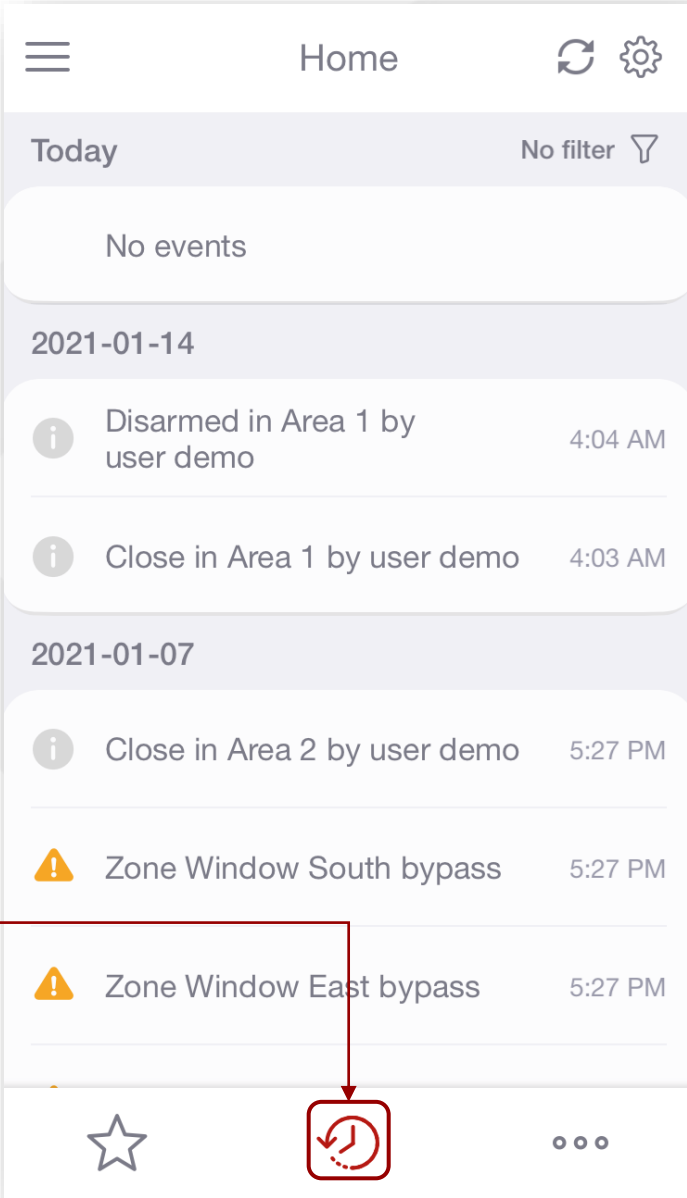

# ADDING MORE DEVICES TO YOUR ACCOUNT

Go to "Add new device" if you want to manage additional devices from the same account.

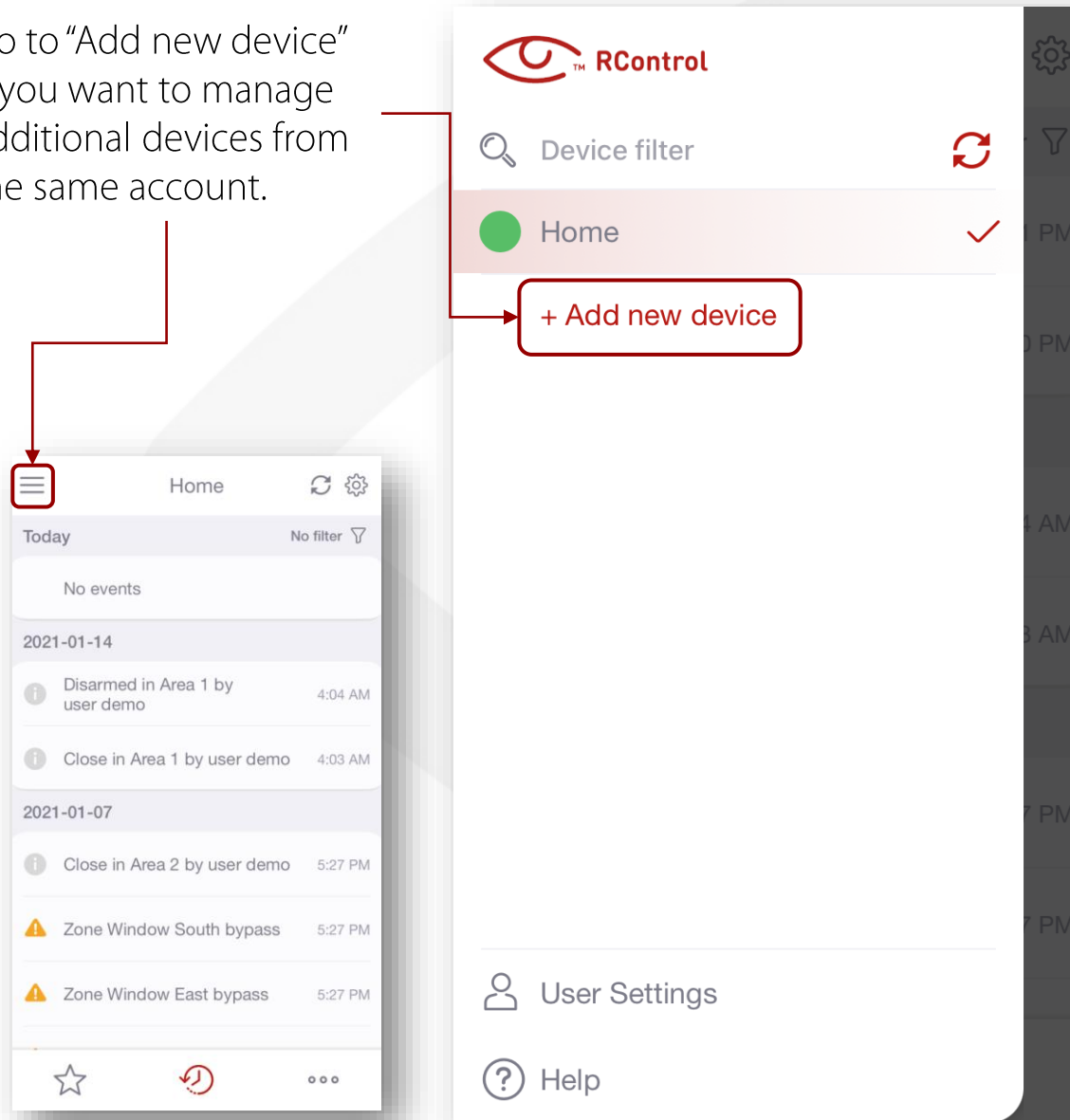

For new devices:  
Enter the serial number of the device that you want to add to this account and the login credentials that comes on the device's manual.

For devices that have already been in use:  
You will have to provide the current username and password.

