

## SystemairCAD week 15 release

### SystemairCAD C2024-04.29.K1

This release contains the following fixes:

- Side By Side units.
- New Defrost free Heat pump.
- Access control system 5.x
- EC Bluefin (Aluminum) fans added in Geniox Core
- CG3500 cylinder filter added.
- Control system flowchart is mirrored when unit is mirrored.
- Update the EuroventEfficiencyClass.dll to version 3 (ECC summer Rev 4.1)
- Hoval Caser DLL update to 2.0.8.0
- Update Recuperator DLL version 1\_0\_8\_0 / Heart A2.3.2.0
- Update Recutech rSelect to use Csharp version of DLL 7.2.0.10
- Update Ziehl Fanselct DLL 1.01 (1.24.02.12)
- DBM Coil DLL updated.

#### Side By Side units

The option to create units where the 2 airflows are beside each other instead of on top of each other is added.

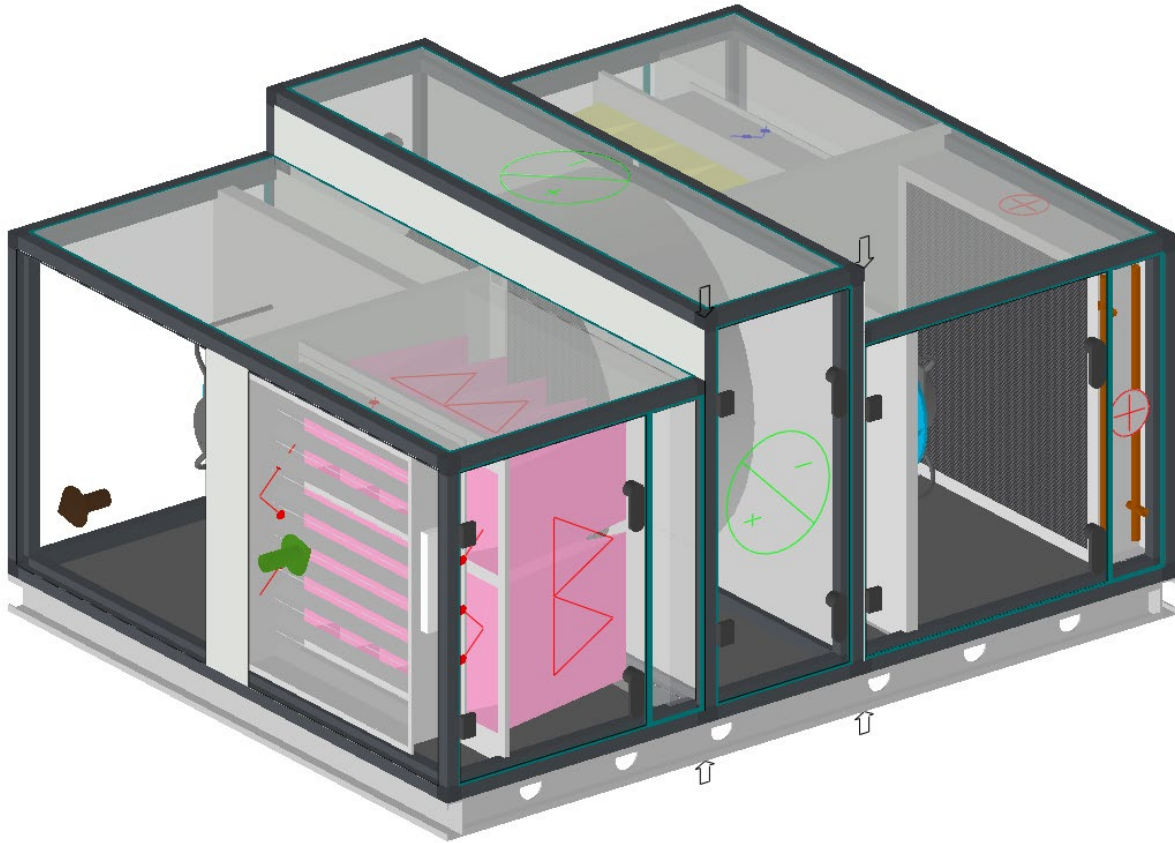

In this first step they are only available on the following markets: Denmark, Netherland, Belgium, France, Germany, Irland and Great Brittan.

#### [New Defrost free Heat pump.](#)

A new Defrost free Heat pump has been added. It has the condenser and evaporator coils on the same side of the heat exchanger.

The compact design results in the heat pump section having a maximum length of 900 mm so it can easily be carried into a building.

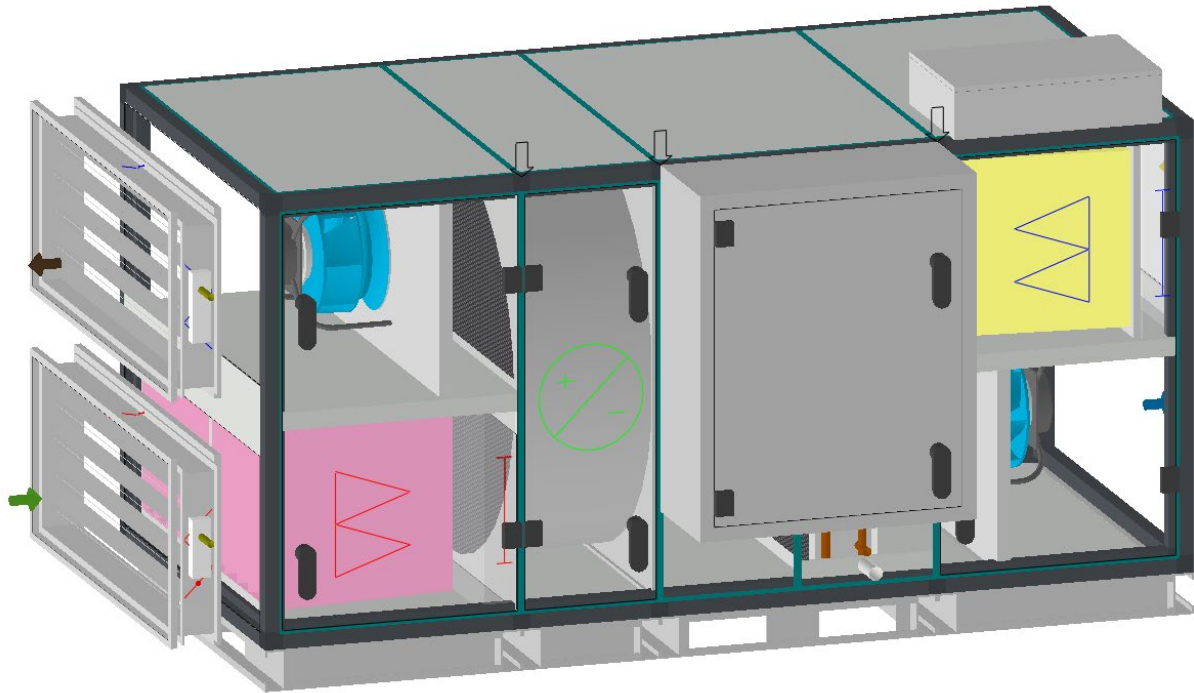

### EC Bluefin (Aluminum) fans added in Geniox Core

In Geniox Core the old EC Blue (Aluminum) fans have been replaced with new more efficient EC Bluefin (Aluminum) fans.

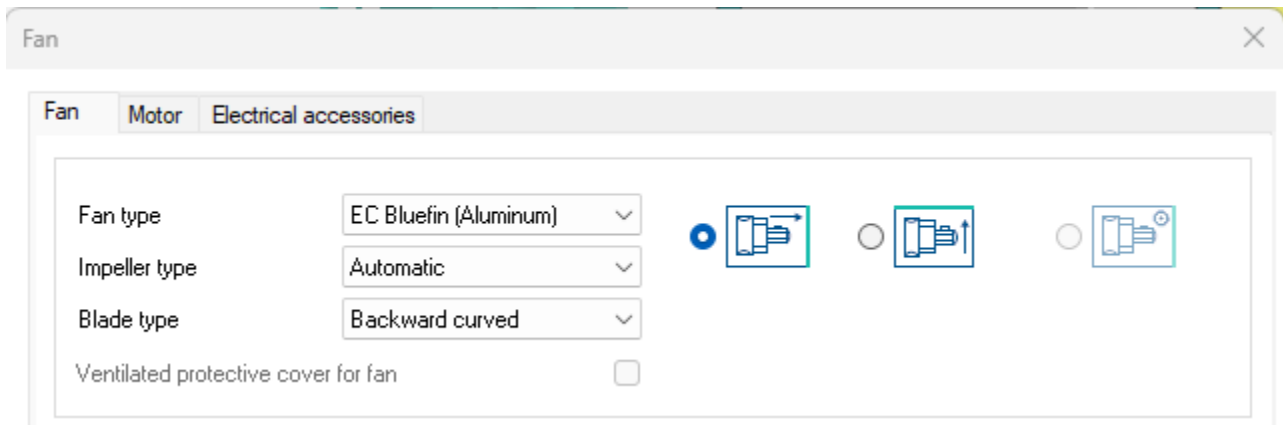

### CG3500 cylinder filter added.

New CG3500 cylinder filters are added so we now have two options for Cylinder filters. The CG3500 filters is longer than CG2600 but they have a lower pressure drop.

Filter

Function type

Material ZincMagnesium

Filter type Cylinder Filters

Filter class CG3500

Only use 1/2 and 1/1 filter cells

Add panel filter before bag filter

Filter class No filter

Extract method Door

Note

Save as default

Catalogue

ISO16890 Calc

Result

Initial pressure drop	106	Pa
Dimensioning pressure drop	111	Pa
Final pressure drop	116	Pa

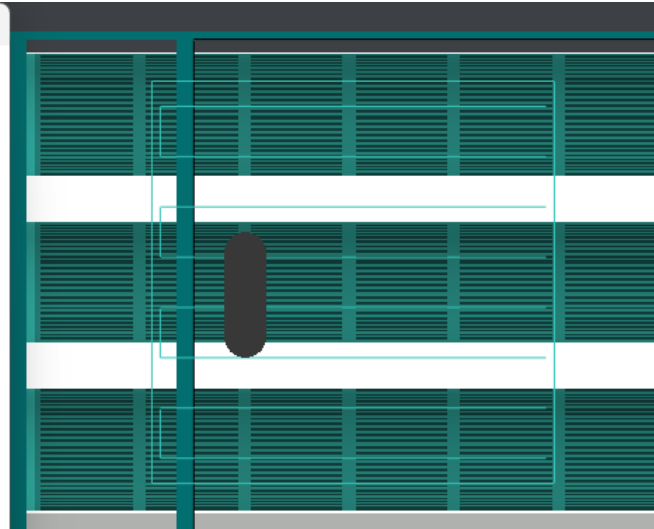

### Access control system 5.x

The Access control system is updated to the new 5.x release.

Access 5.x only works with “Access control system – dialog 2.0” and therefore the old “Systemair Control System” dialog can no longer be selected.

Old quotations created in older versions of SystemairCAD with “Systemair Control System” and Access 4.x can still be opened and calculated with old versions. Users will also have option to update old quotations to Access 5.x.

### Control system flowchart is mirrored when unit is mirrored.

The control system flowchart will now be oriented in the same direction as the unit.

If Outdoor air intake is at the right side of the unit, outdoor air will also be displayed at the right side of the control system flowchart.

